



April 27, 2021

Summit Homes
120 SE 30th St
Lee's Summit, MO 64082

RE: Steel beam revision for Lot 53 Manor at Stoney Creek 11817 SW Merryman Drive, Lee's Summit MO 64082, Permit #PRRES20204555

Residential Engineering Services, LLC (R.E.S.) has been requested to add a post for a steel beam in the basement of the above-mentioned property. Current beam installation lacks sufficient bearing on foundation wall. To compensate for the lack of bearing R.E.S. recommends the following to amend this structural issue:

- Remove 2x ledge and replace with 3" diameter schedule 40 steel post.
- Install new 36"x36"x1'-0" concrete pad with (6) #4 bars each way.
- Dowel and epoxy new pad to existing footing with #4 bars @12" on center embedded 7" both ways.

Please feel free to contact R.E.S. with any further questions on this matter.

Sincerely,

A handwritten signature in blue ink, appearing to read "B. Huxol", is written over a light blue horizontal line.

Bradley A. Huxol, PE



- FOUNDATION NOTES:**
- 1. ALL CONSTRUCTION SHALL CONFORM TO 2018 INTERNATIONAL RESIDENTIAL CODE (IRC).
 - 2. FOOTING ELEVATION TO BE DETERMINED BASED ON FINAL GRADE: ALL FOOTINGS MEET OR EXCEED MINIMUM FROST DEPTH OF 36".
 - 3. SOIL BEARING CAPACITY SHALL BE MINIMUM 1500 PSF.
 - 4. COMPRESSIVE STRENGTH OF CONCRETE SHALL BE 3000 PSI.
 - 5. REQUIRED AIR ENTRAINMENT SHALL BE 5-7% AS SPECIFIED IN IRC TABLE R402.2.

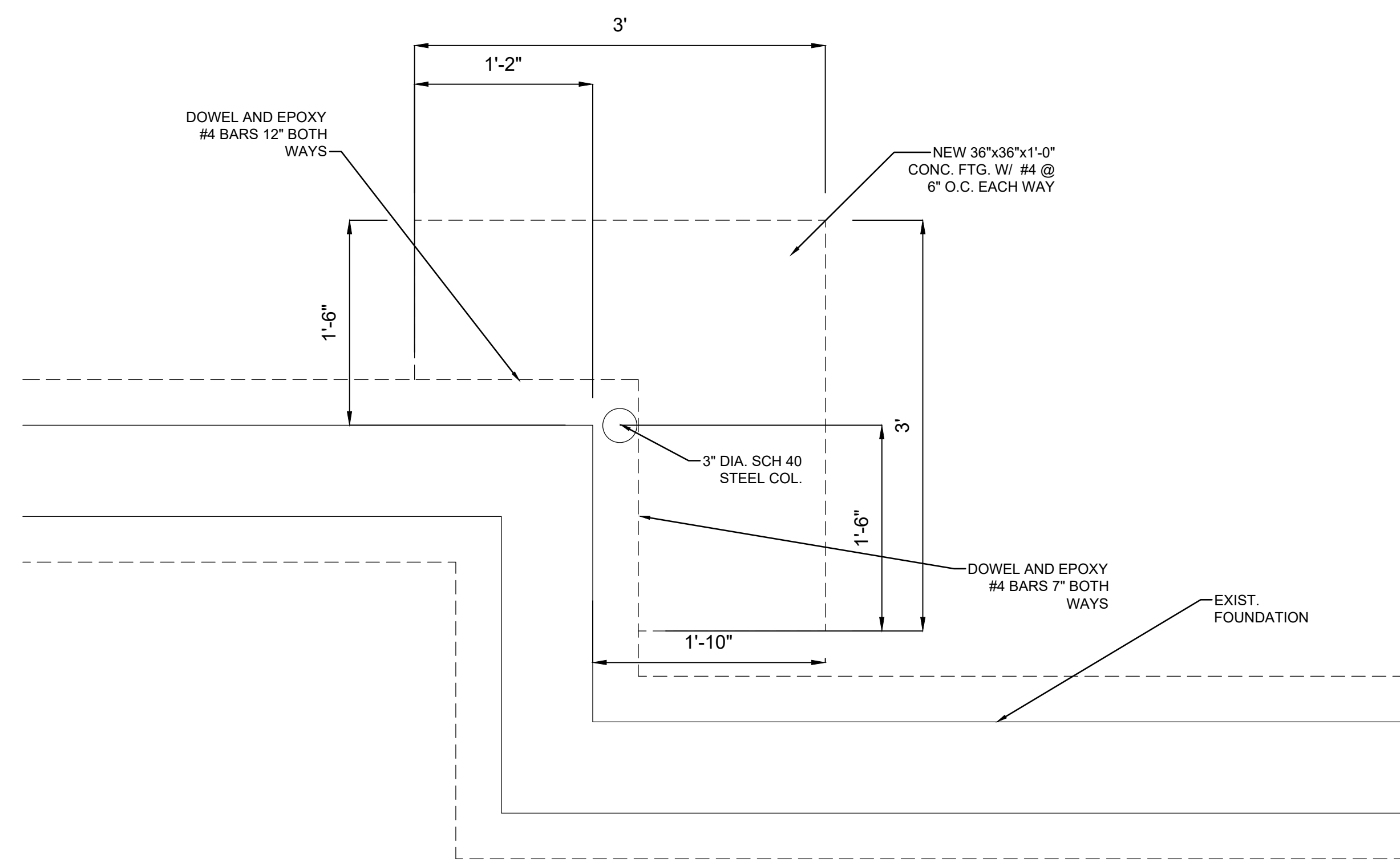

NEW PAD TO EXISTING FOUNDATION FOOTING
N.T.S.



RESIDENTIAL ENGINEERING SERVICES, LLC
WWW.RES-KC.COM
600 SW JEFFERSON ST, STE 300
LEE'S SUMMIT, MO 64063
(816) 399-4901

FOUNDATION DETAIL

SHEET #

S100