

RELEASE FOR  
CONSTRUCTION  
AS NOTED, SURVEY AND REVIEW  
CERTIFICATE SERVICES  
LEEDS SUMMIT, MISSOURI  
00000001

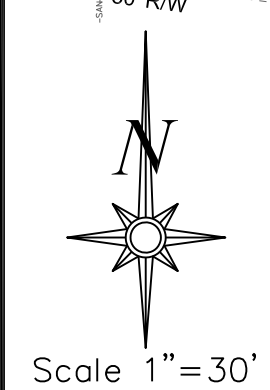

LOT INFORMATION

14,359 SQ. FT.  
MBOE (FRONT LEFT) = 1024.74  
MBOE (FRONT RIGHT) = 1024.20  
MBOE (REAR LEFT) = 1026.51  
MBOE (REAR RIGHT) = 1025.97  
MSFE = 1016.38  
ADDRESS  
1540 SW ARBOR VALLEY DRIVE

LEGAL DESCRIPTION

LOT 94, HAWTHORN RIDGE 1ST PLAT, A SUBDIVISION AS RECORDED IN LEE'S SUMMIT, JACKSON COUNTY, MISSOURI.

- Gas Meter
- Telephone or Fiber-Optic Pedestal
- Cable TV Pedestal
- Electric Pedestal
- Mailbox

PROPOSED HOUSE

TOP FOUNDATION = 1027.75  
GARAGE FLOOR = 1025.75  
TOP FOOTING = 1018.75  
BASEMENT FLOOR = 1019.08  
DRIVEWAY SLOPE = 7.5%

E = EXISTING ELEVATION  
F = PROPOSED FINAL ELEVATION  
G = ADJACENT GRADE AT EGRESS  
U/E = UTILITY EASEMENT  
B/L = BUILDING LINE  
S/Y/S = SIDE YARD SETBACK  
R/Y/S = REAR YARD SETBACK

NOTES

1. BUILDER TO VERIFY ALL BUILDING ELEVATIONS AND DIMENSIONS.
2. THIS PLOT PLAN DOES NOT CONSTITUTE A BOUNDARY SURVEY.
3. THE EASEMENTS SHOWN ON THIS PLOT PLAN ARE TAKEN FROM THE FINAL PLAT. OTHER EASEMENTS MAY EXIST.

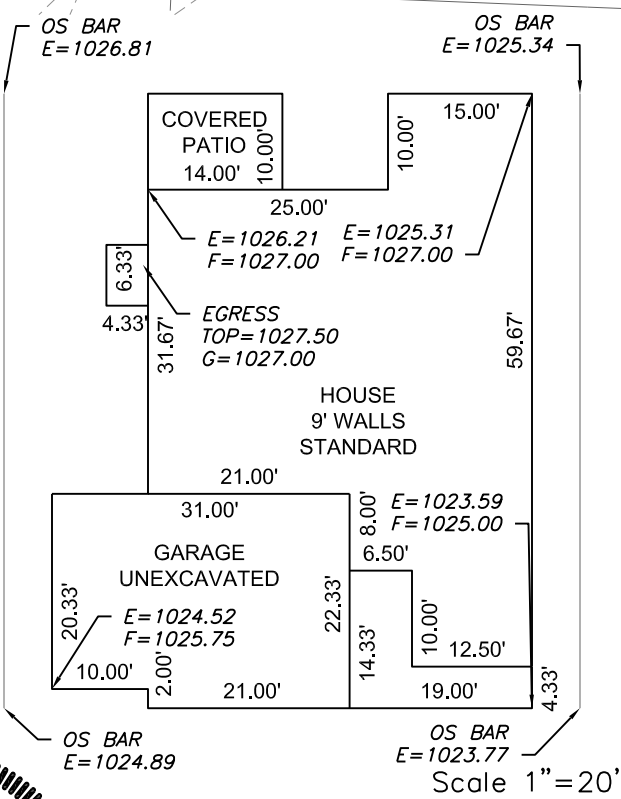

**ENGINEERING SOLUTIONS**  
ENGINEERING & SURVEYING  
50 SE 30TH STREET  
LEE'S SUMMIT, MO 64082  
P: (816) 623-9888 F: (816) 623-9849  
WWW.ENGINEERINGSOLUTIONSKC.COM

STATE OF MISSOURI  
MATTHEW J. SCHLICHT  
PROFESSIONAL ENGINEER  
PE-2006019708  
3/16/2022

**PLOT PLAN - LOT 94**  
HAWTHORN RIDGE 1ST PLAT  
LEE'S SUMMIT, JACKSON COUNTY, MISSOURI  
SUMMIT HOMES  
120 SE 30TH STREET  
LEE'S SUMMIT, MO 64082  
PROJECT NO. 1 FILE NAME LOT 93, 94, HAWTHORN RIDGE DATE 2/19/21 SHEET 1 OF 1  
Rev:

THIS DRAWING IS NOT VALID UNLESS THE SIGNATURE, DATE AND SEAL OF THE ENGINEER WHO SUPERVISED THE PREPARATION OF THIS DRAWING HAS BEEN AFFIXED HERETO.