

Occupant Load Schedule - Working				
Number	Name	Area	Occupancy Use	Max Occupancy
101	Acting Lab	2,548 SF	ACTING LAB -OTHER THAN F	45
102	Circulation	310 SF		
103	Changing Room 1	70 SF	BACKSTAGE	1
104	Changing Room 2	70 SF	BACKSTAGE	1
105	Women WC	53 SF	* NON-SIMULTANEOUS USE COMMON AREA	
106	Men WC	56 SF	* NON-SIMULTANEOUS USE COMMON AREA	
Grand total: 6		3,107 SF		47

Plumbing Fixture Schedule			
Room Name	Fixture	Required	Count
Level 1			
Circulation	Drinking Fountain (Double)	1	1
Circulation	Service Sinks	1	1
Men WC	SINK	1	1
Men WC	WATER CLOSET	1	1
Women WC	SINK	1	1
Women WC	WATER CLOSET	1	1

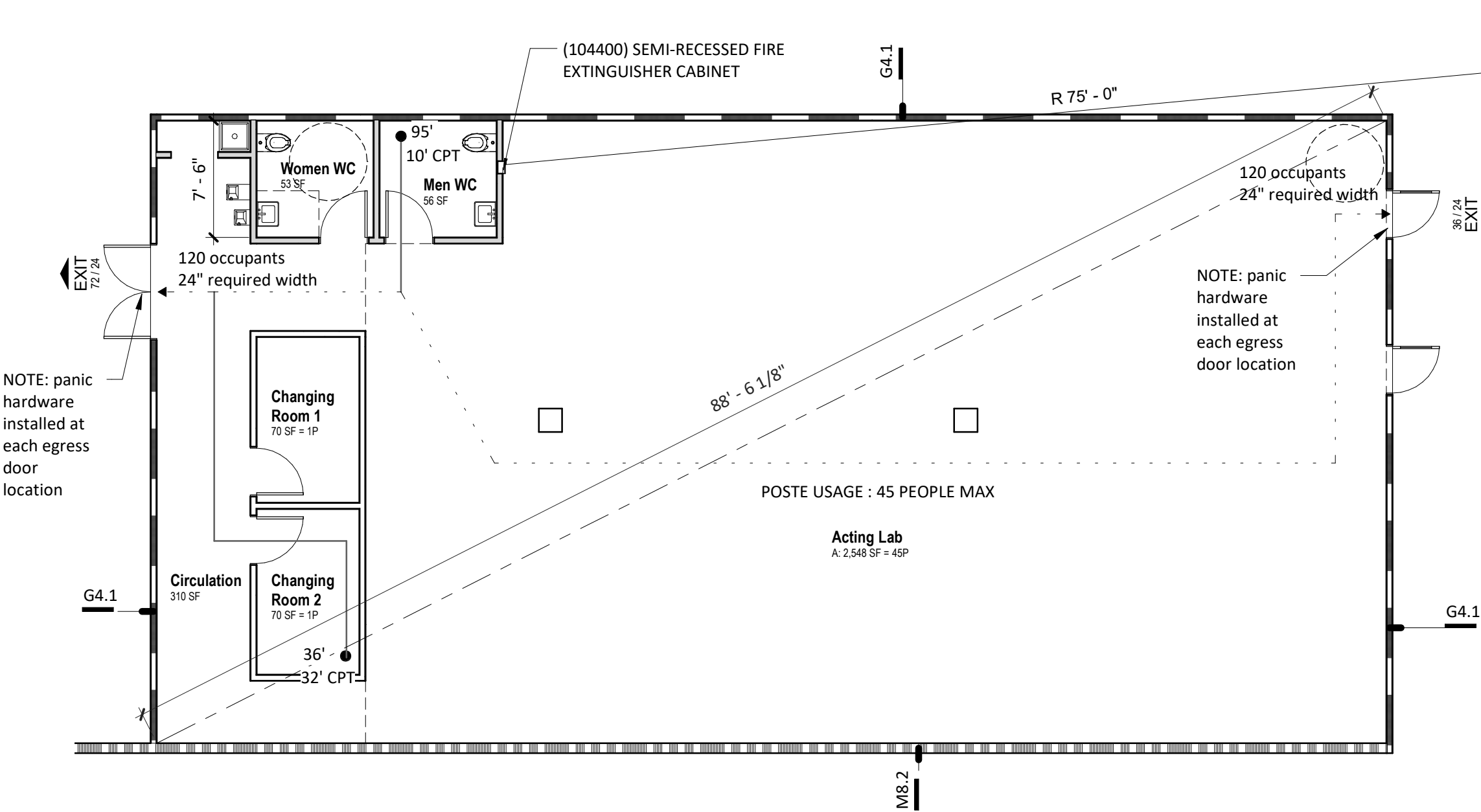

Code Plan Legend:

Egress Path of Travel
Distance to Exit — 100'
Common Path of Travel Distance — 50' CPT

Egress Point
Maximum # of Occupants (by width) — 100 / 50
Required # of Occupants —

Stair Egress
Maximum # of Occupants (by width) — 28 / 14
Required # of Occupants — Stair #1 | 4'-0"

Occupancy Tag
Occupancy Group — B: 200 SF = 2P
Area —
Occupant Load — Room name

Fire Extinguisher Radius
75' Typ

1-Hour: Fire Rated Assembly
2-Hour: Fire Rated Assembly
3-Hour: Fire Rated Assembly
4-Hour: Fire Rated Assembly
Smoke Barrier
Smoke Partition

Ventilation Summary:
Existing unit: 10 ton unit. 800 cfm outside air.
OA required = 10cfm/person + area *.06
OA required = 10cfm/64 + 2548*.06
OA required = 645 + 153 = 798

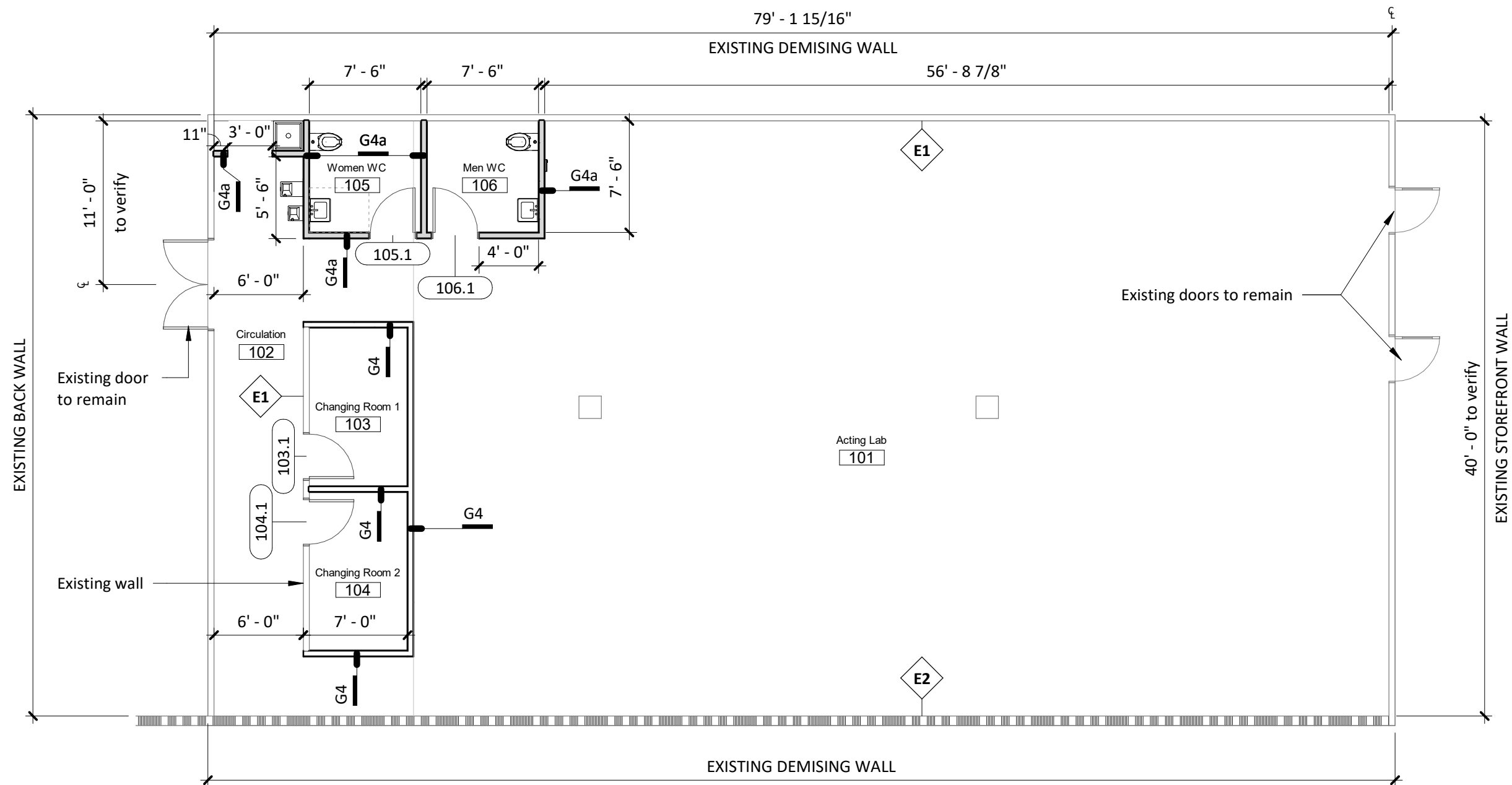

PARTITION SCHEDULE:

- E1 EXISTING PARTITION:
5/8" GYP. BD. STEEL STUDS.
PARTITION IS CONTINUOUS FROM
SLAB TO UNDERSIDE OF DECK.
FIRE CAULK TO BE INSTALLED
WHERE GYP BD MEETS ROOF DECK.
- E2 EXISTING CMU WALL ,
CONTINUOUS FROM SLAB TO
ABOVE PARAPET
- G4A NEW PARTITION:
5/8" GYP BD EACH SIDE OF STEEL
STUDS AT 16" O.C. PARTITION
STOPS AT CEILING
- G4 NEW PARTITION:
5/8" GYP BD. EACH SIDE OF
STEEL STUDS AT 16" O.C.
PARTITION IS CONTINUOUS FROM
SLAB TO UNDERSIDE OF DECK.