

CITY OF LEE'S SUMMIT
Development Services Department
220 SE Green Street
Lee's Summit, MO 64063
(816)969-1200
DEVSERVICES.CITYOFLS.NET

Inspection Summary

Permit #: PRRES20200322
Address: 2029 NE BLUESTONE DR, LEES SUMMIT, MO 64064

This work has been inspected and the inspection results noted below. Please schedule inspections once all corrective actions have been completed. Do not cover any work until approved.

Inspection:	Inspector:	Outcome:	Date:
All Rough Inspection - Residential	Khanh Nguyen	Failed	Tuesday, November 03, 2020

Corrective Action Required:

1 Misc

FRAMING:

- Nail garage portal brace wall per code
- Fb b-vent and shelf space from roof
- Provide collar ties at upper ridge
- Block both deck doors 3 stud spaces out at strike plate height
- Fb floor opening at front bedroom closet wall
- Have engineer address the followings: exterior brace wall width at wall opening to rear porch not per plan; tall 2x4 gable wall with non-continuous studs at front bedroom
- Provide full support for lvl point load carrying the I beam load outside master bedroom. The small I beam below not catching the point load.
- Hallway in basement shall be min 36" in width between finished wall
- Fb basement wall per code vertically at max ten ft interval
- Weld some of the un-attached steel columns to the I beam

PLUMBING:

- Provide min 4-10d nails at each side of the wall top plate straps
- Secure gas csst line at fireplace

** OK TO INSULATE



HD Engineering & Design

Solutions for all your engineering and design needs

November 6, 2020

Wyss Construction, LLC
PO Box 6620
27400 Mason School Rd
Lee's Summit, MO 64064

Re: Lot 322 Park Ridge 2029 NE Bluestone Dr

Our firm has been asked to make structural recommendations for the house being built at the address listed above. The city has questioned several items during the rough-in inspection. Below is a list of our recommendations along with the corresponding city items.

The side to side braced wall lengths have been reduced by adding a 12' slider to the covered rear deck. After reviewing the side-to-side firm recommends installing GB Bracing to the front side-to-side wall of the Master Bedroom and the rear side-to-side wall of the Garage. (see attached)

The front gable wall of the front bedroom has not been framed with continuous studs. Our firm recommends installing Simpson MSTAM24 straps centered on the hinge plate up and down each stud, skipping the last one on each end. The straps should be fastened per the manufacturer's specifications.

The LVL header to the Master Bedroom, which supports the main side-to-side steel beam in the ceiling is not adequately supported. Our firm recommends adding a (4) #2 2X10 beam under this location.

This report has been prepared for the exclusive use of our client for specific application to the project discussed and has been prepared in accordance with generally accepted engineering practices. No warranties, either express or implied, are intended or made.

We appreciate the opportunity to be of service to you on this project. If you have any questions regarding this report, please contact us.

Very truly yours,
HD ENGINEERING & DESIGN, INC.





HD Engineering & Design

Solutions for all your engineering and design needs

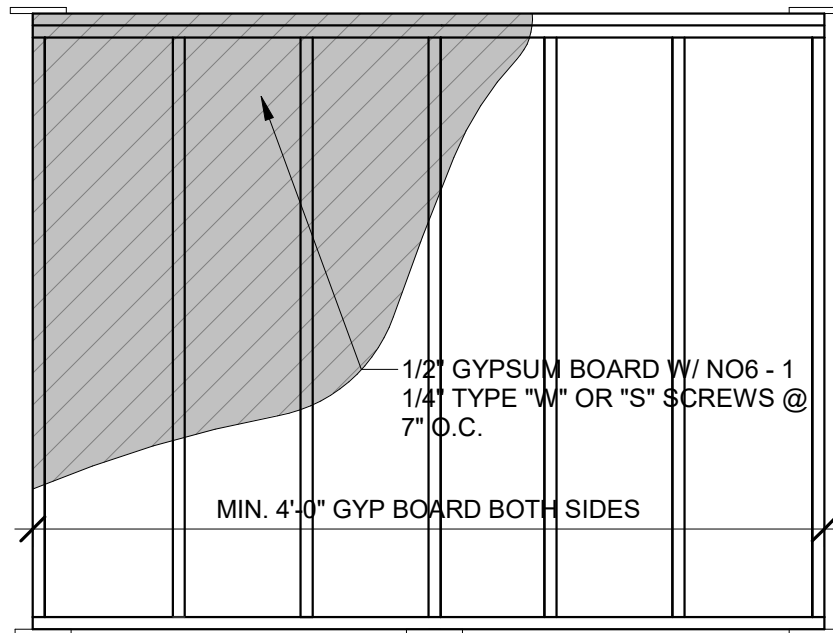

GB BRACING

$1/2" = 1'-0"$

