

RELEASE FOR
CONSTRUCTION
AS NOTED ON PLANS REVIEW
DEVELOPMENT SERVICES
LEE'S SUMMIT, MISSOURI
10/23/2020

Ground Floor

Van Deurzen and Associates, P.A.
11011 King Street, Suite 130
Overland Park, KS 66210
(913) 451-6305 FAX: (913) 451-1021

This shop drawing has been reviewed for conformance with the design concept and information given in the Contract Documents.

- Reviewed with no exceptions noted.
- Reviewed as noted.
- Returned for correction.
- Not Reviewed.

By: JWH Date: 10/21/2020

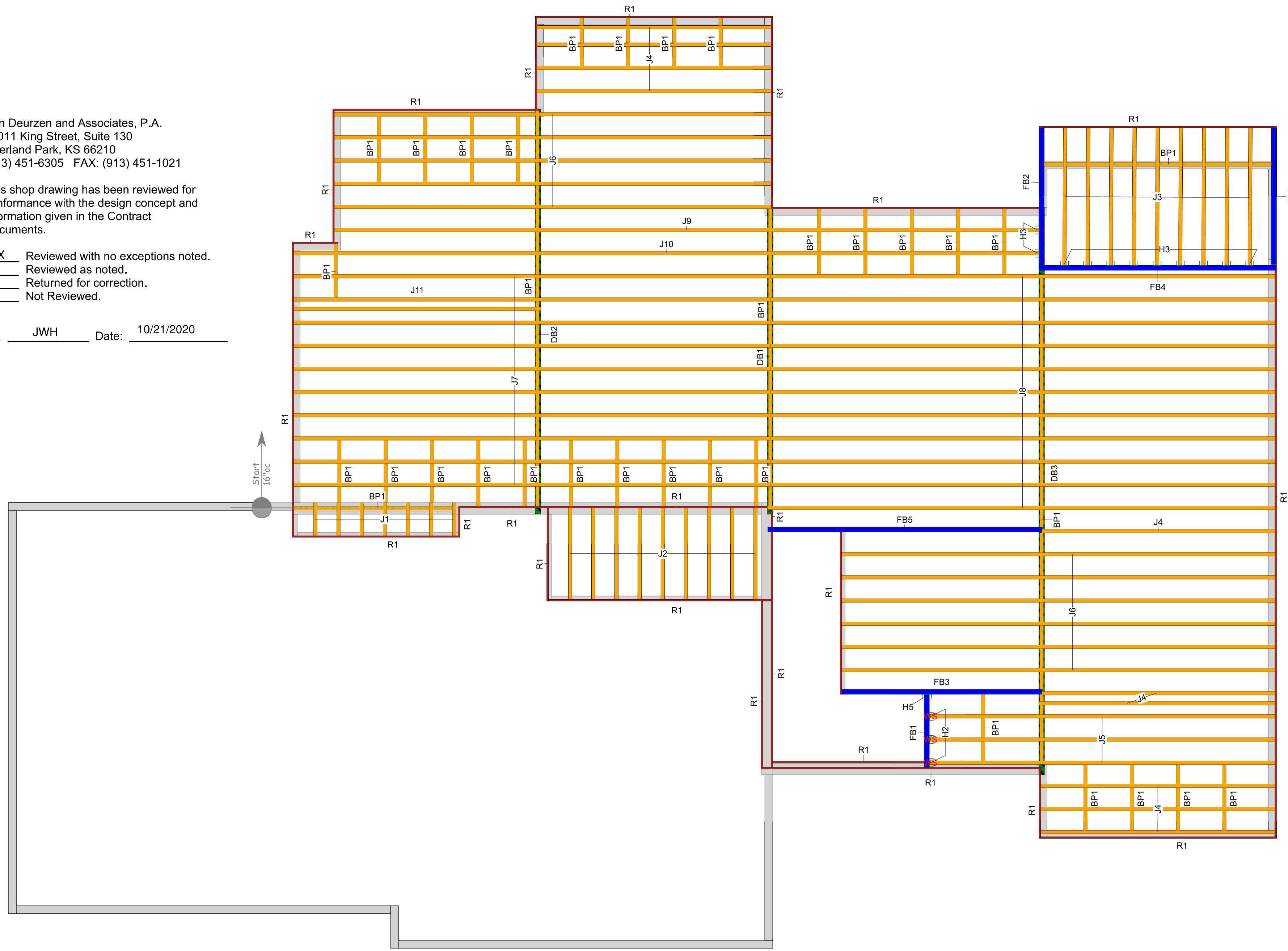

Legend	
WS	Web Stiffener
Wall	onCENTER Rim Board SE 1.125 X 9.5
BLI 40	BLI 40 9.5
onCENTER 2.0E LVL	onCENTER 2.0E LVL 1.75 X 9.5
4 X 4	4 X 4 (Dropped)

- GENERAL NOTES:**
- See Attached Installation Guide
 - Care should be taken when setting I-joists to avoid plumbing drops and mechanical chases. (DO NOT CUT OR DRILL THROUGH I-JOISTS FLANGES)
 - All walls, headers and beams are to be adequately designed and supplied by others to support all loads applied to them
 - (Dealer) recommends gluing and nailing floor sheathing to I-joists
 - I-joist spacing is not to exceed spacing shown on placement plan.
 - All headers are assumed dropped below I-joist framing unless noted otherwise.
 - Solid blocking down to foundation is to be provided by others at all headers, beams and girder bearing points.
 - Provisions must be made by others to avoid excessive moisture content in lumber. Engineered wood products shall not be placed in any environment that will cause the moisture content of the wood to exceed 19%.
 - Construction loads such as stacking of drywall, plywood, shingles, masonry materials, mechanical equipment, etc. in any one concentrated area on I-joists is strictly prohibited. I-joists are not designed for these types of conditions.

- Additional Notes**
- THIS PLACEMENT PLAN IS TO BE REVIEWED AND APPROVED BY THE ARCHITECT/ENGINEER OF RECORD PRIOR TO INSTALLATION OF EWP PRODUCTS
 - BLUELIX CAN'T BE LIABLE FOR CHANGES MADE TO THIS PLAN WITHOUT WRITTEN APPROVAL

Layout Scale 1/4" = 1'

Label	Description	Width	Depth	Qty	Plies	Pcs	Length
J10	BLI 40	2.5	9.5			1	44-0-0
J9	BLI 40	2.5	9.5			1	42-0-0
J8	BLI 40	2.5	9.5			11	30-0-0
J7	BLI 40	2.5	9.5			10	28-0-0
J6	BLI 40	2.5	9.5			11	26-0-0
J5	BLI 40	2.5	9.5			3	20-0-0
J11	BLI 40	2.5	9.5			1	16-0-0
J4	BLI 40	2.5	9.5			10	14-0-0
J3	BLI 40	2.5	9.5			9	8-0-0
J2	BLI 40	2.5	9.5			9	6-0-0
J1	BLI 40	2.5	9.5			7	2-0-0
Label	Description	Width	Depth	Qty	Plies	Pcs	Length
BP1	BLI 40	2.5	9.5	LinFt		Varies	169-0-0
Label	Description	Width	Depth	Qty	Plies	Pcs	Length
FB5	onCENTER 2.0E LVL	1.75	9.5	1	2	2	16-0-0
FB4	onCENTER 2.0E LVL	1.75	9.5	1	2	2	14-0-0
FB3	onCENTER 2.0E LVL	1.75	9.5	1	2	2	12-0-0
FB2	onCENTER 2.0E LVL	1.75	9.5	2	2	4	8-0-0
FB1	onCENTER 2.0E LVL	1.75	9.5	1	2	2	6-0-0
Label	Description	Width	Depth	Qty	Plies	Pcs	Length
R1	onCENTER Rim Board SE 1.125 X 9.5	1.125	9.5			22	12-0-0
Label	Pcs	Description	Skew	Slope			
H2	3	IUS2.56/9.5 (Max)					
H3	11	IUS2.56/9.5 (Min)					
H5	1	HHUS410					
Label	Description	Width	Depth	Qty	Plies	Pcs	Length
DB3	[Beam per Blueprint]	4	4			1	34-0-0
DB2	[Beam per Blueprint]	4	4			1	24-0-0
DB1	[Beam per Blueprint]	4	4			1	18-0-0

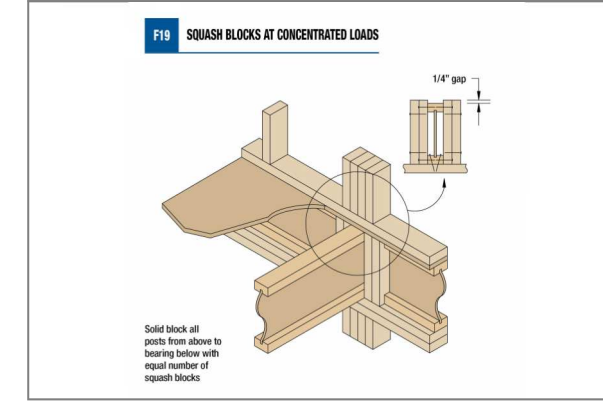
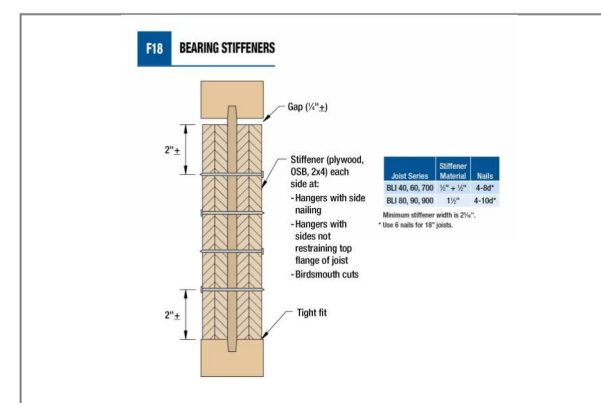
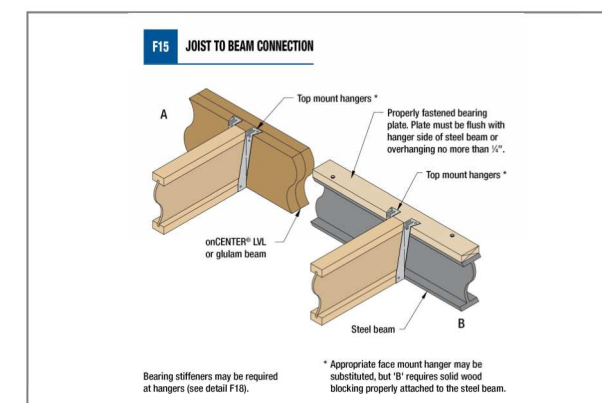
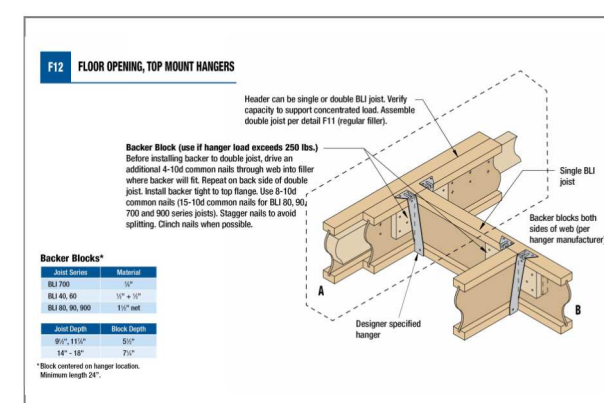
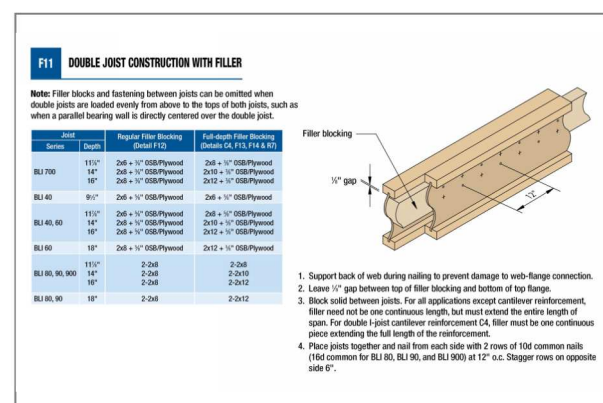
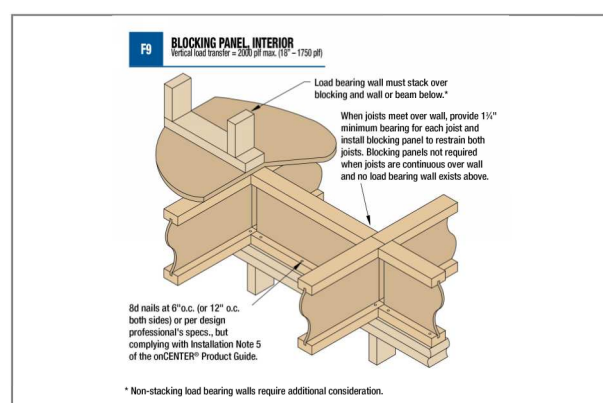
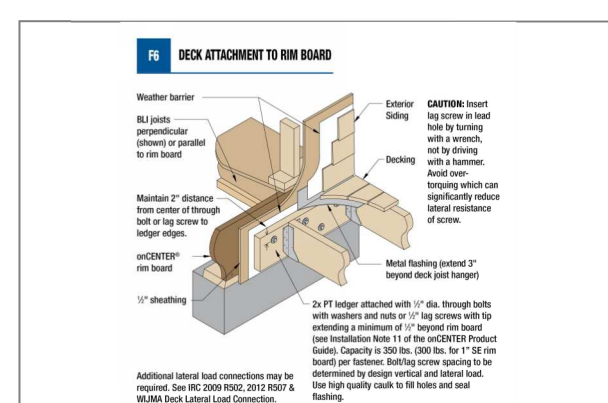
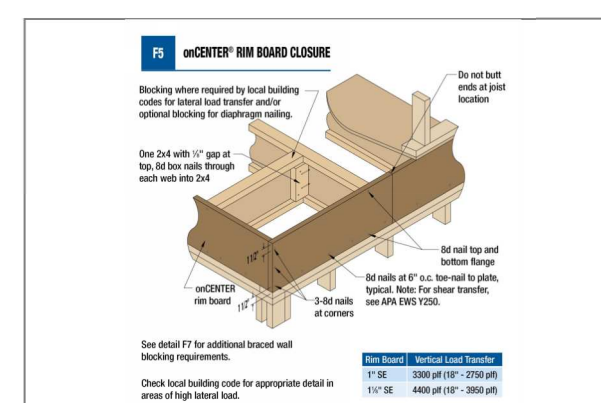
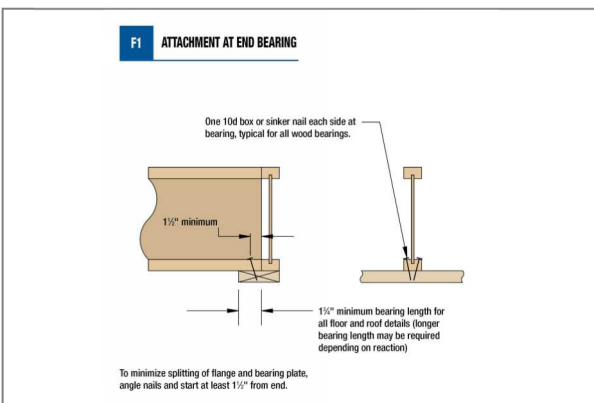
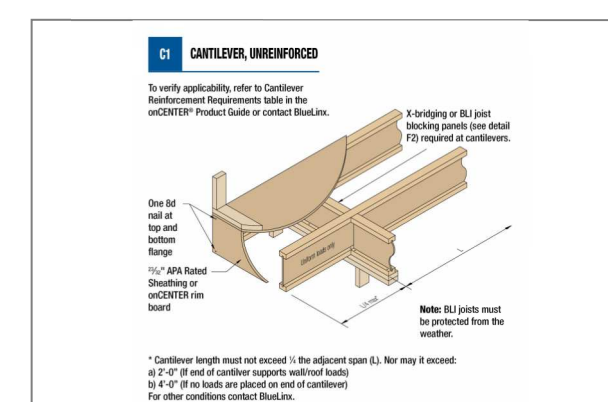
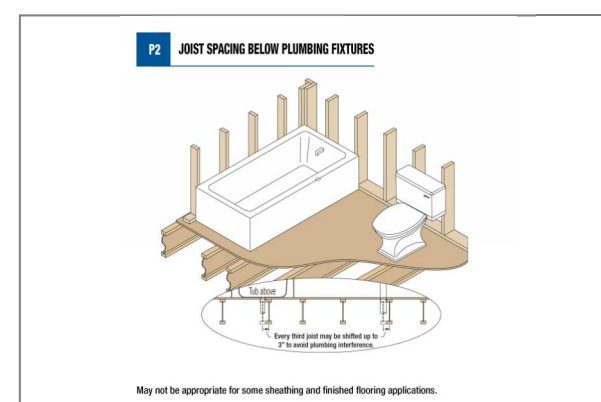
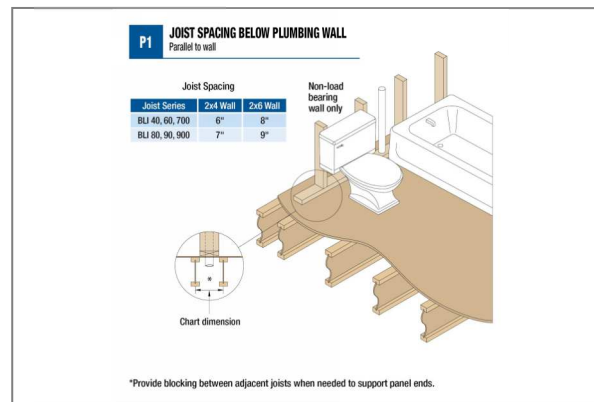

BlueLinx Corporation
1727 Warren St.
North Kansas City, MO. 64116
Phone: (816) 842-3367
VISIT US ON THE WEB AT: <https://bluelinxco.com>

Builder: 84 LUMBER
Layout Name: 20-09411 Rev 1 Woodland Custom
Project: Shipping 1905 NE Park Ridge DR LSMO / Lot 288 Park
Created: September 18, 2020
Revised: October 08, 2020
Designer: Scott Van Cleave

Ground Floor

Design Method ASD (USA)
Building Code IBC/IRC 2015

Floor

Live	40
Dead	10
Deflection Joist	
LL Span L/	480
TL Span L/	240
LL Cant 2L/	360
TL Cant 2L/	360
Deflection Girder	
LL Span L/	360
TL Span L/	240
LL Cant 2L/	360
TL Cant 2L/	360
Decking	
OSB	
23/32 APA Rated Stryd-Floor	
Fastener	Nailed & Glued

Version 20.80.184 Powered by iStruct™ This layout is to be used as an installation guide only. It is meant to be used in conjunction with the architectural and structural drawings, not to replace them.

These drawings are property of (Dealer). Any use of this information for estimating or construction without their written permission is prohibited.