

DESIGN SPECIFICATIONS				
IBC	2012	with	MO	amendments
ASCE	7-10	Minimum Design Loads for Buildings & Other Structures		
ACI	318-14	Building Code Requirements for Structural Concrete		
ANSI/AISC	360-10	Specification for Structural Steel Buildings		
DESIGN LOADS				
Wind	Vult =	115	mph	
Exposure	C			
Risk Cat.	II			
Grnd. Snow	Pg =	20	psf	

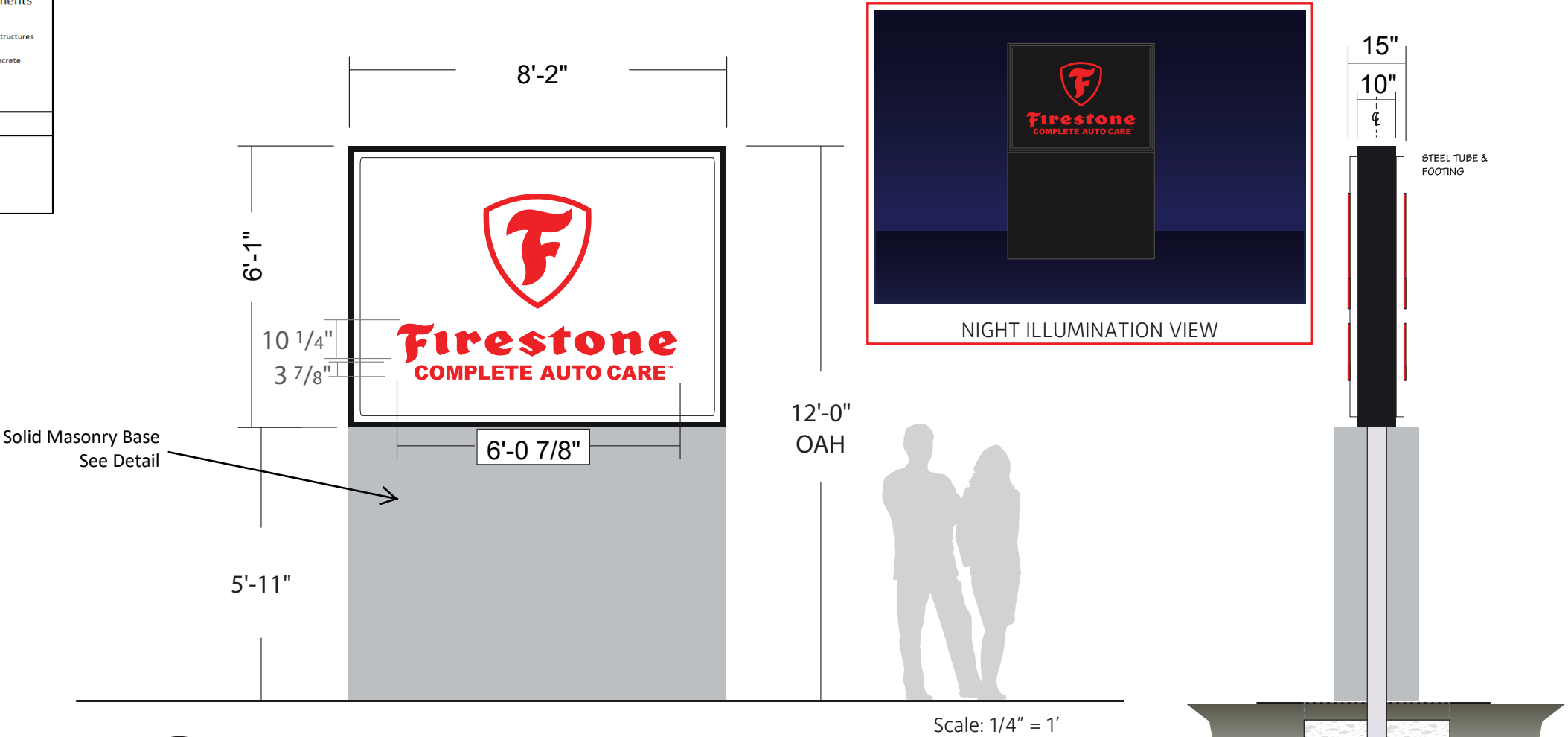

M1 AGI to Install 50sf Monument Cabinet - 12' OAH
CMU Base to Match Building (By GC)

Lighting: GE LEDs

ALUMINUM FABRICATED CABINET & RETAINERS, PTD TO MA TCH PMS# 300C,
NEW 3/16" POLYCARBONATE PAN-FORMED FACES W/ EMBOSSED FACES WITH POLYCARBONATE.

COLORS:
(A.) TOP PART OF LOGO - 3M D ARK RED # 3630-73.
(B.) BOTTOM PART OF LOGO - 3M BRISTOL BLUE # 3630-97 W/ WHITE SHO-THRU COPY READING "SINCE 1926".
(C.) "FIRESTONE" - 3M DARK RED # 3630-73.
(D.) "COMPLETE AUTO CARE" - 3M BRISTOL BLUE # 3630-97.
(E.) F ACE BKGD.- WHITE SHO-THRU.

BASE BY G.C. - BASE TO MATCH BUILDING.

(1) CONCRETE PAD W/ #3 REBAR ON 12" CENTERS. - BY G.C.

CONCRETE PIER REQ'D. - SIZE & DEPTH VARIES PER LOCAL CODE

WALL STEEL SUPPORT REQ'D. - SIZE & LENGTH VARIES PER LOCAL CODE

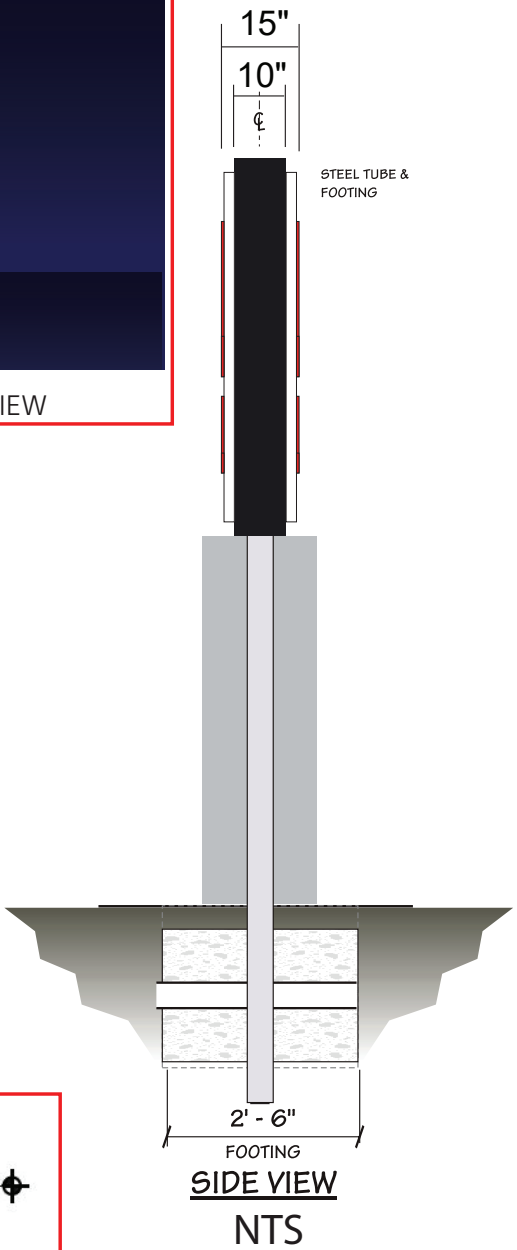
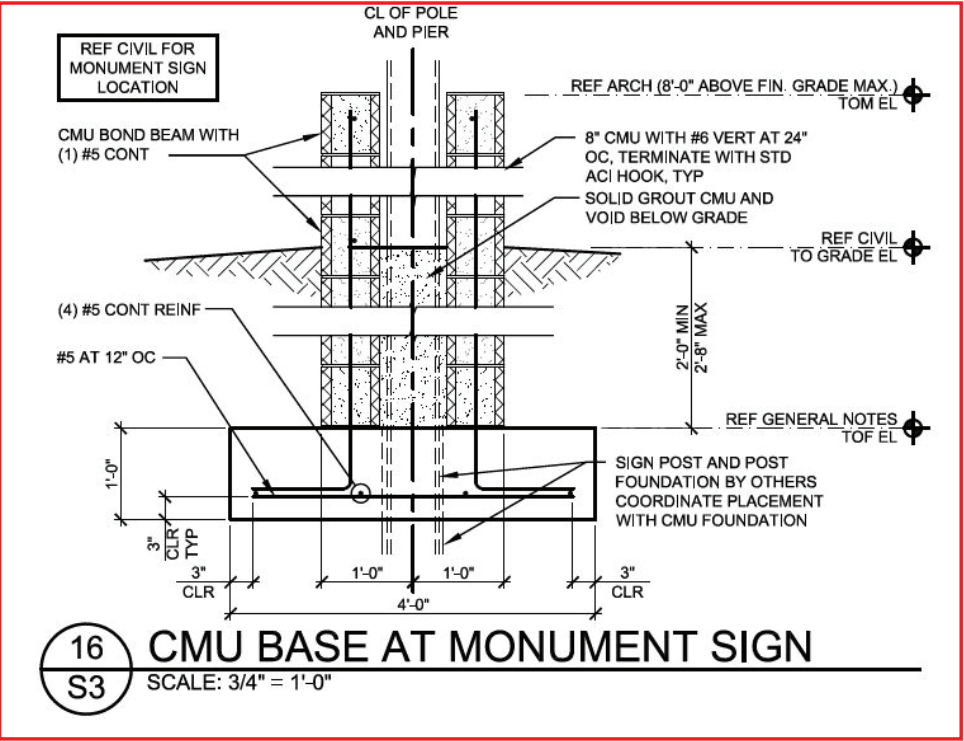

ELECTRICAL ESTIMATE -

TOT AL AMT. CIRCUITS REQ'D. =1
VOLTAGE = 120v
TOT AL DRAW = 8.7 Amps
AMPS CIRCUIT BREAKER(S) = 20

MURDOCH ENGINEERING
SIGN STRUCTURE PROFESSIONAL
JERE MURDOCH
2 HUMMINGBIRD CT
HOWELL, NJ 07731
(973) 570-8215
JERE MURDOCH, PE
Professional Engineer
MO PE Lic. #2014038163
8/22/2020

Firestone
BRIDGESTONE

Design #

Sign Family

Location

1474860

Address

35 SW Market St
Lees Summit MO 64082

Acct. Rep.
Coordinator

Designer

Date

Approval / Date

Client	
Sales	
Estimating	
Art	
Engineering	
Landlord	

Artist/Date: 9/03/19 hw

Revision / Date

Rev.2: 01/07/20 hw
Rev.3: 02/04/20 hw
Rev.4: 05/08/20 hw
Rev.5: 08/19/20 hw
Rev.6: 08/20/20 hw

IMPORTANT APPROVAL NOTIFICATION
ONCE APPROVAL HAS BEEN RECEIVED, YOU WILL BE HELD FINANCIALLY RESPONSIBLE FOR ANY ADDITIONAL CHANGES OR ADJUSTMENTS TO THE RECOMMENDED SIGNAGE.

Authorized Signature: _____
Print Name: _____
Date: _____

☐ Approved As Shown
☐ Approved with Changes Noted

AGI

Drawings are the exclusive property of AGI. Any unauthorized use or duplication is not permitted.

FINAL ELECTRICAL CONNECTION BY CUSTOMER

THIS SIGN IS INTENDED TO BE MANUFACTURED IN ACCORDANCE WITH ARTICLE 600 OF THE NATIONAL ELECTRICAL CODE AND/OR OTHER APPLICABLE LOCAL CODES. THIS INCLUDES PROPER GROUNDING & BONDING OF THE SIGN. SIGN WILL BEAR UL LABEL(S).



AGI EoR C. MILLER
Lead Drafter NJA
Drawn By DLR/LOC/NJA
Project Mgr. F. SMITH

Location _____
Windspeed _____

Drawing Revisions		
	Drawn By	Date Change
	A BMA	04.19.09 EMBOSS FACE
	B LOC	09.10.09 NOTE; HINGE& SWITCH
	A NJA	04.16.19 UPDATE TITLE BLOCK & CHANGE FROM LAMPS TO LED'S
	A NJA	05.28.19 ADDED STEEL UPRIGHT DIMENSION & FIXED CAP PLATE NOTE ON PG 2
	B	
	B	
	A	
	A	
	A	
	B	
	A	
	A	
	A	

Code	09048	Type	C
-------------	--------------	-------------	----------

Sign Type	PG #:
BF-P-50HWL	3



DESIGN SPECIFICATIONS			
IBC	2012	with	MO amendments
ASCE	7-10	Minimum Design Loads for Buildings & Other Structures	
ACI	318-14	Building Code Requirements for Structural Concrete	
ANSI/AISC	360-10	Specification for Structural Steel Buildings	
DESIGN LOADS			
Wind	Vult = 115 mph		
Exposure	C		
Risk Cat.	II		
Grnd. Snow	Pg =	20	psf



MURDOCH
ENGINEERING
SIGN STRUCTURE PROFESSIONALS
JERE MURDOCH
2 HUMMINGBIRD C
HOBOKEN, NJ 07731
(973) 570-8215
MBEF
PE-2014038163
9/22/2020
Jere Murdoch, PE
Professional Engineer
MO PE Lic. #2014038163

**2655 International Pkwy.
Virginia Beach, VA 23452**

- GENERAL:**
- ALL MATERIALS AND WORK SHALL CONFORM TO THE REQUIREMENTS OF THE APPLICABLE INTERNATIONAL BUILDING CODE (IBC).
 - CONSTRUCTION METHODS AND PROJECT SAFETY: DRAWINGS AND SPECIFICATIONS REPRESENT THE FINISHED STRUCTURE AND DO NOT INDICATE METHODS, PROCEDURES, OR SEQUENCE OF CONSTRUCTION. TAKE NECESSARY PRECAUTIONS TO MAINTAIN AND ENSURE THE INTEGRITY OF THE STRUCTURE DURING CONSTRUCTION. THE EOR WILL NOT ENFORCE SAFETY MEASURES OR REGULATIONS. THE CONTRACTOR SHALL DESIGN, CONSTRUCT, AND MAINTAIN ALL SAFETY DEVICES AND SHALL BE SOLELY RESPONSIBLE FOR CONFORMING TO ALL LOCAL, STATE, AND FEDERAL SAFETY AND HEALTH STANDARDS, LAWS, AND REGULATIONS.
 - THE CONTRACTOR SHALL VERIFY ALL DIMENSIONS, ELEVATIONS AND SITE CONDITIONS PRIOR TO THE START OF CONSTRUCTION AND NOTIFY THE ENGINEER IMMEDIATELY OF ANY DISCREPANCIES OR INCONSISTENCIES THAT ARE FOUND. NOTED DIMENSIONS TAKE PRECEDENCE OVER SCALED DIMENSIONS. DO NOT SCALE DRAWINGS.
 - ALL OMISSIONS AND/OR CONFLICTS BETWEEN THE VARIOUS ELEMENTS OF THE WORKING DRAWINGS AND SPECIFICATIONS SHALL BE BROUGHT TO THE ATTENTION OF THE ENGINEER AND FIELD INSPECTOR. THE ENGINEER SHALL PROVIDE A SOLUTION PRIOR TO PROCEEDING WITH ANY WORK AFFECTED BY THE CONFLICT OR OMISSION.
 - WHERE NO CONSTRUCTION DETAILS ARE SHOWN OR NOTED FOR ANY PART OF THE WORK, CONSTRUCT IN ACCORDANCE WITH THE STEEL CONSTRUCTION MANUAL, 14TH EDITION OR 2010 ALUMINUM DESIGN MANUAL.
 - WHEN A DETAIL IS IDENTIFIED AS TYPICAL, THE CONTRACTOR IS TO APPLY THIS DETAIL IN ESTIMATING AND CONSTRUCTION TO EVERY LIKE CONDITION WHETHER OR NOT THE REFERENCE IS REPEATED IN EVERY INSTANCE.
 - ANY CHANGE TO THE DESIGN AS SHOWN ON THE DRAWINGS REQUIRES PRIOR WRITTEN APPROVAL FROM DESIGN ENGINEER OF RECORD BEFORE CONSTRUCTION.
 - WORK PERFORMED IN CONFLICT WITH THE STRUCTURAL DRAWINGS OR APPLICABLE BUILDING CODE REQUIREMENTS SHALL BE CORRECTED AT THE EXPENSE OF THE CONTRACTOR.
 - VERIFICATION: VERIFY ALL DIMENSIONS, ELEVATIONS, AND SITE CONDITIONS BEFORE STARTING WORK. NOTIFY THE EOR IMMEDIATELY OF ANY DISCREPANCIES.
 - DOCUMENT INSTALLATION OF FOOTINGS / ANCHOR BOLTS / EPOXY ANCHORS WITH PHOTOGRAPHS AND MEASUREMENTS
- STEEL**
- STEEL SHAPES SHALL CONFORM TO THE FOLLOWING:

ROUND HSS	ASTM A500, GR B	Fy=42 KSI MIN.
SQUARE/RECT HSS	ASTM A500, GR B	Fy=46 KSI MIN.
THREADED ROD	F1554 GR 55	Fy=55 KSI MIN.
STEEL PLATE	ASTM A36	Fy=36 KSI MIN.
STD. PIPE	ASTM A53, GR B	Fy=35 KSI MIN.

- BOLTS SHALL CONFORM TO ASTM A307 GRADE B
- BOLTS AND THREADED ROD SHALL BE HOT-DIP GALVANIZED PER ASTM F2329 UNO.
- ANCHOR BOLTS SHALL CONFORM TO ASTM F1554 UNO.
- NUTS SHALL CONFORM TO ASTM A563.
- WASHERS SHALL CONFORM TO ASTM F844.
- STEEL HARDWARE SHALL BE HOT-DIP GALVANIZED PER ASTM A153 UNO
- WELDING:
 - WELD STRUCTURAL STEEL IN COMPLIANCE WITH ANSI/AWS D1.1 AND AISC SPECIFICATION, CHAPTER J. WELDERS SHALL BE CERTIFIED AS REQUIRED BY GOVERNING CODE AUTHORITY. WELDING SHALL BE DONE BY ELECTRIC ARC PROCESS USING LOW-HYDROGEN ELECTRODES WITH SPECIFIED TENSILE STRENGTH NOT LESS THAN 70 KSI UNLESS NOTED OTHERWISE.
 - ALL SHOP AND FIELD WELDS SHALL BE PERFORMED BY AN AWS OR ICC CERTIFIED WELDER WITH ACTIVE STATUS AT TIME OF WELDING
 - UNLESS A LARGER WELD SIZE IS INDICATED, PROVIDE MINIMUM SIZE WELDS PER AISC SPECIFICATION, SECTION J2, TABLE J2.4
 - BASE PLATES SHALL BE WELDED ON TOP AND BOTTOM WITH CONTINUOUS WELDS OF AT LEAST 1/4" (IF PLATE IS CUT TO FIT TUBE INTO PLATE)

- ALUMINUM**
- FABRICATE AND ERECT ALUMINUM IN COMPLIANCE WITH THE ALUMINUM ASSOCIATION (AA) 2010 ALUMINUM DESIGN MANUAL (ADM) PART 1, THE SPECIFICATIONS FOR ALUMINUM SHEET METAL WORK (ASM35), AND IBC CHAPTER 20.
 - PIPE AND TUBE SHALL BE 6061-T6 PER ASTM B241 OR B429 WITH Ftu=38 KSI MIN, Fty=35 KSI MIN, Ftuw=24 KSI MIN, Ftyw=15 KSI MIN.
 - STD STRUCTURAL PROFILES SHALL BE 6061-T6 PER B308 WITH Ftu=38 KSI MIN, Fty=35 KSI MIN, Ftuw=24 KSI MIN, Ftyw=15 KSI MIN.
 - SHEET AND PLATE SHALL BE 6061-T6 PER ASTM B209 WITH Ftu=42 KSI MIN, Fty=35 KSI MIN, Ftuw=24 KSI MIN, Ftyw=15 KSI MIN.
 - EXTRUSIONS SHALL BE 6061-T6 PER ASTM B241 OR B429 WITH Ftu=38 KSI MIN, Fty=35 KSI MIN, Ftuw=24 KSI MIN, Ftyw=15 KSI MIN.
 - ALL SHOP AND FIELD WELDS SHALL BE PERFORMED BY AN AWS OR ICC CERTIFIED WELDER WITH CURRENT STATUS AT TIME OF WELDING
 - UNLESS A LARGER WELD SIZE IS INDICATED, PROVIDE MINIMUM SIZE WELD PER ADM. ALL ALUMINUM WELDED JOINTS SHALL HAVE WELD SIZES OF AT LEAST 1/8 INCH
 - FILLET WELDS SHALL NOT EXCEED THINNEST MEMBER WALL THICKNESS JOINED.
 - ALUMINUM WELD FILLER SHALL BE 5356 ALLOY
 - WELDING PROCESS GMAW OR GTAW SHALL BE IN ACCORDANCE WITH AWS D1.2
 - ALUMINUM CHANNEL LETTERS SHALL BE CONSTRUCTED OF 0.090" RETURNS AND 0.125" BACKS MINIMUM, UNLESS A LARGER SIZE IS INDICATED ON DRAWINGS. THIS NOTE SHALL SUPERCEDE DRAWING DETAILS.
 - PROVIDE NEOPRENE GASKET BETWEEN DISSIMILAR METALS TO PREVENT GALVANIC CORROSION
 - ALUMINUM DIRECTLY EMBEDDED INTO CONCRETE SHALL BE CAPPED AT BOTTOM AND COATED WITH BITUMINOUS COATING OR POLYURETHANE WHERE IN CONTACT WITH CONCRETE.
 - FASTENERS BETWEEN DISSIMILAR METALS SHALL BE STAINLESS STEEL 316.

- CONCRETE & REINFORCEMENT**
- MINIMUM 28-DAY COMPRESSIVE STRENGTH (fc') SHALL BE 3,000 PSI. THE MAXIMUM WATER TO CEMENT RATIO SHALL BE 0.45 BY WEIGHT. A MINIMUM OF 5-3/4 BAGS OF CEMENT SHALL BE USED PER CUBIC YARD WITH A SLUMP OF 4" +/- 1.
 - REINFORCEMENT TO BE ASTM A615 GR 60, Fy=60 KSI UNO
 - CALCIUM CHLORIDE OR ADDED CHLORIDE IS NOT PERMITTED
 - VIBRATION: ALL REINFORCED CONCRETE SHALL BE CONSOLIDATED WITH MECHANICAL VIBRATORS.
 - CONCRETE CONSTRUCTION SHALL BE IN ACCORDANCE WITH ACI 318-14
 - PROVIDE A MINIMUM OF 2-1/2" COVER OF ALL EMBEDDED STEEL REBAR AND A MINIMUM OF 6 INCHES OF COVER FOR DIRECT BURIED PIPE OR TUBE MEMBERS.

- FOUNDATIONS**
- CONCRETE POURED INTO CONSTRAINED EARTH EXCAVATIONS MUST CURE UNDER PROPER CONDITIONS FOR A MINIMUM OF 7 DAYS PRIOR TO SIGN BOX INSTALLATION. (EXCEPTION: IF THE OVERALL HEIGHT OF THE SIGN IS LESS THAN 20 FEET AND THE SIGN IS ADEQUATELY BRACED AGAINST WIND LOADS FOR A MINIMUM OF 4 DAYS, THE BOX MAY BE INSTALLED THE SAME DAY AS THE FOOTING IS POURED)
 - FOOTINGS MUST BE POURED AGAINST UNDISTURBED EARTH. SOIL BACKFILL IS UNACCEPTABLE. WHEN A SONOTUBE IS USED AS THE FORM, 3/4" BLUESTONE OR CONCRETE SHALL BE USED TO BACKFILL THE SPACE BETWEEN THE SONOTUBE AND UNDISTURBED EARTH.
 - COLD WEATHER PLACEMENT: PROTECT CONCRETE WORK FROM PHYSICAL DAMAGE OR REDUCED STRENGTH THAT COULD BE CAUSED BY FROST, FREEZING ACTIONS OR LOW TEMPERATURES. DO NOT POUR CONCRETE DURING OR WHEN FREEZING TEMPERATURES ARE ANTICIPATED WITHIN 3 DAYS OF POUR.

- REINFORCEMENT IS NOT REQUIRED FOR DIRECT BURIAL TYPE SIGN FOOTINGS FOR SIGNS OF 25 FEET OVERALL HEIGHT OR LESS, DIRECT BURIED STEEL SHALL EXTEND TO 6 INCHES FROM BOTTOM OF FOOTING.
- FOR ANCHOR BOLT/ BASE PLATE - SQUARE FOOTINGS, PROVIDE A MINIMUM OF #5 VERTICAL REBAR @ 12" O.C., 4" OFFSET FROM PERIMETER, TOP AND BOTTOM OF FOOTING. PROVIDE #3 HORIZONTAL TIES @ 12" O.C.
- FOR ANCHOR BOLT/ BASE PLATE - ROUND FOOTINGS, PROVIDE A MINIMUM OF SIX (6) VERTICAL #5 REBARS, EVENLY SPACED, 4" OFFSET FROM FOOTING PERIMETER & #3 HORIZONTAL TIES, 12" O.C. UNLESS OTHERWISE NOTED.
- ANCHOR BOLTS SHALL BE TIED TO REBAR CAGE AT A MINIMUM OF TWO LOCATIONS PER ANCHOR BOLT
- FOOTING DESIGN ASSUMES FOOTING SHALL BE EXCAVATED AND POURED IN UNDISTURBED NATURAL EARTH, CAPABLE OF WITHSTANDING A MINIMUM 1,500 PSF VERTICAL DESIGN BEARING PRESSURE AND 150 LBS/SF/FT OF DEPTH OF LATERAL BEARING PRESSURE BASED ON SOIL DATA OBTAINED FROM THE USGS SOIL SURVEY.
- IF CLAY, SILTY - CLAY, ORGANIC OR FILL SOIL IS ENCOUNTERED UPON EXCAVATION, CONTACT MURDOCH ENGINEERING FOR FOOTING DESIGN MODIFICATION PRIOR TO CONSTRUCTION.

- EXISTING CONDITIONS:**
- IF EXISTING CONDITIONS ARE NOT AS DETAILED IN THIS DESIGN, THE INSTALLER SHALL CEASE WORK AND NOTIFY MURDOCH ENGINEERING IMMEDIATELY.
 - MURDOCH ENGINEERING WILL NOT BE PERFORMING ON-SITE INSPECTIONS OR VERIFICATIONS. IT IS THE RESPONSIBILITY OF THE INSTALLER, STRUCTURE OWNER, AND PROPERTY OWNER TO IDENTIFY EXISTING CONDITIONS AND CONTACT MURDOCH ENGINEERING WITH ANY DISCREPANCIES OR CONCERNS.
 - INSTALLER SHALL CONFIRM THE DIAMETER AND THICKNESS OF EXISTING MEMBERS AND NOTIFY MURDOCH ENGINEERING OF ANY DISCREPANCIES.
 - INSTALLER SHALL INSPECT AND CONFIRM THE QUALITY OF EXISTING STRUCTURE AS "IN GOOD REPAIR". IF THERE ARE ANY INDICATIONS THAT THIS IS NOT THE CASE, INSTALLER SHALL CEASE WORK IMMEDIATELY AND NOTIFY MURDOCH ENGINEERING.
 - ANY EXISTING INFORMATION SHOWN HAS BEEN FURNISHED BY THE PERSON(S) OR COMPANY THIS DOCUMENT WAS PREPARED FOR (SEE TITLE BLOCK). MURDOCH ENGINEERING IN NO WAY CERTIFIES THIS INFORMATION AS "AS-BUILT". IF THERE IS ANY REASON TO BELIEVE THE EXISTING CONDITIONS DETAILED HEREIN ARE NOT ACCURATE, MURDOCH ENGINEERING SHALL BE NOTIFIED IMMEDIATELY.

SCOPE OF WORK





- LIMITS OF LIABILITY TO EXTEND ONLY TO THE QUANTITY INDICATED. ATTEMPTS IN PART OR IN WHOLE TO INSTALL GREATER QUANTITIES THAN THOSE SPECIFIED WITHOUT CONSULTING MURDOCH ENGINEERING SHALL VOID ALL PROFESSIONAL LIABILITY AND COVERAGE.

SHEET INDEX

S.1 NOTES & ELEVATION

ADDITIONAL NOTES

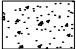
SYMBOLS

STEEL (OR ALUM.)		EARTH	
CONCRETE		SAND (UNO.)	

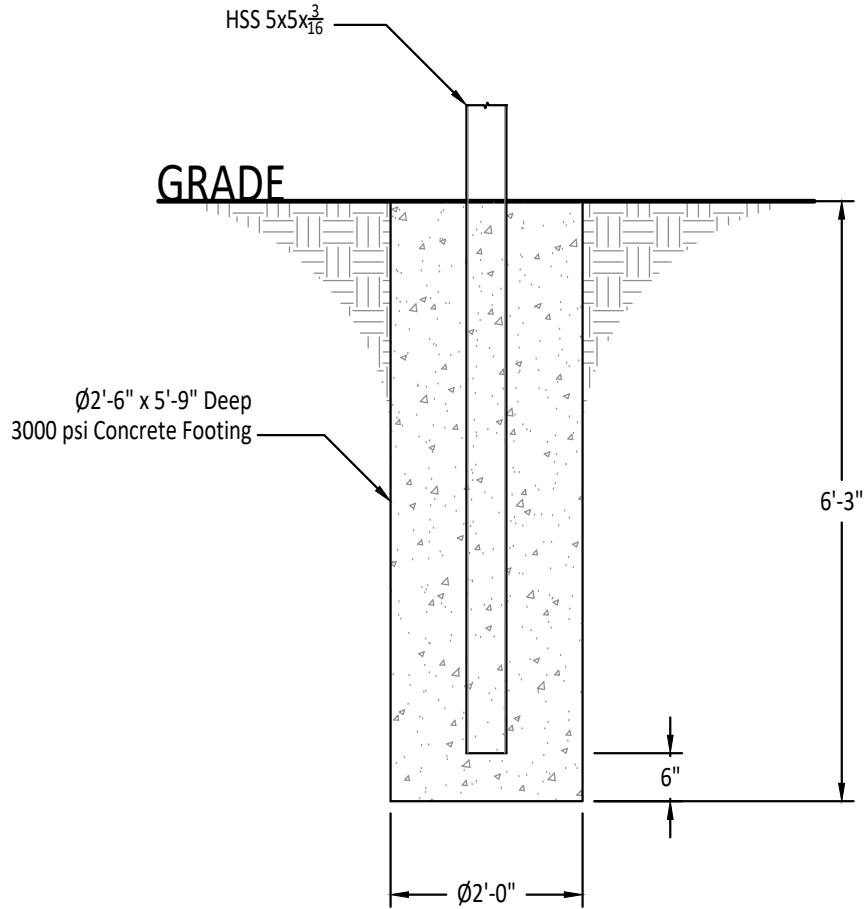

Footing Elevation

Scale: 1/2" = 1'-0"

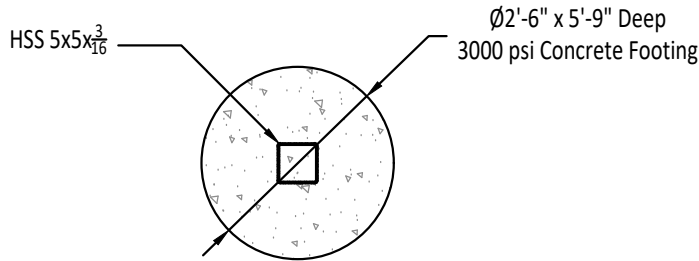

Footing Plan View

Scale: 1/2" = 1'-0"

MURDOCH ENGINEERING
SIGN STRUCTURE PROFESSIONALS

murdochengineering.com
(973) 570-8215
73 Paterson St. 2nd Floor
New Brunswick, NJ 08901

PREPARED FOR:

AGI

Firestone Monument

PROJECT ADDRESS:
35 SW Market St
Lees Summit MO 64082

PROJECT TITLE:

DESIGN SPECIFICATIONS			
IBC	2012	with	MO amendments
ASCE	7-10	Minimum Design Loads for Buildings & Other Structures	
ACI	318-14	Building Code Requirements for Structural Concrete	
ANSI/AISC	360-10	Specification for Structural Steel Buildings	
DESIGN LOADS			
Wind	Vult =	115	mph
Exposure	C		
Risk Cat.	II		
Grnd. Snow	Pg =	20	psf

MURDOCH ENGINEERING
SIGN STRUCTURE PROFESSIONALS
2 HAMMINGBIRD CT.
HOWELL, NJ 07731
(973) 570-8215
Jere Murdoch, PE
Professional Engineer
MO PE Lic. #2014038163

DWG TITLE:

NOTES & ELEVATION

SHEET:

S.1

SIZE:

B

The designs, details and specifications contained in this drawing are confidential. The recipients of this drawing hereby acknowledge and agree that it is the sole property of Murdoch Engineering and that they shall neither use nor reveal any of the designs, details and specifications contained in this drawing, outside of the contractual agreement expressed written permission from Murdoch Engineering.

Deviations from this drawing shall not be made without consulting Murdoch Engineering. In case of incongruities between drawings, specifications, and details included in contract documents, Murdoch Engineering shall decide which indication must be followed and their decision shall be final.

Copyright Murdoch Engineering.
All rights reserved.