

# ECHELON MAINT. AREA

3500 SW HLLYWOOD DRIVE  
LEE'S SUMMIT, MO 64082

## PERMIT SET

31 AUGUST 2020

COLLINS WEBB #: 20050



### OWNER

RESIDENCES AT ECHELON APARTMENTS  
3500 SW HOLLYWOOD DRIVE  
LEE'S SUMMIT, MO 64082  
P: 816.319.0601

### ARCHITECT

COLLINS | WEBB ARCHITECTURE  
13A SW 3RD STREET  
LEE'S SUMMIT, MISSOURI 64063  
P: 816.249.2270  
www.collinsandwebb.com

### MEP ENGINEER

PKMR ENGINEERS  
13000 W. 98TH STREET  
LENEXA, KANSAS 66215  
P: 913.492.2400  
www.pkmreng.com

9/1/2020 7:35:33 AM

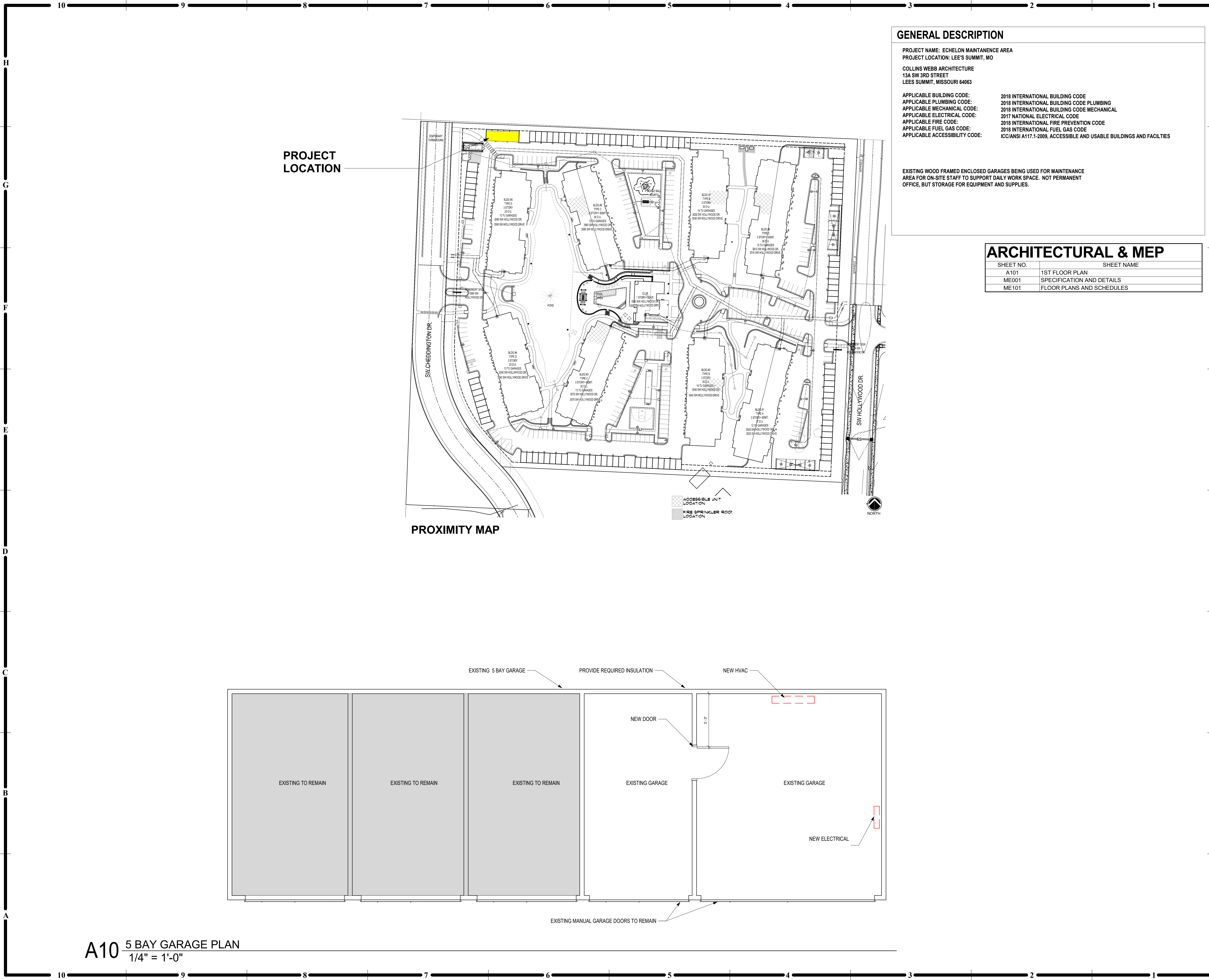

### GENERAL DESCRIPTION

PROJECT NAME: ECHELON MAINTENANCE AREA  
PROJECT LOCATION: LEE'S SUMMIT, MO  
COLLINS WEBB ARCHITECTURE  
13A SW 3RD STREET  
LEES SUMMIT, MISSOURI 64063

APPLICABLE BUILDING CODE: 2018 INTERNATIONAL BUILDING CODE  
APPLICABLE PLUMBING CODE: 2018 INTERNATIONAL BUILDING CODE PLUMBING  
APPLICABLE MECHANICAL CODE: 2018 INTERNATIONAL BUILDING CODE MECHANICAL  
APPLICABLE ELECTRICAL CODE: 2017 NATIONAL ELECTRICAL CODE  
APPLICABLE FIRE CODE: 2018 INTERNATIONAL FIRE PREVENTION CODE  
APPLICABLE FUEL GAS CODE: 2018 INTERNATIONAL FUEL GAS CODE  
APPLICABLE ACCESSIBILITY CODE: ICC/ANSI A117.1-2009, ACCESSIBLE AND USABLE BUILDINGS AND FACILITIES

EXISTING WOOD FRAMED ENCLOSED GARAGES BEING USED FOR MAINTENANCE  
AREA FOR ON-SITE STAFF TO SUPPORT DAILY WORK SPACE. NOT PERMANENT  
OFFICE, BUT STORAGE FOR EQUIPMENT AND SUPPLIES.

### ARCHITECTURAL & MEP

SHEET NO.	SHEET NAME
A101	1ST FLOOR PLAN
ME001	SPECIFICATION AND DETAILS
ME101	FLOOR PLANS AND SCHEDULES

### GENERAL NOTES: FLOOR PLANS

- SEE GENERAL ARCHITECTURAL SHEETS FOR ADDITIONAL NOTES AND DETAILS THAT ARE APPLICABLE.
- ARCHITECTURAL ELEVATION 100'-0"
- DIMENSIONS SHOWN ON THE FLOOR PLAN ARE TO THE FACE OF GYP. BOARD/ WALL (FG); FACE OF MASONRY (FM), FACE OF CONCRETE WALLS (FC), AND COLUMN GRID LINES, UNLESS NOTED OR SHOWN OTHERWISE.
- NOTE: WALL THICKNESSES ARE ACTUAL DIMENSIONS AND PER WALL TYPES. SEE GENERAL SHEETS.
- DOOR OPENINGS NOT LOCATED BY DIMENSION SHALL BE CENTERED IN WALL SHOWN OR LOCATED 4 INCHES FROM FINISH WALL TO HINGE SIDE OF THE DOOR, ALWAYS ALLOWING A MINIMUM OF 18" FROM THE PULL SIDE (STRIKE SIDE) OF THE DOOR TO THE INTERSECTING WALL, OR OTHER PROTRUDING OBJECTS.

## ECHELON MAINT. AREA

3500 SW HLLYWOOD DRIVE  
LEE'S SUMMIT, MO 64082

COPYRIGHT © BY  
COLLINS WEBB  
ARCHITECTURE, LLC

REVISION DATES:



PROFESSIONAL SEAL

# A101

ISSUE DATE: 31 AUGUST 2020

COLLINS WEBB #: 20050

## 1ST FLOOR PLAN



PERMIT SET

RELEASE FOR CONSTRUCTION  
AS NOTED ON PLANS REVIEW  
BY MISSOURI DEPARTMENT OF REVENUE  
LEE'S SUMMIT, MISSOURI  
09/02/2020  
13A SW 3rd St., Lee's Summit, Missouri 64063 | 816.249.2270 | www.collinsandwebb.com



## COORDINATION NOTES

- COORDINATE REQUIREMENTS FOR INSTALLATION OF SYSTEMS AND EQUIPMENT WITH ALL OTHER TRADES.
- THE CONTRACTOR SHALL COORDINATE THE ROUTING AND PATH OF ALL SYSTEMS, CONDUITS, PIPES, DUCTS, ETC WITH THE POSITION AND LAYOUT OF THE STRUCTURE. THE CONTRACTOR IS RESPONSIBLE FOR PROVIDING NECESSARY OFFSETS, TURNS, RISERS AND DROPS FOR SYSTEMS AND COMPONENTS AS NEEDED TO INSTALL THE MEP SYSTEMS TO CLEAR STRUCTURE, CEILING, ETC AND OTHER SYSTEMS IN POTENTIAL CONFLICT WITH ROUTING.
- COORDINATE WORK WITH OTHER TRADES TO INSTALL SYSTEMS ABOVE CEILING HEIGHTS INDICATED ON ARCHITECTURAL PLANS.
- CHECK SPACE REQUIREMENTS WITH OTHER TRADES AND STRUCTURE/CONSTRUCTION TO ENSURE THAT ALL MATERIALS AND EQUIPMENT CAN BE INSTALLED IN THE SPACE ALLOTTED INCLUDING FINISHED SUSPENDED CEILING AND OTHER SPACES, CHASES, ETC WITHIN THE BUILDING. MAKE MODIFICATIONS THERETO AS REQUIRED AND APPROVED.
- TRANSMIT TO OTHER TRADES ALL INFORMATION REQUIRED FOR WORK TO BE PROVIDED UNDER THEIR RESPECTIVE SECTIONS IN AMPLIFIED TIME FOR INSTALLATION.
- ALL EQUIPMENT AND ACCESSORIES INSTALLED IN CONCEALED SPACES REQUIRING ACCESS SHALL BE PROVIDED WITH ACCESS DOORS MEETING ANY FIRE REQUIREMENTS OF THE WALL/CEILING THEY ARE INSTALLED.
- WHenever work interconnects with work of other trades, coordinate with those trades to ensure that all subcontractors have the information necessary so that they may properly install all connections and equipment. identify all items of work that require access so that the ceiling trade will know where to install access doors and panels.
- COORDINATE PROJECT AND SCHEDULE WORK WITH OTHER TRADES IN ACCORDANCE WITH THE CONSTRUCTION SEQUENCE.
- DRAWINGS SHOW THE GENERAL RUNS OF CONDUITS, PIPING AND DUCTWORK AND APPROXIMATE LOCATION OF OUTLETS. ANY SIGNIFICANT CHANGES IN LOCATION OF ITEMS NECESSARY IN ORDER TO MEET FIELD CONDITIONS SHALL BE BROUGHT TO THE IMMEDIATE ATTENTION OF THE ARCHITECT/ENGINEER AND RECEIVE HIS APPROVAL BEFORE SUCH ALTERATIONS ARE MADE. ALL SUCH MODIFICATIONS SHALL BE MADE WITHOUT ADDITIONAL COST TO THE OWNER.
- CONTRACTOR SHALL BE RESPONSIBLE FOR PROTECTION AND REPAIR OF SURFACES, AREAS AND PROPERTY THAT MAY BE DAMAGED AS A RESULT OF CONSTRUCTION ACTIVITIES.
- ADJUST LOCATION OF PIPING, DUCTWORK, ETC. TO PREVENT INTERFERENCES BOTH ANTICIPATED AND ENCOUNTERED. DETERMINE THE EXACT ROUTE AND LOCATION OF EACH ITEM PRIOR TO FABRICATION. MAKE OFFSETS, TRANSITIONS AND CHANGES IN DIRECTION IN SYSTEMS AS REQUIRED TO MAINTAIN ADEQUATE CLEARANCES AND HEADROOM.
- CONTRACTOR SHALL CONCEAL ALL CONDUIT, FITTINGS, AND DEVICES FROM VIEW WHERE REASONABLY POSSIBLE.

## GENERAL ELECTRICAL NOTES

- COMPLETE INSTALLATION SHALL BE IN ACCORDANCE WITH THE LATEST ADOPTED VERSION OF THE NATIONAL ELECTRICAL CODE, LOCAL AND STATE CODES, AND REQUIREMENTS OF THE A/E.
- COORDINATE LOCATIONS OF RECEPTACLES, SWITCHES, ETC. WITH ARCHITECTURAL CASEWORK AND ELEVATIONS.
- REFER TO MOUNTING HEIGHTS DETAIL FOR MOUNTING HEIGHTS OF ALL DEVICES NOT INDICATED OTHERWISE.
- PROVIDE ALL EMPTY CONDUITS WITH PULL STRINGS AND BUSHED ENDS.
- CONTRACTOR SHALL CONCEAL ALL CONDUIT, FITTINGS, AND DEVICES FROM VIEW WHERE REASONABLY POSSIBLE.

- WHEREVER THE WORK IS OF SUFFICIENT COMPLEXITY, PREPARE ADDITIONAL COORDINATION DRAWINGS AND ORGANIZE ON-SITE MEETINGS WITH ALL RELATED SUBCONTRACTORS TO COORDINATE THE WORK BETWEEN TRADES. DRAWINGS SHALL CLEARLY SHOW THE WORK AND ITS RELATION TO THE WORK OF OTHER TRADES, AND BE SUBMITTED FOR REVIEW PRIOR TO COMMENCING SHOP FABRICATION OR ERECTION IN THE FIELD.
- COORDINATE WITH LOCAL UTILITY PROVIDERS FOR THEIR REQUIREMENTS FOR SERVICE CONNECTIONS AND PROVIDE ALL NECESSARY PAYMENTS, MATERIALS, LABOR AND TESTING TO ACCOMPLISH THE WORK.
- COORDINATE THE MOUNTING OF SUSPENDED LIGHT FIXTURES UTILIZING INDIRECT LIGHT SO THAT CONDUIT, DUCTWORK, STRUCTURAL MEMBERS, ETC. ARE NOT LOCATED DIRECTLY ABOVE THE LIGHT FIXTURE. MAINTAIN A MINIMUM OF 24" CLEARANCE FROM THESE ITEMS WHENEVER POSSIBLE.

## GENERAL NOTES

- SOME ROOM NAMES MAY NOT BE SHOWN FOR PURPOSE OF CLARING PLANS. REFER TO ARCHITECTURAL PLANS FOR REFERENCE TO ROOM NAMES NOT SHOWN.
- IT IS THE RESPONSIBILITY OF THE CONTRACTOR TO MAINTAIN AND KEEP AT THE JOB SITE, AN UP TO DATE SET OF "RECORD DRAWINGS" SHOWING ALL CHANGES FROM THE ORIGINAL PLANS. THE CONTRACTOR SHALL DELIVER THE "RECORD DRAWINGS" TO THE ENGINEER AT THE CONCLUSION OF THE PROJECT ELECTRONICALLY.
- THESE DRAWINGS ARE DIAGNOSTIC. THE CONTRACTOR SHALL VERIFY ALL ALL CONDITIONS (NEW AND EXISTING), DIMENSIONS, AND CLEARANCES PRIOR TO THE COMMENCEMENT OF WORK AND SHALL INCLUDE ALL COSTS, EQUIPMENT, MATERIAL, ACCESSORIES, ETC. REQUIRED FOR A FULLY COMPLETE, FUNCTIONAL AND CODE COMPLIANT INSTALLATION.
- FINAL LOCATIONS OF ALL DEVICES, LIGHT FIXTURES, EQUIPMENT ETC. SHALL BE INDICATED ON THE ARCHITECTURAL DRAWINGS. ALL DIMENSIONAL INFORMATION SHALL BE OBTAINED FROM ARCHITECTURAL PLANS. NO DIMENSIONAL INFORMATION SHALL BE OBTAINED FROM MEP DRAWINGS.
- THE CONTRACTOR SHALL OBTAIN ALL REQUIRED PERMITS, APPROVALS, LICENSES, ETC. AS NEEDED FOR THE COMPLETE INSTALLATION AND PROJECT. THE CONTRACTOR SHALL COORDINATE WITH THE OWNER FOR ALL FEES AND DATA NEEDED FOR THIS.

## GEN. RENOVATION NOTES

- DISCONNECT AND REMOVE ANY EQUIPMENT, PIPING OR DUCTWORK THAT WAS INSTALLED AS PART OF THE BUILDING SHELL THAT IS NOT NEEDED OR CONFLICTS WITH THIS BUILD OUT.
- EXISTING UNDERGROUND PIPING LOCATIONS ARE ESTIMATED BASED UPON ANTICIPATED ROUTINGS. FIELD VERIFY EXACT LOCATIONS DURING CONSTRUCTION AND PROVIDE ALL NECESSARY MODIFICATIONS.
- SAW/CUT GRADE FLOOR SLABS TO INSTALL NEW PIPING, MECHANICAL SYSTEMS, ELECTRICAL FLOOR BOXES AND ALL ASSOCIATED CONDUIT, ETC. PATCH FLOOR TO MAKE LIKE NEW AFTER INSTALLATION. TAKE CARE TO LOCATE EXISTING CONDUIT, ETC. AND AVOID CUTTING EXISTING CONDUITS BY NOT OVER-CUTTING SLAB DEPTH.
- SAW/CUT AND CORE DRILL OPENINGS AS REQUIRED FOR ABOVE GRADE SLAB PENETRATIONS. X-RAY SLABS TO ASCERTAIN STEEL AND EXISTING CONDUIT PENETRATIONS PRIOR TO CUTTING. VERIFY OPENINGS WITH STRUCTURAL ENGINEER PRIOR TO CUTTING.
- HOMERUN CIRCUITS TO 20 AMP SINGLE POLE BREAKERS IN PANELBOARDS INDICATED. UTILIZE SPARE BREAKERS MADE AVAILABLE BY DEMOLITION. IF NO SPARE BREAKER IS AVAILABLE, PROVIDE NEW BREAKER.
- EXISTING CIRCUITING MAY BE RE-USED WHERE POSSIBLE.
- CONCEAL NEW CIRCUITING IN WALLS WHERE POSSIBLE. FOR NEW DEVICES INSTALLED ON EXISTING SOLID WALLS, CONCEAL CIRCUITING IN WIREMOLD. COORDINATE FINISH AND GENERAL ROUTING OF WIREMOLD WITH ARCHITECT TO BE AS CONCEALED AND/OR ROUTED IN A NEAT AND ORGANIZED CONSISTENT MANNER.
- ALL LIGHTING FIXTURES THAT ARE RELOCATED OR OTHERWISE AFFECTED BY THE SCOPE OF WORK SHALL BE CLEANED AND RELAMPED.

## SHEET INDEX

ME001	Mechanical/Electrical/Plumbing - Specifications and Details
ME101	Mechanical/Electrical - Site Plan and Schedules

## GEN. MECHANICAL NOTES

- COMPLETE INSTALLATION SHALL BE IN ACCORDANCE WITH THE LATEST ADOPTED VERSION OF THE INTERNATIONAL MECHANICAL CODE, LOCAL AND STATE CODES, AND REQUIREMENTS OF THE A/E.
- ANY POWER FOR CONTROL SYSTEMS TO BE PROVIDED BY E/C IS INDICATED ON ELECTRICAL PLANS. ANY ADDITIONAL LINE VOLTAGE OR LOW VOLTAGE POWER REQUIRED BY THE M/C OR SUBCONTRACTORS TO HAVE A FULLY FUNCTIONING SYSTEM SHALL BE PROVIDED BY THE M/C CONTRACTOR OR SUBS.
- ALL EQUIPMENT SHALL BE ADEQUATELY AND PROPERLY SUPPORTED AND FASTENED FROM STRUCTURE.
- ALL EQUIPMENT AND ACCESSORIES INSTALLED IN CONCEALED SPACES REQUIRING ACCESS SHALL BE PROVIDED WITH ACCESS DOORS MEETING ANY FIRE REQUIREMENTS OF THE WALL/CEILING THEY ARE INSTALLED.
- EACH AIR HANDLING UNIT OVER 2000CFM SHALL BE PROVIDED WITH A SMOKE DETECTOR TO SHUT DOWN THE UNIT PER IMC 606 AS REQUIRED BY A/E. COORDINATE WITH OTHER TRADES.
- START UP AND ADJUST ALL EQUIPMENT AND VERIFY ALL MECHANICAL SYSTEMS IN OPERATION IN ACCORDANCE WITH THEIR INTENDED PURPOSES. SUBMIT BALANCE AND START UP REPORTS TO THE A/E. REFER TO SPECIFICATIONS FOR ANY ADDITIONAL REQUIREMENTS.

## GENERAL ELECTRICAL NOTES

- COMPLETE INSTALLATION SHALL BE IN ACCORDANCE WITH THE LATEST ADOPTED VERSION OF THE NATIONAL ELECTRICAL CODE, LOCAL AND STATE CODES, AND REQUIREMENTS OF THE A/E.
- COORDINATE LOCATIONS OF RECEPTACLES, SWITCHES, ETC. WITH ARCHITECTURAL CASEWORK AND ELEVATIONS.
- REFER TO MOUNTING HEIGHTS DETAIL FOR MOUNTING HEIGHTS OF ALL DEVICES NOT INDICATED OTHERWISE.
- PROVIDE ALL EMPTY CONDUITS WITH PULL STRINGS AND BUSHED ENDS.
- CONTRACTOR SHALL CONCEAL ALL CONDUIT, FITTINGS, AND DEVICES FROM VIEW WHERE REASONABLY POSSIBLE.

## MECHANICAL SYMBOL LEGEND

SOME SYMBOLS AND ABBREVIATIONS ON THIS LEGEND MAY NOT BE USED

### MECHANICAL

⊕ THERMOSTAT

### PIPING SYMBOLS

—○—	PIPING ELBOW UP
—┴—	PIPING ELBOW DOWN
—┬—	PIPING TEE
—┴┬—	PIPING ELBOW

## ELECTRICAL SYMBOL LEGEND

SOME SYMBOLS AND ABBREVIATIONS ON THIS LEGEND MAY NOT BE USED

### CIRCUITING

	HOME RUN (2#12 1#12G UNO)
	INDICATES 2 PHASE, 1 N, & 1 GRD CONDUCTOR
	HOME RUN: INDICATES SHARED CIRCUIT
	HOME RUN: INDICATES #10 CONDUCTORS ENTIRELY

### UTILITIES

---	UNDERGROUND ELECTRICAL
---	OHE OVERHEAD ELECTRICAL
---	TELE TELECOMMUNICATIONS CONDUIT
---	UGT --- UNDERGROUND TELECOMMUNICATIONS CONDUIT

### LIGHTING

	GRID-MOUNTED TROFFER LIGHT FIXTURE
	STRIP LIGHT FIXTURE
	SURFACE/RECESSED LIGHT FIXTURE
	WALL-MOUNTED LIGHT FIXTURE
	POLE-MOUNTED LIGHT FIXTURE
	EXIT LIGHT
	BATTERY-OPERATED EMERGENCY LIGHT (WALL MTD)
	BATTERY-OPERATED EMERGENCY LIGHT (CEILING MTD)
	WALL-MOUNTED COMBINATION EXIT LIGHT/BATTERY-OPERATED EMERGENCY LIGHT
	LIGHT SWITCH - SINGLE POLE
	LIGHT SWITCH - 3-WAY
	LIGHT SWITCH - 4-WAY

### POWER DEVICES

	DUPLEX RECEPTACLE
	LINE THRU DEVICE INDICATES ABOVE COUNTER
	SPECIAL DUPLEX RECEPTACLE (GFCI, ISOLATED GROUND, ETC.)
	QUADPLEX RECEPTACLE
	SIMPLEX RECEPTACLE W/NEMA CONFIG AS NOTED
	MULTI-POLE RECEPTACLE W/NEMA CONFIG AS NOTED
	CEILING MOUNTED RECEPTACLE
	JUNCTION BOX
	PUSH BUTTON
	MOTOR
	DISCONNECT SWITCH. RE: PLANS FOR INFORMATION.
	MAGNETIC MOTOR STARTER
	COMBINATION DISCONNECT SWITCH / MOTOR STARTER
	TOGGLE-TYPE DISCONNECT. FURNISH WITH THERMAL MOTOR PROTECTION WHERE SERVING FANS/PUMPS.
	SURFACE PANELBOARD
	RECESSED PANELBOARD
	DISTRIBUTION PANELBOARD
	SWITCHBOARD. FEEDER/MAIN CIRCUIT BREAKER SECTION AND DISTRIBUTION SECTION.

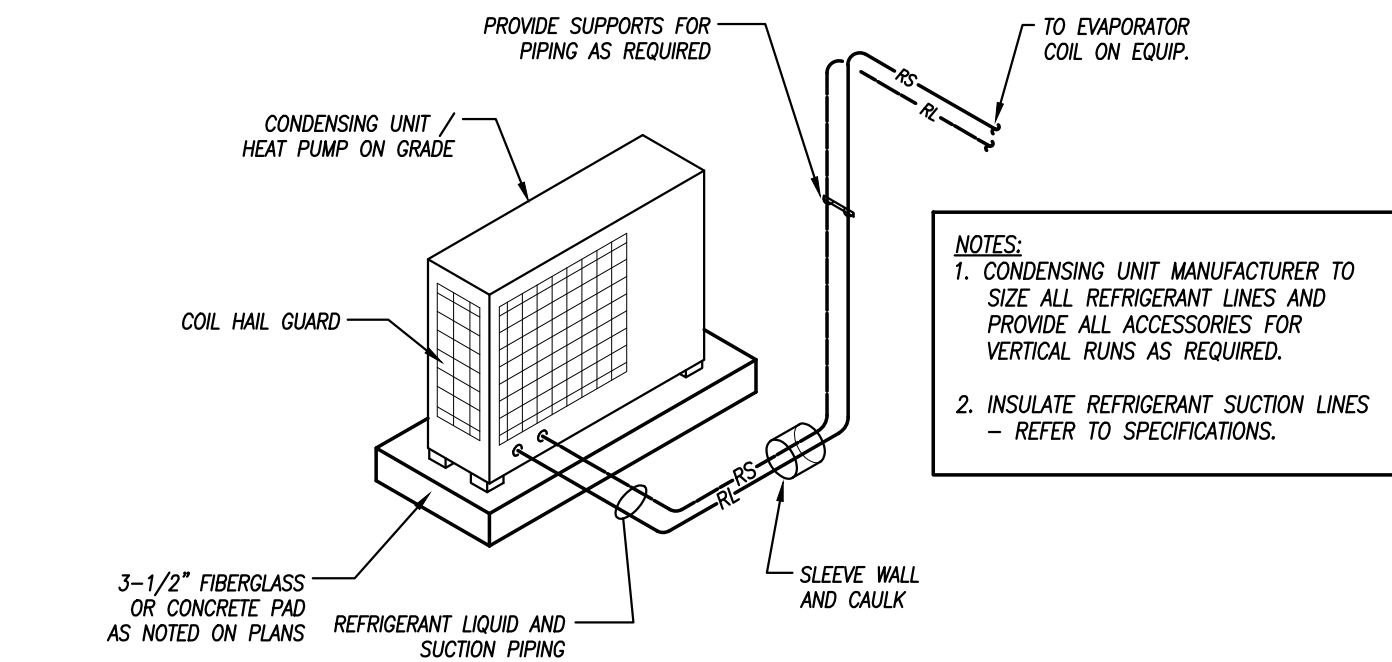

## MINI SPLIT CONDENSING UNIT / HEAT PUMP DETAIL

NOT TO SCALE

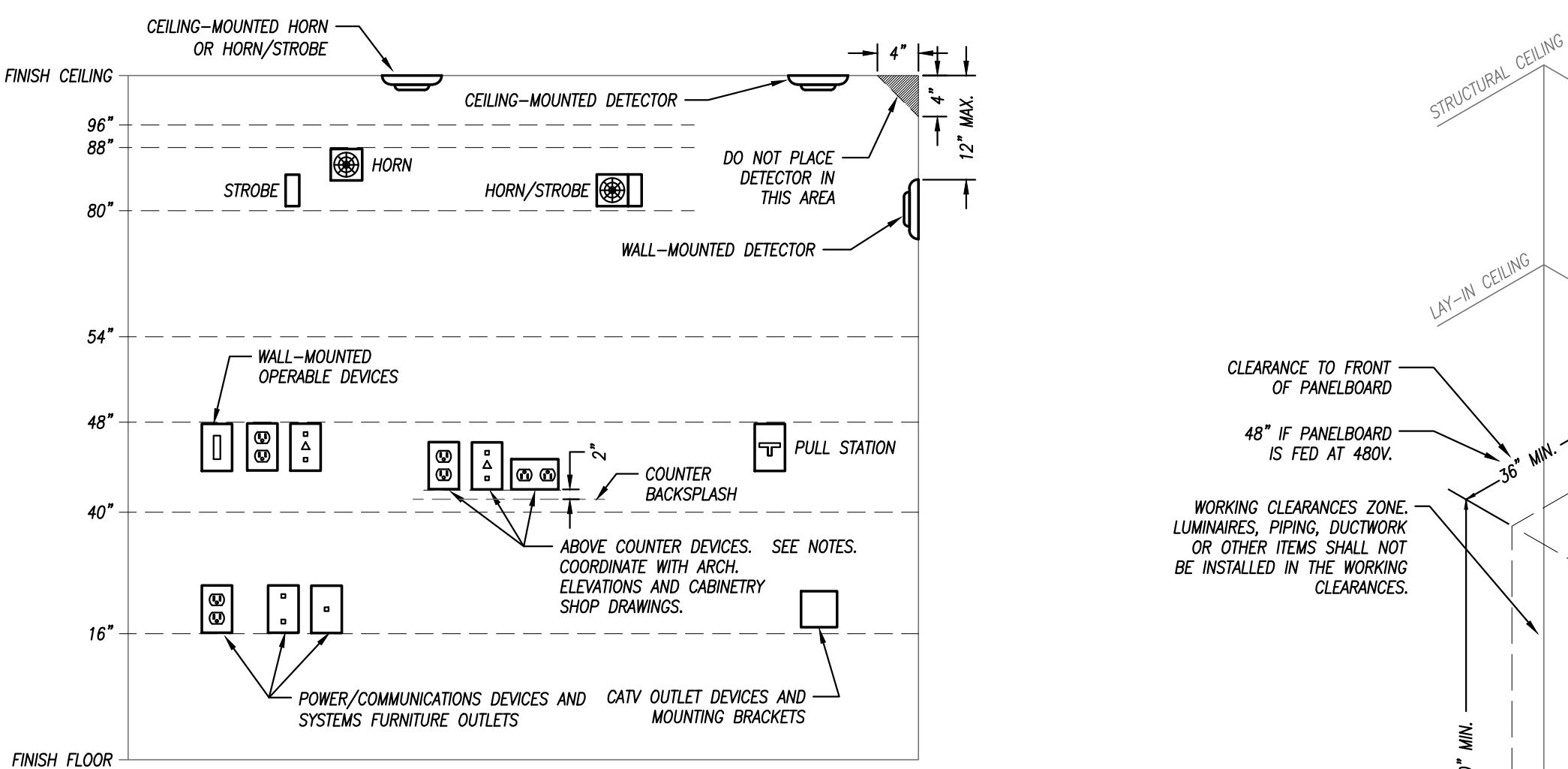

- GENERAL NOTES:
- MOUNTING HEIGHTS SHOWN IN THIS DETAIL ARE TYPICAL UNLESS OTHERWISE NOTED ON THE PLANS.
  - SEE ARCHITECTURAL ELEVATIONS FOR SPECIAL CONDITIONS. NOTIFY ARCHITECT IMMEDIATELY OF ANY CONFLICTS.
  - ALL INSTALLATIONS SHALL COMPLY WITH ADA.

VISUAL FIRE ALARM NOTIFICATION DEVICES (STROBE) LOCATE DEVICE SO THE BOTTOM OF THE DEVICE IS BETWEEN 80" AND 96" A.F.F. (NFA) OR 6" BELOW CEILING, WHICHEVER IS LOWER (ADA 2010).

ADDITIONAL FIRE ALARM NOTIFICATION DEVICES (HORN) LOCATE DEVICE SO THAT THE TOP OF UNIT IS NOT MORE THAN 90" A.F.F. AND NOT LESS THAN 6" BELOW CEILING (NFA).

FIRE ALARM ACTIVATION DEVICES (PULL STATION) LOCATE FRONT-APPROACH DEVICES SO THAT THE HIGHEST OPERABLE PORTION OF THE DEVICE IS NOT MORE THAN 48" A.F.F. (ADA 2010) AND NOT LESS THAN 42" A.F.F. (NFA).

WALL-MOUNTED OPERABLE DEVICES: OPERABLE DEVICES SHALL BE LOCATED AT 48" A.F.F. TO THE TOP OF THE OPERABLE PORTION OF THE DEVICE.

WALL-MOUNTED OPERABLE DEVICES INCLUDE, BUT ARE NOT LIMITED TO THE FOLLOWING: LIGHT SWITCHES, DIMMERS, CONTROLS, ETC. PUSH BUTTONS. NURSE/PATIENT CALL DEVICES (INCLUDING THOSE FOR STAFF USE) OTHER CONTROL OR "CALL" DEVICES

## MOUNTING HEIGHTS FOR WALL-MOUNTED DEVICES

NOT TO SCALE

## TYPICAL PANELBOARD INSTALLATION DETAIL

NOT TO SCALE

## 16000 - ELECTRICAL SPECIFICATIONS

### SECTION 16000 - ELECTRICAL REQUIREMENTS

#### GENERAL REQUIREMENTS

- ALL WORK SHALL BE IN ACCORDANCE W/ LATEST EDITION OF INTERNATIONAL BUILDING CODE, NATIONAL ELECTRICAL CODE, NFPA, CODES AS ADOPTED BY CITY, COUNTY, STATE & ALL OTHER APPLICABLE CODES.
- ALL MATERIALS & EQUIPMENT SHALL BE NEW & SHALL BEAR U.L. LABEL WHERE APPLICABLE. PROVIDE WATERPROOF EQUIPMENT ENCLOSURES WHERE REQUIRED.
- OBTAIN & PAY FOR ALL PERMITS REQUIRED FOR EXECUTION OF THIS WORK & SHALL MAKE ARRANGEMENTS FOR MODIFICATIONS TO ELECTRICAL CONNECTIONS TO BUILDING AS REQUIRED.
- CONTRACTOR SHALL PROVIDE ALL LABOR & MATERIALS REQUIRED TO HAVE COMPLETE FUNCTIONING ELECTRICAL LIGHTING & POWER SYSTEMS TOGETHER W/ ALL ASSOCIATED EQUIPMENT & APPARATUS AS SHOWN ON PLANS.
- WHERE AN ELECTRICAL DEVICE IS REQUIRED BY CODE BUT NOT SHOWN, IT SHALL BE PROVIDED AS THOUGH FULLY SHOWN & SPECIFIED.
- CONTRACTOR SHALL VISIT SITE & OBSERVE CONDITIONS UNDER WHICH WORK WILL BE DONE. ANY DISCREPANCIES SHALL BE CALLED TO ARCHITECT'S ATTENTION. NO SUBSEQUENT ALLOWANCE WILL BE MADE IN THIS CONNECTION FOR ANY ERROR OR NEGLIGENCE ON CONTRACTOR'S PART.
- FINAL ACCEPTANCE OF WORK SHALL BE SUBJECT TO CONDITION THAT ALL SYSTEMS, EQUIPMENT, APPARATUS & APPLIANCES OPERATE SATISFACTORILY AS DESIGNED & INTENDED. WORK SHALL INCLUDE REQUIRED ADJUSTMENT OF SYSTEMS & CONTROL EQUIPMENT INSTALLED UNDER THESE SPECIFICATIONS.
- WARRANT TO OWNER QUALITY OF MATERIALS, EQUIPMENT, WORKMANSHIP & OPERATION OF EQUIPMENT PROVIDED UNDER THESE SPECIFICATIONS FOR ONE YEAR FROM & AFTER COMPLETION OF BUILDING & ACCEPTANCE OF MECHANICAL SYSTEMS BY OWNER.

#### SECTION 16100 - CONDUIT & CONDUCTORS

- FOLLOW CIRCUITING SHOWN ON PLANS. USE NO CONDUIT SMALLER THAN 1/2" & NO CONDUCTORS SMALLER THAN #12 GA. UNLESS NOTED OTHERWISE.
- WIRE SHALL BE IN NON-FLEXIBLE METALLIC CONDUIT (EMT, IMC OR RMC) FOR ALL CIRCUITS AND FEEDERS GREATER THAN 30A. LIGHT SWITCH RISERS, KITCHEN CIRCUITS & HOME RUNS.
- MC CABLE ACCEPTABLE FOR BRANCH COMMENCEMENT CIRCUITS AND LIGHTING CIRCUITS. DO NOT USE CHAIN LIGHT FIXTURES. PROVIDE HEALTH CARE RATED MC FOR MEDICAL TREATMENT AREAS WHEN NOT IN CONDUIT.
- CONDUIT INSTALLED BELOW GRADE SHALL BE SCHEDULE 80 PVC HEAVY WALL PLASTIC CONDUIT MEETING NEMA STANDARDS & UL LISTED FOR UNDERGROUND & EXPOSED USE. PROVIDE ONE RADIUS BENDS & RISERS AS LONG AS CONDUITS RISE ABOVE GRADE OR ABOVE FLOOR SLAB.
- PROVIDE INTERLOCKING SPACERS FOR MULT RUNS OF UG CONDUITS IN SAME TRENCH.
- LIGHTING & RECEPTACLE CIRCUIT CONDUCTORS SHALL BE COPPER THINW/THIN 600 VOLT, 75 DEG C. COLOR CODED AS DESCRIBED UNDER APPLICABLE CODES. NO ROMEX, PLASTIC FLEX TUBING ETC PERMITTED. LIGHT FIXTURE WIRE INSULATION SHALL HAVE TEMP RATING NOT LESS THAN INDIVIDUAL FIXTURE MANUF RECOMMENDED RATING.
- CIRCUITS W/ NO. 8 OR LARGER CONDUCTORS, MOTOR CIRCUITS, POWER & FEEDER CIRCUITS & BUILDING SERVICE FEEDERS SHALL BE COPPER THINW/THIN 600 VOLT, 75 DEG C.
- ALL CONDUIT, JUNCTION BOXES, ETC. ABOVE CEILINGS SHALL BE SUPPORTED FROM STRUCTURE. PIPE SLEEVES, HANGERS & SUPPORTS SHALL BE FURNISHED & SET & CONTRACTOR SHALL BE RESPONSIBLE FOR PROPER & PERMANENT LOCATIONS.

#### SECTION 16200 - GROUNDING

- SUPPLEMENT GROUNDING NEUTRAL OF SECONDARY DISTRIBUTION SYSTEM W/ EQUIPMENT GROUNDING SYSTEM INSTALLED SO THAT METALLIC ENCLOSURES, RACEWAYS, JUNCTION BOXES, OUTLET BOXES, CABINETS, MACHINE FRAMES, PORTABLE EQUIPMENT & OTHER CONDUCTIVE ITEMS OPERATE CONTINUOUSLY AT GROUND POTENTIAL & PROVIDE LOW IMPEDANCE PATH FOR GROUND FAULT CURRENTS.
- SYSTEM SHALL COMPLY W/ NATIONAL ELECTRICAL CODE, DRAWINGS & AS SPECIFIED.
- PROVIDE EQUIPMENT GROUND BUS IN BASE OF LOW VOLTAGE SWITCHGEAR BRAZED OR OTHERWISE ADEQUATELY CONNECTED TO APPROVED METHOD TO GROUND RODS.
- PROVIDE IN CONDUIT GREEN INSULATED COPPER GROUND CONDUCTOR TO MAIN METALLIC WATER SERVICE ENTRANCE & CONNECT BY MEANS OF ADEQUATE GROUND CLAMPS.
- EQUIPMENT GROUNDING CONDUCTORS FOR BRANCH CIRCUIT HOME RUNS SHOWN ON DRAWINGS SHALL INDICATE AN INDIVIDUAL & SEPARATE GROUND CONDUCTOR FOR THAT BRANCH CIRCUIT WHICH SHALL BE TERMINATED AT BRANCH CIRCUIT PANELBOARD, SWITCHBOARD, OR OTHER DISTRIBUTION EQUIPMENT.
- PROVIDE LOW VOLTAGE DISTRIBUTION SYSTEM W/ SEPARATE GREEN INSULATED EQUIPMENT GROUNDING CONDUCTOR FOR EACH SINGLE OR THREE-PHASE FEEDER. SINGLE PHASE 120 VOLT BRANCH CIRCUITS FOR LIGHTING & POWER SHALL CONSIST OF PHASE & NEUTRAL CONDUCTORS & GREEN GROUND CONDUCTOR INSTALLED IN COMMON CONDUIT WHICH SHALL SERVE AS GROUNDING CONDUCTOR.
- GROUNDING CONDUCTORS SHALL BE AS SHOWN ON PLANS & IF NOT SPECIFICALLY SHOWN SHALL BE NO SMALLER THAN THAT REQUIRED BY NEC.

#### SECTION 16300 - ELECTRICAL EQUIPMENT

- JUNCTION BOXES & OUTLET BOXES SHALL BE GALVANIZED KNOCKOUT TYPE. LIGHTING FIXTURE BOXES IN CEILINGS SHALL NOT BE LESS THAN 4" OCTAGONAL KNOCKOUT TYPE. OUTLETS SHALL BE INSTALLED IN LOCATIONS SHOWN ON DRAWINGS EXCEPT OUTLETS MAY BE MOVED 4 & 4 FEET IN EITHER DIRECTION TO GROUND RODS WITHOUT ADDITIONAL COST. BOXES SHALL BE FLUSH MOUNTED ON WALLS FOR CONCEALED WORK. GANGLABLE BOXES SHALL BE USED IN ALL GYPSED SURFACES.
- PANELBOARDS
- BRANCH CIRCUIT 208/240V PANELS SHALL BE CAPACITY SHOWN W/ TIN PLATED COPPER BUSSING & BRACED FOR MINIMUM OF 10,000A AC OR AS OTHERWISE NOTED OR REQUIRED (SERIES RATED ACCEPTABLE). BOXES ON CIRCUIT BREAKERS. 480V PANELS SAME EXCEPT 14,000A AC MIN. MINIMUM 20" WIDE W/ GALV STEEL ENCLOSURE W/ HINGED DOOR & KEYS LOCK. COORD TRIM WITH MOUNTING LOCATION. PANELS TO BE RECESSED WHENEVER POSSIBLE.
- DISTRIBUTION PANELS SHALL BE CAPACITY SHOWN & SHALL BE SQUARE D I-LINE W/ TIN PLATED COPPER BUSSING. 65KAIC MIN OR AS OTHERWISE NOTED/REQD. BOLT ON CIRCUIT BREAKERS (SERIES RATED ACCEPTABLE). GALV STEEL ENCLOSURE.
- EQUIVALENT BY SQUARE D, SIEMENS, CUTLER HAMMER, OR GE.

#### SECTION 16350 - ELECTRICAL IDENTIFICATION

- MANUFACTURED LABELS FOR EACH PANELBOARD & TRANSFORMER. TYPEWRITTEN PANEL SCHEDULES MOUNTED IN PANELS.
- PRINTED TAPE STYLE LABEL FOR EACH RECEPTACLE INDICATING PANEL & CIRCUIT #.
- MANUFACTURED LABELS FOR ALL DISCONNECT SWITCHES INDICATING EQUIPMENT SERVED.
- BRANCH CIRCUITS - IDENTIFY EACH CIRCUIT W/ WIRE MARKERS WHEN ENCLOSURE LABEL AND WIRE COLORS DO NOT PROVIDE ENOUGH INFORMATION TO IDENTIFY EACH CIRCUIT WITHOUT TRACING. FEEDERS & BRANCH CIRCUIT HOME RUNS W/ WIRE MARKER W/ PANEL & CMT #. BOX COVERS ABOVE LAP-IN CEILINGS NEATLY MARKED W/ INDELEIBLE MARKER.

#### SECTION 16400 - WIRING DEVICES

- CONVENIENCE OUTLETS - SPEC GRADE 20 AMP DUPLEX W/ GROUND & SS WALL PLATES. OTHER OUTLETS SHALL BE VERIFIED W/ EQUIPMENT SUPPLIERS FOR PROPER NEMA CONFIGURATIONS. PROVIDE GFCI RATED DEVICES WHERE INDICATED AND AS REQD PER CODE.
- LIGHT SWITCHES - SPEC GRADE 20 AMP TOGGLE SWITCHES W/ SS WALL PLATES.
- WALL MOTION SWITCHES - SPEC GRADE, PIR, OVERRIDE.
- WALL MOTION SWITCHES (BATHROOM) - DUAL RELAY, SPEC GRADE, PIR, 2ND RELAY FOR OPERATION OF EXHAUST FAN DELAY.
- COLOR OF DEVICES AS DIRECTED BY ARCHITECT.
- EQUIVALENT DEVICES BY LEVITON, BRYANT, HUBBELL, WATTS/STOPPER, LITHONIA, SENSOR SWITCH.

#### EXECUTION

- ALL OUTLETS, SHALL BE MOUNTED W/ BOTTOM AT 18" AFF & SWITCHES W/ BOTTOM AT 44" ABOVE FINISHED FLOOR UNLESS NOTED OTHERWISE ON PLANS. REFER TO ARCH FOR OTHER REQUIRED ELEVATIONS AND CABINERY COORDINATION.

#### SECTION 16500 - LUMINAIRES, LAMPS & BALLASTS

- PROVIDE LIGHTING FIXTURES W/ LAMPS & ACCESSORIES REQD FOR HANGING. COORD MOUNTING OF LIGHTING FIXTURES W/ ARCHITECT & G/C. ADDITIONAL FIXTURE SUPPORTS SHALL BE PROVIDED BY E/C. SUPPORTS SHALL COMPLY W/ LATEST EDITION OF NEC. PROVIDE LIGHTING FIXTURE SECURITY CLIPS AS REQUIRED. CONSULT ARCH PLANS FOR CEILING TYPES & PROVIDE SURFACE & RECESSED LIGHTING FIXTURES W/ APPROPRIATE MOUNTING COMPONENTS & ACCESSORIES.
- REFER TO LIGHTING FIXTURE SCHEDULE PLANS FOR FUTURE TYPES.
- EQUIVALENT LUMINAIRES BY HUBBELL, INFINITY, LITHONIA, WILLIAMS, COLUMBIA, EXTRONICS, LITELARM, EXIDE.

#### LAMPS

- LAMPS SHALL BE TYPE RECOMMENDED BY FIXTURE MANUF. LAMP NONE ABOVE MANUF RECOMMENDED MAX WATTAGE.
- EQUIVALENT LAMPS BY G.E., VENTURE, PHILIPS OR SYLVANIA.
- PROVIDE ASSOCIATED DRIVER WITH LED FIXTURES.

## 15000 - MECHANICAL SPECIFICATIONS

### SECTION 15000 - MECHANICAL REQUIREMENTS

#### 1. GENERAL REQUIREMENTS

- ALL WORK SHALL BE IN ACCORDANCE W/ LATEST EDITION OF INTERNATIONAL BUILDING CODE, MECHANICAL & PLUMBING CODES, CODES AS ADOPTED BY CITY, COUNTY, STATE & ALL OTHER APPLICABLE CODES.
- FURNISH & INSTALL ALL LABOR & MATERIALS REQUIRED FOR COMPLETE, FUNCTIONING, MECHANICAL & PLUMBING SYSTEMS W/ ALL ASSOCIATED EQUIPMENT & APPARATUS AS SHOWN ON PLANS. "PROVIDE" MEANS TO FURNISH & INSTALL.
- OBTAIN & PAY FOR ALL PERMITS REQUIRED FOR EXECUTION OF THIS WORK & SHALL MAKE ARRANGEMENTS FOR MODIFICATIONS TO WATER, GAS & SEWER CONNECTIONS TO BUILDING AS REQUIRED.
- VISIT SITE & OBSERVE CONDITIONS UNDER WHICH WORK WILL BE DONE. ANY DISCREPANCIES SHALL BE CALLED TO ARCHITECT'S ATTENTION. NO SUBSEQUENT ALLOWANCE WILL BE MADE IN CONTRACT FOR ANY ERROR OR NEGLIGENCE ON CONTRACTOR'S PART.
- FINAL ACCEPTANCE OF WALL SHALL BE SUBJECT TO CONDITION THAT ALL SYSTEMS, EQUIPMENT, APPARATUS & APPLIANCES OPERATE SATISFACTORILY AS DESIGNED & INTENDED. WORK SHALL INCLUDE REQUIRED ADJUSTMENT OF SYSTEMS & CONTROL EQUIPMENT INSTALLED UNDER THESE SPECIFICATIONS.
- WARRANT TO OWNER QUALITY OF MATERIAL, EQUIPMENT, WORKMANSHIP & OPERATION OF EQUIPMENT PROVIDED UNDER THESE SPECIFICATIONS FOR ONE YEAR FROM & AFTER COMPLETION OF BUILDING & ACCEPTANCE OF MECHANICAL SYSTEMS BY OWNER.
- ALL MATERIALS INSTALLED IN PLUMBING SHALL BE NONCOMBUSTIBLE OR HAVE FLAME/SMOKE INDEX OF NO MORE THAN 25/50 IN ACCORDANCE W/ ASTM E 84.
- ROOF PENETRATIONS - MADE BY AUTHORIZED ROOFING CONTRACTOR WHEN REQUIRED.

#### SECTION 15300 - HVAC

##### GENERAL

- PROVIDE COMPLETE HVAC SYSTEM AS SHOWN ON DRAWINGS INCLUDING ALL NECESSARY EQUIPMENT, DUCTWORK, DIFFUSERS, GRILLES, & FILTERS. PROVIDE OPERATING & MAINTENANCE INSTRUCTIONS ON ALL EQUIPMENT.
- ALL HVAC WORK SHALL BE DONE IN STRICT ACCORDANCE W/ ALL REQUIREMENTS OF LOCAL BUILDING CODE, ASHRAE, NEC, NFPA, & ALL OTHER APPLICABLE CODES HAVING JURISDICTION.

##### PIPING

- REFRIGERANT PIPING - COPPER TUBE TYPE ACR, HARD TEMPER NITROGENIZED REFRIGERANT TUBE, ASTM B-88, TYPE L OR K, BRAZED JOINTS. INSULATE W/ ARMAFLEX IN THICKNESS PER ASHRAE 90.1. PROVIDE EXTERIOR RATED OR COATED ARMAFLEX OUTDOORS.
- CONDENSATE PIPING - ALL PIPING SHALL BE 95-5 TIN-ANTIMONY JOINED TYPE L COPPER. INSULATE W/ FIBERGLASS W/ ASU & PVC COVERS. THICKNESS IN ACCORDANCE W/ ASHRAE 90.1. OR SCHED 40 PVC W/ SOLVENT WELDS MAY BE USED WHERE ALLOWED BY LOCAL CODE.

##### EQUIPMENT

- MINI-SPLIT FAN COIL & HEAT PUMP UNITS AS SCHEDULED. PROVIDE WALL MOUNTED FAN COIL WITH WIRE MOUNTED THERMOSTAT AND HEAT PUMP 18" SAME MANUFACTURER. EQUIVALENT BY DAIKIN, LG, MITSUBISHI, LENOX, YORK, CARRIER. CONTRACTOR SHALL ROUTE REFRIGERANT PIPING FROM INDOOR FAN COIL TO OUTDOOR HEAT PUMP. REFER TO MANUFACTURER'S RECOMMENDATION FOR PIPE SIZING BASED ON CAPACITY AND PIPE LENGTHS. COORDINATE WITH ELECTRICAL CONTRACTOR FOR WIRING BETWEEN UNITS.

##### EXECUTION

- COORDINATE W/ E/C TO PROVIDE ALL WIRING BETWEEN EQUIPMENT, THERMOSTATS & ALL OTHER REQUIRED CONTROLS & DEVICES. PROVIDE ANY REQUIRED INTERFACES TO FIRE ALARM OR SIMILAR SYSTEMS.
- PROVIDE GROUND-MOUNTED UNITS ON 4" REINFORCED CONCRETE BASE, 4" LARGER THAN UNIT ON EACH SIDE.



## GENERAL LIGHTING NOTES

1. REFER TO GENERAL NOTES ON MEP COVER SHEET FOR ADDITIONAL REQUIREMENTS OF WORK.
2. LIGHT FIXTURES INDICATED AS EMERGENCY FIXTURES ARE TO FUNCTION AS NIGHT LIGHTS UNLESS SPECIFICALLY SHOWN SWITCHED.
3. ALL CIRCUITING SHOWN ON THIS PLAN IS DIAGRAMMATIC.
  - 3.1. ALL FIXTURES SHALL BE FED FROM JUNCTION BOXES WITH LIGHT FIXTURE WHIPS (<6'). DAISY-CHAINING OF FIXTURES IS NOT ALLOWED.
  - 3.2. SWITCH BOX LOCATIONS SHALL BE WIRED SO THAT A NEUTRAL WIRE IS AVAILABLE AT THE SWITCH BOX LOCATION, EITHER IN THE BOX OR AVAILABLE TO BE ADDED VIA RACEWAY OR AN ACCESSIBLE WALL CAVITY.
  - 3.3. WALL SWITCHES FOR SEPARATE LOAD TYPES (EM/NORMAL, 120/277V, ETC.) SHALL NOT BE IN A SINGLE BOX.
  - 3.4. REFER TO SPECIFICATIONS FOR ADDITIONAL REQUIREMENTS.

## GENERAL POWER NOTES

1. REFER TO GENERAL NOTES ON MEP COVER SHEET FOR ADDITIONAL REQUIREMENTS OF WORK.
2. COORDINATE EXACT NEMA CONFIGURATIONS OF RECEPTACLES SERVING EQUIPMENT WITH EXACT EQUIPMENT BEING FURNISHED.
3. REFER TO THE SPECIFICATIONS FOR ADDITIONAL LOCATIONS/REQUIREMENTS FOR RECEPTACLES, INCLUDING GFCI, WEATHER-RESISTANT, HOSPITAL-GRADE, AND TAMPER-RESISTANT RECEPTACLES.
4. EXACT MECHANICAL EQUIPMENT LOCATIONS MAY NOT BE SHOWN FOR CLARITY. COORDINATE EXACT LOCATIONS OF ALL MECHANICAL EQUIPMENT, DUCT DETECTORS, ETC. WITH MECHANICAL DRAWINGS AND CONTRACTOR.
5. COORDINATE EXACT LOCATIONS OF SMOKE DETECTORS WITH CEILING FANS, HVAC DIFFUSERS, SPRINKLER HEADS, ETC. PER NFPA REQUIREMENTS.

## GENERAL HVAC NOTES

1. REFER TO GENERAL NOTES ON MEP COVER SHEET FOR ADDITIONAL REQUIREMENTS OF WORK.

## HVAC KEYED NOTES

1. REFRIGERANT SUCTION AND LIQUID LINE TO HEAT PUMP. SEAL WALL PENETRATION.
2. ROUTE CONDENSATE TO STORM DRAIN OR LANDSCAPED AREA. AVOID DISCHARGING ON SIDEWALK OR PARKING LOT.

## SINGLE-SECTION PANELBOARD SCHEDULE

PANEL DESIGNATION: L1									
MOUNTING: SURFACE LOCATION: -									
DESCRIPTION	PHASE		C/B		CIRCUIT #		C/B		DESCRIPTION
	A	B	TRIP	POLE			POLE	TRIP	
LTG. WORKSHOP	238		20	1	1	2	1	20	REC. WORKSHOP 1
LTG. OUTDOOR		160	20	1	3	4	1	20	REC. WORKSHOP 2
A/C MINI-SPLIT	1596		15	2	5	6	1	20	REC. CART CHARGER
-		1596	-	-	7	8	1	20	REC. WORKSHOP 3
REC. DEDICATED 220V	1920		20	2	9	10	1	20	REC. WORKSHOP 4
-		1920	-	-	11	12	1	20	REC. GARAGE 1
SPARE	-	-	20	1	13	14	1	20	REC. GARAGE 2
SPARE	-	-	20	1	15	16	1	20	REC. WORKSHOP 5
SPARE	-	-	20	1	17	18	1	20	SPARE
SPARE	-	-	20	1	19	20	1	20	SPARE
SPARE	-	-	20	1	21	22	1	20	SPARE
-	-	-	-	-	1	23	24	1	-
-	-	-	-	-	1	25	26	1	-
-	-	-	-	-	1	27	28	1	-
-	-	-	-	-	1	29	30	1	-
TOTALS	3754	3676							

PANELBOARD SIZING LOAD			
LOAD DESCRIPTION	CONNECTED	DEMAND	CODE MIN. (VA)
LIGHTS	398	1.25	498
RECEPTACLES	9,420	10KVA + 50% REST	9,420
MOTORS	0	1.25 x LARGEST + SUM OF REST	0
AIR CONDITIONING	3,192	1.00	3,192
SPACE HEATING	0	0.00	0
CONTINUOUS	0	1.25	0
NON-CONTINUOUS	0	1.00	0
MISC. LOADS 1	0	1.00	0
MISC. LOADS 2	0	1.00	0
SIZING LOAD:			13,110
SIZING LOAD (AMPS):			63

CONNECTED PHASE LOADS		
PHASE	VA	AMPS
A	6,274	52.3
B	6,736	56.1
TOTALS	13,010	62.5

### REMARKS:

- 1.
- 2.
- 3.
- 4.
- 5.



## FLOOR PLAN - ELECTRICAL/MECHANICAL

1/4" = 1'-0"

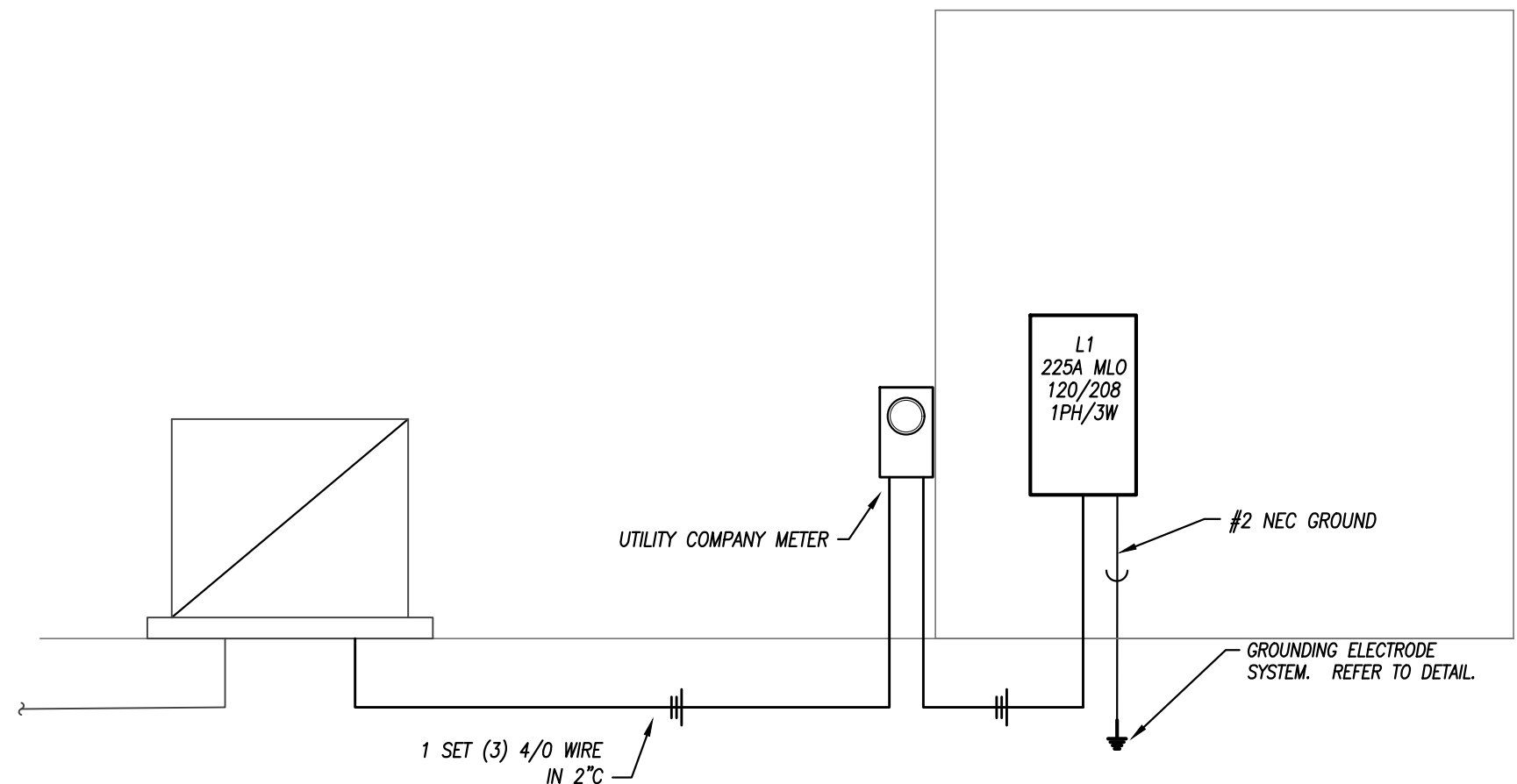

## LIGHT FIXTURE SCHEDULE

FIXTURE TYPE	MANUFACTURER	CATALOG NUMBER	DESCRIPTION	LAMP NUMBER / DESCRIPTION	VOLTAGE	REMARKS
A	---	---	ROUND LED DOWNLIGHT.	ONE (1) 26 WATT, 1782 LUMEN, L20 LUMEN PACKAGE. 3500K CCT.	120	1,2
B	---	---	4'-0" LONG x 2'-5/8" WIDE SURFACE-MOUNTED LEF FIXTURE. ROUNDED FROSTED ACRYLIC LENS. WHITE POWDER COAT FINISH.	ONE (1) 41 WATT, 4100 LUMEN, L41 LED MODULE. 3500K CCT.	120	1,2
C	N/A	N/A	EXISTING OUTDOOR WALL PACK LIGHT	---	120	

### REMARKS:

1. FURNISH WITH AND INSTALL ALL NECESSARY HARDWARE AND MOUNTING BRACKETS.
2. FIXTURE IS OWNER-PROVIDED, CONTRACTOR INSTALLED. COORDINATE EXACT ROUGH-IN REQUIREMENTS PRIOR TO CONSTRUCTION.

### GENERAL NOTES (APPLICABLE TO ALL FIXTURES):

- 1) REFER TO SPECIFICATIONS FOR APPROVED EQUAL FIXTURE MANUFACTURERS AND ADDITIONAL FIXTURE/DRIVER/BALLAST REQUIREMENTS.
- 2) ALL FIXTURES WITH PAINTED METAL PARTS SHALL BE PAINTED AFTER FABRICATION.
- 3) LUMENS LISTED FOR LED FIXTURES ARE GENERALLY DELIVERED LUMENS UNLESS NOTED OTHERWISE.
- 4) ALL EXTERIOR LED FIXTURES ARE FULL CUTOFF UNLESS NOTED OTHERWISE.
- 5) ALL FIXTURES SHALL BE IC RATED OR PROVIDED WITH INSULATION SHIELDS WHEN INSTALLED IN INSULATED AREAS OF THE TRUSS SPACE.
- 6) FOR ALL FIXTURES INSTALLED IN RATED ASSEMBLIES, FURNISH AND INSTALL APPROVED FIRE BARRIER (E.G. BARRIER OR TENMAT FF109 SERIES) OVER FIXTURE TO MAINTAIN 1 HOUR CEILING ASSEMBLY RATING.

## MINI-SPLIT COOLING ONLY UNIT

PLAN MARK	MANUFACTURER	MODEL	STYLE	NOM. TON.	SUPPLY FAN					OUTDOOR HEAT PUMP UNIT					REMARKS
					CFM	FLA	EAT/LAT	CAP. (MBH)	TYPE	VOLTAGE	MARK	MODEL	AMBIENT	REF.	
FC-1	DAIKIN	FTXN18	WALL MOUNTED	1	455	0.30	75° / 55°	18.0	DX	24V	HP-1	RXN18	0°F / 95°F	R-410A	1, 2, 3

### REMARKS:

1. PROVIDE WITH WIRED WALL MOUNTED THERMOSTAT / CONTROLLER.
2. PROVIDE INTEGRAL DISCONNECT FOR INDOOR EVAPORATOR AND EXTERNAL HEAVY DUTY NEMA 3R DISCONNECT FOR HEAT PUMP. PROVIDE WIRING BETWEEN INDOOR AND HEAT PUMP. COORDINATE WITH EC.
3. UNIT SHALL OPERATE DOWN TO 0°F IN COOLING MODE. PROVIDE ACCESSORIES AS REQUIRED.