

SUMMIT AT WEST PRYOR

PROJECT INFORMATION

STATE: MISSOURI
COUNTY: JACKSON
CITY: LEE'S SUMMIT
TYPE: NON-DIVING POOL
SCOPE: SINGLE BODY POOL
CONSTRUCTION METHOD: SHOTCRETE
SANITATION: CHLORINE
HEATED: NATURAL GAS

VICINITY MAP

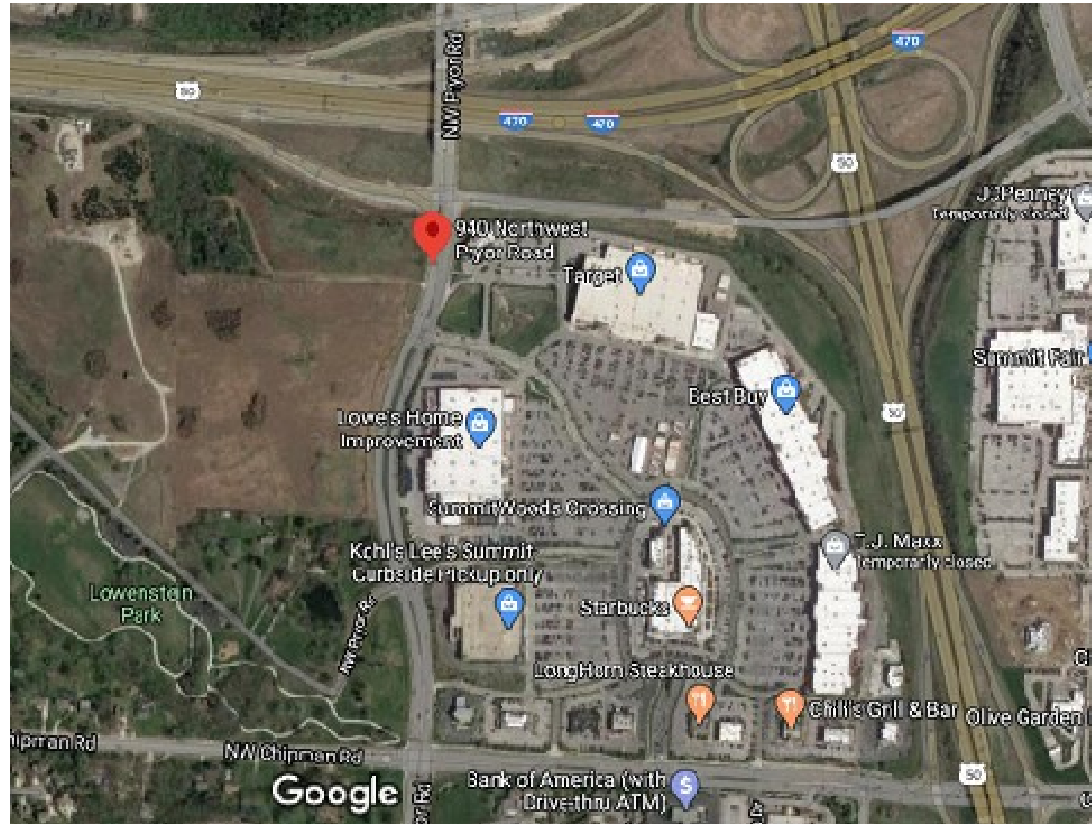

PROJECT TEAM

MIDWEST CUSTOM POOLS

GLEN WESTERVELT, PRESIDENT
785.766.1111
GLEN@MIDWESTCUSTOMPOOLS.COM

CLINT PINNICK, PROJECT MANAGER
785.979.4955
CLINT@MIDWESTCUSTOMPOOLS.COM

POOL DATA

PERIMETER: 224 - FT

SURFACE AREA: 2050 - SQFT

APPROXIMATE VOLUME: 45,000 - GALLONS

MINIMUM TURNOVER: 4 TIMES PER 24 HRS

DESIGNED FLOW RATE: 125 - GPM

SAFETY

ALL DOORS LEADING TO POOL AREA TO HAVE KEY FOB LOCKS

BODY HOOK AND THROWABLE FLOATATION DEVICE ON 50' ROPE TO BE LOCATED WITHIN SITE OF THE POOL AND BE ACCESSABLE TO ALL USERS OF THE POOL

ALL SIGNAGE TO BE PROVIDED BY THE OWNER AND SHALL MEET THE HEALTH DEPT REQUIREMENTS

GENERAL NOTES

- > ANY CHANGES IN CONSTRUCTION PLANS OR EQUIPMENT MUST BE APPROVED BY THE COUNTY HEALTH DEPARTMENT. CHANGES MAY REQUIRE ADDITIONAL PLAN CHECK FEES AND RE-SUBMITTAL.
- > POOL PLAN APPROVAL DOES NOT AUTHORIZE THE VIOLATION OF ANY LAW, ORDINANCE, OR REGULATION AND FINAL APPROVAL IS SUBJECT TO FIELD INSPECTION.
- > ALL EQUIPMENT SHALL BE INSTALLED PER MANUFACTURER'S INSTRUCTIONS.

GENERAL NOTES

- > ALL EQUIPMENT AND MATERIALS NOT SHOWN OR SPECIFIED ON THESE PLANS, BUT REQUIRED TO COMPLETE THIS PROJECT, SHALL BE SUPPLIED BY THE POOL CONTRACTOR AS PART OF THIS CONTRACT WORK.
- > REINFORCING STEEL OF ALL AQUATIC FEATURES SHALL BE BONDED WITH A #8 COPPER WIRE. TIED BOND TO EACH MECHANICAL SYSTEM AND ALL RAIL ANCHORS AND METAL WITHIN 5 FT OF POOL EDGE.

GENERAL NOTES

- > ALL STEEL TO BE GRADE 40, #4 BAR AND A MINIMUM OF 12" ON CENTER EACH WAY HORIZONTAL AND VERTICAL. DAM WALLS 12" THICK TO HAVE A DOUBLE MAT OF STEEL
- > REINFORCING STEEL TO BE PLACED A MINIMUM OF 2" BELOW EXPOSED FACE OF CONCRETE

SHEET INDEX

SD0.00	COVER SHEET
SD1.01	SUBMITTALS
SD2.01	LAYOUT PLAN
SD3.01	PLUMBING PLAN - SUCTION
SD3.02	PLUMBING PLAN - RETURN
SD4.01	LIGHTING PLAN
SD5.01	BONDING PLAN
SD6.01	PROFILE & REBAR PLAN
SD8.01	DETAILS

SPECIFICATIONS

- > 4 FT. MAX WATER DEPTH
- > (2) MAIN DRAINS
- > (9) SURFACE SKIMMERS
- > (9) RETURNS
- > (1) 3 HP VARIABLE SPEED CIRCULATION PUMP
- > (12) LED LIGHTS
- > (1) 48" SAND FILTER
- > (1) LIQUID CHLORINE SANITATION SYSTEM
- > (1) 400K BTU ASME NATURAL GAS HEATER
- > (1) ADA CHAIR LIFT
- > INTELLICHEM CHEMICAL AUTOMATION W/ ACID & CHLORINE INJECTION SYSTEM
- > AUTOFILL WATER LEVEL SYSTEM
- > WATER LINE TILE, STANDARD
- > DEPTH MARKER TILES IN WATER LINE AND COPING
- > SUPER BLUE QUARTZ INTERIOR FINISH
- > MARKER RIBBON, 2 ROWS OF 1" TILE, STANDARD
- > SAFETY GRIP COPING
- > GEO FOAM FORMING SYSTEM

CODE COMPLIANCE

- > ANSI POOL AND SPA STANDARD TO PREVENT SUCTION ENTRAPMENT
- > VIRGINIA GRAEME BAKER SAFETY ACT
- > COUNTY ENVIRONMENTAL SANITARY CODE
- > COUNTY CODE OF REGULATIONS FOR BUILDINGS AND CONSTRUCTION.

MIDWEST CUSTOM POOLS
600 Lincoln Street
Lawrence, KS 66044
P. 785.843.9119
F. 785.843.6524
MidwestCustomPools.com



Summit at West Pryor
940 NW Pryor Road
Lee's Summit, MO 64081

Plan Date:
05.26.2020

Drawn By: DN

SHEET NO.
SD0.00

MASTERTEMP®

FAST EFFICIENT AND BUILT TO ENHANCE YOUR POOL ENJOYMENT

pentairpool.com

INTELLIFLOXF^{VSF}

VARIABLE SPEED AND FLOW PUMP

PRECISE FLOW CONTROL, AND HIGHEST AVAILABLE SAVINGS IN OUR MOST EFFICIENT PUMPS.

pentairpool.com

P6® Roll Top Hardcover Spill Pallet

PAK001 Holds (2) 55 gal. Plastic or Steel Drums, 87.5" x 41.25" x 74", 66 gal. Pump Capacity

Load your drums into our roomy roll top hard covers for all-weather protection and liquid containment. You don't even have to remove pumps and funnels!

- Roll top slides up for easy access to drum tops while the rest of the unit stays closed, store drums with pumps or funnels in place
- Lower-profile pallet with sump catches leaks, drips and spills while keeping drum tops and accessories within reach
- Weather-resistant design prevents contaminants from entering stormwater
- Heavy-duty construction allows hardscove and pallet to be filled by a forklift with drums in place
- Low-density polyethylene (LDPE) with UV inhibitors resists UV rays, rust, corrosion and most chemicals for long, trouble-free life
- Ergonomically designed roll top only goes down to waist height to eliminate bending and reaching
- Door and roll top can be secured with a padlock (sold separately)
- Durable swing-out doors on front for easy loading and unloading
- Optional .75" drain plug lets you empty sump without removing drums or grating

Item#	Description	Dimensions	Weight
PAK001-KWD	Knockout Down - Without Doors	87.5" W x 41.25" D x 74" H	345 lbs.
PAK001-KWD	Knockout Down - With Doors	87.5" W x 41.25" D x 74" H	345 lbs.
PAK001-KWD	Assembled - Without Doors	87.5" W x 41.25" D x 74" H	345 lbs.
PAK001-KWD	Assembled - With Doors	87.5" W x 41.25" D x 74" H	345 lbs.

Metric Equivalent:

Item#	Description	Dimensions	Weight
PAK001-KWD	Knockout Down - Without Doors	171.5cm W x 104.8cm D x 190.5cm H	156.8 kg
PAK001-KWD	Knockout Down - With Doors	171.5cm W x 104.8cm D x 190.5cm H	156.8 kg

NOTE

Each 90-degree elbow reduces the maximum horizontal PVC air intake duct run by 12 feet and each 45-degree elbow in the PVC air intake duct run reduces the maximum run by 15 feet. See the Table 1 for the maximum lengths using 90-degree elbows.

Combination 3 in. PVC Pipe (Indoor or Outdoor)	Minimum Length (Feet)
1	12
2	18
3	24
4	30
5	36

Table 1.

Direct Air Intake Duct with 3-inch PVC Pipe (Indoor Installation) (MasterTemp® Heater shown)

WARNING!

DO NOT USE PVC PIPE FOR FUEL EXHAUST VENT TEMPERATURES CAN EXCEED 400°F. FUEL EXHAUST VENT MUST BE CATEGORY I OR CATEGORY II METAL VENT.

AUTOMATIC WATER FILLER

Protect your pool equipment by ensuring proper water level.

Pentair.com

INTELLICHEM®

COMBUSTIBLE POWER CHEMISTRY CONTROLLER

ULTIMATE POOL CHEMICAL MANAGEMENT AND CONVENIENCE

Step up your pool's chemical management with IntelliChem, the ultimate pool chemical management system. The IntelliChem system automatically controls your pool's chemical levels, ensuring you always have the right amount of chemicals to keep your pool clean, clear, and safe to enjoy, anytime.

With the IntelliChem system, you can manage your pool's chemical levels with the touch of a button.

STANDARD FEATURES

- IntelliChem's chemical management system is designed to keep your pool's chemical levels at the optimal level, ensuring you always have the right amount of chemicals to keep your pool clean, clear, and safe to enjoy, anytime.
- IntelliChem's chemical management system is designed to keep your pool's chemical levels at the optimal level, ensuring you always have the right amount of chemicals to keep your pool clean, clear, and safe to enjoy, anytime.

INTELLICHEM®

COMBUSTIBLE POWER CHEMISTRY CONTROLLER

ULTIMATE POOL CHEMICAL MANAGEMENT AND CONVENIENCE

Step up your pool's chemical management with IntelliChem, the ultimate pool chemical management system. The IntelliChem system automatically controls your pool's chemical levels, ensuring you always have the right amount of chemicals to keep your pool clean, clear, and safe to enjoy, anytime.

With the IntelliChem system, you can manage your pool's chemical levels with the touch of a button.

STANDARD FEATURES

- IntelliChem's chemical management system is designed to keep your pool's chemical levels at the optimal level, ensuring you always have the right amount of chemicals to keep your pool clean, clear, and safe to enjoy, anytime.
- IntelliChem's chemical management system is designed to keep your pool's chemical levels at the optimal level, ensuring you always have the right amount of chemicals to keep your pool clean, clear, and safe to enjoy, anytime.

FullFloXF™

2-Way and 3-Way Diverter Valve and Check Valve

Installation and Operation Instructions

WARNING! PLEASE READ THESE INSTRUCTIONS CAREFULLY BEFORE INSTALLING THIS VALVE. THIS VALVE IS NOT INSTALLED AND OPERATED IN ANY MANNER OTHER THAN THAT SPECIFIED IN THESE INSTRUCTIONS. FAILURE TO FOLLOW THESE INSTRUCTIONS MAY RESULT IN DAMAGE TO THE VALVE, THE POOL, OR PERSONAL INJURY. THE INSTALLER IS RESPONSIBLE FOR THE PROPER INSTALLATION AND OPERATION OF THIS VALVE.

WARNING! DO NOT EXCEED THE MAXIMUM FLOW RATE OF 10 GPM (38 LPM) FOR THE 2-WAY VALVE AND 15 GPM (57 LPM) FOR THE 3-WAY VALVE. EXCEEDING THESE FLOW RATES MAY RESULT IN DAMAGE TO THE VALVE, THE POOL, OR PERSONAL INJURY.

IMPORTANT NOTICE: Attention Installer: The IntelliFloXF™ 2-Way and 3-Way Diverter Valve and Check Valve is designed to be used in a pool's circulation system. It is not designed to be used in a hot tub or spa. The IntelliFloXF™ 2-Way and 3-Way Diverter Valve and Check Valve is not designed to be used in a pool's circulation system if the pool's circulation system is not properly maintained. The IntelliFloXF™ 2-Way and 3-Way Diverter Valve and Check Valve is not designed to be used in a pool's circulation system if the pool's circulation system is not properly maintained.

2-Way & 3-Way Diverter Valve (2-1/2" Socket x 3" Spigot)

The IntelliFloXF™ 2-Way and 3-Way Diverter Valve and Check Valve is designed to be used in a pool's circulation system. It is not designed to be used in a hot tub or spa. The IntelliFloXF™ 2-Way and 3-Way Diverter Valve and Check Valve is not designed to be used in a pool's circulation system if the pool's circulation system is not properly maintained. The IntelliFloXF™ 2-Way and 3-Way Diverter Valve and Check Valve is not designed to be used in a pool's circulation system if the pool's circulation system is not properly maintained.

Figure 1: 2-Way Diverter Valve

Figure 2: 3-Way Diverter Valve Ports

Stair Rails – 3-Bend

Three Bend

• Taking 1 1/2" OD
• Wall Thickness .049" or .063"
• Stainless Steel 304 or 316 Marine Grade** (add .10 to part number)
• Bend: 90°/180°
• Options: Powder-coating and Sealed/Sealant Sealant
• Recommended minimum: 1/4" (6.35mm) (order separately)
• Recommended maximum: 1/2" (12.7mm) (order separately)
• Minimum wall thickness: .049" for 304/316 Marine Grade

Part #	Length (ft)	Weight (lb)	Material
SR304-12	12	1.2	304
SR304-18	18	1.8	304
SR304-24	24	2.4	304
SR304-30	30	3.0	304
SR304-36	36	3.6	304
SR304-42	42	4.2	304
SR304-48	48	4.8	304
SR304-54	54	5.4	304
SR304-60	60	6.0	304
SR304-66	66	6.6	304
SR304-72	72	7.2	304
SR304-78	78	7.8	304
SR304-84	84	8.4	304
SR304-90	90	9.0	304
SR304-96	96	9.6	304
SR304-102	102	10.2	304
SR304-108	108	10.8	304
SR304-114	114	11.4	304
SR304-120	120	12.0	304
SR304-126	126	12.6	304
SR304-132	132	13.2	304
SR304-138	138	13.8	304
SR304-144	144	14.4	304
SR304-150	150	15.0	304
SR304-156	156	15.6	304
SR304-162	162	16.2	304
SR304-168	168	16.8	304
SR304-174	174	17.4	304
SR304-180	180	18.0	304
SR304-186	186	18.6	304
SR304-192	192	19.2	304
SR304-198	198	19.8	304
SR304-204	204	20.4	304
SR304-210	210	21.0	304
SR304-216	216	21.6	304
SR304-222	222	22.2	304
SR304-228	228	22.8	304
SR304-234	234	23.4	304
SR304-240	240	24.0	304
SR304-246	246	24.6	304
SR304-252	252	25.2	304
SR304-258	258	25.8	304
SR304-264	264	26.4	304
SR304-270	270	27.0	304
SR304-276	276	27.6	304
SR304-282	282	28.2	304
SR304-288	288	28.8	304
SR304-294	294	29.4	304
SR304-300	300	30.0	304
SR304-306	306	30.6	304
SR304-312	312	31.2	304
SR304-318	318	31.8	304
SR304-324	324	32.4	304
SR304-330	330	33.0	304
SR304-336	336	33.6	304
SR304-342	342	34.2	304
SR304-348	348	34.8	304
SR304-354	354	35.4	304
SR304-360	360	36.0	304
SR304-366	366	36.6	304
SR304-372	372	37.2	304
SR304-378	378	37.8	304
SR304-384	384	38.4	304
SR304-390	390	39.0	304
SR304-396	396	39.6	304
SR304-402	402	40.2	304
SR304-408	408	40.8	304
SR304-414	414	41.4	304
SR304-420	420	42.0	304
SR304-426	426	42.6	304
SR304-432	432	43.2	304
SR304-438	438	43.8	304
SR304-444	444	44.4	304
SR304-450	450	45.0	304
SR304-456	456	45.6	304
SR304-462	462	46.2	304
SR304-468	468	46.8	304
SR304-474	474	47.4	304
SR304-480	480	48.0	304
SR304-486	486	48.6	304
SR304-492	492	49.2	304
SR304-498	498	49.8	304
SR304-504	504	50.4	304
SR304-510	510	51.0	304
SR304-516	516	51.6	304
SR304-522	522	52.2	304
SR304-528	528	52.8	304
SR304-534	534	53.4	304
SR304-540	540	54.0	304
SR304-546	546	54.6	304
SR304-552	552	55.2	304
SR304-558	558	55.8	304
SR304-564	564	56.4	304
SR304-570	570	57.0	304
SR304-576	576	57.6	304
SR304-582	582	58.2	304
SR304-588	588	58.8	304
SR304-594	594	59.4	304
SR304-600	600	60.0	304
SR304-606	606	60.6	304
SR304-612	612	61.2	304
SR304-618	618	61.8	304
SR304-624	624	62.4	304
SR304-630	630	63.0	304
SR304-636	636	63.6	304
SR304-642	642	64.2	304
SR304-648	648	64.8	304
SR304-654	654	65.4	304
SR304-660	660	66.0	304
SR304-666	666	66.6	304
SR304-672	672	67.2	304
SR304-678	678	67.8	304
SR304-684	684	68.4	304
SR304-690	690	69.0	304
SR304-696	696	69.6	304
SR304-702	702	70.2	304
SR304-708	708	70.8	304
SR304-714	714	71.4	304
SR304-720	720	72.0	304
SR304-726	726	72.6	304
SR304-732	732	73.2	304
SR304-738	738	73.8	304
SR304-744	744	74.4	304
SR304-750	750	75.0	304
SR304-756	756	75.6	304
SR304-762	762	76.2	304
SR304-768	768	76.8	304
SR304-774	774	77.4	304
SR304-780	780	78.0	304
SR304-786	786	78.6	304
SR304-792	792	79.2	304
SR304-798	798	79.8	304
SR304-804	804	80.4	304
SR304-810	810	81.0	304
SR304-816	816	81.6	304
SR304-822	822	82.2	304
SR304-828	828	82.8	304
SR304-834	834	83.4	304
SR304-840	840	84.0	304
SR304-846	846	84.6	304
SR304-852	852	85.2	304
SR304-858	858	85.8	304
SR304-864	864	86.4	304
SR304-870	870	87.0	304
SR304-876	876	87.6	304
SR304-882	882	88.2	304
SR304-888	888	88.8	304
SR304-894	894	89.4	304
SR304-900	900	90.0	304
SR304-906	906	90.6	304
SR304-912	912	91.2	304
SR304-918	918	91.8	304
SR304-924	924	92.4	304
SR304-930	930	93.0	304
SR304-936	936	93.6	304
SR304-942	942	94.2	304
SR304-948	948	94.8	304
SR304-954	954	95.4	304
SR304-960	960	96.0	304
SR304-966	966	96.6	304
SR304-972	972	97.2	304
SR304-978	978	97.8	304
SR304-984	984	98.4	304
SR304-990	990	99.0	304
SR304-996	996	99.6	304
SR304-1000	1000	100.0	304

www.essentia.com / 800.824.4587

GLOBRITE®

POOL AND SPA LED LIGHTS

ADD THE MAGIC AND VIBRANCY OF WHITE LED LIGHTING

GLOBRITE White LED Lights are engineered with the highest, most efficient LED light technology on the market today.

- LED array creates powerful, brilliant white light with no flicker.
- Uses only 10 watts to deliver the equivalent of 100 watts of incandescent light.
- Two driving lights on each side of the light fixture, providing a wide area of light.
- Sealed design with no moving parts, no maintenance required.

Combine us to learn more about GLOBRITE lights.

AVAILABLE FROM:

1-800-875-5273

INTELLIFLOXF^{VSF}

VARIABLE SPEED AND FLOW PUMP

PRECISE FLOW CONTROL, AND HIGHEST AVAILABLE SAVINGS IN OUR MOST EFFICIENT PUMPS.

pentairpool.com

ADA COMPLIANT POOL LIFTS

SPECTRUM Motion Trek 350

The Motion Trek 350 is an ADA compliant battery powered lift that is self operable from the deck and water with a robust operating system. The Motion Trek 350 is designed for in-ground pools and spas.

- Fully ADA Compliant
- 350 pound operating load capacity
- Self operable from the deck and water
- 30 lifts per battery charge
- All stainless steel construction (electropolished 304L grade)
- Coated with Spectra Shield® for maximum corrosion protection
- Stabilizer bar significantly improves lift stability during transfer
- Spacious seat with excellent lumbar support designed for ease of transfer
- Rotationally and vertically powered with 360 degree continuous powered rotation
- Proprietary Robust Operating System and Actuator outperforms the competition
- Accommodates pool wall setback of 6" to 22" and water draft up to 12"
- Easy to install, even into existing concrete decks
- Improved rotation system for a smooth ride

Part# 15321 - LIFT INCLUDES:

- One watertight hardwired remote control
- Battery and battery charger
- Two armrests

ADDITIONAL OPTIONS:

- Lift Cover
- Lift Kit
- Battery

700 Spectrum Lane, Madison, WI 53606 • 800.798.8056 • SPECTRUM-AQUATICS.COM

Model: PX100 and PX100S - 100 W Transformers</

MASTERTEMP®

MASTERTEMP®

VARIABLE SPEED HEATER

FAST, EFFICIENT AND BUILT TO ENHANCE YOUR POOL ENJOYMENT

NOTE

Each 90-degree elbow reduces the maximum horizontal PVC air intake duct run by 12 feet and each 45-degree elbow in the PVC air intake duct run reduces the maximum run by 15 feet. See the Table 1 for the maximum lengths using 90-degree elbows.

COMBINATION 3 IN. PVC PIPE

MIN. AIR INTAKE DUCT REQUIREMENTS

DUCT SIZE (Inches)	MINIMUM LENGTH (Feet)
3"	120.0
4"	144.0
6"	216.0
8"	288.0

WARNING!

DO NOT USE PVC PIPE FOR FUEL EXHAUST. FUEL EXHAUST TEMPERATURES CAN EXCEED 400°F. FUEL EXHAUST VENT MUST BE CATEGORY 1 OR CATEGORY 2 METAL VENT.

Direct Air Intake Duct with 3-inch PVC Pipe (Indoor Installation) (MasterTemp® Heater shown)

AUTOMATIC WATER FILLER

AUTOMATIC WATER FILLER

Protect your pool equipment by ensuring proper water level.

Pentair.com

INTELLICHEM®

COMBUSTIBLE POWER CHEMISTRY CONTROLLER

ULTIMATE POOL CHEMICAL MANAGEMENT AND CONVENIENCE

STANDARD FEATURES

- The use of IntelliChem's intelligent chemistry control system offers the ability to keep track of pH and ORP levels and make adjustments locally or remotely.
- Compatible with IntelliChem's IntelliChem Controllers, IntelliChem pumps and CO systems.
- IntelliChem's intelligent chemistry control system offers the ability to keep track of pH and ORP levels and make adjustments locally or remotely.
- IntelliChem's intelligent chemistry control system offers the ability to keep track of pH and ORP levels and make adjustments locally or remotely.

INTELLIFLOXF® VSF

PRECISE FLOW CONTROL, AND HIGHEST AVAILABLE SAVINGS IN OUR MOST EFFICIENT PUMP.

INTELLIFLOXF® VSF

PRECISE FLOW CONTROL, AND HIGHEST AVAILABLE SAVINGS IN OUR MOST EFFICIENT PUMP.

INTELLIFLOXF® VSF

PRECISE FLOW CONTROL, AND HIGHEST AVAILABLE SAVINGS IN OUR MOST EFFICIENT PUMP.

INTELLIFLOXF® VSF

PRECISE FLOW CONTROL, AND HIGHEST AVAILABLE SAVINGS IN OUR MOST EFFICIENT PUMP.

INTELLIFLOXF® VSF

PRECISE FLOW CONTROL, AND HIGHEST AVAILABLE SAVINGS IN OUR MOST EFFICIENT PUMP.

INTELLIFLOXF® VSF

PRECISE FLOW CONTROL, AND HIGHEST AVAILABLE SAVINGS IN OUR MOST EFFICIENT PUMP.

INTELLIFLOXF® VSF

PRECISE FLOW CONTROL, AND HIGHEST AVAILABLE SAVINGS IN OUR MOST EFFICIENT PUMP.

INTELLIFLOXF® VSF

PRECISE FLOW CONTROL, AND HIGHEST AVAILABLE SAVINGS IN OUR MOST EFFICIENT PUMP.

INTELLIFLOXF® VSF

PRECISE FLOW CONTROL, AND HIGHEST AVAILABLE SAVINGS IN OUR MOST EFFICIENT PUMP.

INTELLIFLOXF® VSF

PRECISE FLOW CONTROL, AND HIGHEST AVAILABLE SAVINGS IN OUR MOST EFFICIENT PUMP.

INTELLIFLOXF® VSF

PRECISE FLOW CONTROL, AND HIGHEST AVAILABLE SAVINGS IN OUR MOST EFFICIENT PUMP.

MIDWEST CUSTOM POOLS

600 Lincoln Street

Lawrence, KS 66044

P. 785.843.9119

F. 785.843.6524

MidwestCustomPools.com

Summit at West Pryor

940 NW Pryor Road

Lee's Summit, MO 64081

PROVIDED BY OTHERS

GENERAL NOTES:

1.POOL DESIGN AND INSTALLATION SHALL COMPLY WITH ANSI/NSPI-5 2003

2.POOL SHELL SHALL BE MONOLITHIC SHOTCRETE, MIN OF 8" THICK FREE OF JOINTS OR SEAMS (SUCH AS IN A POURED POOL SHELL). SHELL SHALL BE PLACED IN ONE DAY IF POSSIBLE, IF NOT FEATHER CUT OFF SECTION. CONCRETE SHALL MEET ASTM-C-34-62 TRANSIT MIX AND DEVELOP MIN 4000PSI COMPRESSIVE STRENGTH AT 7 DAYS

3.POOL DECK TO BE POURED IN PLACE CONCRETE AND SHALL DEVELOP MIN 4000 PSI COMPRESSIVE STRENGHT AT 28 DAYS

4.POOL DECKS SHALL CONTAIN AIR-ENTRAINING ADMIXTURE TO RESULT IN CONCRETE AT POINT OF PLACEMENT HAVING AIR-CONTENT OF 5 TO 7 PERCENT ENTRAINED AIR

5.ALL REINFORCING STEEL TO BE GRADE 40 OF BETTER. LAP ALL BARS MIN OF 40 DIAMETERS. TIE AT LEAST 50% OF ALL LAPS WITH AT LEAST 16 ga WIRE OR EQUAL, BEND ALL TIES DOWN

6.PLACE STEEL REINFORCEMENT IN TOP OF BOTTOM 1/3 OF CONCRETE

7.OWNER WHERE POSSIBLE KEEP SURFACE OF CONCRETE MOIST FOR 3 TO 4 DAYS AFTER PLACEMENT

8.INSTALL HYDROSTATIC RELIEF VALVE IN PRESENCE OF HIGH WATER TABLE

9.6" FROST PROOF, CERAMIC TILE SHALL BE PLACED AT WATERLINE OF POOL

10.CONCRETE DECKS ARE SUBJECT TO CRACKING, DUE TO SHRINKAGE, AND OR FREEZING AND EXPANSION SOILS

11.POOL PIPING SHALL BE SCHEDULE 40, TYPE 1 OR 2, PVC RIGID, NSF APPROVED

12.POOL LIGHTS SHALL BE SUPPLIED BY A GFCI OR GFI OUTLET

13.POOL LIGHTS SHALL BE INSTALLED ACCORDING TO NEC ARTICLE 680

14.ALL BONDING SHALL MEET THE SPECIFICATIONS IN NEC ARTICLE 680

15.POOL BONDING: ALL METAL WITHIN 5'-0" OF POOL WATER SHALL BE BONDED WITH A CONTINUOUS #8 BARE COPPER BOND WIRE, USING APPROVED CONNECTORS ONLY, PER NEC ARTICLE 680. BOND WIRE SHALL RUN AROUND THE PERIMETER OF THE POOL SHELL REBAR AND THE POOL DECK REBAR. THE BOND WIRE SHALL TERMINATE AT THE POOL EQUIPMENT. ALL METAL RAIL GOODS (LADDERS, GRAB RAILS, ETC.) SHALL BE INSTALLED USING AN APPROVED DECK ANCHOR AND BONDED TO DECK REBAR

Note handrail
changes on
SD5.058
revised
7-19-20

WORK TO BE DONE BY OTHERS

1. ALL ELECTRICAL WORK (BY OTHERS) MUST BE INSTALLED BY A LICENSED ELECTRICIAN IN ACCORDANCE WITH NEC AND APPLICABLE LOCAL CODES AND ORDINANCES.
2. BONDING SHALL BE PERFORMED IN ACCORDANCE WITH SECTION 680-25 OF NEC.
3. GAS LINE FOR HEATER BY OTHERS.
4. POOL DECK
5. DECK DRAINAGE BY OTHERS.
6. SANITARY LINE AND TERMINATION FOR BACKWASHING ARE BY OTHERS. MINIMUM FLOW RATE IS LISTED IN DESIGN DRAWINGS.
7. DOMESTIC WATER CONNECTIONS ARE BY OTHERS.
8. DRAINING OF POOL IS BY OTHERS.
9. REFERENCE AND FOLLOW THE GEOTECHNICAL REPORT FOR ALL PERTINENT INFORMATION REGARDING SITE CONDITIONS.
10. POOL VAULT

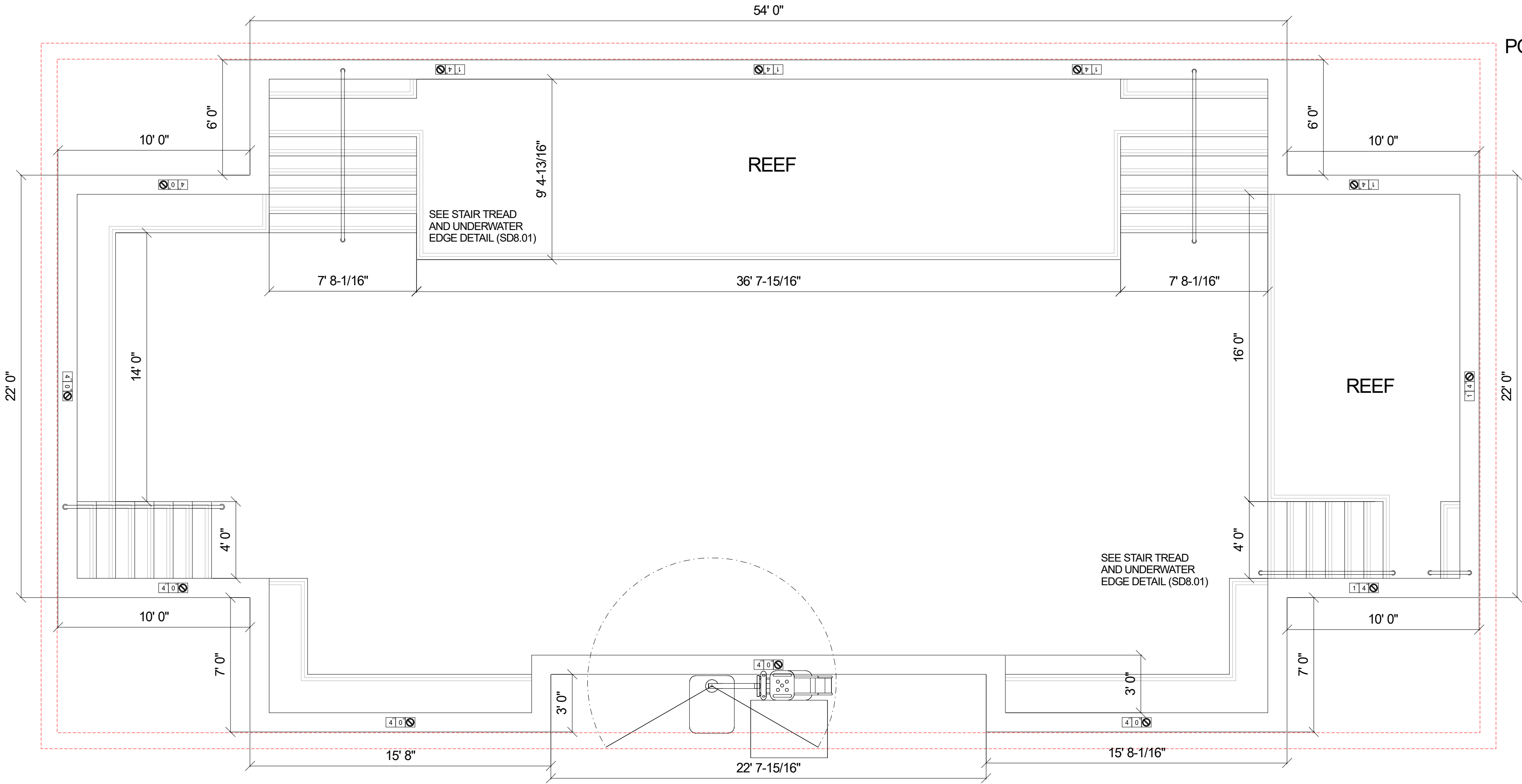

POOL VAULT (BY OTHERS)

MIDWEST CUSTOM POOLS
600 Lincoln Street
Lawrence, KS 66044
P. 785.843.9119
F. 785.843.6524
MidwestCustomPools.com



Summit at West Pryor
940 NW Pryor Road
Lee's Summit, MO 64081

Plan Date:
05.26.2020

Drawn By: DN

SHEET NO.
SD2.01

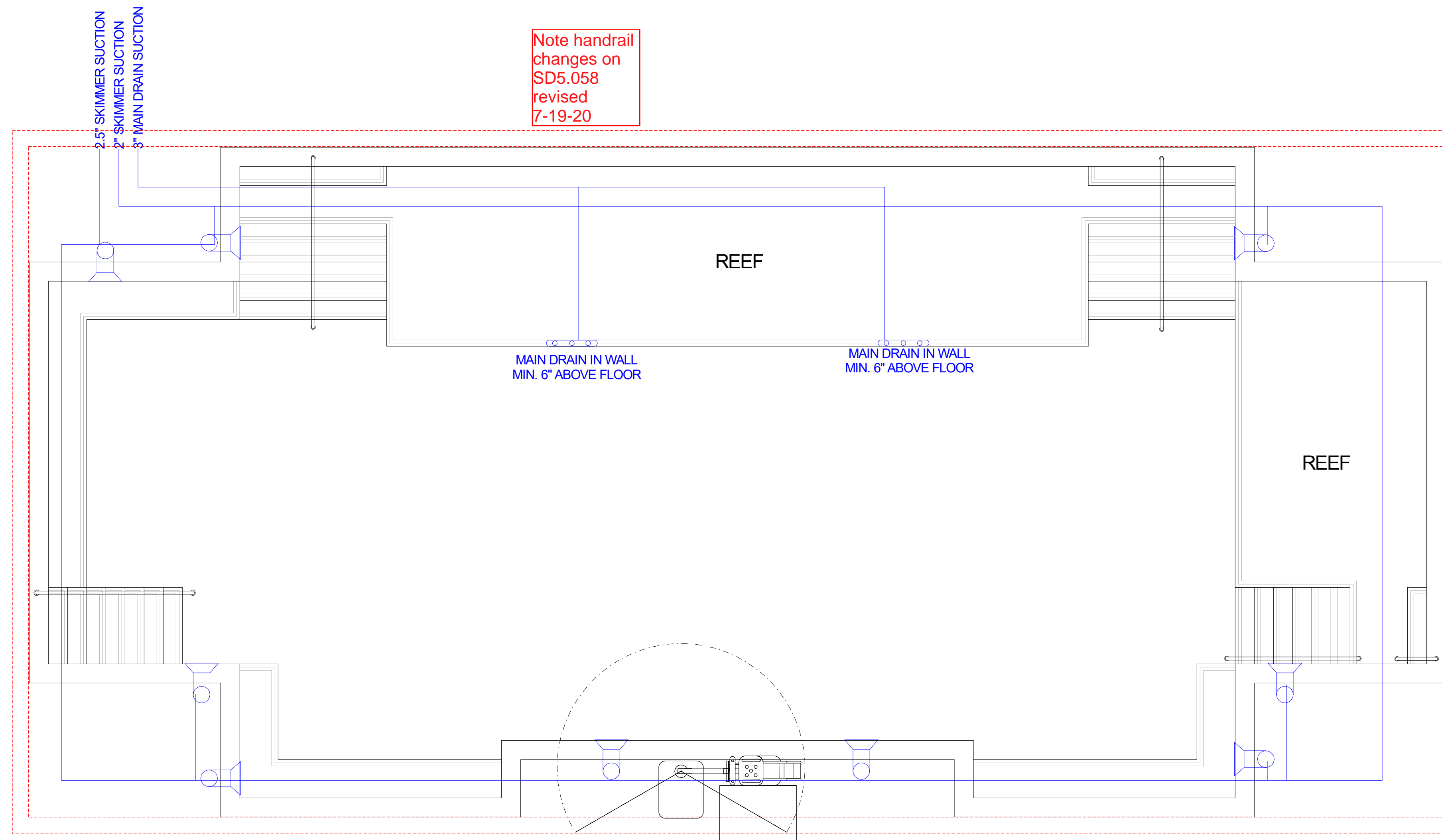
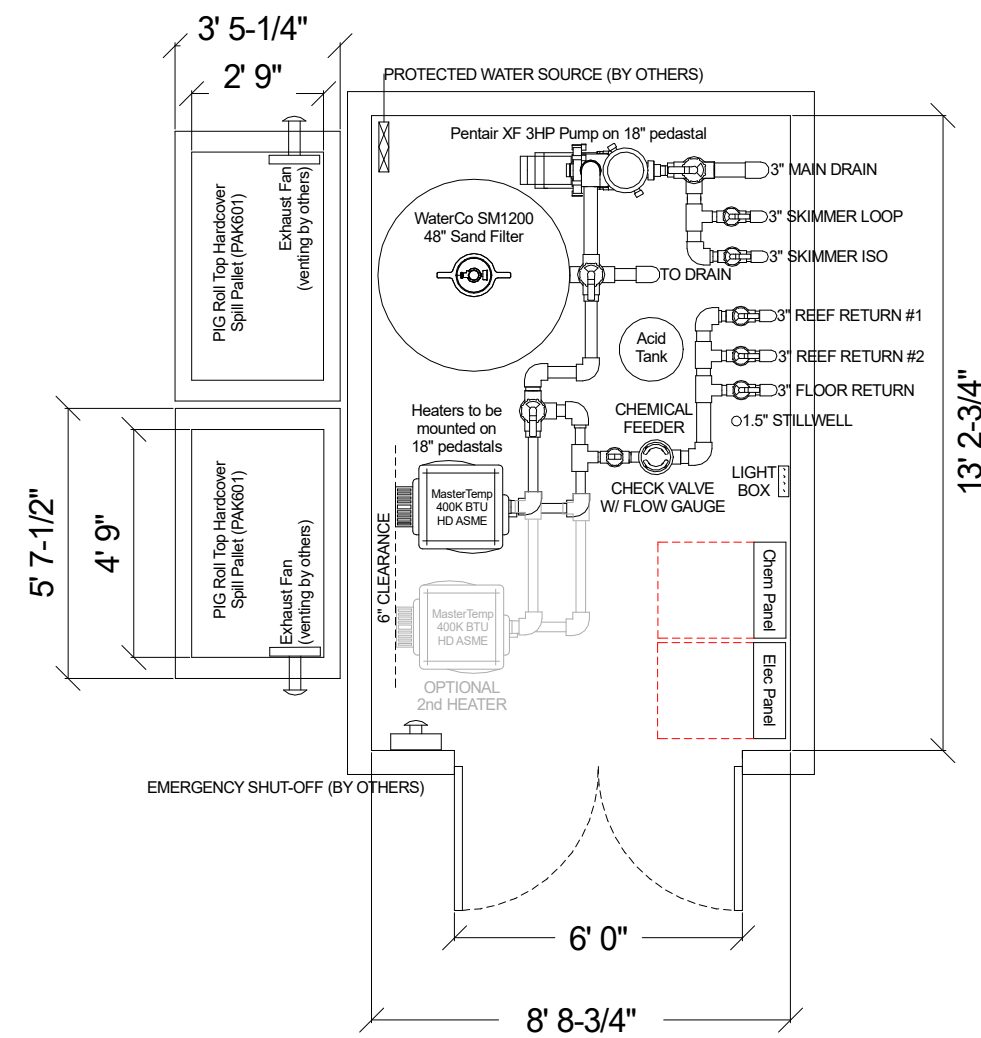

Note handrail
changes on
SD5.058
revised
7-19-20

POOL VAULT (BY OTHERS)

MIDWEST CUSTOM POOLS
600 Lincoln Street
Lawrence, KS 66044
P: 785.843.9119
F: 785.843.6524
MidwestCustomPools.com



Summit at West Pryor
940 NW Pryor Road
Lee's Summit, MO 64081

Plan Date:
05.26.2020

Drawn By: DN

SHEET NO.
SD3.01

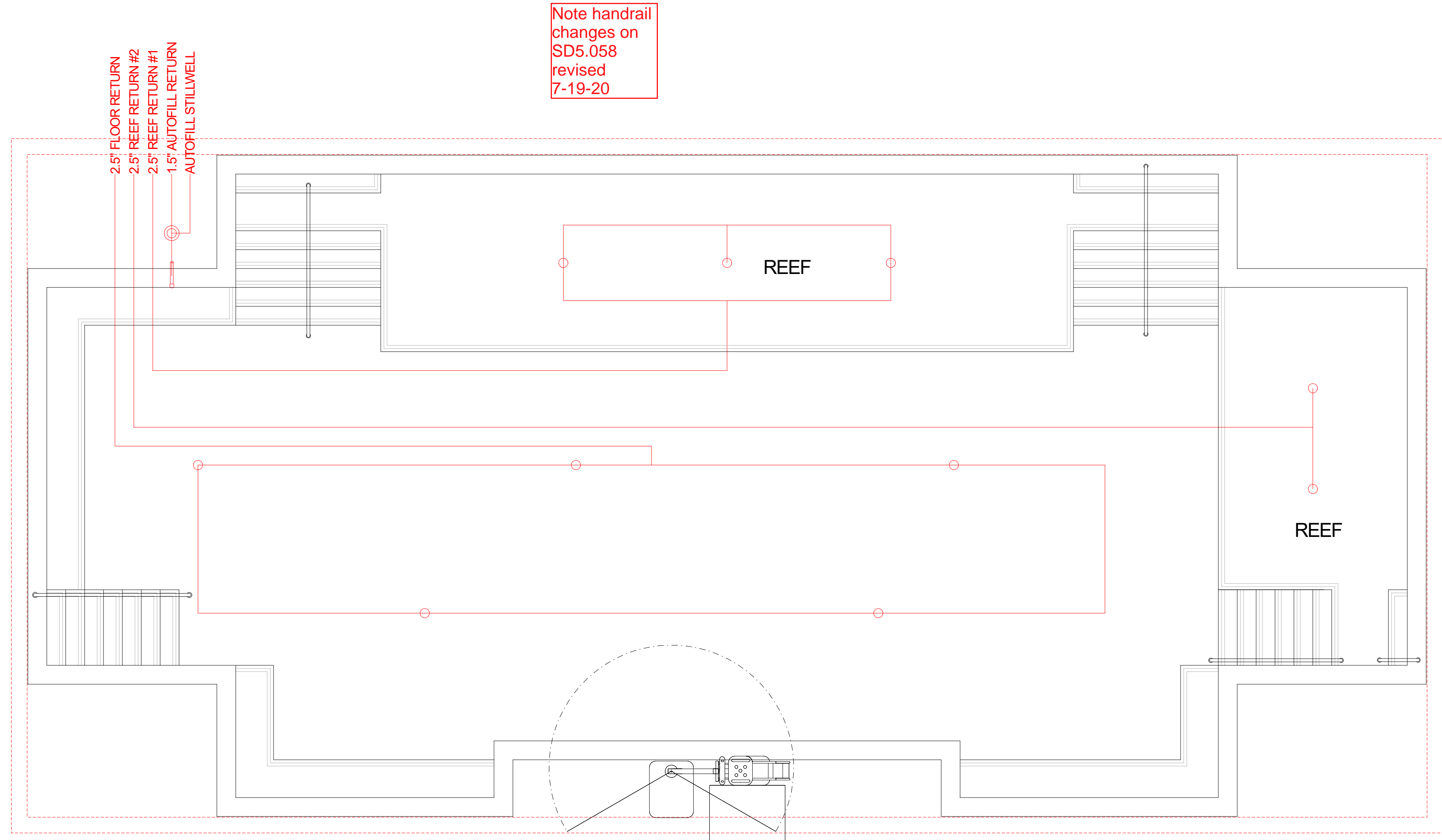
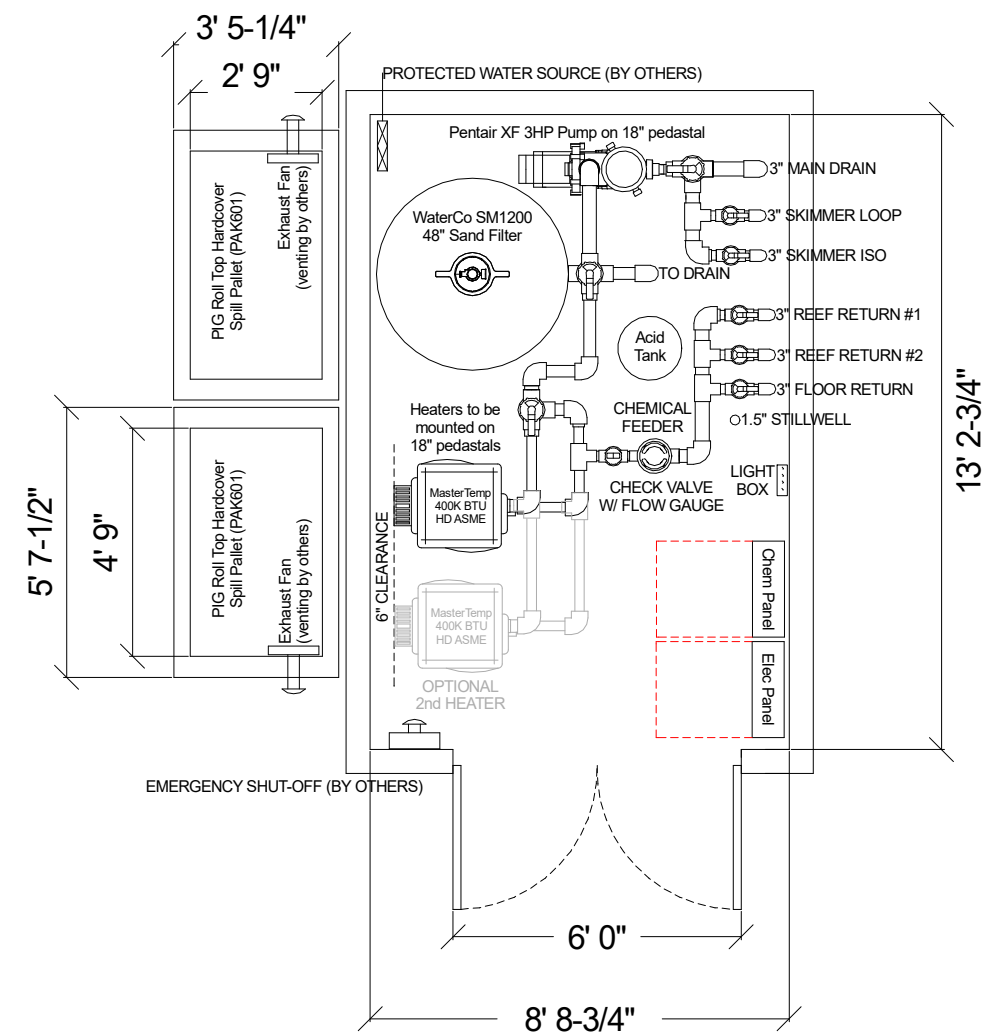

Note handrail
changes on
SD5.058
revised
7-19-20

POOL VAULT (BY OTHERS)



Summit at West Pryor
940 NW Pryor Road
Lee's Summit, MO 64081

Plan Date:
05.26.2020

Drawn By: DN

SHEET NO.
SD3.02

MIDWEST CUSTOM POOLS
600 Lincoln Street
Lawrence, KS 66044
P: 785.843.9119
F: 785.843.6524
MidwestCustomPools.com

1" LIGHTING CONDUITS
TO JUNCTION BOX IN
LANDSCAPE PLANTER

Note handrail
changes on
SD5.058
revised
7-19-20

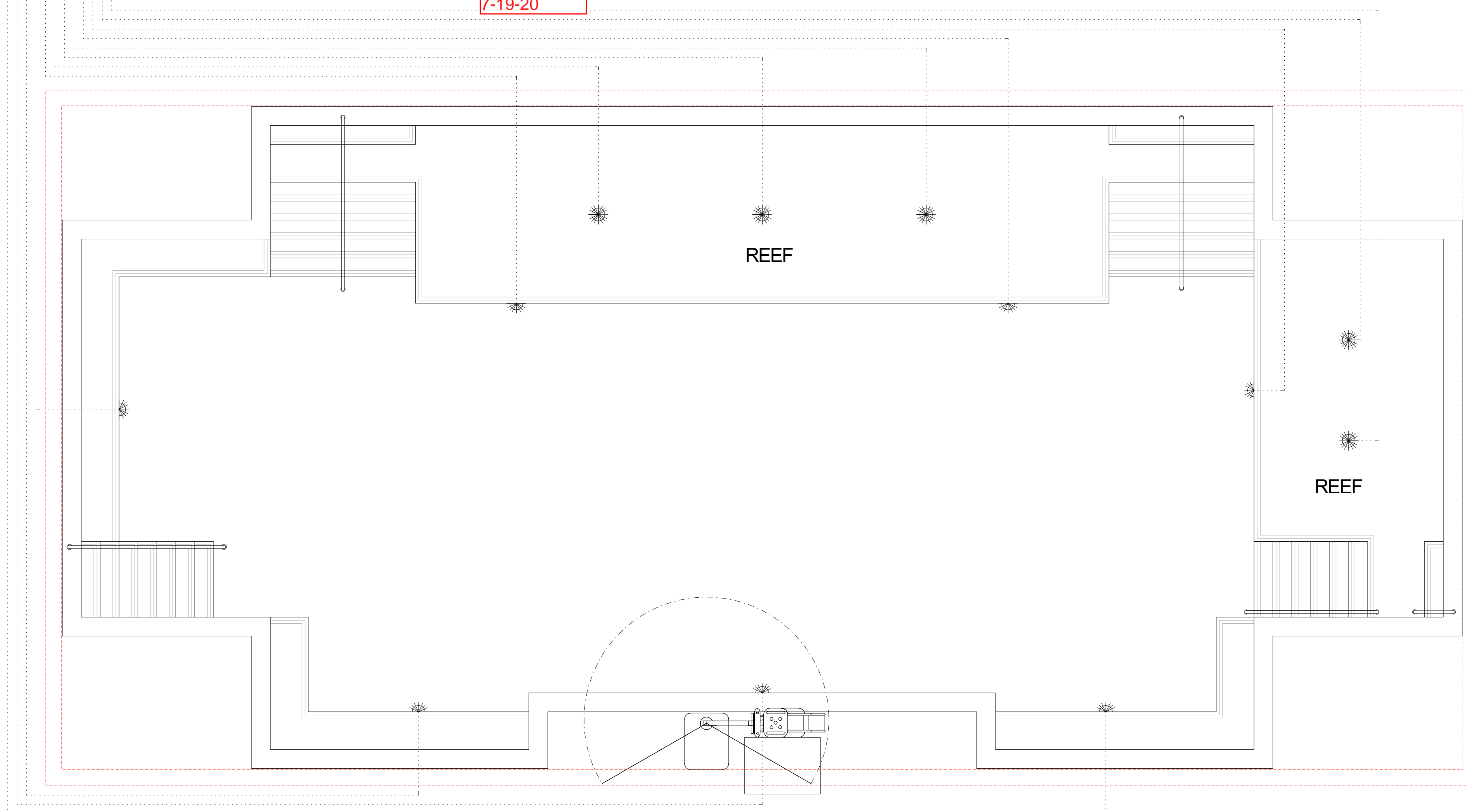

POOL VAULT (BY OTHERS)



Summit at West Pryor
940 NW Pryor Road
Lee's Summit, MO 64081

Plan Date:
05.26.2020

Drawn By: DN

SHEET NO.
SD4.01

MIDWEST CUSTOM POOLS
600 Lincoln Street
Lawrence, KS 66044
P: 785.843.9119
F: 785.843.6524
MidwestCustomPools.com



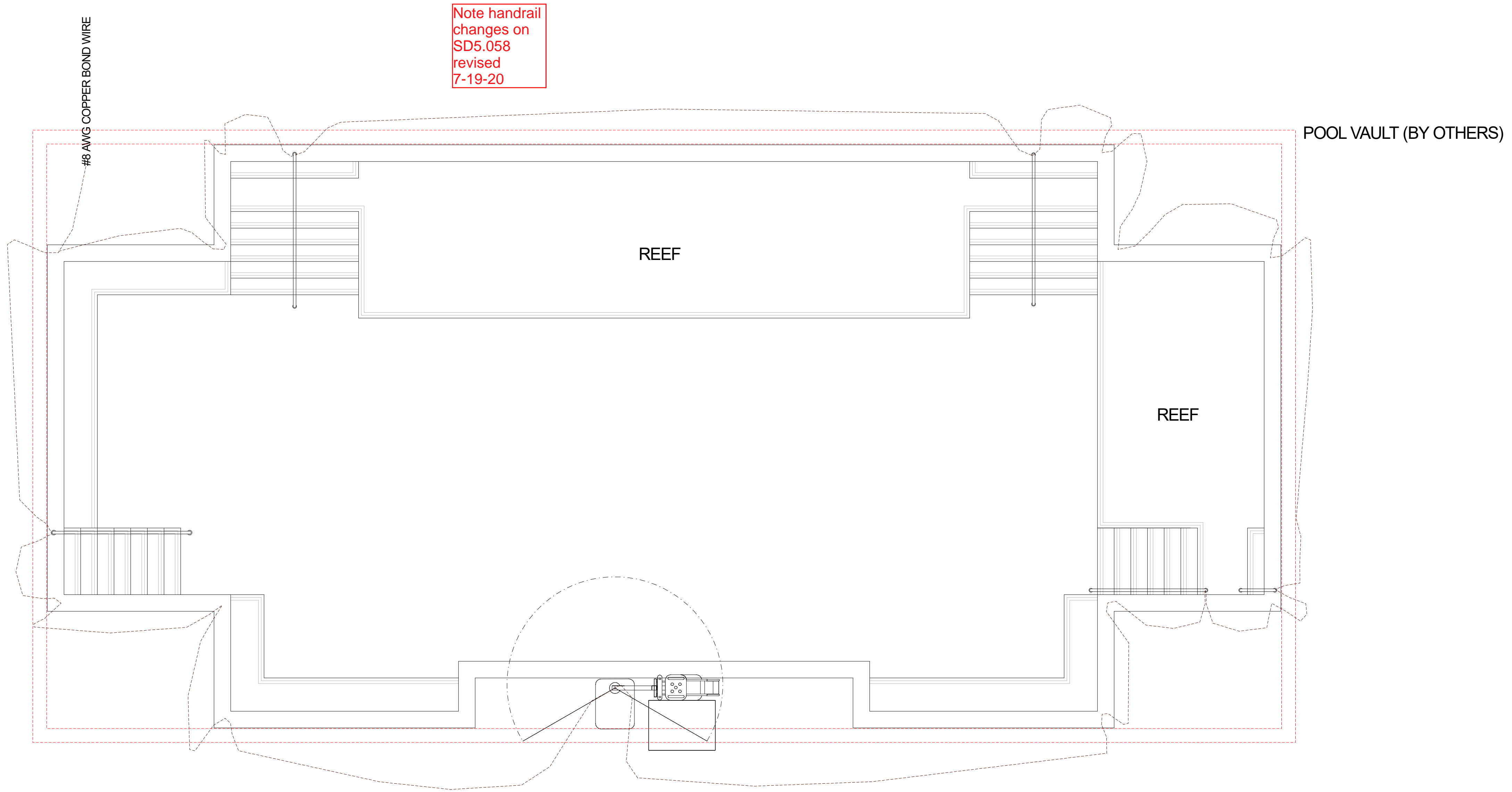

BONDING SHALL BE PERFORMED IN ACCORDANCE WITH SECTION 680.256 OF NEC

Summit at West Pryor
940 NW Pryor Road
Lee's Summit, MO 64081

Plan Date:
05.26.2020

Drawn By: DN

SHEET NO.
SD5.01



MIDWEST CUSTOM POOLS
600 Lincoln Street
Lawrence, KS 66044
P: 785.843.9119
F: 785.843.6524
MidwestCustomPools.com

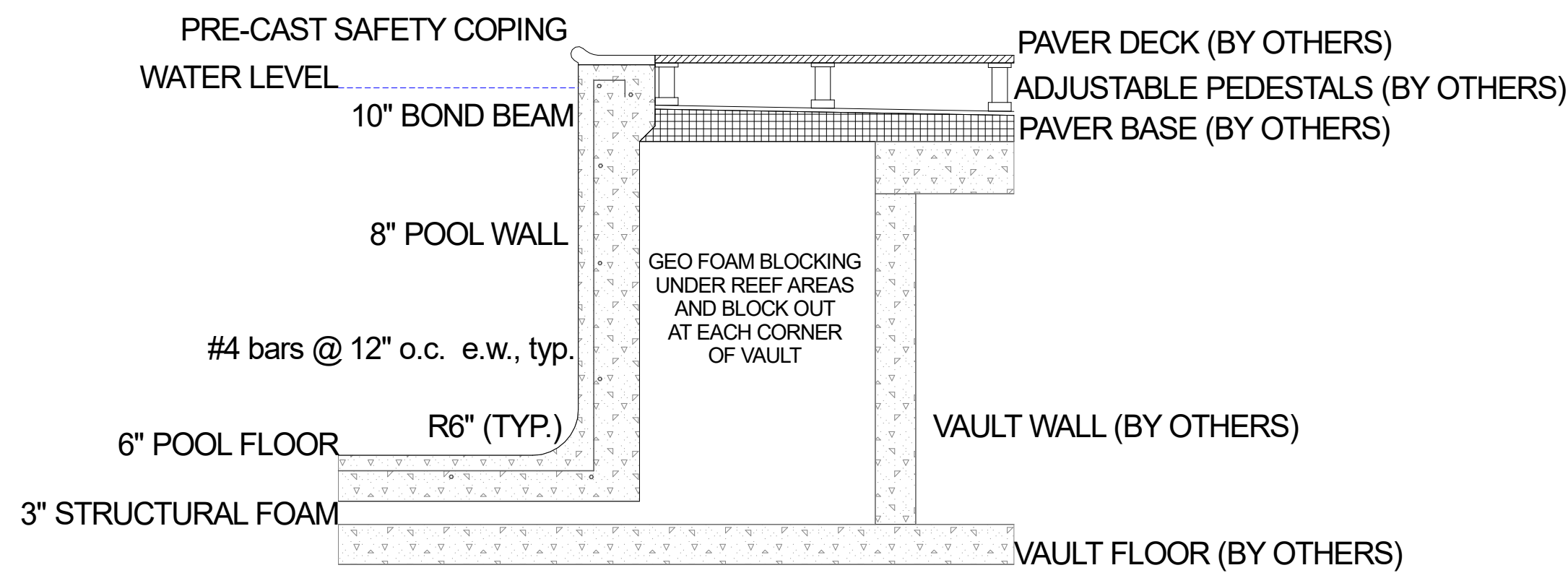

TYPICAL POOL WALL SECTION
NO SCALE

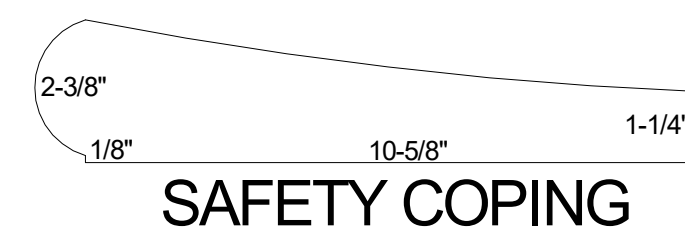

SAFETY COPING

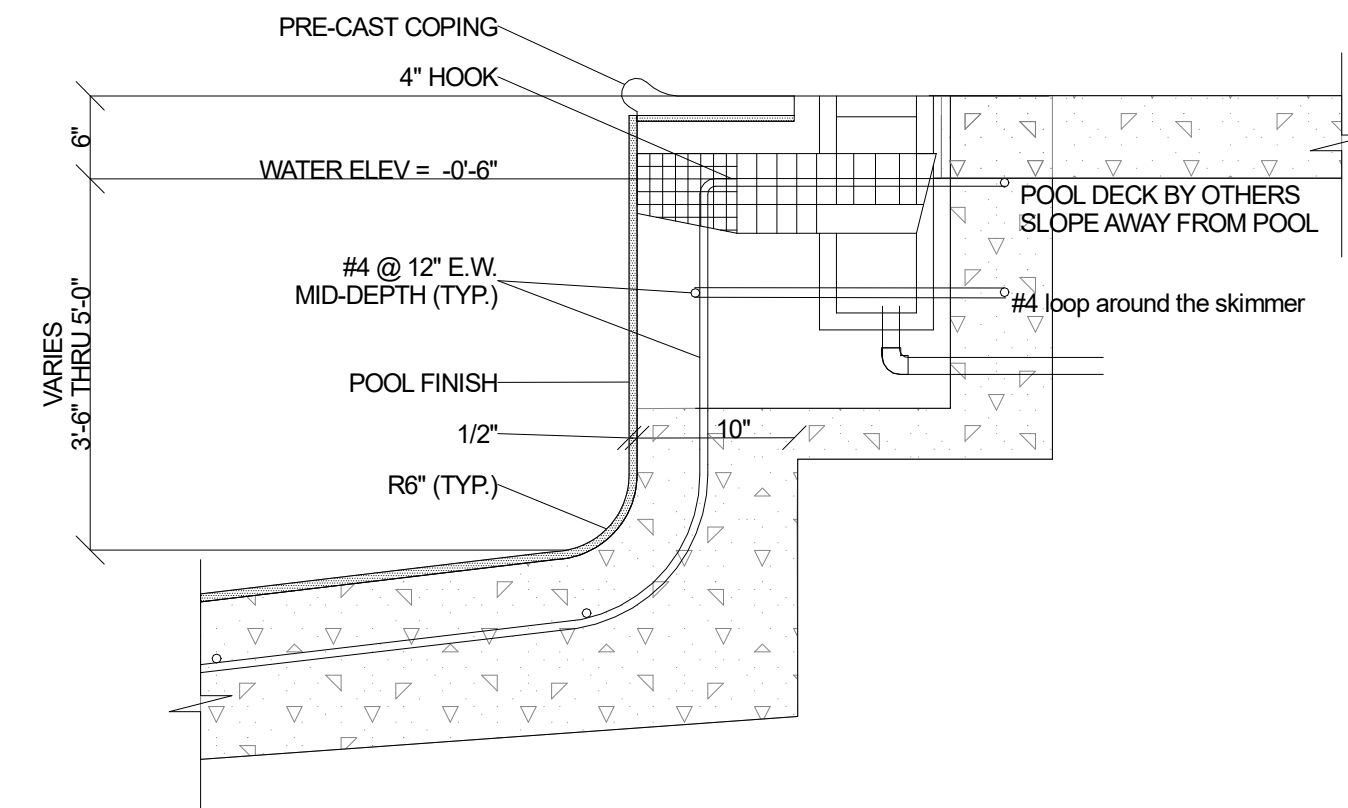

TYPICAL POOL SKIMMER SECTION
NO SCALE

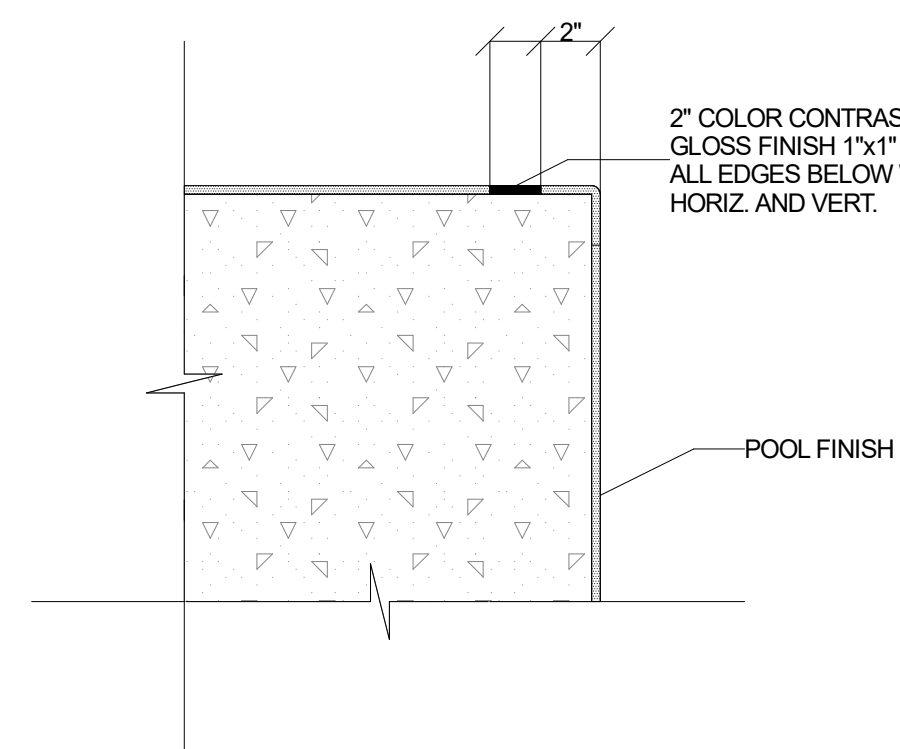

STAIR TREAD AND UNDER WATER EDGE DETAIL
NO SCALE

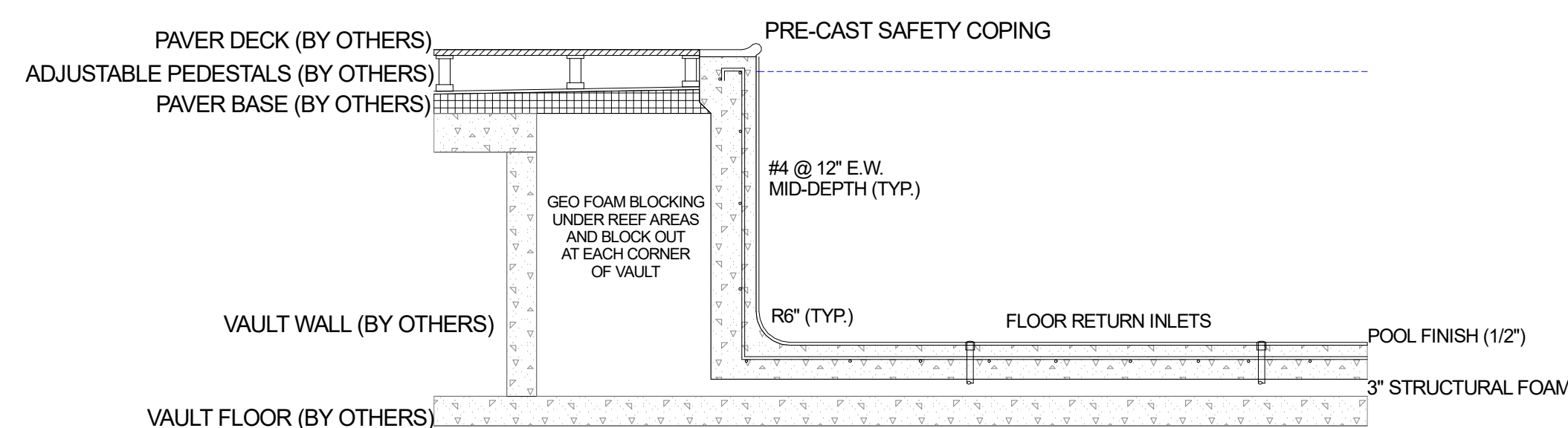

POOL RETURN DETAIL
NO SCALE

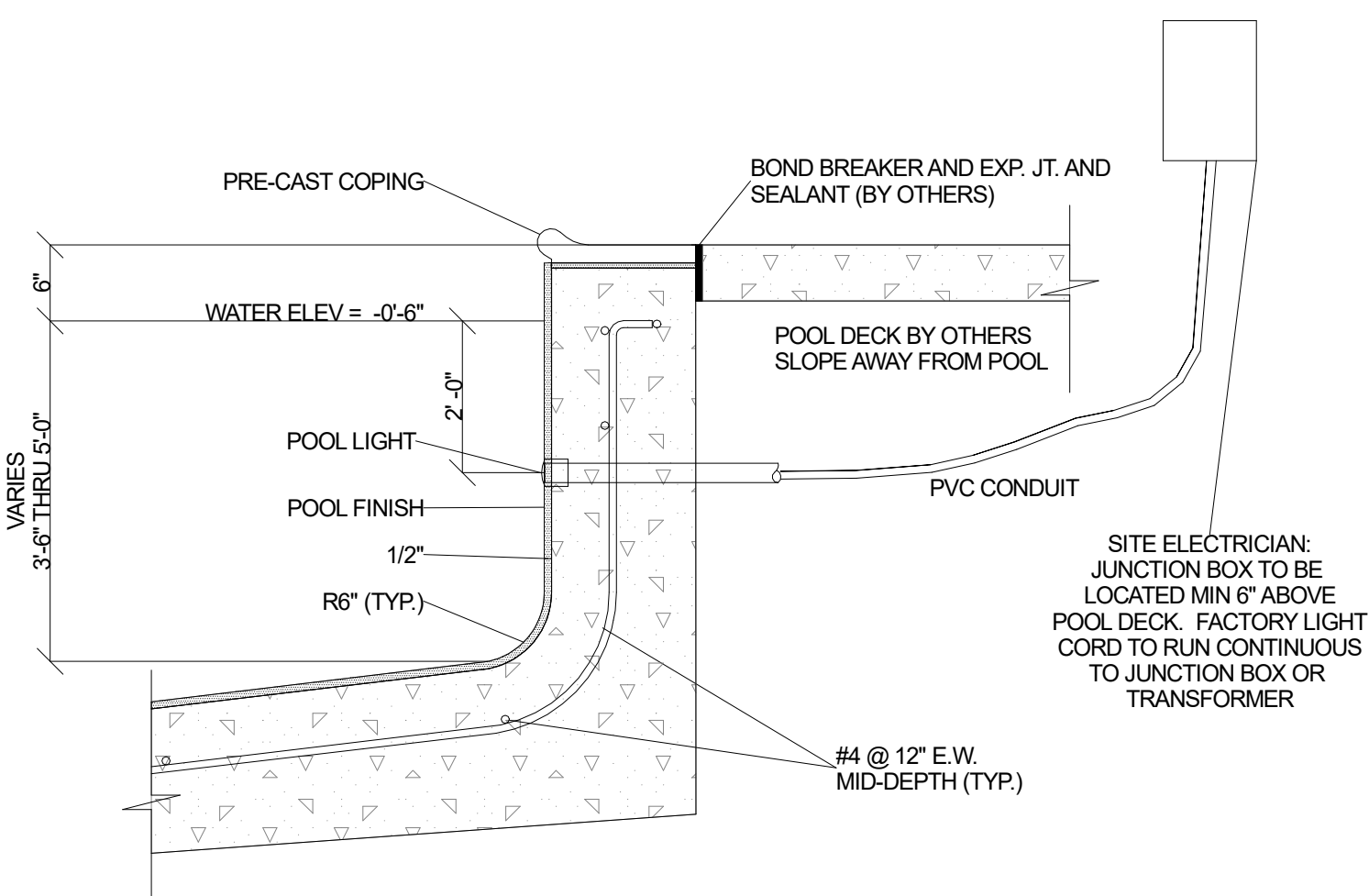

POOL LIGHT SECTION
NO SCALE

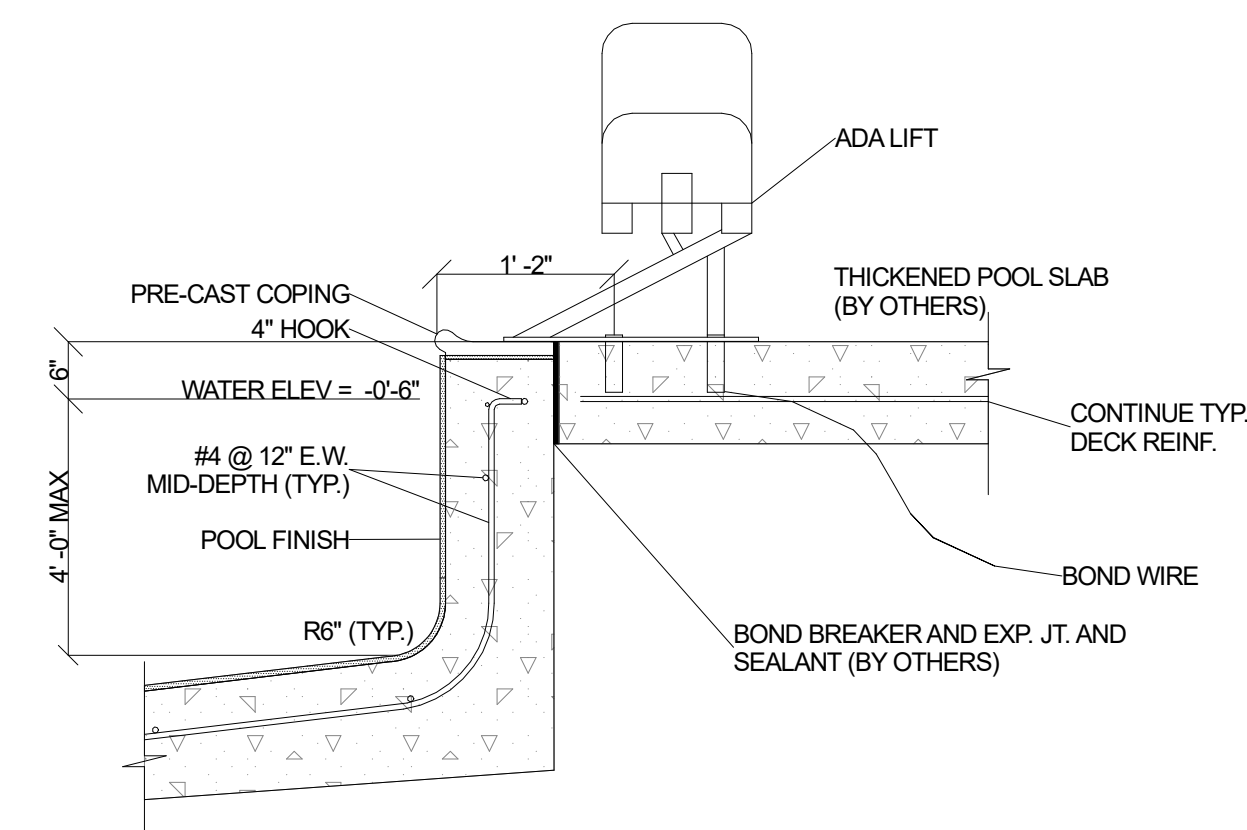

POOL ADA LIFT SECTION
NO SCALE

04

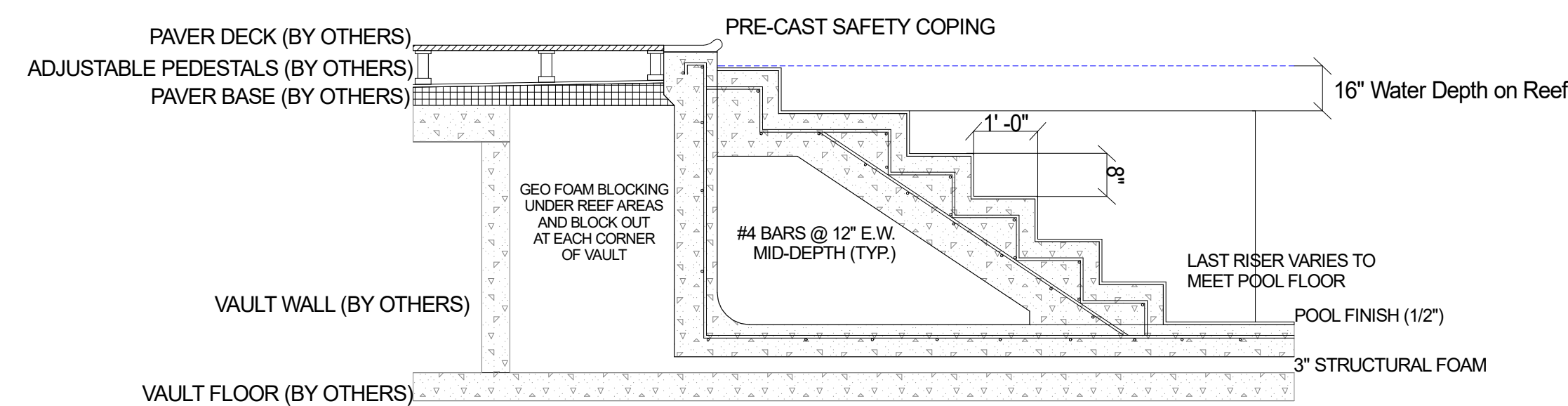

POOL STAIR DETAIL
NO SCALE

MIDWEST CUSTOM POOLS
600 Lincoln Street
Lawrence, KS 66044
P: 785.843.9119
F: 785.843.6524
MidwestCustomPools.com



Summit at West Pryor
940 NW Pryor Road
Lee's Summit, MO 64081

Plan Date:
05.26.2020

Drawn By: DN

SHEET NO.

SD8.01

