

GENERAL ROOF NOTES

1. CONSIDERATION WILL NOT BE GRANTED FOR ANY ALLEGED MISUNDERSTANDINGS OF THE AMOUNT OF WORK TO BE PERFORMED. TENDER OF PROPOSAL SHALL CONVEY FULL AGREEMENT TO THE ITEMS AND CONDITIONS INDICATED ON THE DRAWINGS. SHOULD THE CONTRACTOR FIND DISCREPANCIES OR OMISSIONS IN THE CONTRACT DOCUMENTS OR BE IN DOUBT AS TO THE INTENT THEREOF, THE CONTRACTOR SHALL OBTAIN WRITTEN CLARIFICATION FROM THE ARCHITECT AND/OR THE OWNER'S REPRESENTATIVE PRIOR TO THE SUBMITTING HIS PROPOSAL FOR WORK.
2. CONTRACTOR WILL ENSURE POSITIVE DRAINAGE OF THE ROOF TO DRAINS AND SCUPPERS WITHOUT PONDING.

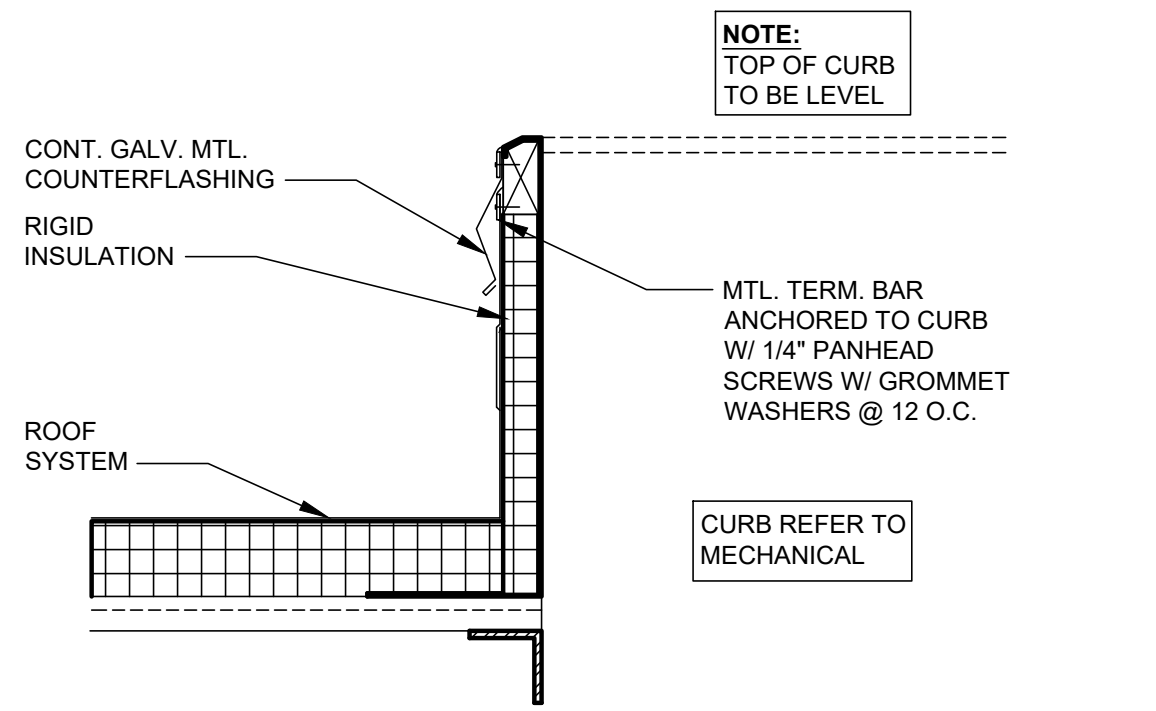

2 DETAIL @ ROOF CURB
SCALE: 1-1/2" = 1'-0"

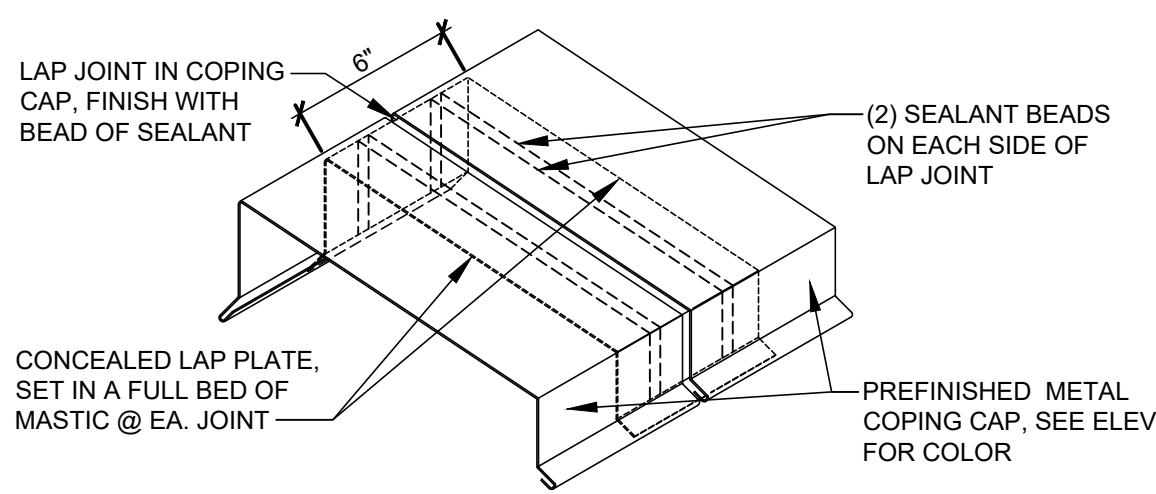

3 TYPICAL COPING LAP JOINT
SCALE: 1-1/2" = 1'-0"

NOTE: LANDLORD'S ROOFER TO BE USED TO ENSURE EXISTING ROOF WARRANTY REMAINS.

Starbucks & Medical Office

155 S.W. MO-150 HWY
LEE'S SUMMIT, MO 64802

CONSTR. DOC. & REVISIONS	
No.	Description
1	Owner Review
Date: 05/12/20	

CASCO DIVERSIFIED CORPORATION
ARCHITECTURAL
CERTIFICATE OF AUTHORITY
#000329 12/31/21

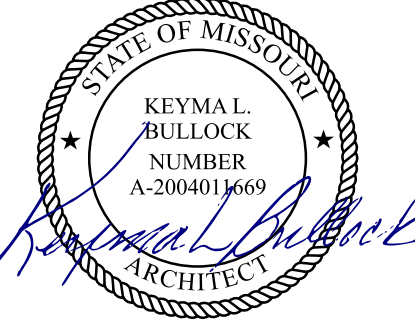

PROFESSIONAL OF RECORD
BULLOCK, KEYMA L.
License NO. 2004011669
Expiration Date 12/31/20

Drawn By/Checked By: RMT/MSD
Project Number 320488

Permit Date 06-17-20

ROOF PLAN