

**RELEASE FOR CONSTRUCTION**  
 AS NOTED ON PLANS REVIEW  
 CODES ADMINISTRATION  
 LEE'S SUMMIT, MISSOURI

06/05/2020

NOTE : DECK APPROVAL WILL BE  
 REQUIRED PRIOR TO (FUTURE) DECK  
 CONSTRUCTION

**LEGEND**

- Gas Meter
- Telephone or Fiber-Optic Pedestal
- Cable TV Pedestal
- Electric Pedestal
- Light Pole
- Mailbox
- Fire Hydrant
- Water Valve

**PROPOSED HOUSE**

TOP FOUNDATION = 960.50  
 GARAGE FLOOR = 957.00  
 TOP FOOTING = 951.50  
 BASEMENT FLOOR = 951.83

E = EXISTING ELEVATION  
 F = PROPOSED FINAL ELEVATION  
 G = ADJACENT GRADE AT EGRESS  
 U/E = UTILITY EASEMENT  
 B/L = BUILDING LINE  
 S/Y/S = SIDE YARD SETBACK  
 R/Y/S = REAR YARD SETBACK

**NOTES**

1. BUILDER TO VERIFY ALL BUILDING ELEVATIONS AND DIMENSIONS.
2. THIS PLOT PLAN DOES NOT CONSTITUTE A BOUNDARY SURVEY.
3. THE EASEMENTS SHOWN ON THIS PLOT PLAN ARE TAKEN FROM THE FINAL PLAT. OTHER EASEMENTS MAY EXIST.

EXTENDED LOT AREA = 12,282 SF  
 DRIVEWAY AREA = 904 SF  
 APPROACH AREA = 221 SF  
 SIDEWALK AREA = N/A  
 DRIVEWAY SLOPE = 8.9%

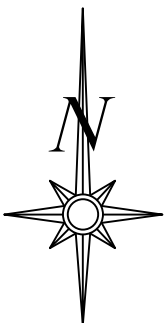

Scale 1" = 40'

**LOT INFORMATION**

11,129 SQ. FT.  
 MBFE = 949.11  
 ADDRESS  
 4412 SW NAUTILUS PL

**LEGAL DESCRIPTION**

LOT 28, CREEKSIDE AT RAINTREE,  
 A SUBDIVISION AS RECORDED IN  
 LEE'S SUMMIT, CASS & JACKSON  
 COUNTY, MISSOURI.

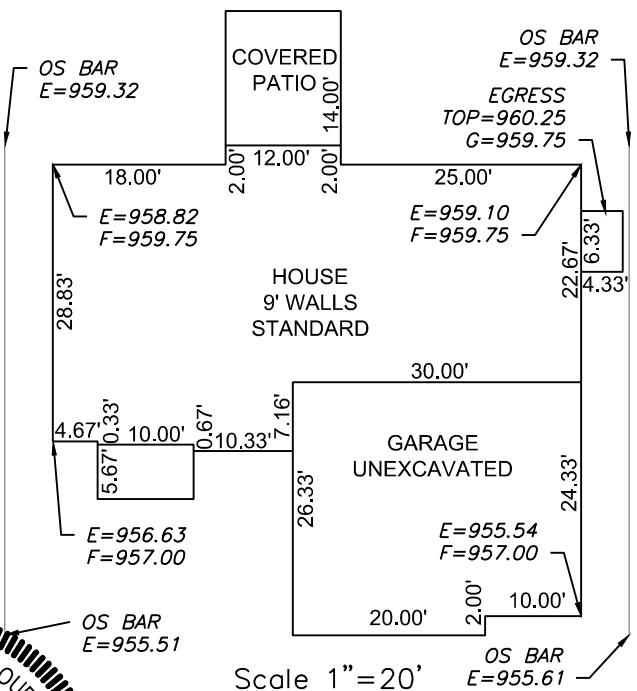

**ENGINEERING SOLUTIONS**  
 ENGINEERING & SURVEYING  
 50 SE 30TH STREET  
 LEE'S SUMMIT, MO 64082  
 P:(816) 623-9888 F:(816)623-9849  
 WWW.ENGINEERINGSOLUTIONKCC.COM

STATE OF MISSOURI  
 MATTHEW J. SCHLICHT  
 NUMBER  
 PE-2006019708  
 5/13/2020  
 PROFESSIONAL ENGINEER

**PLOT PLAN - LOT 28**

CREEKSIDE AT RAINTREE  
 LEE'S SUMMIT, CASS & JACKSON COUNTY, MISSOURI

SUMMIT HOMES  
 120 SE 30TH STREET  
 LEE'S SUMMIT, MO 64082

PROJECT NO.	FILE NAME	DATE	SHEET	OF
1	LOT 28, CREEKSIDE AT RAINTREE	3/27/20	1	1

THIS DRAWING IS NOT VALID UNLESS THE SIGNATURE, DATE AND SEAL OF THE ENGINEER WHO SUPERVISED THE PREPARATION OF THIS DRAWING HAS BEEN AFFIXED HERETO.