

LEGEND

- GM Gas Meter
- D Telephone or Fiber-Optic Pedestal
- Y Cable TV Pedestal
- EP Electric Pedestal
- Light Pole
- M Mailbox
- Fire Hydrant
- Water Valve

PROPOSED HOUSE

TOP FOUNDATION = 945.00
GARAGE FLOOR = 944.00
TOP FOOTING = 936.00
BASEMENT FLOOR = 936.33

E = EXISTING ELEVATION
F = PROPOSED FINAL ELEVATION
G = ADJACENT GRADE AT EGRESS
U/E = UTILITY EASEMENT
B/L = BUILDING LINE
S/Y/S = SIDE YARD SETBACK
R/Y/S = REAR YARD SETBACK

NOTES

- BUILDER TO VERIFY ALL BUILDING ELEVATIONS AND DIMENSIONS.
- THIS PLOT PLAN DOES NOT CONSTITUTE A BOUNDARY SURVEY.
- THE EASEMENTS SHOWN ON THIS PLOT PLAN ARE TAKEN FROM THE FINAL PLAT. OTHER EASEMENTS MAY EXIST.

DRIVEWAY SLOPE = 5.9%

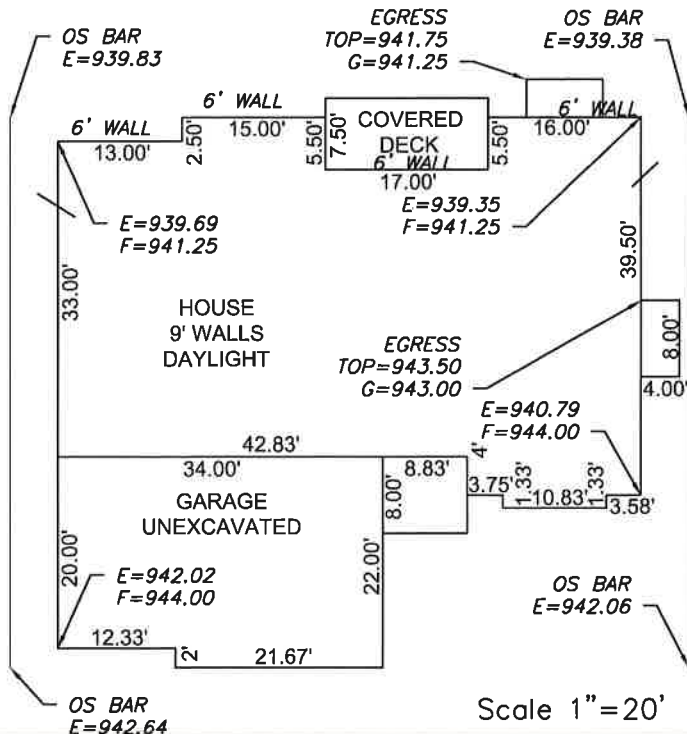

Scale 1"=20'

Scale 1"=30'

LOT INFORMATION

10409.62 SQ. FT.
MBFE = 932.31
ADDRESS
2013 NE BLUESTONE DR

LEGAL DESCRIPTION

LOT 326, PARK RIDGE 6TH PLAT,
A SUBDIVISION AS RECORDED IN
LEE'S SUMMIT, JACKSON
COUNTY, MISSOURI.

ENGINEERING
ENGINEERING & SURVEYING
SOLUTIONS
50 SE 30TH STREET
LEE'S SUMMIT, MO 64082
P:(816) 623-9888 F:(816) 623-9849
WWW.ENGINEERINGSOLUTIONSNC.COM

PLOT PLAN - LOT 326

PARK RIDGE 6TH PLAT
LEE'S SUMMIT, JACKSON COUNTY, MISSOURI

MONTICELLO HOMES
PO BOX 7006
LEE'S SUMMIT, MO 64084

| PROJECT NO. | FILE NAME | DATE | SHEET | OF |
|-------------|---------------------|--------|-------|----|
| 1 | LOT 326, PARK RIDGE | 8/7/19 | 1 | 1 |

Rev:

THIS DRAWING IS NOT VALID UNLESS THE SIGNATURE, DATE AND SEAL OF THE ENGINEER WHO SUPERVISED THE PREPARATION OF THIS DRAWING HAS BEEN AFFIXED HERETO.