

RELEASE FOR CONSTRUCTION AS NOTED ON PLANS REVIEW DEVELOPMENT SERVICES LEE'S SUMMIT, MISSOURI 05/26/2020

LEGEND

- Gas Meter
- Telephone or Fiber-Optic Pedestal
- Cable TV Pedestal
- Electric Pedestal
- Light Pole
- Mailbox
- Fire Hydrant
- Water Valve

PROPOSED HOUSE

TOP FOUNDATION = 921.75
 GARAGE FLOOR = 920.25
 TOP FOOTING = 912.75
 BASEMENT FLOOR = 913.08

E = EXISTING ELEVATION
 F = PROPOSED FINAL ELEVATION
 G = ADJACENT GRADE AT EGRESS
 U/E = UTILITY EASEMENT
 B/L = BUILDING LINE
 S/Y/S = SIDE YARD SETBACK
 R/Y/S = REAR YARD SETBACK

NOTES

1. BUILDER TO VERIFY ALL BUILDING ELEVATIONS AND DIMENSIONS.
2. THIS PLOT PLAN DOES NOT CONSTITUTE A BOUNDARY SURVEY.
3. THE EASEMENTS SHOWN ON THIS PLOT PLAN ARE TAKEN FROM THE FINAL PLAT. OTHER EASEMENTS MAY EXIST.

AS-GRADED PLOT PLAN IS REQUIRED PRIOR TO SODDING

PROPOSED CONTOURS
 AS-GRADED CONTOURS

X=###.## = Actual asbuilt ground shots taken on May 19, 2020.

Contours shown are asbuilt.

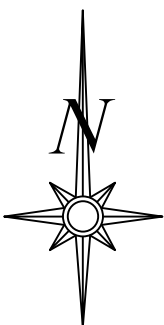

Scale 1" = 30'

LOT INFORMATION

10553.94 SQ. FT.
 MBFE = 906.23
 ADDRESS
 1305 NE BRANDYWINE ROAD

LEGAL DESCRIPTION

LOT 27, MONTICELLO 1ST PLAT, A SUBDIVISION AS RECORDED IN LEE'S SUMMIT, JACKSON COUNTY, MISSOURI.

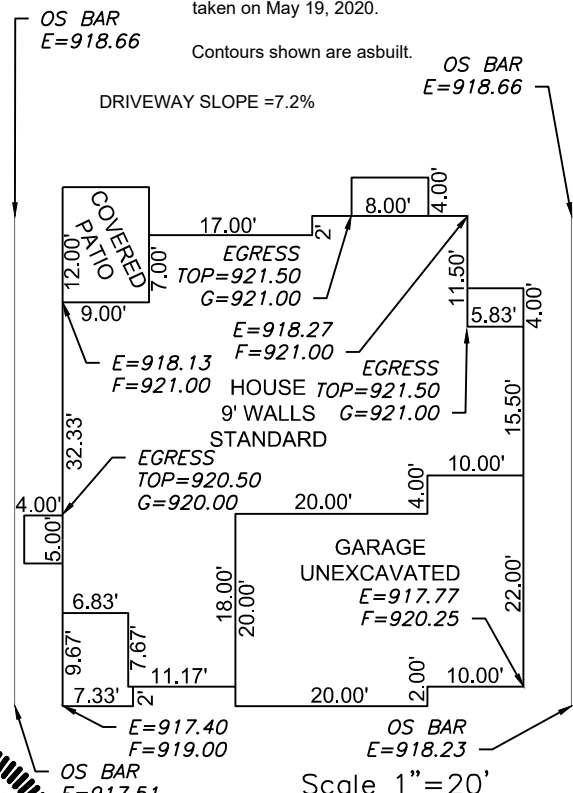

Scale 1" = 20'

ENGINEERING SOLUTIONS
 ENGINEERING & SURVEYING
 50 SE 30TH STREET
 LEE'S SUMMIT, MO 64082
 P:(816) 623-9888 F:(816)623-9849
 WWW.ENGINEERINGSOLUTIONKCC.COM

STATE OF MISSOURI
 MATTHEW J. SCHLICHT
 LICENSE NUMBER FE-2006019708
 PROFESSIONAL ENGINEER

PLOT PLAN - LOT 27

MONTICELLO 1ST PLAT
 LEE'S SUMMIT, JACKSON COUNTY, MISSOURI

SAB HOMES
 200 NW COMMERCE COURT
 LEE'S SUMMIT, MISSOURI, 64086

PROJECT NO.	FILE NAME	DATE	SHEET	OF
1	LOT 27, MONTICELLO	8/26/19	1	1

Rev:

THIS DRAWING IS NOT VALID UNLESS THE SIGNATURE, DATE AND SEAL OF THE ENGINEER WHO SUPERVISED THE PREPARATION OF THIS DRAWING HAS BEEN AFFIXED HERETO.