



LEE'S SUMMIT
MISSOURI

RELEASE FOR LAWN SPRINKLER SYSTEM
IN CITY OF LEE'S SUMMIT RIGHT OF WAY
(RESIDENTIAL)

In consideration for the City of Lee's Summit's permission to extend a Lawn Irrigation System into the City's right of way at (legal description of the property):

Lot No. 54 Plat Title The Manor at Stoney Creek Address: 1821 SW Merryman Dr
County: Jackson State: Missouri

I, Zalman Kohen, the undersigned, successors, and assigns do hereby release and forever discharge the City of Lee's Summit, its employees and/or agents from and against any and all liability, claims and demands for any use arising out of, relating to, or being in any way connected with work or service by the City, its employees or agents within the City's right of way for any purpose whatsoever.

NOW THEREFORE, the Undersigned hereby declares that said property described above shall be held, sold and conveyed subject to the release herein and said release shall run with the real property and be binding on all parties having any part thereof, their heirs, successors and assigns.

IN WITNESS WHEREOF, this release has been read, signed and sealed this 4th day of May, 2020.

By:

[Signature] V.P.
Zalman Kohen
Printed or Typed Name

INDIVIDUAL ACKNOWLEDGMENT

STATE OF MISSOURI
COUNTY OF JACKSON

ON THIS, The 4th day of May, 2020 before me, a Notary Public, personally appeared:
Zalman Kohen

proved to me on the basis of satisfactory evidence to be the person(s) whose name(s) subscribed to the within instrument, and acknowledged that he he/she/they executed the same for the purposes stated therein and no other.

WITNESS my hand and official seal in the County and State aforesaid, the day and year first above written.

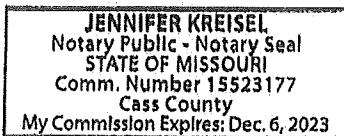

(Seal)

/s/

Jennifer Kreisel
Notary Public Signature
Jennifer Kreisel
Printed or Typed Name

My Commission Expires:

December 6, 2023

Revised 10/21/14

Development Services

220 SE Green Street | Lee's Summit, MO 64063 | P: 816.969.1200 | F: 816.969.1201 | cityofls.net

- MH STA 7+64.98
TOP 1014.01
FL 1000.71







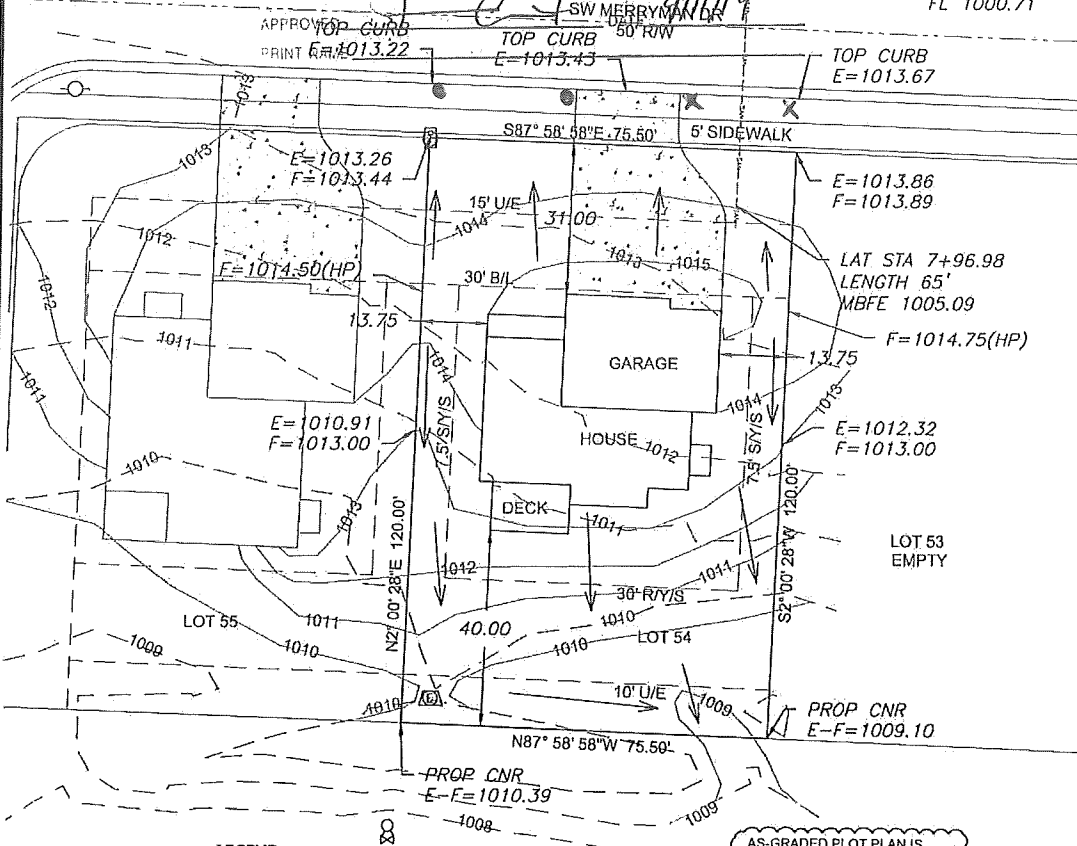

APPROVED TOP CURB
PRINT DATE 5/13/22

TOP CURB 50' R/W
E=1013.43

- TOP CURB
E=1013.67



LEGEND

- | | |
|---|-----------------------------------|
|  | Gas Meter |
|  | Telephone or Fiber-Optic Pedestal |
|  | Cable TV Pedestal |
|  | Electric Pedestal |
|  | Light Pole |
|  | Mailbox |
|  | Fire Hydrant |
|  | Water Valve |

PROPOSED HOUSE

TOP FOUNDATION = 1017.00
GARAGE FLOOR = 1015.50
TOP FOOTING = 1008.00
BASEMENT FLOOR = 1008.33

E = EXISTING ELEVATION
F = PROPOSED FINAL ELEVATION
G = ADJACENT GRADE AT EGRESS
U/E = UTILITY EASEMENT
B/L = BUILDING LINE
S/Y/S = SIDE YARD SETBACK
R/Y/S = REAR YARD SETBACK

NOTES

1. BUILDER TO VERIFY ALL BUILDING ELEVATIONS AND DIMENSIONS.
2. THIS PLOT PLAN DOES NOT CONSTITUTE A BOUNDARY SURVEY.
3. THE EASEMENTS SHOWN ON THIS PLOT PLAN ARE TAKEN FROM THE FINAL PLAT. OTHER EASEMENTS MAY EXIST.

DRIVEWAY SLOPE = 6.0%
EXTENDED LOT AREA = 9,891 SF
DRIVE AREA = 949 SF
APPROACH AREA = 236 SF
SIDEWALK AREA = 271 SF

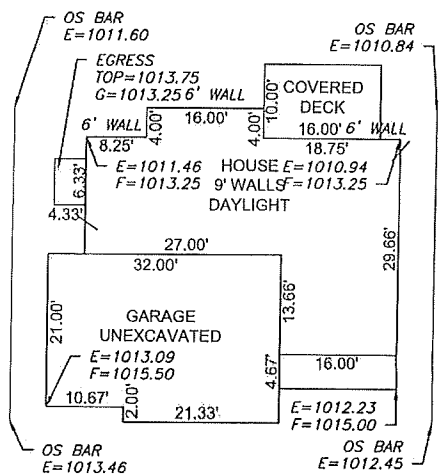

Scale 1"=20'

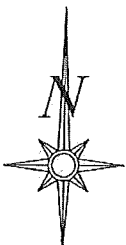

Scale 1"=30'

LOT INFORMATION

9,060 SQ. FT.
MBFE = 1005.09
ADDRESS
1821 SW MERRYMAN DR.

LEGAL DESCRIPTION

LOT 54, THE MANOR AT STONEY
CREEK 2ND PLAT, A SUBDIVISION
AS RECORDED IN LEE'S SUMMIT,
JACKSON COUNTY, MISSOURI.

ENGINEERING SOLUTIONS

—ENGINEERING & SURVEYING

50 SE 30TH STREET
LEES SUMMIT, MO 64082
P:(816) 621-9838 F:(816) 621-9449
WWW.ENGINEERINGSOLUTIONSXC.COM

THIS DRAWING IS NOT VALID UNLESS THE SIGNATURE, DATE AND SEAL OF THE ENGINEER WHO SUPERVISED THE PREPARATION OF THIS DRAWING HAS BEEN AFFIXED HERETO.

PLOT PLAN - LOT 54

THE MANOR AT STONEY CREEK 2ND PLAT
LEE'S SUMMIT, JACKSON COUNTY, MISSOURI

SUMMIT HOMES
120 SE 30TH STREET
LEE'S SUMMIT, MO 64082

PROJECT NO. 1	FILE NAME LOT 54 & 55, MAHAR AT STONEY CREEK	DATE 8/13/10	SHEET 1	OF 1
------------------	---	-----------------	------------	---------