

LEGEND

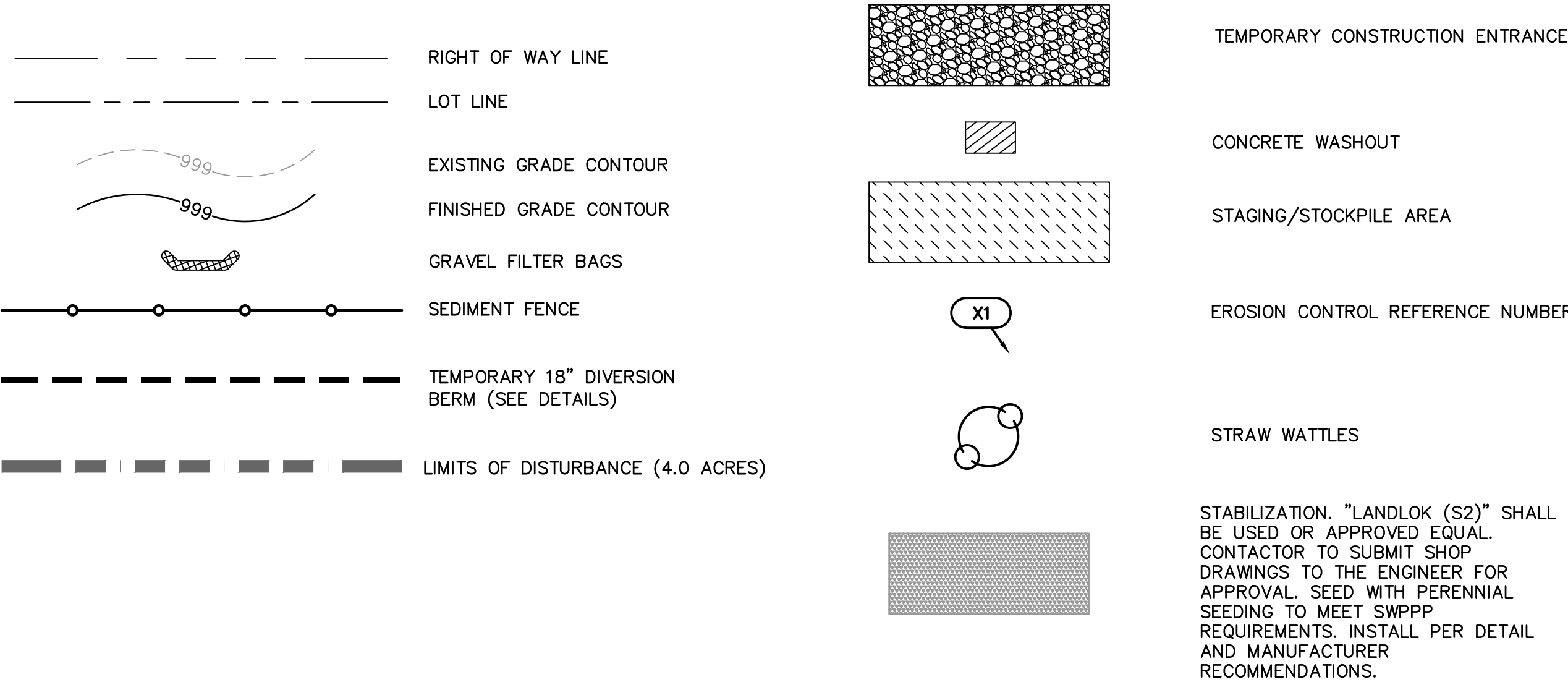

EROSION CONTROL STAGING CHART

PROJECT STAGE	EROSION CONTROL BMP REFERENCE NO.	BMP DESCRIPTION	REMOV E AFTER STAGE	NOTES:
A - PRE-CONSTRUCTION	A1	TEMPORARY CONSTRUCTION ENTRANCE	C	INSTALL AS INDICATED ON PLANS
	A2	CONCRETE WASHOUT	C	INSTALL AS INDICATED ON PLANS
	A3	TEMPORARY SLOPE BARRIER (SEDIMENT FENCE)	D	INSTALL AS INDICATED ON PLANS
	A4	STAGING / STOCKPILE AREA	C	INSTALL AS INDICATED ON PLANS
	A5	EXISTING CURB INLET PROTECTION - TEMPORARY SEDIMENT BARRIER - CONDITION A	C	INSTALL AS INDICATED ON PLANS
	A6	TEMPORARY SEDIMENT TRAP	C	INSTALL AS INDICATED ON PLANS
	A7	PERMANENT SWALE	C	INSTALL AS INDICATED ON PLANS
B - STORM SEWER & UTILITY CONSTRUCTION (STABILIZE ANY DISTURBED AREAS OUTSIDE OF BUILDING PADS AND PARKING LOTS)	B1	TEMPORARY SEDIMENT BARRIER - CURB INLET - CONDITION A	C	INSTALL AS INDICATED ON PLANS
	B2	TEMPORARY SEDIMENT BARRIER - JUNCTION BOX - CONDITION A	C	INSTALL AS INDICATED ON PLANS
	B3	TEMPORARY EROSION CONTROL BLANKET (LANDLOK S2)	C	INSTALL AS INDICATED ON PLANS
C - BUILDING AND PAVEMENT CONSTRUCTION	C1	TEMPORARY SEDIMENT BARRIER - CURB INLET - CONDITION B	D	INSTALL AS INDICATED ON PLANS
	C2	TEMPORARY SEDIMENT BARRIER - JUNCTION BOX - CONDITION B	D	INSTALL AS INDICATED ON PLANS
D - FINAL STABILIZATION	D1	REPLACE TOP SOIL, SEED MULCH, SOD, LANDSCAPE	N/A	ESTABLISH PERENNIAL VEGETATION WITH A 70% DENSITY OVER 100% OF DISTURBED AREA.

Sediment Basin Design Calculations

Trap 1 - Colbern Road
OA# G17-0585

Design Flows:

Tributary Drainage Area to Pond: 4.00 Acres
Disturbed Tributary Drainage Area to Pond: 4.00 Acres

Drainage Area

Drainage Basin Area	Total Area	C	KC	Tc	Intensity	Design Q
	(acre)		(K=1.0)	(min)	(in/hr)	(cfs)
Basin #1	4.00	0.35	0.35	5.00	5.41	7.58
Basin #1-Disturbed Area	4.00	0.35	0.35	5.00	5.41	7.58

Drainage Area

Drainage Basin Area	Total Area	C	KC	Tc	Intensity	Design Q
	(acre)		(K=1.1)	(min)	(in/hr)	(cfs)
Basin #1	4.00	0.35	0.39	5.00	8.53	13.16
Basin #1-Disturbed Area	4.00	0.35	0.39	5.00	8.53	13.16

Sediment Basin Storage:

Minimum Sediment Storage = 4 Acre x 67 CY/Acre = 268 CY

Pond

Basin	Elevation	Area (Sq. Ft.)	Volume (Cu. Yd.)	Cummulative Volume (Cu. Yd.)
Basin Volume #1	960.50	0		
	961.00	1100	10	10
	962.00	3500	85	95
	963.00	6700	189	284
	964.00	9000	291	575

Overflow Elevation:

Spillway Length = 6 x Tributary area in acres (Ft) = 24
= 4.00 x 6 = 24

Ho=18"
Use 10" Rip Rap

Spillway Elevation = 964.03

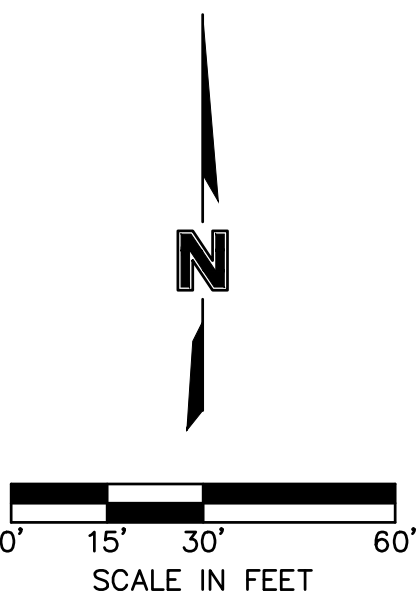

SAPP
DESIGN
ARCHITECTS

3750 S. Fremont Ave.
Springfield, MO 65804 417.877.9600

Sapp Design Associates Architects, P.C.
Missouri State Certificate of Authority #000607

helix.

1629 Walnut
Kansas City, MO 64108 816.300.0300

SPECIAL NOTICES

In the event the client consents to allow, authorize or approve of changes to any plans, specifications or other construction documents, and these changes are not approved in writing by the design professional, the client recognizes that such changes and the results thereof are not the responsibility of the design professional. Therefore, the client agrees to release the design professional from any liability arising from the construction, use or result of such changes. In addition, the client agrees to the fullest extent permitted by law, to indemnify and hold the design professional harmless from any damage, liability or cost (including reasonable attorney's fees and costs of defense) arising from such changes.

The personal seal of the registered Architect or Engineer shall be the legal equivalent of his signature whenever & wherever used, and the owner of the seal shall authenticate this sheet and the specification sections pertaining to this sheet. Responsibility shall be disclaimed for all other plans, specifications, estimates, reports or other documents or instruments relating to or intended to be used for any part or parts of the architectural project.

Mid-Continent Public Library
CONSTRUCTION DOCUMENTS FOR
COLBERN ROAD BRANCH
1000 N.E. COLBERN ROAD
LEE'S SUMMIT, MO 64086
JACKSON COUNTY

PACKAGE
10

Engineer of Record

ISSUE FOR
CONSTRUCTION
02.05.20

Terry M Parsons, Engineer MO PE-2018010505

olsson

7301 West 133rd Street, Suite 200
Overland Park, KS 66213
TEL 913.381.1170
FAX 913.381.1174
www.olsson.com

Olsson
Missouri State Certificate of Authority #001592

Revision No.	Description	Date
1	CITY COMMENTS	03.19.20
2	CITY COMMENTS	04.08.20

Project No.	Date	Drawn
B18-0330	02.05.20	RLK

Drawing No.

C9.0
EROSION CONTROL PLAN
- PRE CONSTRUCTION

© Copyright 2020 by SAPP Design Architects, P.C. All rights reserved.

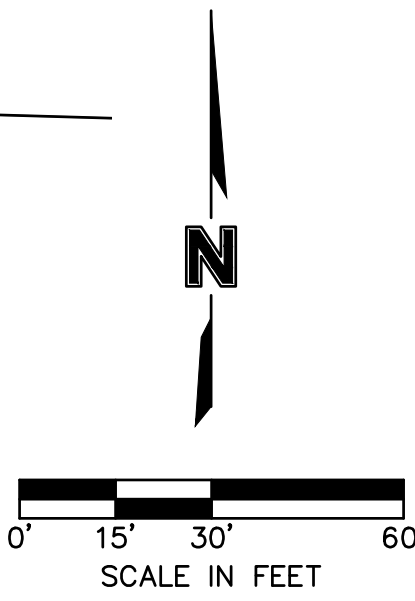

EROSION CONTROL STAGING CHART				
PROJECT STAGE	EROSION CONTROL BMP REFERENCE NO.	BMP DESCRIPTION	REMOVE AFTER STAGE	NOTES:
A – PRE-CONSTRUCTION	A1	TEMPORARY CONSTRUCTION ENTRANCE	C	INSTALL AS INDICATED ON PLANS
	A2	CONCRETE WASHOUT	C	INSTALL AS INDICATED ON PLANS
	A3	TEMPORARY SLOPE BARRIER (SEDIMENT FENCE)	D	INSTALL AS INDICATED ON PLANS
	A4	STAGING / STOCKPILE AREA	C	INSTALL AS INDICATED ON PLANS
	A5	EXISTING CURB INLET PROTECTION – TEMPORARY SEDIMENT BARRIER – CONDITION A	C	INSTALL AS INDICATED ON PLANS
	A6	TEMPORARY SEDIMENT TRAP	C	INSTALL AS INDICATED ON PLANS
	A7	TEMPORARY DIVERSION BERM	C	INSTALL AS INDICATED ON PLANS
B – STORM SEWER & UTILITY CONSTRUCTION (STABILIZE ANY DISTURBED AREAS OUTSIDE OF BUILDING PADDS AND PARKING LOTS)	B1	TEMPORARY SEDIMENT BARRIER – CURB INLET – CONDITION A	C	INSTALL AS INDICATED ON PLANS
	B2	TEMPORARY SEDIMENT BARRIER – JUNCTION BOX – CONDITION A	C	INSTALL AS INDICATED ON PLANS
	B3	TEMPORARY EROSION CONTROL BLANKET (LANDLOCK S2)	C	INSTALL AS INDICATED ON PLANS
C – BUILDING AND PAVEMENT CONSTRUCTION	C1	TEMPORARY SEDIMENT BARRIER – CURB INLET – CONDITION B	D	INSTALL AS INDICATED ON PLANS
	C2	TEMPORARY SEDIMENT BARRIER – JUNCTION BOX – CONDITION B	D	INSTALL AS INDICATED ON PLANS
D – FINAL STABILIZATION	D1	REPLACE TOP SOIL, SEED MULCH, SOD, LANDSCAPE	N/A	ESTABLISH PERENNIAL VEGETATION WITH A 70% DENSITY OVER 100% OF DISTURBED AREA.

<h1 style="margin: 0;">SAPP DESIGN ARCHITECTS</h1> <p style="margin: 5px 0;">3750 S. Fremont Ave. Springfield, MO 65804 417.877.9600</p>		
Sapp Design Associates Architects, P.C. Missouri State Certificate of Authority #000607		
1629 Walnut Kansas City, MO 64108 816.300.0300		
SPECIAL NOTICES		
In the event the client consents to, allows, authorizes or approves of changes to any plans, specifications or other construction documents, and these changes are not approved in writing by the design professional, the client recognizes that such changes and the results thereof are not the responsibility of the design professional. Therefore, the client agrees to release the design professional from any liability arising from the construction, use or result of such changes. In addition, the client agrees to the fullest extent permitted by law, to indemnify and hold the design professional harmless from any damage, liability or cost (including reasonable attorney's fees and costs of defense) arising from such changes.		
The personal seal of the registered Architect or Engineer shall be the legal equivalent of the signature whenever and wherever used, and the owner of the seal shall authenticate this seal and the specification sections pertaining to this seal. Responsibility shall be disclaimed for all other plans, specifications, estimates, reports or other documents or instruments relating to or intended to be used for any part or parts of the architectural project.		
<div style="display: flex; justify-content: space-between; align-items: center;"> <div style="writing-mode: vertical-rl; transform: rotate(180deg);"> Mid-Continent Public Library CONSTRUCTION DOCUMENTS FOR </div> <div style="writing-mode: vertical-rl; transform: rotate(180deg);"> COLBERN ROAD BRANCH </div> <div style="writing-mode: vertical-rl; transform: rotate(180deg);"> 1000 N.E. COLBERN ROAD LEE'S SUMMIT, MO 64086 JACKSON COUNTY </div> </div> <div style="margin-top: 20px; text-align: center;"> <div style="border: 1px solid black; padding: 5px; display: inline-block;"> PACKAGE 10 </div> </div>		
Engineer of Record		
ISSUE FOR CONSTRUCTION 02.05.20		
Terry M Parsons, Engineer MO PE-2018010505		
7301 West 133rd Street, Suite 200 Overland Park, KS 66213 TEL 913.381.1170 FAX 913.381.1174 www.olsson.com		
Olsson Missouri State Certificate of Authority #001592		
Revision No.	Description	Date
1 CITY COMMENTS	CITY COMMENTS	03.19.20
2 CITY COMMENTS	CITY COMMENTS	04.08.20
Project No. B18-0330	Date 02.05.20	Drawn RLK
Drawing No.		
<h2 style="margin: 0;">C9.1</h2> <p style="margin: 0;">EROSION CONTROL PLAN - CONSTRUCTION</p> <p style="margin: 0; font-size: 0.8em;">© Copyright 2018 - Sapp Design Associates, Architects, P.C.</p>		



LEGEND

EROSION CONTROL STAGING CHART



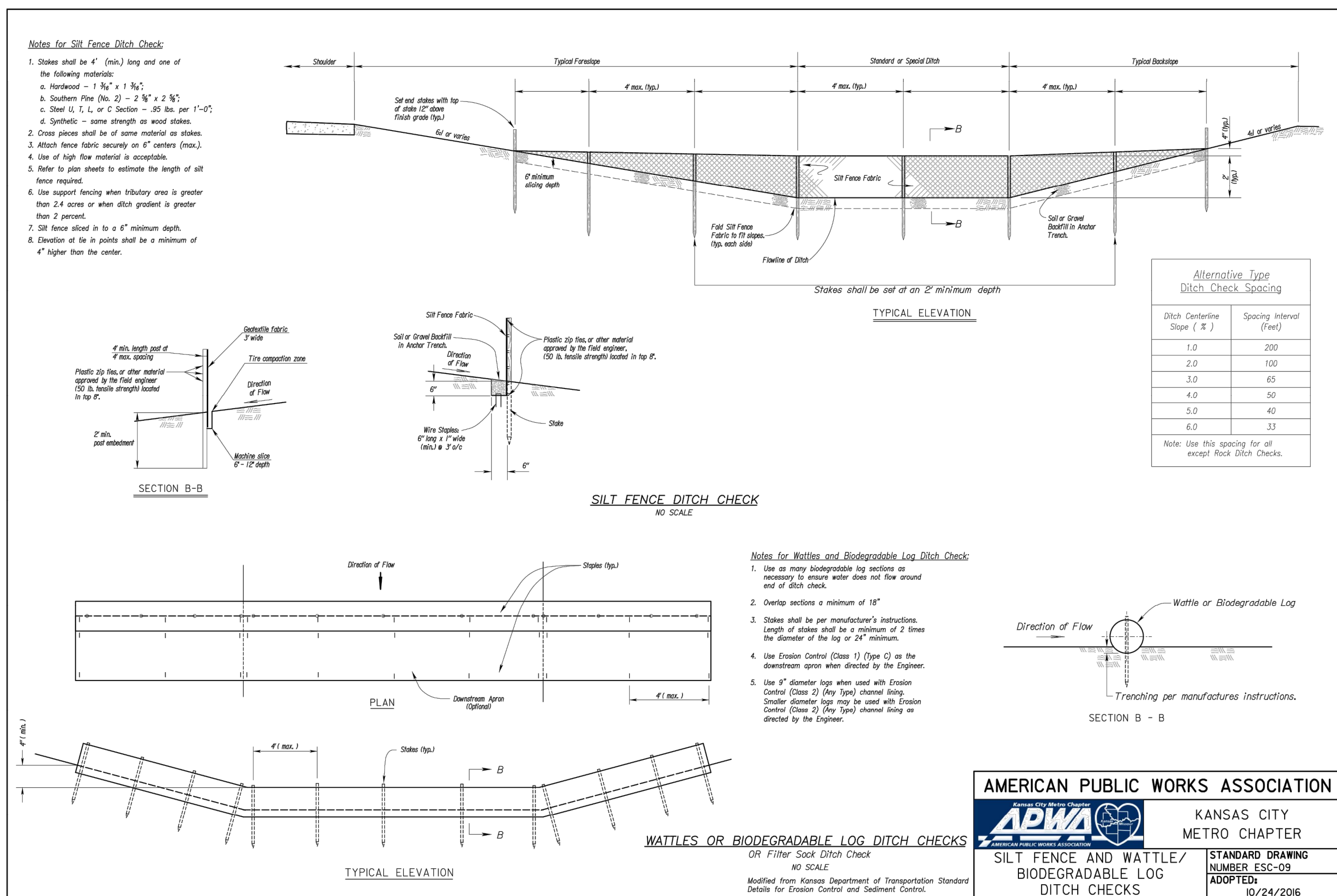
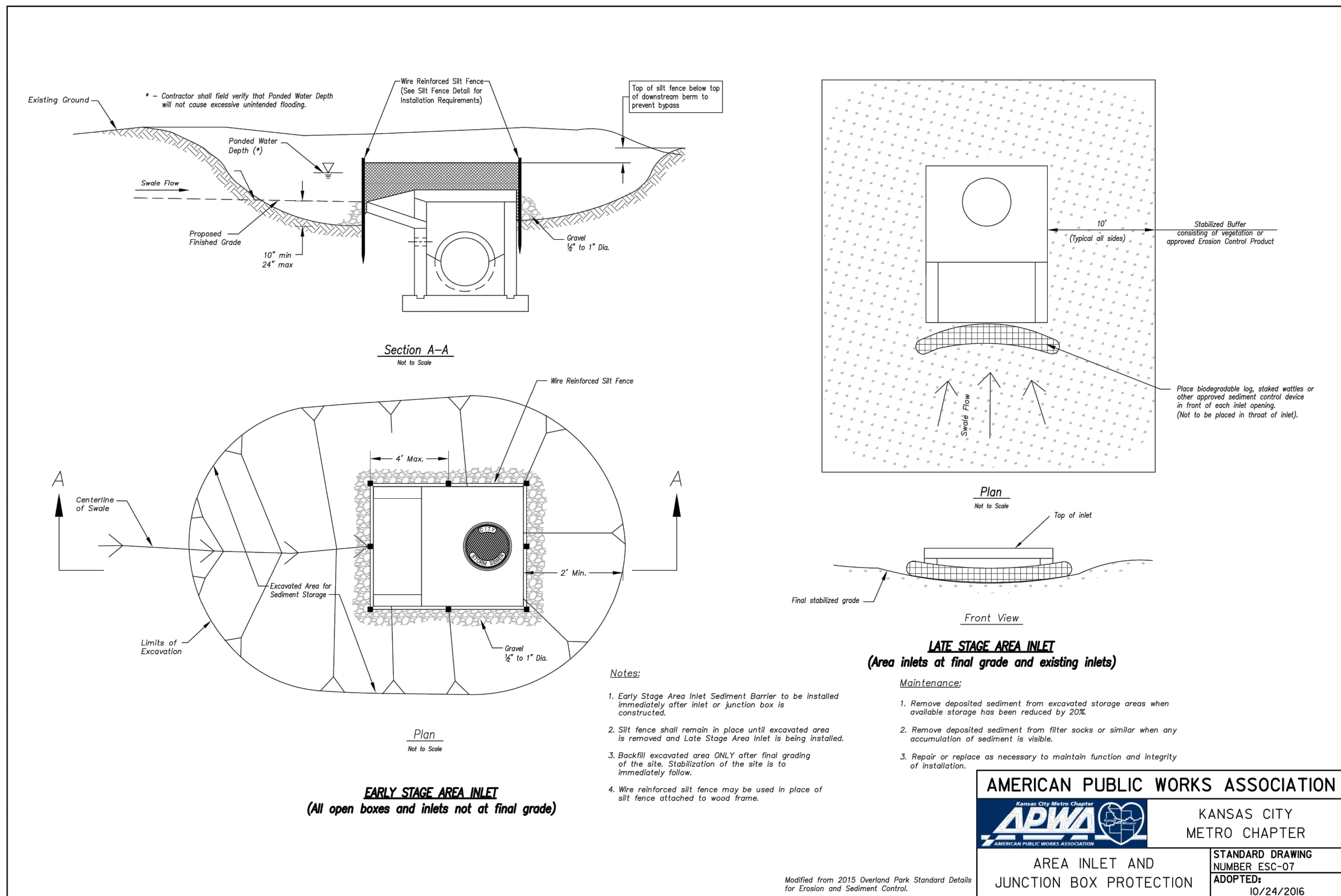
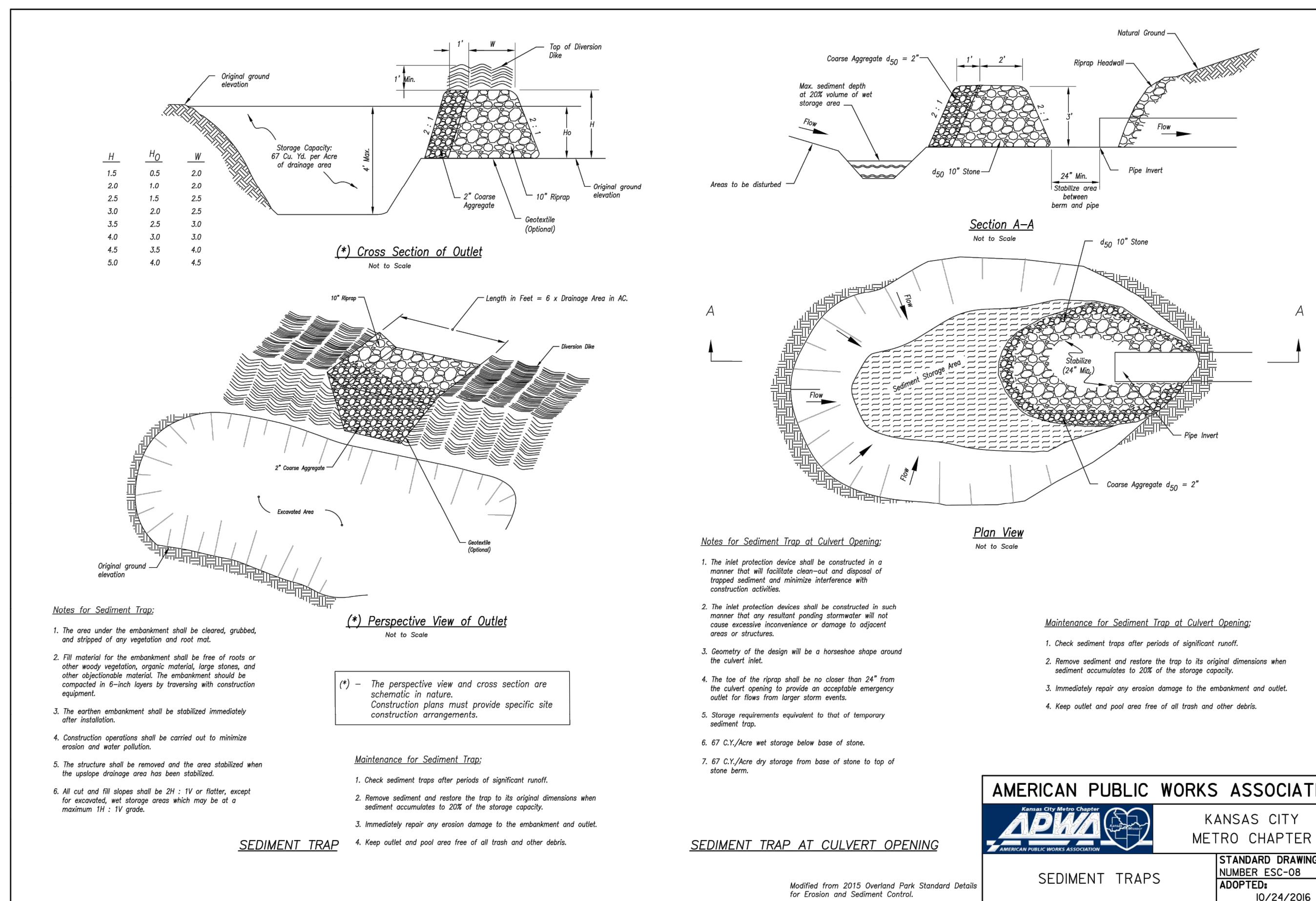
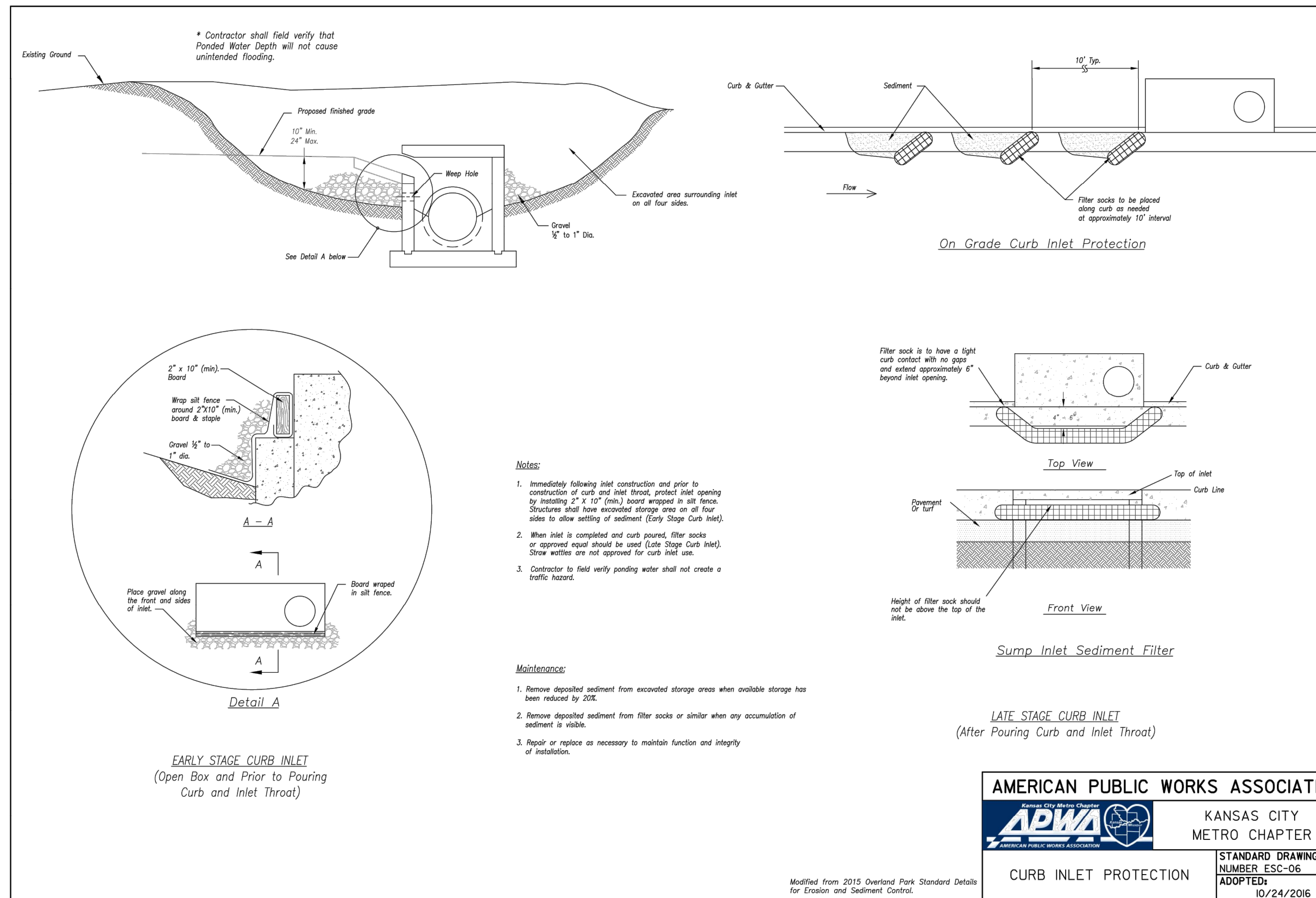

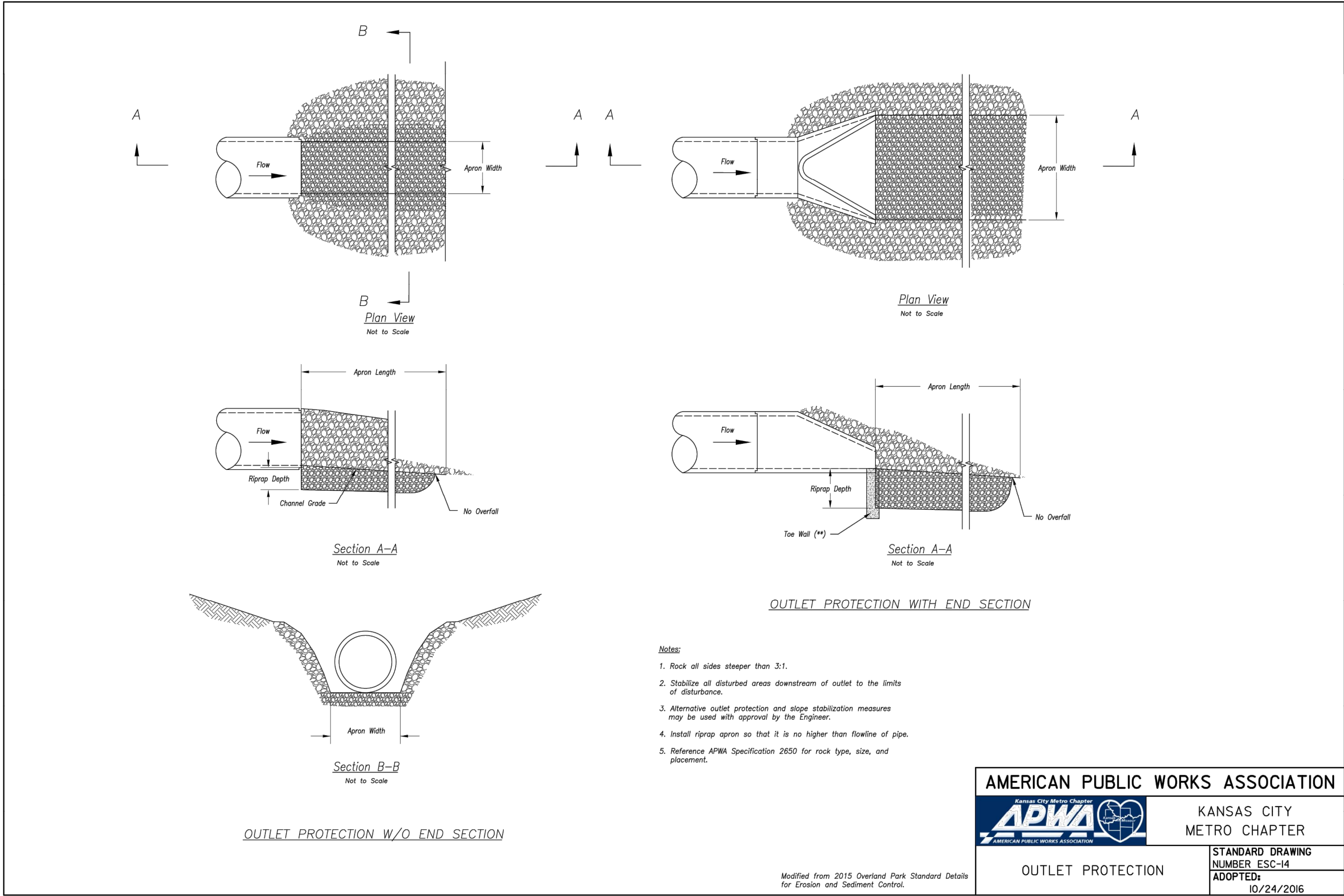
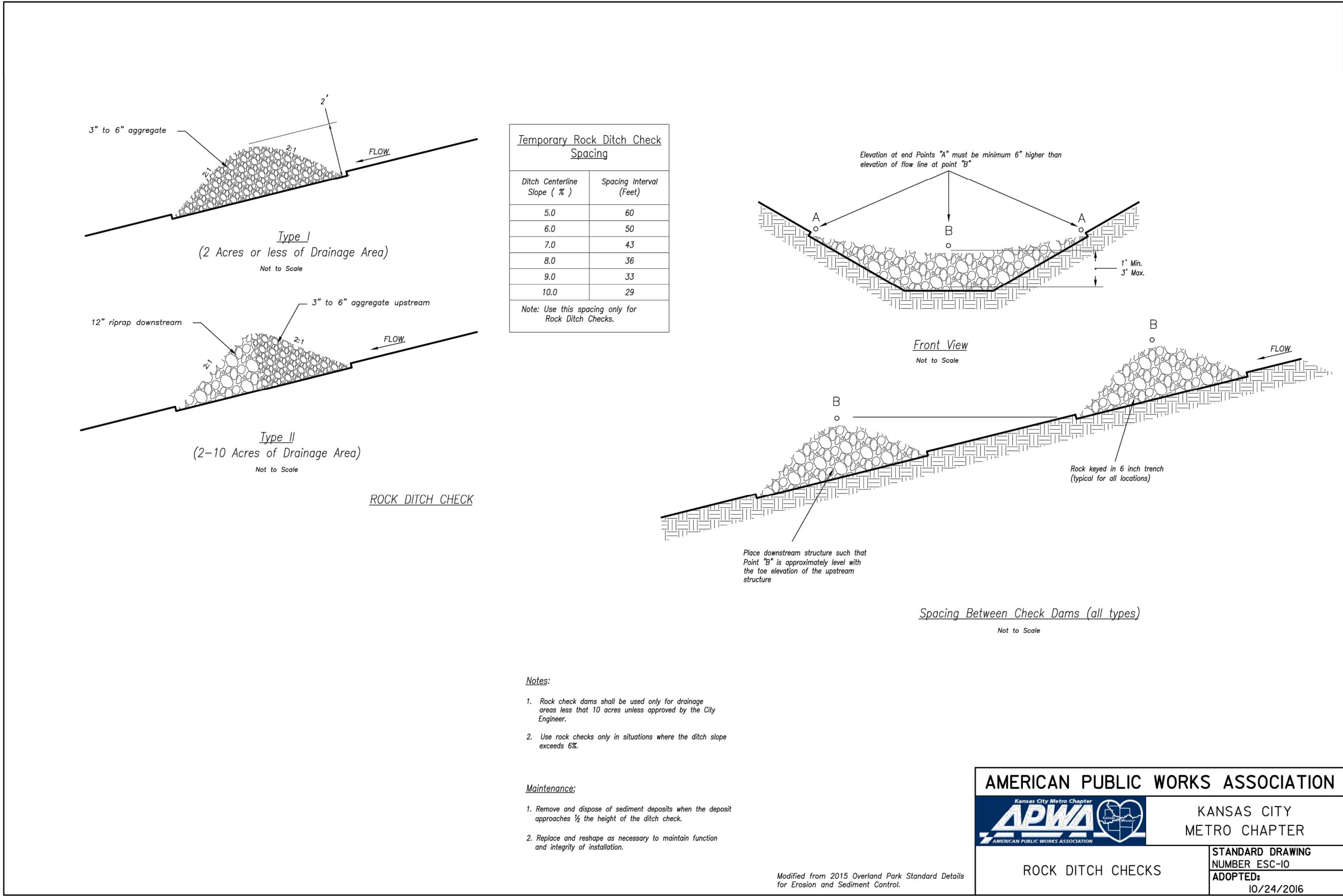

SAPP
DESIGN
ARCHITECTS

3750 S. Fremont Ave.
Springfield, MO 65804
417.877.9600

Sapp Design Associates Architects, P.C.
Missouri State Certificate of Authority #000607

helix.

1629 Walnut
Kansas City, MO 64108
816.300.0300

SPECIAL NOTICES

In the event the client consents to, allows, authorizes or approves changes to any plans, specifications or other construction documents, and these changes are not approved in writing by the design professional, the client recognizes that such changes and the results thereof are not the responsibility of the design professional. Therefore, the client agrees to release the design professional from any liability arising from the construction, use or result of such changes. In addition, the client agrees to the fullest extent permitted by law, to indemnify and hold the design professional harmless from any damage, liability or cost (including reasonable attorney's fees and costs of defense) arising from such changes.

The personal seal of the registered Architect or Engineer shall be the legal equivalent of his signature whenever & whenever used, and the owner of the seal shall authenticate this sheet and the specification sections pertaining to this sheet. Responsibility shall be disclaimed for all other plans, specifications, estimates, reports or other documents or instruments relating to or intended to be used for any part or parts of the architectural project.

Mid-Continent Public Library
CONSTRUCTION DOCUMENTS FOR
COLBERN ROAD BRANCH

1000 N.E. COLBERN ROAD
LEE'S SUMMIT, MO 64086
JACKSON COUNTY

PACKAGE
10

Engineer of Record

ISSUE FOR
CONSTRUCTION
02.05.20

Terry M Parsons, Engineer MO PE-2018010505

olsson

7301 West 133rd Street, Suite 200
Overland Park, KS 66213
TEL 913.381.1170
FAX 913.381.1174
www.olsson.com

Olsson
Missouri State Certificate of Authority #001592

Revision No.	Description	Date
1	CITY COMMENTS	03.19.20
2	CITY COMMENTS	04.08.20

Project No.	Date	Drawn
B18-0330	02.05.20	RLK

Drawing No.
C9.5
EROSION CONTROL
DETAILS

© Copyright 2019 by Olsson Engineering, Inc. All rights reserved.