

RELEASE FOR CONSTRUCTION
AS NOTED ON PLANS REVIEW
CODES ADMINISTRATION
LEE'S SUMMIT, MISSOURI

04/28/2020

NOTE: DECK APPROVAL WILL BE
REQUIRED PRIOR TO (FUTURE) DECK
CONSTRUCTION

DRIVEWAY SLOPE = 8.9%

LEGEND

- Gas Meter
- Telephone or Fiber-Optic Pedestal
- Cable TV Pedestal
- Electric Pedestal
- Light Pole
- Mailbox
- Fire Hydrant
- Water Valve

PROPOSED HOUSE

TOP FOUNDATION = 1020.00
GARAGE FLOOR = 1018.00
TOP FOOTING = 1011.00
BASEMENT FLOOR = 1011.33

E = EXISTING ELEVATION
F = PROPOSED FINAL ELEVATION
G = ADJACENT GRADE AT EGRESS
U/E = UTILITY EASEMENT
B/L = BUILDING LINE
S/Y/S = SIDE YARD SETBACK
R/Y/S = REAR YARD SETBACK

NOTES

1. BUILDER TO VERIFY ALL BUILDING ELEVATIONS AND DIMENSIONS.
2. THIS PLOT PLAN DOES NOT CONSTITUTE A BOUNDARY SURVEY.
3. THE EASEMENTS SHOWN ON THIS PLOT PLAN ARE TAKEN FROM THE FINAL PLAT. OTHER EASEMENTS MAY EXIST.

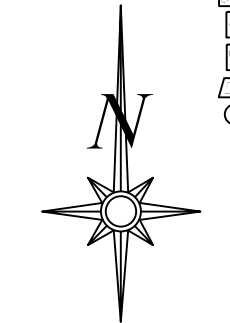
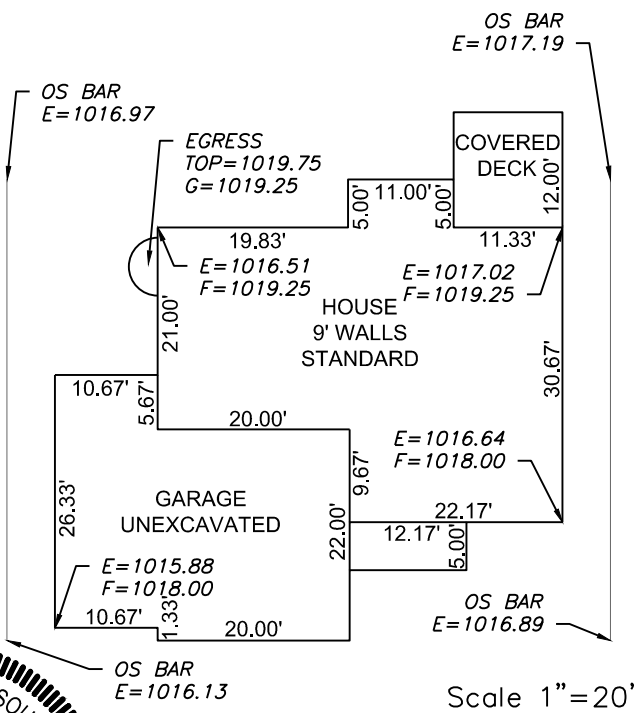

Scale 1"=30'

LOT INFORMATION

10,193.6 SQ. FT.
MBOE = 1019.20
MBFE = 1005.70
ADDRESS
1808 SW BLACKSTONE PLACE

LEGAL DESCRIPTION

LOT 98, NAPA VALLEY 2ND PLAT,
A SUBDIVISION AS RECORDED IN
LEE'S SUMMIT, JACKSON
COUNTY, MISSOURI.

PLOT PLAN - LOT 98

NAPA VALLEY 2ND PLAT
LEE'S SUMMIT, JACKSON COUNTY, MISSOURI

KEVIN HIGDON CONTRUCTION
PO BOX 847
LEE'S SUMMIT, MO 64063

PROJECT NO. 1	FILE NAME LOT 98, NAPA VALLEY	DATE 4/7/20	SHEET 1	OF 1
------------------	----------------------------------	----------------	------------	---------

ENGINEERING SOLUTIONS
ENGINEERING & SURVEYING
50 SE 30TH STREET
LEE'S SUMMIT, MO 64082
P:(816) 623-9888 F:(816)623-9849
WWW.ENGINEERINGSOLUTIONKCC.COM

STATE OF MISSOURI
MATTHEW J. SCHLICHT
REGISTERED PROFESSIONAL ENGINEER
NUMBER
PE-2006019708
4/28/2020

THIS DRAWING IS NOT VALID UNLESS THE SIGNATURE, DATE AND SEAL OF THE ENGINEER WHO SUPERVISED THE PREPARATION OF THIS DRAWING HAS BEEN AFFIXED HERETO.