

ORDERED BY: MCFARLAND CUSTOM BUILDERS

PROPERTY ADDRESS: 2521 SW RIVER TRAIL ROAD

DESCRIPTION: Lot 671, EAGLE CREEK, FIFTEENTH PLAT, a subdivision in the City of Lee's Summit, Jackson County, Missouri.

MGP LOT DESIGNATION-  
STANDARD

LAND SURVEY COMPANY

Quality since 1959  
P.O. BOX 528, GRANDVIEW, MISSOURI 64030  
PHONE: (816) 966-0839 FAX: (816) 763-1761

CONSTRUCTION STAKE PLOT PLAN

\*\*\*\*NOTE:  
As graded Plot Plan  
required Prior to sodding!

RELEASE FOR CONSTRUCTION  
AS NOTED ON PLANS REVIEW  
CODES ADMINISTRATION  
LEE'S SUMMIT, MISSOURI

04/24/2020



SCALE: 1"= 20'  
DATE: 3/4/20  
GO AHEAD: 4/13/20  
FINAL: 4/21/20

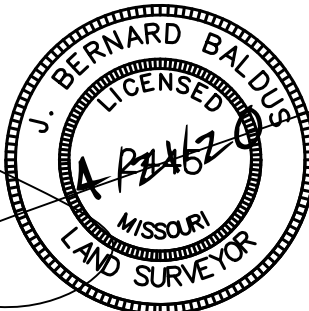

J. BERNARD BALDUS, MPLS # 2445

Attention: This Plot Plan was prepared for use before and during foundation construction ONLY. This house is staked as shown on this drawing. The Contractor is to check and verify house dimensions and elevations at the job site. We are not responsible for unknown or unplatted easements of any kind unless we are furnished with the description of said easement prior to our field work being performed. Elevations shown hereon are for a guide only, and final elevations are the responsibility of the on-Site Contractor. Unless otherwise noted, THIS IS NOT AN AS-BUILT SURVEY and we can not guarantee the construction of anything shown on this "Plan." Boundary and Improvement Surveys and "As-Built" Grading Certifications serve the purpose of showing "Actual" construction.

