

PLAN FOR
SAINT LUKE'S EAST - FLEX FACILITY EXPANSION
CITY OF LEE'S SUMMIT, MISSOURI

GENERAL NOTES

1. ALL WORKMANSHIP AND MATERIALS SHALL BE SUBJECT TO THE INSPECTION AND APPROVAL OF CITY OF LEE'S SUMMIT, MISSOURI.
2. LINEAL FOOT MEASUREMENTS SHOWN ON THE PLANS ARE HORIZONTAL MEASUREMENTS, NOT SLOPE MEASUREMENTS. ALL PAYMENTS SHALL BE MADE ON HORIZONTAL MEASUREMENTS.
3. THE UTILITY LOCATIONS SHOWN ON THESE PLANS ARE TAKEN FROM UTILITY COMPANY RECORDS AND ARE APPROXIMATE ONLY. THEY DO NOT CONSTITUTE ACTUAL FIELD LOCATIONS. THE CONTRACTOR SHALL VERIFY THE LOCATION AND DEPTH OF ALL UTILITIES PRIOR TO CONSTRUCTION.
4. THE CONTRACTOR SHALL ADHERE TO THE PROVISIONS OF THE SENATE BILL NUMBER 583, 78TH GENERAL ASSEMBLY OF THE STATE OF MISSOURI. THE BILL REQUIRES THAT ANY PERSON OR FIRM DOING EXCAVATION ON PUBLIC RIGHT-OF-WAY DO SO ONLY AFTER GIVING NOTICE TO, AND OBTAINING INFORMATION FROM, UTILITY COMPANIES. STATE LAW REQUIRES 48 HOURS ADVANCE NOTICE. THE NAMES AND TELEPHONE NUMBERS OF UTILITY COMPANIES, EVEN IF ONLY REMOTELY INVOLVED WITH THIS PROJECT ARE AS FOLLOWS:

ELECTRIC	KANSAS CITY POWER & LIGHT CO.	888-474-5275
GAS	MISSOURI GAS ENERGY	816-756-5252
WATER	CITY OF LEE'S SUMMIT	816-969-1940
TELEPHONE	AT&T	800-464-7928
SEWER	CITY OF LEE'S SUMMIT	816-969-1940
CABLE TV	TIME WARNER	816-358-8833
	COMCAST	816-833-3400



THE CONTRACTOR MAY ALSO UTILIZE THE FOLLOWING TOLL FREE PHONE NUMBER PROVIDED BY "MISSOURI ONE CALL SYSTEM, INC.": 1-(800)-DIG RITE. THIS PHONE NUMBER IS APPLICABLE ANYWHERE WITHIN THE STATE OF MISSOURI. PRIOR TO COMMENCEMENT OF WORK, THE CONTRACTOR SHALL NOTIFY ALL THOSE COMPANIES WHICH HAVE FACILITIES IN THE NEAR VICINITY OF THE CONSTRUCTION TO BE PERFORMED.

5. PRIOR TO ORDERING PREFABRICATED STRUCTURES, SHOP DRAWINGS SHALL BE SUBMITTED TO THE DESIGN ENGINEER FOR APPROVAL.
6. THE CONTRACTOR SHALL PROTECT ALL MAJOR TREES FROM DAMAGE. NO TREE SHALL BE REMOVED WITHOUT PERMISSION OF THE OWNER, UNLESS SHOWN OTHERWISE.
7. CLEARING AND GRUBBING OPERATIONS AND DISPOSAL OF ALL DEBRIS SHALL BE PERFORMED BY THE CONTRACTOR IN STRICT ACCORDANCE WITH ALL LOCAL CODES AND ORDINANCES.
8. ALL MANHOLES, CATCH BASINS, UTILITY VALVES AND METER PITS TO BE ADJUSTED OR REBUILT TO GRADE AS REQUIRED. ALL EXISTING UTILITIES SHALL BE ADJUSTED AS REQUIRED.
9. ALL EXCESS AND UNSUITABLE MATERIAL SHALL BE DISPOSED OF AT A LOCATION OFF SITE PROVIDED BY THE CONTRACTOR.
10. SUBGRADE SOIL FOR ALL CONCRETE STRUCTURES, REGARDLESS OF THE TYPE OR LOCATION, SHALL BE FIRM, DENSE AND THOROUGHLY COMPACTED AND CONSOLIDATED; SHALL BE FREE FROM MUCK AND MUD; AND SHALL BE SUFFICIENTLY STABLE TO REMAIN FIRM AND INTACT UNDER THE FEET OF THE WORKMEN OR MACHINERY ENGAGED IN SUBGRADE SURFACING, LAYING REINFORCING STEEL, AND DEPOSITING CONCRETE THEREON. IN ALL CASES WHERE SUBSOIL IS MUCKY OR WORKS INTO MUD OR MUCK DURING SUCH OPERATION, A SEAL COURSE OF EITHER CONCRETE OR ROCK SHALL BE PLACED BELOW SUBGRADE TO PROVIDE A FIRM BASE FOR WORKING AND FOR PLACING THE FLOOR SLAB.
11. ALL EXCAVATION SHALL BE UNCLASSIFIED. NO SEPARATE PAYMENT WILL BE MADE FOR ROCK EXCAVATION.

FLOOD NOTE:

THIS PROPERTY LIES WITHIN FLOOD ZONE X, DEFINED AS AREAS OF DETERMINED TO BE OUTSIDE THE 0.2% ANNUAL CHANCE FLOODPLAIN, AS SHOWN ON THE FLOOD INSURANCE RATE MAP, PREPARED BY THE FEDERAL EMERGENCY AGENCY'S NATIONAL FLOOD INSURANCE PROGRAM FOR LEE'S SUMMIT, JACKSON COUNTY, MISSOURI, MAP NUMBER 29095C0409G AND DATED JANUARY 20, 2017.

SPECIFICATIONS

ALL WORK PERFORMED AND MATERIALS FURNISHED WITHIN PUBLIC RIGHT-OF-WAY SHALL BE IN ACCORDANCE WITH THE REQUIREMENTS OF CITY OF LEE'S SUMMIT, MISSOURI. THE CONSTRUCTION AND MATERIALS FOR THIS PROJECT SHALL BE IN ACCORDANCE WITH THE CURRENT SPECIFICATIONS OF THE "AMERICAN PUBLIC WORKS ASSOCIATION, KANSAS CITY METROPOLITAN CHAPTER" AND ARE HEREBY MADE THE SPECIFICATIONS FOR THIS SET OF PLANS BY REFERENCE AS THOUGH FULLY SET FORTH HEREIN.

NOTE:

1. BY USE OF THESE PLANS THE CONTRACTOR AGREES THAT HE/SHE SHALL BE SOLELY RESPONSIBLE FOR THE SAFETY OF THE CONSTRUCTION WORKERS AND OF THE PUBLIC.
2. ALL CONSTRUCTION SHALL CONFORM TO THE SPECIFICATIONS SET FORTH BY THE KANSAS CITY CHAPTER OF THE AMERICAN PUBLIC WORKS ASSOCIATION AND THE CITY OF LEE'S SUMMIT, MISSOURI, WHICHEVER IS MORE STRICT.
3. THE CONTRACTOR SHALL CONTACT THE CITY'S DEVELOPMENT SERVICES ENGINEERING INSPECTORS 48 HOURS PRIOR TO ANY LAND DISTURBANCE WORK AT (816)969-1200.



GENERAL LOCATION

PROJECT BENCHMARKS

BENCHMARK 1 ELEV.: 982.17
SET 5 PUNCH HOLES IN THE TOP OF A SOUTHWEST FLANGE BOLT ON A FIRE HYDRANT IN THE SOUTHEAST QUADRANT OF SOUTH RING ROAD AND DRIVE ENTRANCE SOUTHWEST OF THE HELICOPTER PAD.

BENCHMARK 2 ELEV.: 983.85
SET 5 PUNCH HOLES IN THE TOP OF A SOUTHWEST FLANGE BOLT ON A FIRE HYDRANT IN THE SOUTHEAST QUADRANT OF SOUTH RING ROAD AND PARK LOT E TO 50± DUE SOUTH OF THE SOUTHWEST CORNER OF MEDICAL OFFICE BUILDING.

LEGAL DESCRIPTION:

ALL OF LOT 1, SAINT LUKES HOSPITAL OF LEE'S SUMMIT LOTS 1 & 2, A SUBDIVISION OF LAND IN THE CITY OF LEE'S SUMMIT, JACKSON COUNTY, MISSOURI.

CIVIL INDEX OF SHEETS

	C000	REVISED FINAL DEVELOPMENT PLAN
LAND	C001	COVER SHEET
DISTURBANCE	C002	EXISTING CONDITIONS
PERMIT	C101	EROSION CONTROL PLAN-1
SUBMITTAL	C102	EROSION CONTROL PLAN-2
	C103	EROSION CONTROL DETAILS-1
	C104	EROSION CONTROL DETAILS-2
	C200	GRADING PLAN
	C201	DEMOLITION PLAN
	C202	TREE CLEARING PLAN
	C203	SITE PLAN
	C403	ENLARGED GRADING PLAN-1
	C404	ENLARGED GRADING PLAN-2
	C405	ENLARGED GRADING PLAN-3
	C406	ENLARGED GRADING PLAN-4
	C407	ENLARGED GRADING PLAN-5
	C408	ENLARGED GRADING PLAN-6
	C409	RETAINING WALL PLAN & PROFILES
	C501	UTILITY SERVICE PLAN
	C502	UTILITY SERVICE PROFILES
	C601	DETAILS-1
	C602	DETAILS-2
	E101	SITE LIGHTING
	E102	LIGHTING DETAILS

DESIGN ENGINEER

MATT EBLEN
1700 SWIFT AVE, SUITE 100
NORTH KANSAS CITY, MO
913-307-2588
MEBLEN@MECRESULTS.COM

PREPARED & SUBMITTED BY:

McCLURE
1700 SWIFT STREET, SUITE 100
NORTH KANSAS CITY, MISSOURI 64116

ENGINEER

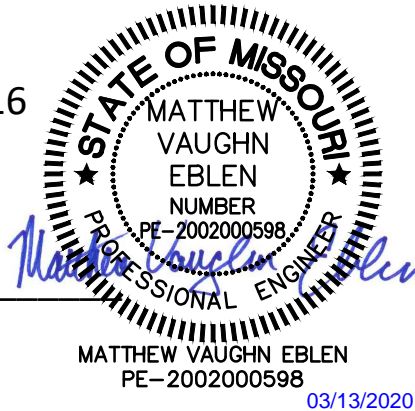

DATE

ACCEPTED BY:

DATE

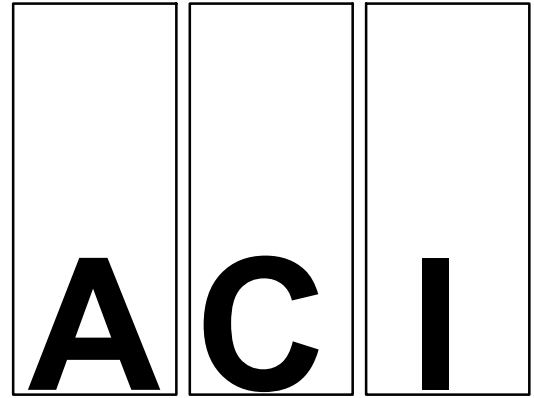

BOLAND
ARCHITECTS

1710 Wyandotte
Kansas City, MO 64108
T: 816.763.9000
ACI/Boland, Inc.
Kansas City | St. Louis
Licensee's Certificate of Authority Number:

CIVIL CONSULTANT

McClure Engineering Company
1700 Swift Ave., Suite 100
North Kansas City, MO 64116
Phone Number: 816.756.0444
Licensee's Certificate of Authority Number:

STRUCTURAL CONSULTANT

Structural Engineering Associates
1000 Walnut Street, Suite 1570
Kansas City, MO 64106
Phone Number: 816.421.1042
Licensee's Certificate of Authority Number:

MEP CONSULTANT

W.L. Cassell & Associates, Inc.
1600 Baltimore, Suite 300
Kansas City, MO 64108
Phone Number: 816.842.8437
Licensee's Certificate of Authority Number:

Saint Luke's East Hospital
Flex Facility Expansion
100 NE Saint Luke's Blvd
Lee's Summit, MO 64086
Construction Documents

Date	2.21.2020
Job Number	3-19092
Drawn By	KRM
Checked By	MVE

Revision		
Number	Date	Description
1	03.02.2020	Addendum #1
2	03.12.2020	CITY COMMENTS

C001

© 2020 ACI/BOLAND, Inc.

COVER SHEET



PROJECT LOCATION

STATE OF MISSOURI

MATTHEW VAUGHN

EBLEN

NUMBER

PE-200200098

PROFESSIONAL ENGINEER

MATTHEW VAUGHN EBLEN

PE-200200098

03/13/2020

ACI

BOLAND

ARCHITECTS

1710 Wyandotte

Kansas City, MO 64108

T: 816.763.9000

ACI/Boland, Inc.

Kansas City | St. Louis

Licensee's Certificate of Authority Number:

CIVIL CONSULTANT

McClure Engineering Company

1700 Swift Ave., Suite 100

North Kansas City, MO 64116

Phone Number: 816.756.0444

Licensee's Certificate of Authority Number:

STRUCTURAL CONSULTANT

Structural Engineering Associates

1000 Walnut Street, Suite 1570

Kansas City, MO 64106

Phone Number: 816.421.1042

Licensee's Certificate of Authority Number:

MEP CONSULTANT

W.L. Cassell & Associates, Inc.

1600 Baltimore, Suite 300

Kansas City, MO 64108

Phone Number: 816.842.8437

Licensee's Certificate of Authority Number:

Saint Luke's East Hospital

Flex Facility Expansion

100 NE Saint Luke's Blvd

Lee's Summit, MO 64086

Construction Documents

Date	2.21.2020
Job Number	3-19092
Drawn By	KRM
Checked By	MVE

Revision		
Number	Date	Description

C002

© 2020 ACI/BOLAND, Inc.

EXISTING CONDITIONS

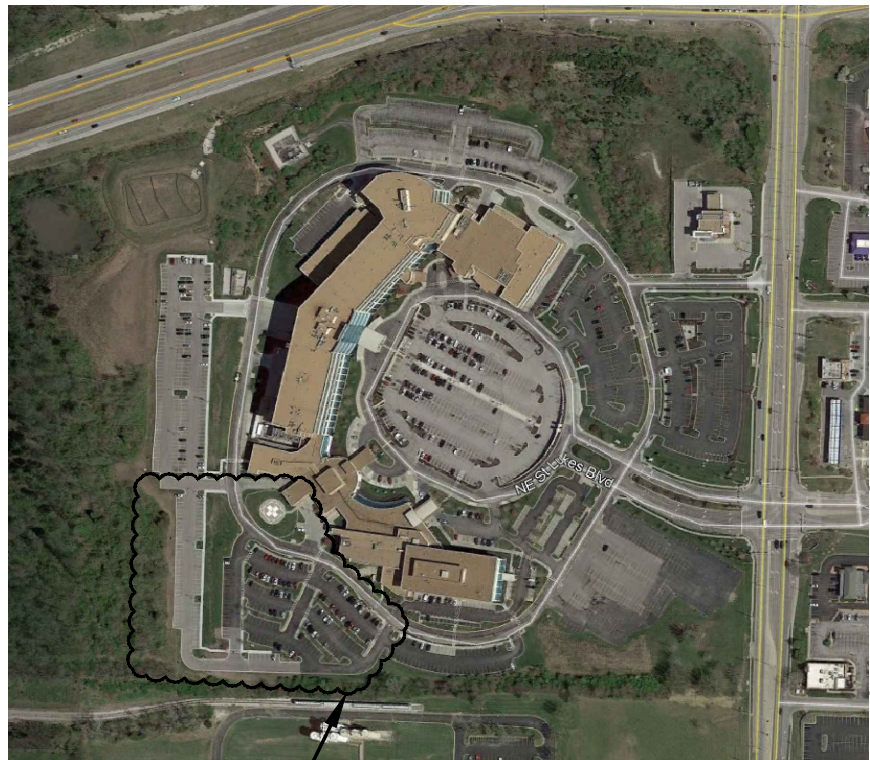

PROJECT LOCATION

EROSION CONTROL LEGEND

- SILT FENCE
- WATTLE BARRIER
- CONSTRUCTION ENTRANCE
- GRAVEL DROP INLET SEDIMENT TRAP
- CURB INLET SEDIMENT BARRIER
- EXISTING 1' CONTOUR
- EXISTING 5' CONTOUR
- PROPOSED 1' CONTOUR
- PROPOSED 5' CONTOUR

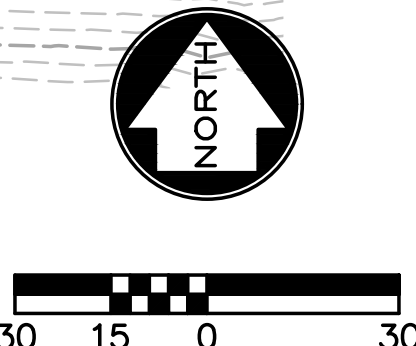
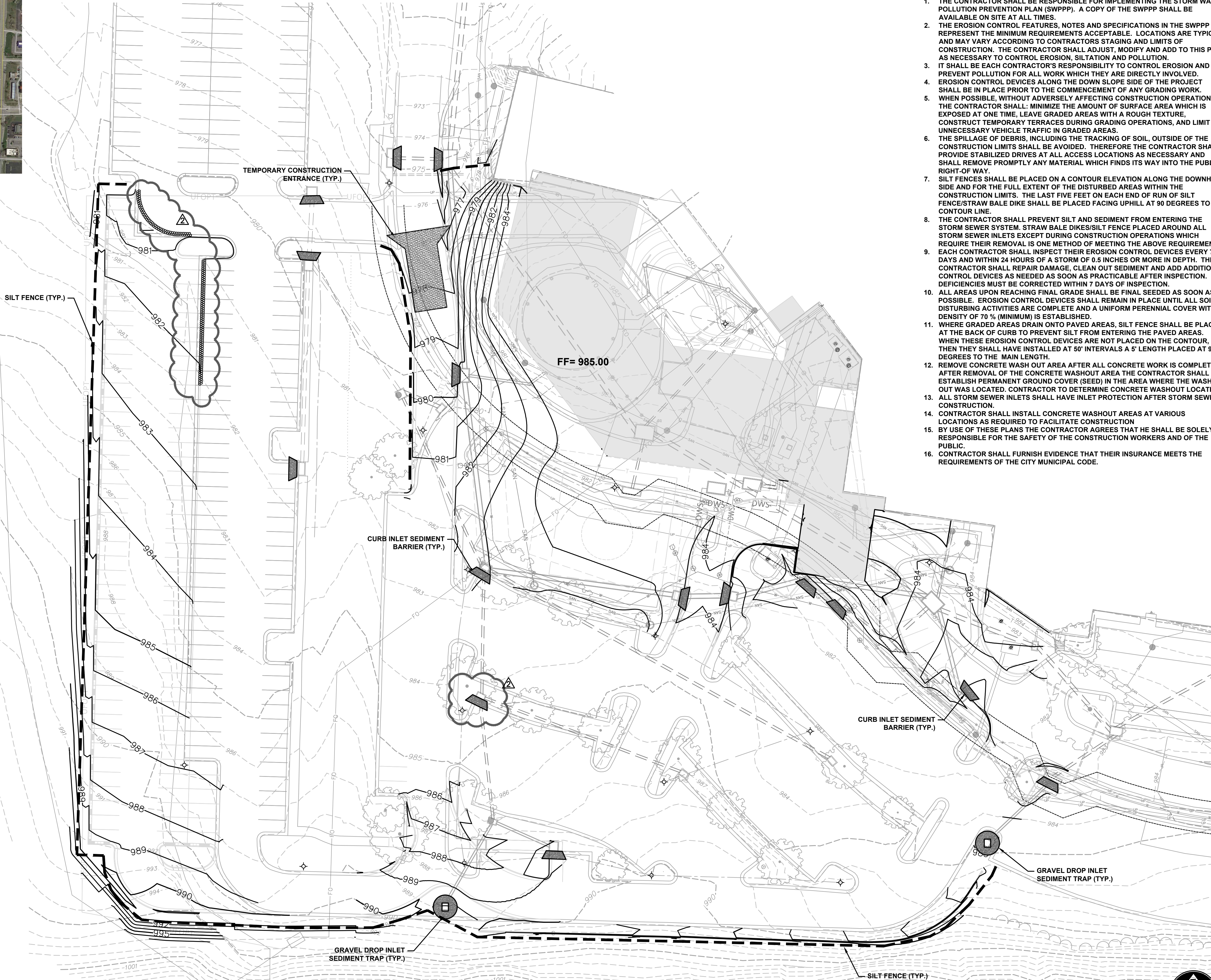

- NOTES:
1. THE CONTRACTOR SHALL BE RESPONSIBLE FOR IMPLEMENTING THE STORM WATER POLLUTION PREVENTION PLAN (SWPPP). A COPY OF THE SWPPP SHALL BE AVAILABLE ON SITE AT ALL TIMES.
 2. THE EROSION CONTROL FEATURES, NOTES AND SPECIFICATIONS IN THE SWPPP REPRESENT THE MINIMUM REQUIREMENTS ACCEPTABLE. LOCATIONS ARE TYPICAL AND MAY VARY ACCORDING TO CONTRACTORS STAGING AND LIMITS OF CONSTRUCTION. THE CONTRACTOR SHALL ADJUST, MODIFY AND ADD TO THIS PLAN AS NECESSARY TO CONTROL EROSION, SILTATION AND POLLUTION.
 3. IT SHALL BE EACH CONTRACTOR'S RESPONSIBILITY TO CONTROL EROSION AND PREVENT POLLUTION FOR ALL WORK WHICH THEY ARE DIRECTLY INVOLVED.
 4. EROSION CONTROL DEVICES ALONG THE DOWN SLOPE SIDE OF THE PROJECT SHALL BE IN PLACE PRIOR TO THE COMMENCEMENT OF ANY GRADING WORK.
 5. WHEN POSSIBLE, WITHOUT ADVERSELY AFFECTING CONSTRUCTION OPERATIONS, THE CONTRACTOR SHALL: MINIMIZE THE AMOUNT OF SURFACE AREA WHICH IS EXPOSED AT ONE TIME. LEAVE GRADED AREAS WITH A ROUGH TEXTURE. CONSTRUCT TEMPORARY TERRACES DURING GRADING OPERATIONS, AND LIMIT UNNECESSARY VEHICLE TRAFFIC IN GRADED AREAS.
 6. THE SPILLAGE OF DEBRIS, INCLUDING THE TRACKING OF SOIL, OUTSIDE OF THE CONSTRUCTION LIMITS SHALL BE AVOIDED. THEREFORE THE CONTRACTOR SHALL PROVIDE STABILIZED DRIVES AT ALL ACCESS LOCATIONS AS NECESSARY AND SHALL REMOVE PROMPTLY ANY MATERIAL WHICH FINDS ITS WAY INTO THE PUBLIC RIGHT-OF WAY.
 7. SILT FENCES SHALL BE PLACED ON A CONTOUR ELEVATION ALONG THE DOWNHILL SIDE AND FOR THE FULL EXTENT OF THE DISTURBED AREAS WITHIN THE CONSTRUCTION LIMITS. THE LAST FIVE FEET ON EACH END OF RUN OF SILT FENCE/STRAW BALE DIKE SHALL BE PLACED FACING UPHILL AT 90 DEGREES TO THE CONTOUR LINE.
 8. THE CONTRACTOR SHALL PREVENT SILT AND SEDIMENT FROM ENTERING THE STORM SEWER SYSTEM. STRAW BALE DIKES/SILT FENCE PLACED AROUND ALL STORM SEWER INLETS EXCEPT DURING CONSTRUCTION OPERATIONS WHICH REQUIRE THEIR REMOVAL IS ONE METHOD OF MEETING THE ABOVE REQUIREMENT.
 9. EACH CONTRACTOR SHALL INSPECT THEIR EROSION CONTROL DEVICES EVERY 7 DAYS AND WITHIN 24 HOURS OF A STORM OF 0.5 INCHES OR MORE IN DEPTH. THE CONTRACTOR SHALL REPAIR DAMAGE, CLEAN OUT SEDIMENT AND ADD ADDITIONAL CONTROL DEVICES AS NEEDED AS SOON AS PRACTICABLE AFTER INSPECTION. DEFICIENCIES MUST BE CORRECTED WITHIN 7 DAYS OF INSPECTION.
 10. ALL AREAS UPON REACHING FINAL GRADE SHALL BE FINAL SEEDDED AS SOON AS POSSIBLE. EROSION CONTROL DEVICES SHALL REMAIN IN PLACE UNTIL ALL SOIL DISTURBING ACTIVITIES ARE COMPLETE AND A UNIFORM PERENNIAL COVER WITH A DENSITY OF 70 % (MINIMUM) IS ESTABLISHED.
 11. WHERE GRADED AREAS DRAIN ONTO PAVED AREAS, SILT FENCE SHALL BE PLACED AT THE BACK OF CURB TO PREVENT SILT FROM ENTERING THE PAVED AREAS. WHEN THESE EROSION CONTROL DEVICES ARE NOT PLACED ON THE CONTOUR, THEN THEY SHALL HAVE INSTALLED AT 50' INTERVALS A 5' LENGTH PLACED AT 90 DEGREES TO THE MAIN LENGTH.
 12. REMOVE CONCRETE WASH OUT AREA AFTER ALL CONCRETE WORK IS COMPLETE. AFTER REMOVAL OF THE CONCRETE WASHOUT AREA THE CONTRACTOR SHALL ESTABLISH PERMANENT GROUND COVER (SEED) IN THE AREA WHERE THE WASH OUT WAS LOCATED. CONTRACTOR TO DETERMINE CONCRETE WASHOUT LOCATION.
 13. ALL STORM SEWER INLETS SHALL HAVE INLET PROTECTION AFTER STORM SEWER CONSTRUCTION.
 14. CONTRACTOR SHALL INSTALL CONCRETE WASHOUT AREAS AT VARIOUS LOCATIONS AS REQUIRED TO FACILITATE CONSTRUCTION
 15. BY USE OF THESE PLANS THE CONTRACTOR AGREES THAT HE SHALL BE SOLELY RESPONSIBLE FOR THE SAFETY OF THE CONSTRUCTION WORKERS AND OF THE PUBLIC.
 16. CONTRACTOR SHALL FURNISH EVIDENCE THAT THEIR INSURANCE MEETS THE REQUIREMENTS OF THE CITY MUNICIPAL CODE.

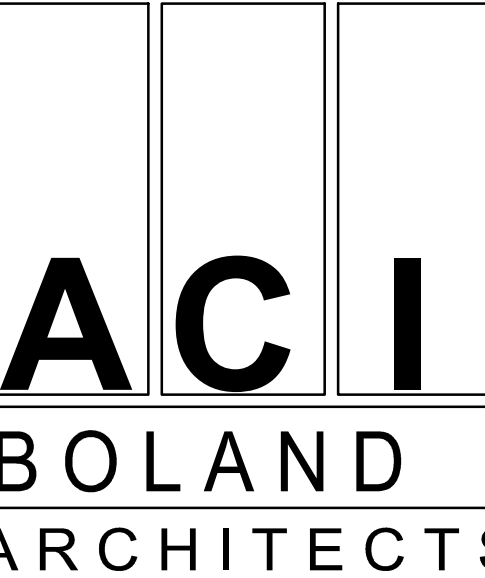

1710 Wyandotte
Kansas City, MO 64108
T: 816.763.9000
ACI/Boland, Inc.
Kansas City | St. Louis
Licensee's Certificate of Authority Number:

CIVIL CONSULTANT

McClure Engineering Company
1700 Swift Ave., Suite 100
North Kansas City, MO 64116
Phone Number: 816.756.0444
Licensee's Certificate of Authority Number:

STRUCTURAL CONSULTANT

Structural Engineering Associates
1000 Walnut Street, Suite 1570
Kansas City, MO 64106
Phone Number: 816.421.1042
Licensee's Certificate of Authority Number:

MEP CONSULTANT

W.L. Cassell & Associates, Inc.
1600 Baltimore, Suite 300
Kansas City, MO 64108
Phone Number: 816.842.8437
Licensee's Certificate of Authority Number:

Saint Luke's East Hospital
Flex Facility Expansion
100 NE Saint Luke's Blvd
Lee's Summit, MO 64086
Construction Documents

Date	2.21.2020
Job Number	3-19092
Drawn By	KRM
Checked By	MVE

Revision		
Number	Date	Description
2	03.12.2020	CITY COMMENTS



PROJECT LOCATION



- NOTES:
1. THE CONTRACTOR SHALL BE RESPONSIBLE FOR IMPLEMENTING THE STORM WATER POLLUTION PREVENTION PLAN (SWPPP). A COPY OF THE SWPPP SHALL BE AVAILABLE ON SITE AT ALL TIMES.
 2. THE EROSION CONTROL FEATURES, NOTES AND SPECIFICATIONS IN THE SWPPP REPRESENT THE MINIMUM REQUIREMENTS ACCEPTABLE. LOCATIONS ARE TYPICAL AND MAY VARY ACCORDING TO CONTRACTORS STAGING AND LIMITS OF CONSTRUCTION. THE CONTRACTOR SHALL ADJUST, MODIFY AND ADD TO THIS PLAN AS NECESSARY TO CONTROL EROSION, SILTATION AND POLLUTION. IT SHALL BE EACH CONTRACTOR'S RESPONSIBILITY TO CONTROL EROSION AND PREVENT POLLUTION FOR ALL WORK WHICH THEY ARE DIRECTLY INVOLVED.
 3. EROSION CONTROL DEVICES ALONG THE DOWN SLOPE SIDE OF THE PROJECT SHALL BE IN PLACE PRIOR TO THE COMMENCEMENT OF ANY GRADING WORK.
 4. WHEN POSSIBLE, WITHOUT ADVERSELY AFFECTING CONSTRUCTION OPERATIONS, THE CONTRACTOR SHALL: MINIMIZE THE AMOUNT OF SURFACE AREA WHICH IS EXPOSED AT ONE TIME, LEAVE GRADED AREAS WITH A ROUGH TEXTURE, CONSTRUCT TEMPORARY TERRACES DURING GRADING OPERATIONS, AND LIMIT UNNECESSARY VEHICLE TRAFFIC IN GRADED AREAS.
 5. THE SPILLAGE OF DEBRIS, INCLUDING THE TRACKING OF SOIL, OUTSIDE OF THE CONSTRUCTION LIMITS SHALL BE AVOIDED. THEREFORE THE CONTRACTOR SHALL PROVIDE STABILIZED DRIVES AT ALL ACCESS LOCATIONS AS NECESSARY AND SHALL REMOVE PROMPTLY ANY MATERIAL WHICH FINDS ITS WAY INTO THE PUBLIC RIGHT-OF-WAY.
 6. SILT FENCES SHALL BE PLACED ON A CONTOUR ELEVATION ALONG THE DOWNHILL SIDE AND FOR THE FULL EXTENT OF THE DISTURBED AREAS WITHIN THE CONSTRUCTION LIMITS. THE LAST FIVE FEET ON EACH END OF RUN OF SILT FENCE/STRAW BALE DIKE SHALL BE PLACED FACING UPHILL AT 90 DEGREES TO THE CONTOUR LINE.
 7. THE CONTRACTOR SHALL PREVENT SILT AND SEDIMENT FROM ENTERING THE STORM SEWER SYSTEM. STRAW BALE DIKES/SILT FENCE PLACED AROUND ALL STORM SEWER INLETS EXCEPT DURING CONSTRUCTION OPERATIONS WHICH REQUIRE THEIR REMOVAL IS ONE METHOD OF MEETING THE ABOVE REQUIREMENT.
 8. EACH CONTRACTOR SHALL INSPECT THEIR EROSION CONTROL DEVICES EVERY 7 DAYS AND WITHIN 24 HOURS OF A STORM OF 0.5 INCHES OR MORE IN DEPTH. THE CONTRACTOR SHALL REPAIR DAMAGE, CLEAN OUT SEDIMENT AND ADD ADDITIONAL CONTROL DEVICES AS NEEDED AS SOON AS PRACTICABLE AFTER INSPECTION. DEFICIENCIES MUST BE CORRECTED WITHIN 7 DAYS OF INSPECTION.
 9. ALL AREAS UPON REACHING FINAL GRADE SHALL BE FINAL SEED AS SOON AS POSSIBLE. EROSION CONTROL DEVICES SHALL REMAIN IN PLACE UNTIL ALL SOIL DISTURBING ACTIVITIES ARE COMPLETE AND A UNIFORM PERENNIAL COVER WITH A DENSITY OF 70 % (MINIMUM) IS ESTABLISHED.
 10. WHERE GRADED AREAS DRAIN ONTO PAVED AREAS, SILT FENCE SHALL BE PLACED AT THE BACK OF CURB TO PREVENT SILT FROM ENTERING THE PAVED AREAS. WHEN THESE EROSION CONTROL DEVICES ARE NOT PLACED ON THE CONTOUR, THEN THEY SHALL HAVE INSTALLED AT 50' INTERVALS A 5' LENGTH PLACED AT 90 DEGREES TO THE MAIN LENGTH.
 11. ALL STORM SEWER INLETS SHALL HAVE INLET PROTECTION AFTER STORM SEWER CONSTRUCTION.
 12. CONTRACTOR SHALL INSTALL CONCRETE WASHOUT AREAS AT VARIOUS LOCATIONS AS REQUIRED TO FACILITATE CONSTRUCTION.
 13. BY USE OF THESE PLANS THE CONTRACTOR AGREES THAT HE SHALL BE SOLELY RESPONSIBLE FOR THE SAFETY OF THE CONSTRUCTION WORKERS AND OF THE PUBLIC. CONTRACTOR SHALL FURNISH EVIDENCE THAT THEIR INSURANCE MEETS THE REQUIREMENTS OF THE CITY MUNICIPAL CODE.
 - 15.

EROSION CONTROL LEGEND

- SILT FENCE
- EXISTING 1' CONTOUR
- EXISTING 5' CONTOUR
- ROCK DITCH CHECK
- WATTLE BARRIER

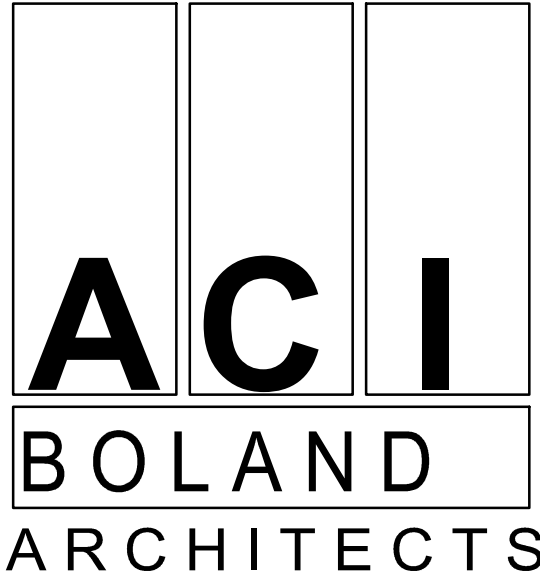
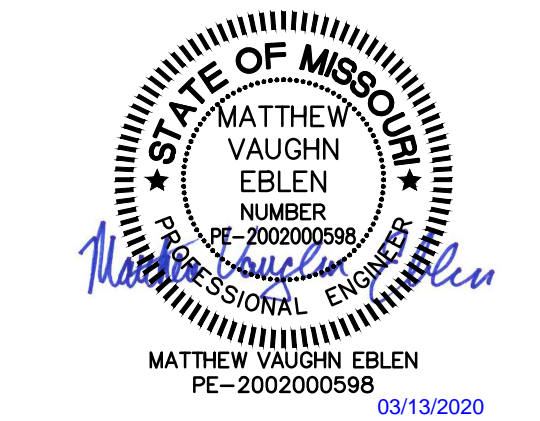
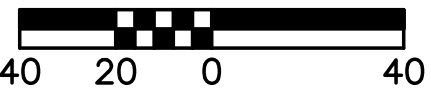

1710 Wyandotte
Kansas City, MO 64108
T: 816.763.9000
ACI/Boland, Inc.
Kansas City | St. Louis
Licensee's Certificate of Authority Number:

CIVIL CONSULTANT

McClure Engineering Company
1700 Swift Ave., Suite 100
North Kansas City, MO 64116
Phone Number: 816.756.0444
Licensee's Certificate of Authority Number:

STRUCTURAL CONSULTANT

Structural Engineering Associates
1000 Walnut Street, Suite 1570
Kansas City, MO 64106
Phone Number: 816.421.1042
Licensee's Certificate of Authority Number:

MEP CONSULTANT

W.L. Cassell & Associates, Inc.
1600 Baltimore, Suite 300
Kansas City, MO 64108
Phone Number: 816.842.8437
Licensee's Certificate of Authority Number:

Saint Luke's East Hospital
Flex Facility Expansion
100 NE Saint Luke's Blvd
Lee's Summit, MO 64086
Construction Documents

Date	2.21.2020
Job Number	3-19092
Drawn By	KRM
Checked By	MVE

Revision		
Number	Date	Description
2	03.12.2020	CITY COMMENTS

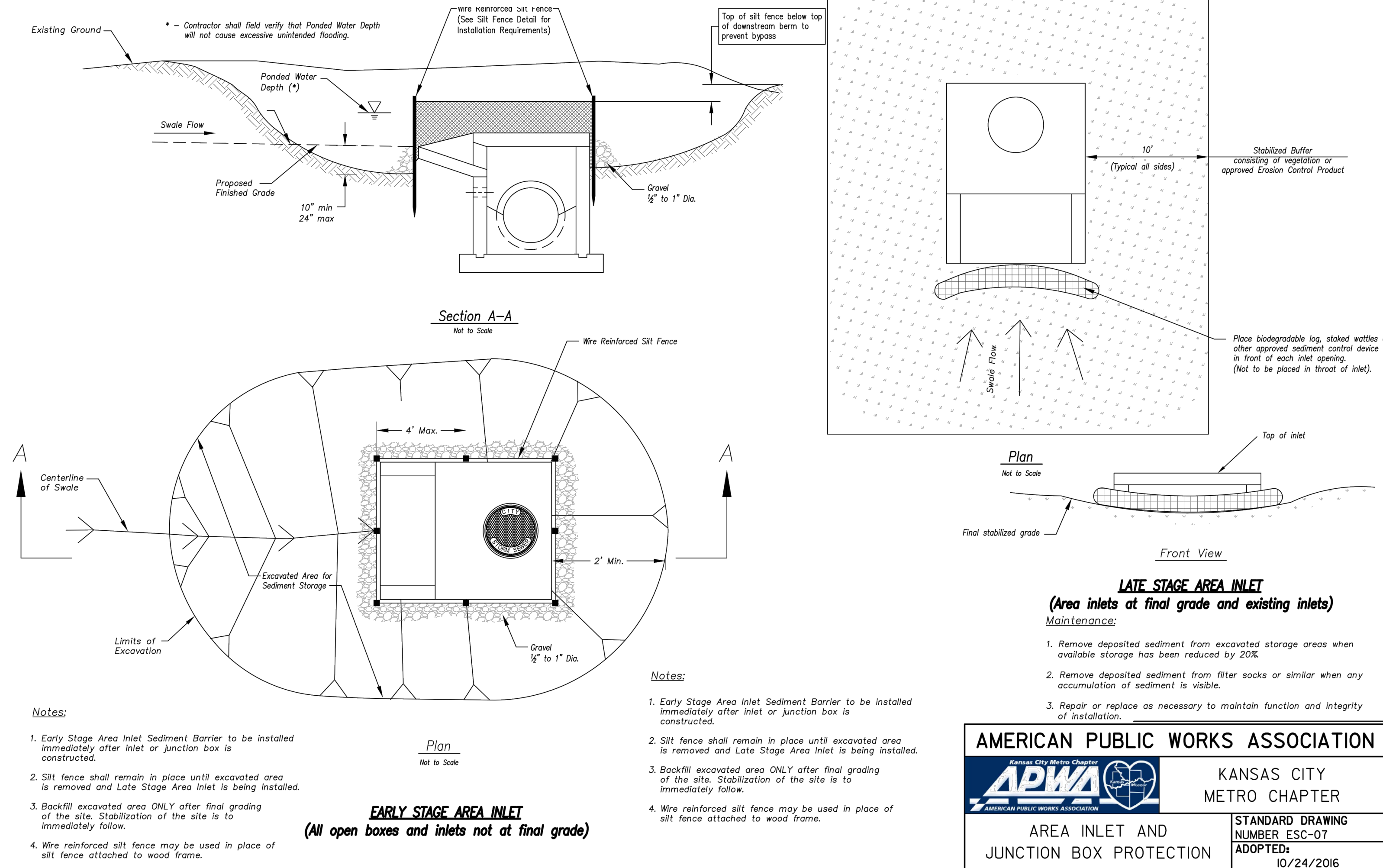
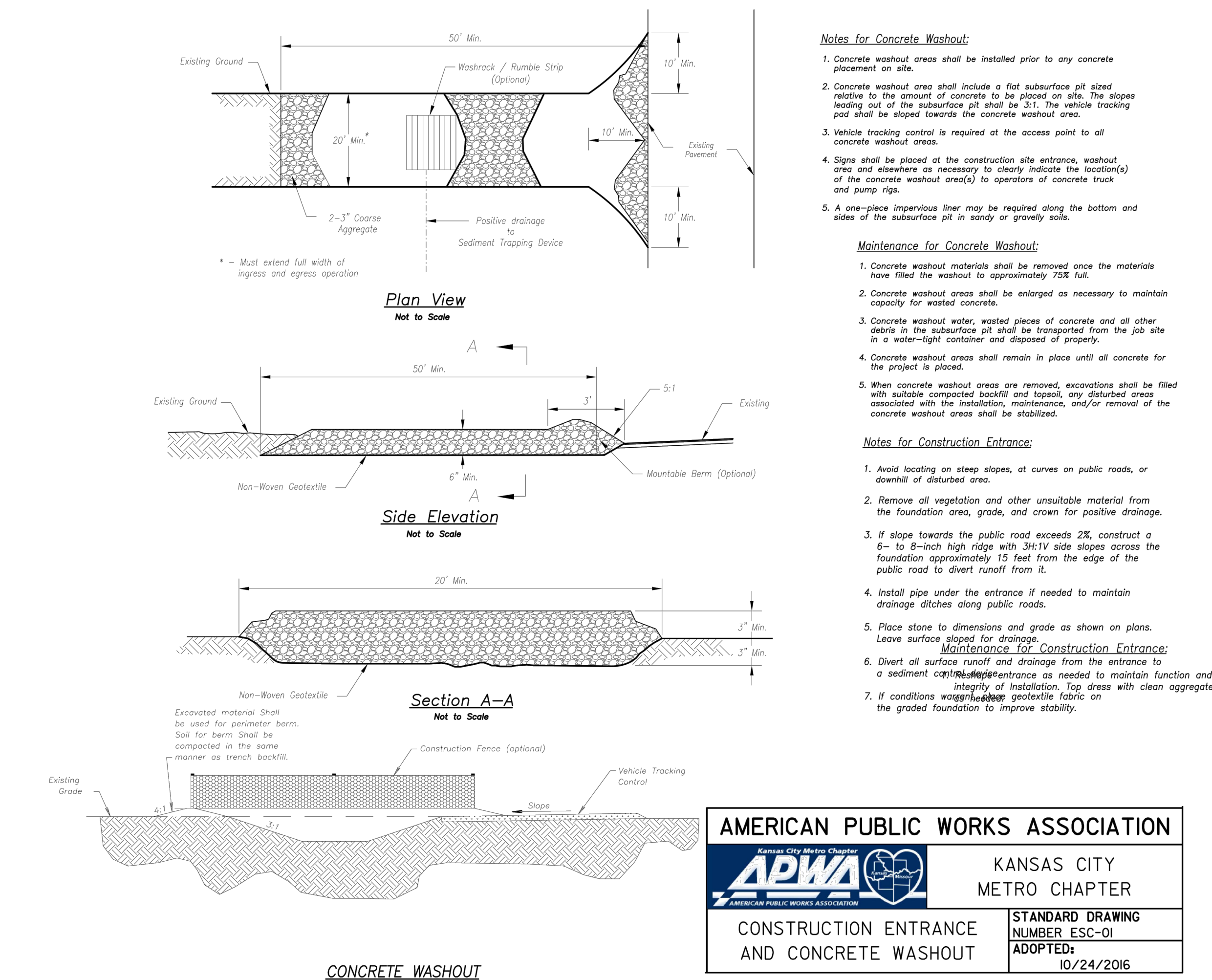
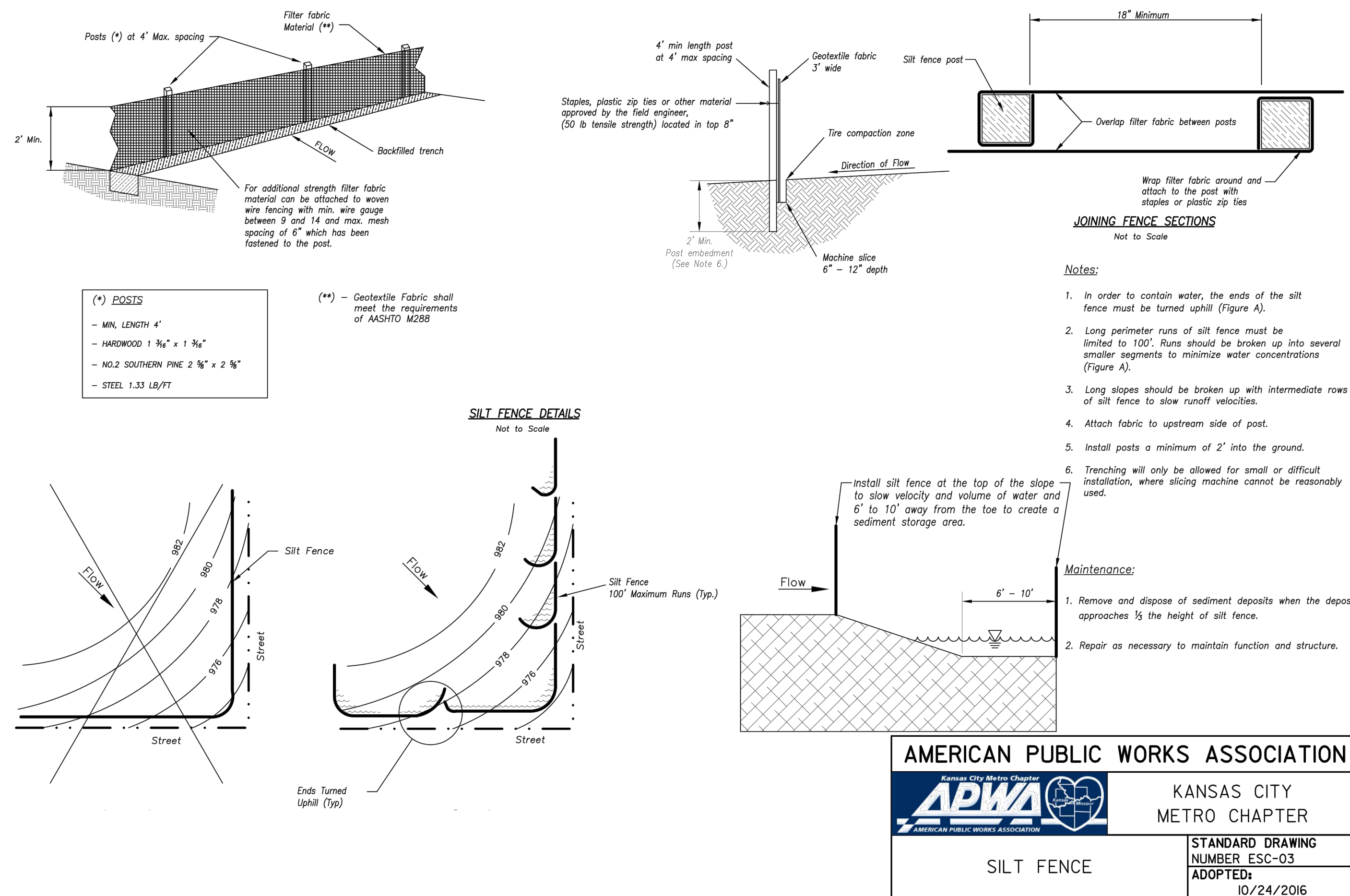
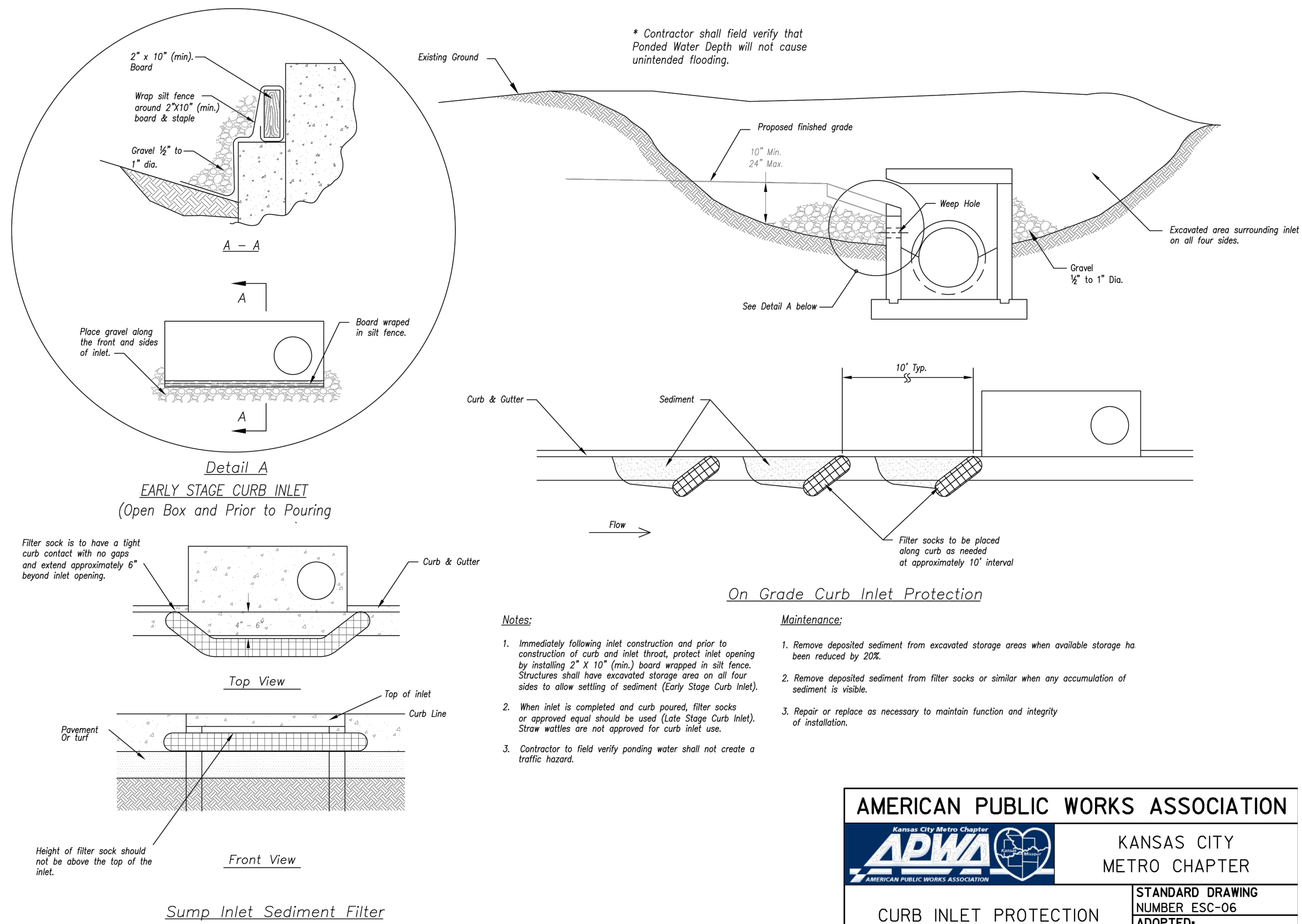

ACI BOLAND ARCHITECTS

1710 Wyandotte
Kansas City, MO 64108
T: 816.763.9500
ACI/Boland, Inc.
Kansas City | St. Louis
Licensee's Certificate of Authority Number:

CIVIL CONSULTANT

McClure Engineering Company
1700 Swift Ave., Suite 100
North Kansas City, MO 64116
Phone Number: 816.756.0444
Licensee's Certificate of Authority Number:

STRUCTURAL CONSULTANT

Structural Engineering Associates
1000 Walnut Street, Suite 1570
Kansas City, MO 64106
Phone Number: 816.421.1042
Licensee's Certificate of Authority Number:

MEP CONSULTANT

W.L. Cassell & Associates, Inc.
1600 Baltimore, Suite 300
Kansas City, MO 64108
Phone Number: 816.842.8437
Licensee's Certificate of Authority Number:

Saint Luke's East Hospital Flex Facility Expansion

100 NE Saint Luke's Blvd
Lee's Summit, MO 64086

Construction Documents

Date 2.21.2020
Job Number 3-19092
Drawn By KRM
Checked By MVE

Revision
Number Date Description
2 03.12.2020 CITY COMMENTS



Notes:



1. Rock check dams shall be used only for drainage areas less than 10 acres unless approved by the City Engineer.
2. Use rock checks only in situations where the ditch slope exceeds 6%.

Maintenance:

1. Remove and dispose of sediment deposits when the deposit approaches $\frac{1}{2}$ the height of the ditch check.
2. Replace and reshape as necessary to maintain function and integrity of installation.

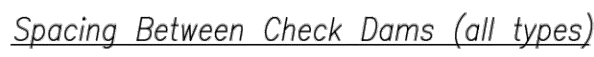
Modified from 2015 Overland Park Standard Details
for Erosion and Sediment Control.



<div> <div> <div>AMERICAN PUBLIC WORKS ASSOCIATION</div> <div> <div>Kansas City Metro Chapter</div> <div>  </div> </div> <div>  </div> <div> <div>KANSAS CITY</div> <div>METRO CHAPTER</div> </div> </div> </div>	
<div>ROCK DITCH CHECKS</div>	<div> <div>STANDARD DRAWING</div> <div>NUMBER ESC-10</div> <div>ADOPTED:</div> <div>10/24/2016</div> </div>

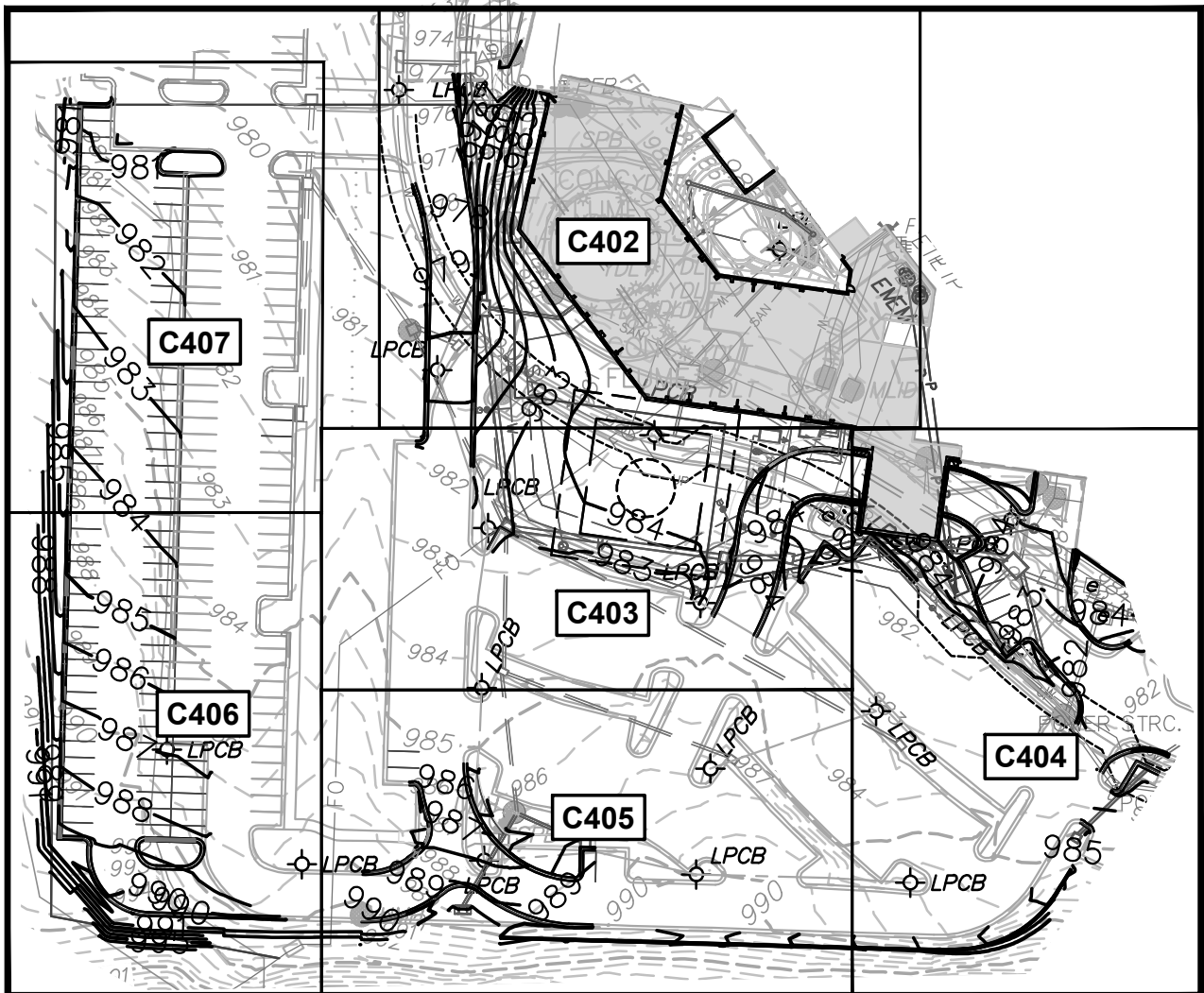
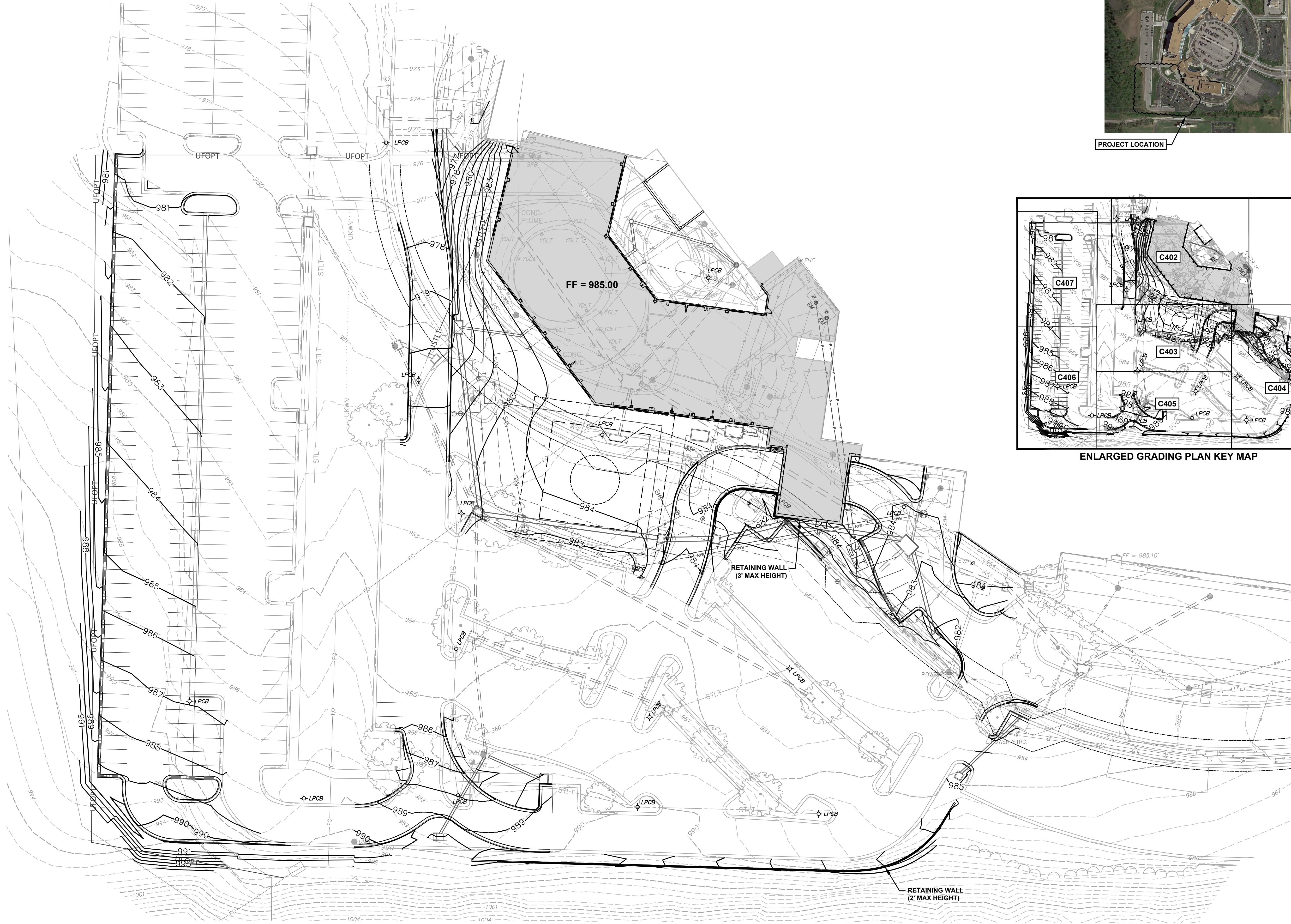

LEGEND

- 924 --- EXISTING 1' CONTOUR
- 925 --- EXISTING 5' CONTOUR
- 929 --- PROPOSED 1' CONTOUR
- 930 --- PROPOSED 5' CONTOUR

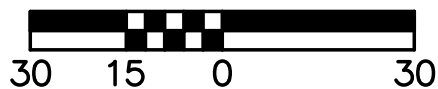

ACI
BOLAND
ARCHITECTS

1710 Wyandotte
Kansas City, MO 64108
T: 816.763.9000
ACI/Boland, Inc.
Kansas City | St. Louis
Licensee's Certificate of Authority Number:

CIVIL CONSULTANT
McClure Engineering Company
1700 Swift Ave., Suite 100
North Kansas City, MO 64116
Phone Number: 816.756.0444
Licensee's Certificate of Authority Number:

STRUCTURAL CONSULTANT
Structural Engineering Associates
1000 Walnut Street, Suite 1570
Kansas City, MO 64106
Phone Number: 816.421.1042
Licensee's Certificate of Authority Number:

MEP CONSULTANT
W.L. Cassell & Associates, Inc.
1600 Baltimore, Suite 300
Kansas City, MO 64108
Phone Number: 816.842.8437
Licensee's Certificate of Authority Number:

Saint Luke's East Hospital
Flex Facility Expansion
100 NE Saint Luke's Blvd
Lee's Summit, MO 64086
Construction Documents

Date 2.21.2020
Job Number 3-19092
Drawn By KRM
Checked By MVE

Number	Date	Description
2	03.12.2020	CITY COMMENTS

C200

© 2020 ACI/BOLAND, Inc.
GRADING PLAN

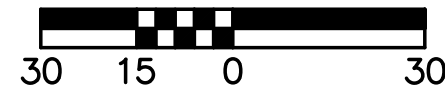

1. THE SCOPE OF DEMOLITION IS NOT LIMITED EXCLUSIVELY TO THE WORK INDICATED ON THE DEMOLITION PLAN. THE CONSTRUCTION DOCUMENTS ARE PROVIDED AS A GENERAL GUIDE FOR DEMOLITION. THE CONTRACTOR IS RESPONSIBLE FOR VERIFYING ADDITIONAL DEMOLITION THAT MAY BE REQUIRED FOR PROPER INSTALLATION OF NEW WORK. SEE ALL CONSTRUCTION DOCUMENTS FOR ADDITIONAL INFORMATION AND REQUIREMENTS.
2. ALL UTILITIES NOT SPECIFICALLY MARKED FOR DEMOLITION, SHALL BE PROTECTED THROUGHOUT CONSTRUCTION. SPECIAL SUPPORTS, BRACING ETC. SHOULD BE PROVIDED TO PROTECT EXISTING UTILITIES TO REMAIN.
3. THE CONTRACTOR SHALL SCHEDULE AND COORDINATE ALL UTILITY DEMOLITION, SHUTOFFS AND SWITCH OVERS WITH THE RESPECTIVE UTILITY COMPANY.
4. THE CONTRACTOR SHALL PROTECT ALL ITEMS, NOT SPECIFICALLY NOTED FOR DEMOLITION. IF ITEMS ARE DAMAGED BY CONSTRUCTION ACTIVITIES, THE CONTRACTOR SHALL REPAIR THE ITEMS AT NO ADDITIONAL COST TO THE OWNER.
5. THE CONTRACTOR SHALL REPAIR ALL SURROUNDING PAVEMENTS, SIDEWALKS AND CURBS DAMAGED BY CONSTRUCTION ACTIVITIES.
6. ALL UTILITIES INCLUDING, BUT NOT LIMITED TO, MANHOLES, UTILITY VALVES, CLEANOUTS AND INTAKES ARE TO BE ADJUSTED AND/OR REBUILT TO FINISHED GRADE AS REQUIRED.
7. THE CONTRACTOR IS RESPONSIBLE FOR MAINTAINING FLOW IN THE EXISTING STORM SEWER & SANITARY SEWER SYSTEMS THROUGHOUT CONSTRUCTION. TEMPORARY BYPASS PUMPING, OR DIVERSION PIPES MAY BE REQUIRED.
8. THE CONTRACTOR IS RESPONSIBLE FOR FIELD LOCATING THE EXISTING WATER SERVICES.
9. THE CONTRACTOR IS HEREBY ADVISED THAT NO FEDERALLY OWNED MAILBOX MAY BE DISTURBED. THE CONTRACTOR SHALL GIVE AT LEAST TWENTY-FOUR (24) HOURS ADVANCE NOTICE TO THE MANAGER OF DELIVERY AND COLLECTIONS. TAMPERING WITH FEDERAL MAIL FACILITIES MAY SUBJECT THE CONTRACTOR TO PROSECUTION BY THE FEDERAL GOVERNMENT.
10. THE CONTRACTOR IS RESPONSIBLE FOR THE PROTECTION OF ALL BOUNDARY CORNERS, PUBLIC LAND SURVEY SYSTEM ALIQUOT CORNERS, AND/OR BENCHMARKS. ANY BOUNDARY CORNER, PUBLIC LAND SURVEY SYSTEM ALIQUOT CORNER, AND/OR BENCHMARK DISTURBED OR DAMAGED BY CONSTRUCTION ACTIVITIES SHALL BE RESET BY A PROFESSIONAL LAND SURVEYOR LICENSED IN THE STATE OF MISSOURI AT THE CONTRACTOR'S EXPENSE.
11. ALL CONSTRUCTION DEMOLITION DEBRIS SHALL BE DISPOSED OF OFF-SITE AND IN FULL COMPLIANCE WITH CURRENT ENVIRONMENTAL REGULATIONS.
12. ALL UTILITIES MUST BE PLACED SUCH THAT THE HOSPITAL HAS SERVICE TO ALL UTILITIES THROUGHOUT CONSTRUCTION.

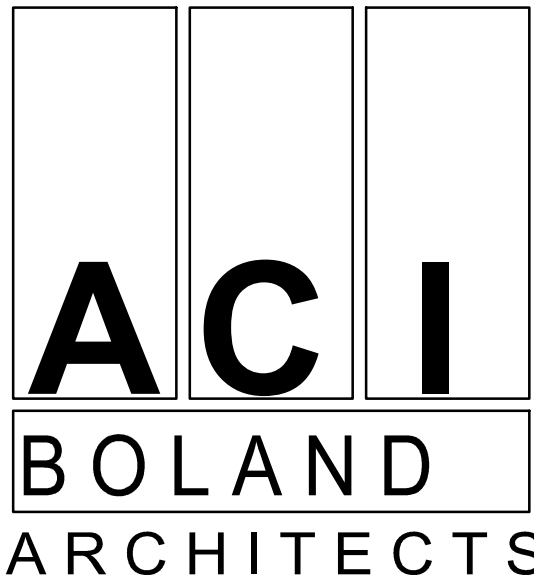

1710 Wyandotte
Kansas City, MO 64108
T: 816.763.9600
ACI/Boland, Inc.
Kansas City | St. Louis
Licensee's Certificate of Authority Number:

McClure Engineering Company
1700 Swift Ave., Suite 100
North Kansas City, MO 64116
Phone Number: 816.756.0444
Licensee's Certificate of Authority Number:

Structural Engineering Associates
1000 Walnut Street, Suite 1570
Kansas City, MO 64106
Phone Number: 816.421.1042
Licensee's Certificate of Authority Number:

W.L. Cassell & Associates, Inc.
1600 Baltimore, Suite 300
Kansas City, MO 64108
Phone Number: 816.842.8437
Licensee's Certificate of Authority Number:

Saint Luke's East Hospital
Flex Facility Expansion
100 NE Saint Luke's Blvd
Lee's Summit, MO 64086
Construction Documents

Date	2.21.2020
Job Number	3-19092
Drawn By	KRM
Checked By	MVE

Revision		
Number	Date	Description
1	03.02.2020	Addendum #1
2	03.12.2020	CITY COMMENT

© 2020 ACI/BOLAND, Inc

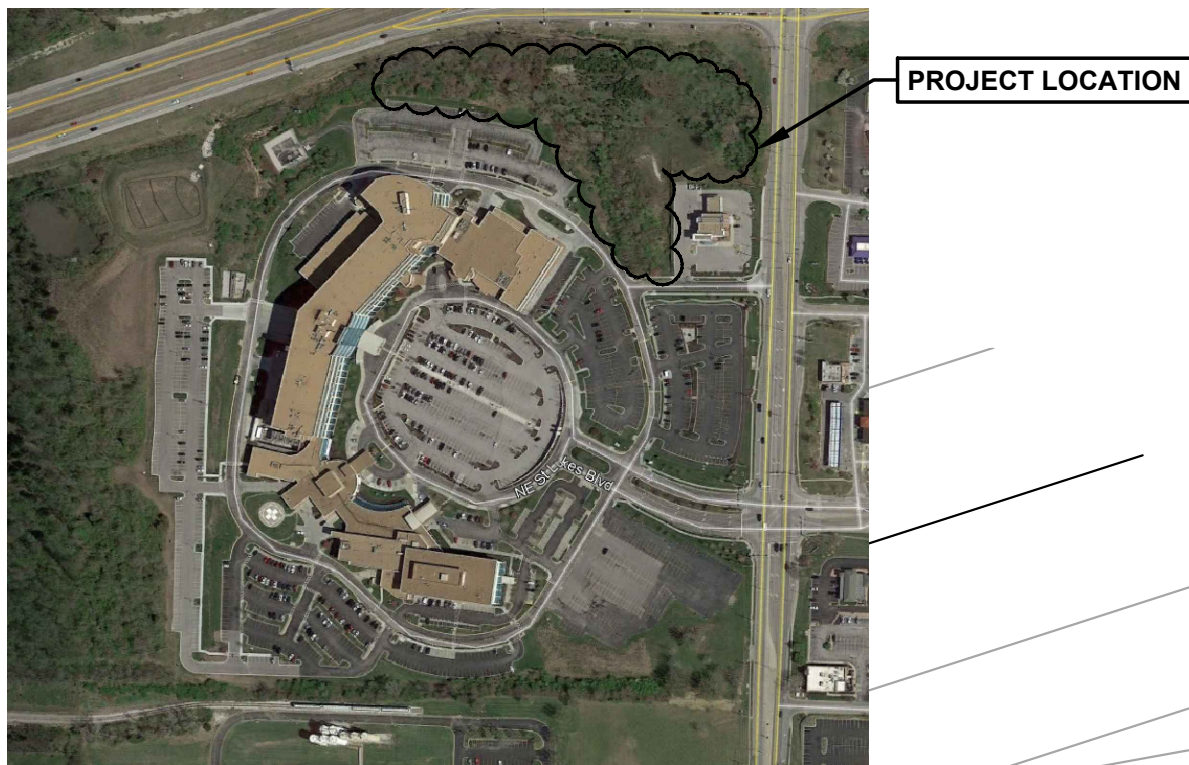

NOTES

1. ALL TREES SHALL BE CUT DOWN WITHIN THE CONSTRUCTION LIMITS SHOWN.
2. NO FELLED TREES MAY BE LEFT WITHIN EITHER THE WETLAND OR WETLAND BUFFER LIMITS.
3. ALL TREES SHALL BE CUT DOWN PRIOR TO APRIL 1, 2020.
4. ALL TREES TO BE CUT DOWN WITHIN THE EMERGENT WETLANDS AND EMERGENT WETLAND BUFFER LIMITS SHALL BE REMOVED BY SAWING (NO MACHINE TREE REMOVAL EQUIPMENT SHALL BE USED) WITH MINIMAL DISTURBANCE TO THE GROUND. THE TREES SHALL BE CUT AND STUMPS LEFT 4 FEET ABOVE EXISTING GRADE.
5. CONTRACTOR TO REMOVE CUT DOWN TREES FROM THE SITE.
6. CONTRACTOR MAY USE MECHANICAL EQUIPMENT TO CUT DOWN TREES OUTSIDE THE DELINEATED EMERGENT WETLANDS BUFFER.

LEGEND
DENOTES TREES TO BE CLEARED

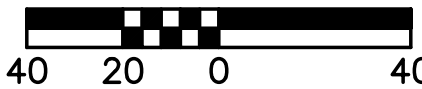

ACI
BOLAND
ARCHITECTS

1710 Wyandotte
Kansas City, MO 64108
T: 816.763.9000

ACI/Boland, Inc.
Kansas City | St. Louis
Licensee's Certificate of Authority Number:

CIVIL CONSULTANT

McClure Engineering Company
1700 Swift Ave., Suite 100
North Kansas City, MO 64116
Phone Number: 816.756.0444
Licensee's Certificate of Authority Number:

STRUCTURAL CONSULTANT

Structural Engineering Associates
1000 Walnut Street, Suite 1570
Kansas City, MO 64106
Phone Number: 816.421.1042
Licensee's Certificate of Authority Number:

MEP CONSULTANT

W.L. Cassell & Associates, Inc.
1600 Baltimore, Suite 300
Kansas City, MO 64108
Phone Number: 816.842.8437
Licensee's Certificate of Authority Number:

Saint Luke's East Hospital
Flex Facility Expansion
100 NE Saint Luke's Blvd
Lee's Summit, MO 64086
Construction Documents

Date: 2.21.2020
Job Number: 3-19092
Drawn By: KRM
Checked By: MVE

Revision		
Number	Date	Description
2	03.12.2020	CITY COMMENTS

C202

© 2020 ACI/BOLAND, Inc.

TREE CLEARING PLAN