



SCALE: 1"=20'

PREPARED FOR:
NEW MARK HOMES-KC

PLOT PLAN

LOT 9

WHISPERING WOODS FIRST PLAT

1905 SW. RIVER RUN DRIVE

This approval is issued in reliance upon information submitted by the applicant. Any permit issued pursuant to this approval may be suspended or revoked whenever the permit is issued in error, or on the basis of incorrect information supplied, or in violation of any ordinance or regulation. Approved plans shall not be changed, modified or altered without authorization. The issuance or granting of a permit or approval of plans shall not be construed to be a permit for, or an approval of, any violation of any of the provisions of the ordinance of the City of Lee's Summit, Missouri.

APPROVED SC DATE 1/10/20
PRINT NAME _____

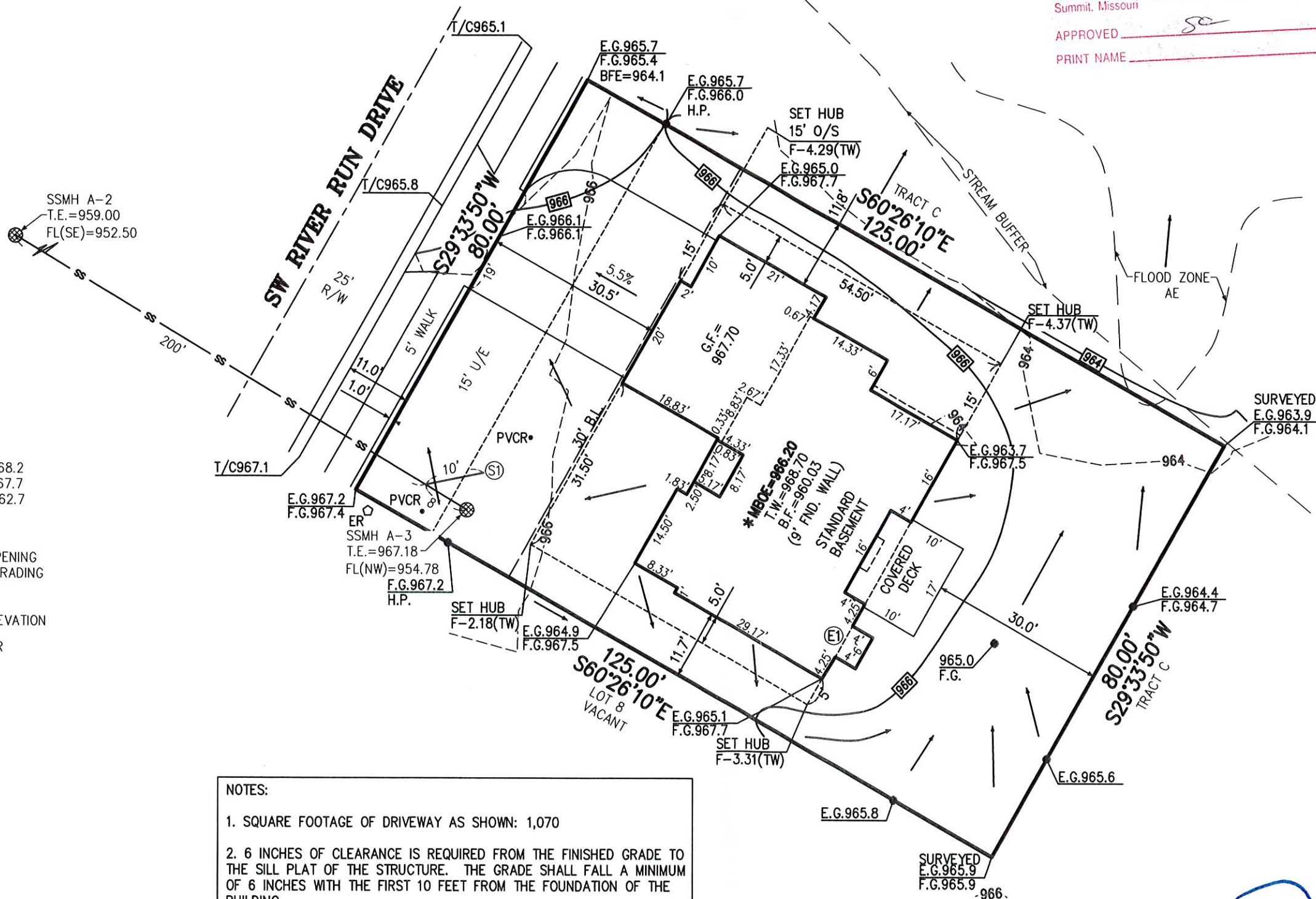

LEGEND

(S1) MSFE=958.72
10 LF 4" PVC
200' DDS
FL@EOS=955.89

(E1) WRWW
TOP EGRESS WELL=968.2
F.G. EGRESS WELL=967.7
TOP EGRESS WALL=962.7
3' WALL

* = MBOE=966.20
MINIMUM BUILDING OPENING
ELEVATION AS PER GRADING
PLAN
100YR WSEL=964.20
BFE=BASE FLOOD ELEVATION
MBOE=GARAGE FLOOR
967.70 AS SHOWN

NOTES:

- SQUARE FOOTAGE OF DRIVEWAY AS SHOWN: 1,070
- 6 INCHES OF CLEARANCE IS REQUIRED FROM THE FINISHED GRADE TO THE SILL PLAT OF THE STRUCTURE. THE GRADE SHALL FALL A MINIMUM OF 6 INCHES WITH THE FIRST 10 FEET FROM THE FOUNDATION OF THE BUILDING.
- A AS GRADED PLOT PLAN PER SECTION 7-160, CODE OF ORDINANCES IS REQUIRED PRIOR TO OCCUPANCY, AS GRADED PLOT PLAN IS REQUIRED PRIOR TO SODDING.
- FOUNDATION ELEVATION CERTIFICATE REQUIRED PRIOR TO OCCUPANCY.
- REVISED: 12-31-19 CITY COMMENTS

LOT AREA=10,000 SQ. FT.

DATE STAKED: 11-25-19
SURVEY CREW: ML
HOUSE TIES CHK'D: YES

DATE RE-STAKED: 12-26-19
SURVEY CREW: ML
HOUSE TIES CHK'D: YES

LEGAL DESCRIPTION:

LOT 9, WHISPERING WOODS FIRST PLAT, A
SUBDIVISION OF LAND IN THE CITY OF LEE'S
SUMMIT, JACKSON COUNTY, MISSOURI.

CERTIFICATE OF AUTHORIZATION
KANSAS
LAND SURVEYING - LS-82
ENGINEERING - E-381
MISSOURI
LAND SURVEYING-2007001128
ENGINEERING-2007005058

This plot plan was prepared for
construction only. All
dimensions to be verified by
builder and all grades as shown
shall be verified by builder to
insure proper drainage and
adequate fall to sewer. No title
information was furnished on
this drawing. Not responsible for
unplatted easements.

Note: Builder shall obtain a
building permit prior to any
construction to ensure that this
site plan meets City approval.

PROJECT NO. 190774

DATE: 10/3/19

BY: DEA

PHelps ENGINEERING, INC
1270 N. Winchester
Olathe, Kansas 66061
(913) 393-1155
Fax (913) 393-1166

PLANNING
ENGINEERING
IMPLEMENTATION

