



SCALE: 1"=20'



PREPARED FOR:  
NEW MARK HOMES-KC

# PLOT PLAN

LOT 6

WHISPERING WOODS FIRST PLAT  
1908 SW RIVER RUN DRIVE

This approval is issued in reliance upon information submitted by the applicant. Any permit issued pursuant to this approval may be suspended or revoked whenever the permit is issued in error, or on the basis of incorrect information supplied, or in violation of any ordinance or regulation. Approved plans shall not be changed, modified or altered without authorization. The issuance or granting of a permit or approval of plans shall not be construed to be a permit for, or an approval of, any violation of any of the provisions of the ordinance of the City of Lees Summit, Missouri.

APPROVED \_\_\_\_\_  
PRINT NAME \_\_\_\_\_  
DATE 1/2/20

SSMH A-2  
T.E.=959.00  
FL(SE)=952.50  
FL(NW)=950.70  
E.G.959.0  
F.G.959.0

FLOOD ZONE AE

SURVEYED  
E.G.960.6  
F.G.960.6

TRACT B  
S27°46'24"W  
59.69'

15' U/E

SET HUB  
F-11.06(TW)

E.G.960.3  
F.G.962.0

LOT 7  
VACANT  
S58°53'38"E  
139.97'

DAYLIGHT  
T.W.965.5  
3'-4" WALL

MBOE=960.70  
T.M.=971.20  
B.F.=962.53  
(9' FND. WALL)

PVCR

PVCR

E.G.966.7  
F.G.967.1

SET HUB  
F-7.36(TW)

E.G.963.7  
F.G.964.8

LOT 5  
VACANT  
S32°52'52"E  
125.40'

E.G.968.8  
F.G.970.5

SET HUB  
F-2.12(TW)

BGMA  
E.G.968.4  
F.G.968.5

T/C968.3

SSMH A-3  
T.E.=967.18  
FL(NW)=954.78

## LEGEND

- (S1) MSFE=956.91  
10 LF 4" PVC  
65' DDS  
FL@EOS=954.41
- \* = MBOE=960.70  
MINIMUM BUILDING  
OPENING PER GRADING  
PLAN  
100YR WSEL=958.00  
MBOE=962.53  
BASEMENT FLOOR  
WALKOUT AS SHOWN

LOT AREA=11,895 SQ. FT.

DATE STAKED: 11-22-19  
SURVEY CREW: ML  
HOUSE TIES CHK'D: YES  
DATE RE-STAKED: 12-26-19  
SURVEY CREW: ML  
HOUSE TIES CHK'D: YES

## LEGAL DESCRIPTION:

LOT 6, WHISPERING WOODS FIRST PLAT, A  
SUBDIVISION OF LAND IN THE CITY OF LEE  
SUMMIT, JACKSON, MISSOURI.

## NOTES:

- SQUARE FOOTAGE OF DRIVEWAY AS SHOWN: 1,106
- 6 INCHES OF CLEARANCE IS REQUIRED FROM THE FINISHED GRADE TO THE SILL PLAT OF THE STRUCTURE. THE GRADE SHALL FALL A MINIMUM OF 6 INCHES WITH THE FIRST 10 FEET FROM THE FOUNDATION OF THE BUILDING.
- LOT 6 IS LOCATED WITHIN THE FLOOD ZONE X (SHADED) PURSUANT TO FEMA LETTER OF MAP REVISION (BASED ON FILL) LOMR-F CASE NUMBER 19-07-1279A, WITH AN EFFECTIVE DATE OF JUNE 4, 2019.
- REVISED: 12-31-19 CITY COMMENTS ADDRESSED

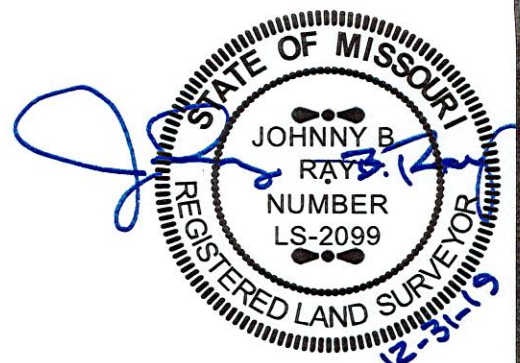

PHELPS ENGINEERING, INC  
1270 N. Winchester  
Olathe, Kansas 66061  
(913) 393-1155  
Fax (913) 393-1166

PLANNING  
ENGINEERING  
IMPLEMENTATION

PROJECT NO. 190755  
DATE: 9/27/19  
BY: DEA

Note: Builder shall obtain a  
building permit prior to any  
construction to ensure that this  
site plan meets City approval.

This plot plan was prepared for  
foundation construction only. All  
dimensions to be verified by  
builder and all grades as shown  
shall be verified by builder to  
insure proper drainage and  
adequate fall to sewer. No title  
information was furnished on  
this drawing. Not responsible for  
unplatted easements.

CERTIFICATE OF AUTHORIZATION  
KANSAS  
LAND SURVEYING - LS-82  
ENGINEERING - E-391  
CERTIFICATE OF AUTHORIZATION  
MISSOURI  
LAND SURVEYING-2007001128  
ENGINEERING-2007005058