

This approval is issued in reliance upon information submitted by the applicant. Any permit issued pursuant to this approval may be suspended or revoked whenever the permit is issued in error, or on the basis of incorrect information supplied, or in violation of any ordinance or regulation. Approved plans shall not be changed, modified or altered without authorization. The issuance or granting of a permit or approval of plans shall not be construed to be a permit for, or an approval of, any violation of any of the provisions of the ordinance of the City of Lee's Summit, Missouri.

APPROVED SC DATE 12/6/19
PRINT NAME _____

LEGEND

- Gas Meter
- Telephone or Fiber-Optic Pedestal
- Cable TV Pedestal
- Electric Pedestal
- Light Pole
- Mailbox
- Fire Hydrant
- Water Valve

PROPOSED HOUSE

TOP FOUNDATION = 992.00
GARAGE FLOOR = 990.50
TOP FOOTING = 983.00
BASEMENT FLOOR = 983.33

E = EXISTING ELEVATION
F = PROPOSED FINAL ELEVATION
G = ADJACENT GRADE AT EGRESS
U/E = UTILITY EASEMENT
B/L = BUILDING LINE
S/Y/S = SIDE YARD SETBACK
R/Y/S = REAR YARD SETBACK

NOTES

1. BUILDER TO VERIFY ALL BUILDING ELEVATIONS AND DIMENSIONS.
2. THIS PLOT PLAN DOES NOT CONSTITUTE A BOUNDARY SURVEY.
3. THE EASEMENTS SHOWN ON THIS PLOT PLAN ARE TAKEN FROM THE FINAL PLAT. OTHER EASEMENTS MAY EXIST.

DRIVEWAY SLOPE = 7.0%

EXTENDED LOT AREA = 10,054.5 SF
DRIVEWAY APPROACH = 222.8 SF
DRIVEWAY = 929.9 SF
SIDEWALK = 303.9 SF

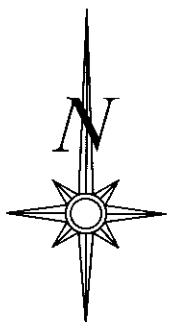

Scale 1"=30'

LOT INFORMATION

9,161.75 SQ. FT.
MBFE = 977.37
ADDRESS
1410 SW GEORGETOWN DR

LEGAL DESCRIPTION

LOT 76, THE RESERVE AT STONEY CREEK 3RD PLAT, A SUBDIVISION AS RECORDED IN LEE'S SUMMIT, JACKSON COUNTY, MISSOURI.

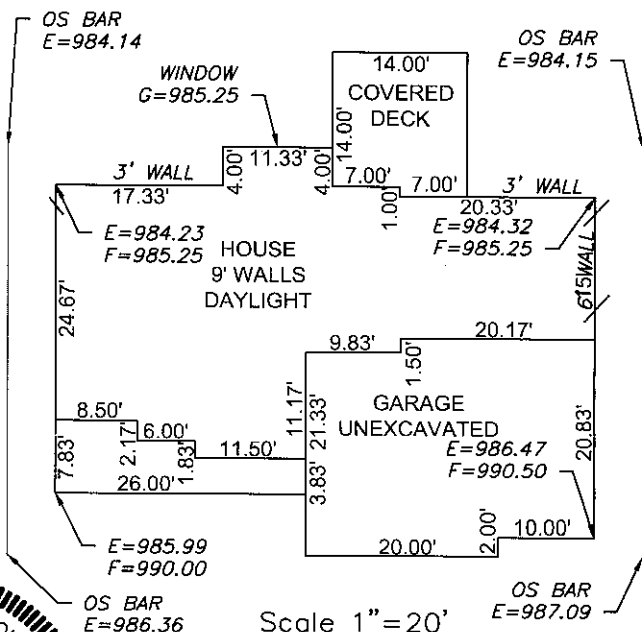

Scale 1"=20'

ENGINEERING
ENGINEERING & SURVEYING
SOLUTIONS

50 SE 30TH STREET
LEE'S SUMMIT, MO 64082
P: (816) 623-9888 F: (816) 623-9849
WWW.ENGINEERINGSOLUTIONKCC.COM



PLOT PLAN - LOT 76

THE RESERVE AT STONEY CREEK -3RD PLAT
LEE'S SUMMIT, JACKSON COUNTY, MISSOURI

SUMMIT HOMES
120 SE 30TH STREET
LEE'S SUMMIT, MO 64082

PROJECT NO.	FILE NAME	DATE	SHEET	OF
1	LOT 76 RESERVE AT STONEY CREEK	9/11/19	1	1

THIS DRAWING IS NOT VALID UNLESS THE SIGNATURE, DATE AND SEAL OF THE ENGINEER WHO SUPERVISED THE PREPARATION OF THIS DRAWING HAS BEEN AFFIXED HERETO.