

APPROVED: *[Signature]* DATE: 10/25/18
 PRINT NAME: STEVEN GORTICK



Scale 1" = 30'

LOT INFORMATION

10,893 SQ. FT.
 MBFE = 920.42
 ADDRESS
 4063 NE TIMBERLAKE COURT

LEGAL DESCRIPTION

LOT 57, THE TRAILS OF PARK RIDGE 2ND PLAT, A SUBDIVISION AS RECORDED IN LEE'S SUMMIT, JACKSON COUNTY, MISSOURI.

- LEGEND**
- Gas Meter
 - Telephone or Fiber-Optic Pedestal
 - Cable TV Pedestal
 - Electric Pedestal
 - Light Pole
 - Mailbox
 - Fire Hydrant
 - Water Valve

PROPOSED HOUSE

TOP FOUNDATION = 934.75
 GARAGE FLOOR = 933.75
 TOP FOOTING = 925.75
 BASEMENT FLOOR = 928.08

- E = EXISTING ELEVATION
- F = PROPOSED FINAL ELEVATION
- G = ADJACENT GRADE AT EGRESS
- U/E = UTILITY EASEMENT
- B/L = BUILDING LINE
- S/Y/S = SIDE YARD SETBACK
- R/Y/S = REAR YARD SETBACK

NOTES

1. BUILDER TO VERIFY ALL BUILDING ELEVATIONS AND DIMENSIONS.
2. THIS PLOT PLAN DOES NOT CONSTITUTE A BOUNDARY SURVEY.
3. THE EASEMENTS SHOWN ON THIS PLOT PLAN ARE TAKEN FROM THE FINAL PLAT. OTHER EASEMENTS MAY EXIST.

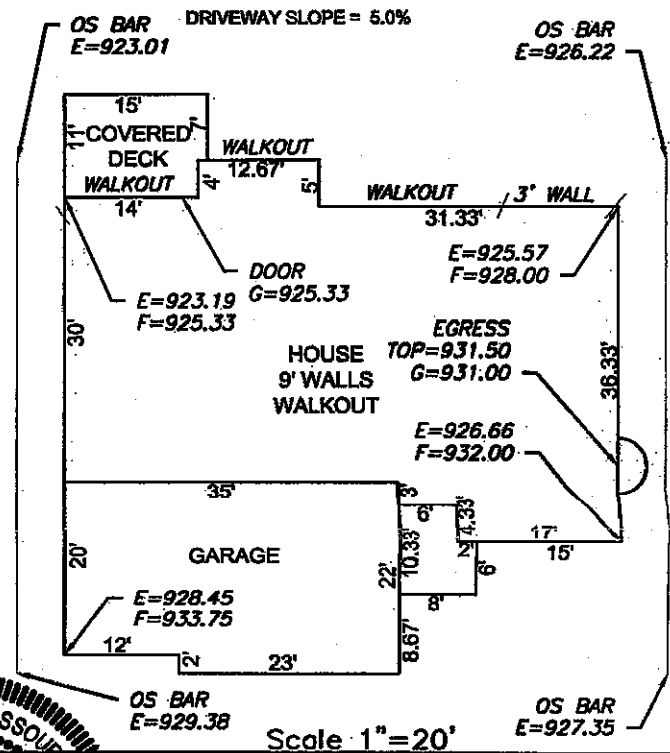

Scale 1" = 20'

ENGINEERING SOLUTIONS
 ENGINEERING & SURVEYING
 50 SE 30TH STREET
 LEE'S SUMMIT, MO 64082
 P: (816) 623-9888 F: (816) 623-9849
 WWW.ENGINEERINGANDSURVEYSOLUTIONS.COM

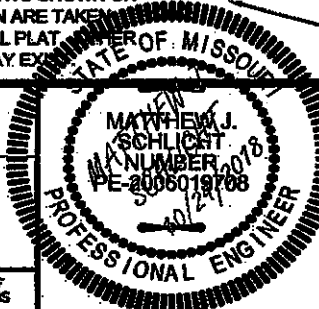

PLOT PLAN - LOT 57

THE TRAILS OF PARK RIDGE 2ND PLAT
 LEE'S SUMMIT, JACKSON COUNTY, MISSOURI

McGraw Homes, Inc.
 902 SE WILLOW PLACE
 BLUE SPRING, MISSOURI, 64014

PROJECT NO.	FILE NAME	DATE	SHEET	OF
1	LOT 57, TRAILS OF PARK RIDGE	10/11/18	1	1

THIS DRAWING IS NOT VALID UNLESS THE SIGNATURE, DATE AND SEAL OF THE ENGINEER WHO SUPERVISED THE PREPARATION OF THIS DRAWING HAS BEEN AFFIXED HERETO.