

Dev. Services approval for roof over patio  
 6/10/19

**LEGEND**

- Gas Meter
- Telephone or Fiber-Optic Pedestal
- Cable TV Pedestal
- Electric Pedestal
- Light Pole
- Mailbox
- Fire Hydrant
- Water Valve

**PROPOSED HOUSE**

TOP FOUNDATION = 983.50  
 GARAGE FLOOR = 982.0  
 TOP FOOTING = 974.50  
 BASEMENT FLOOR = 974.83

E = EXISTING ELEVATION  
 F = PROPOSED FINAL ELEVATION  
 G = ADJACENT GRADE AT EGRESS

U.E. = UTILITY EASEMENT  
 B.L. = BUILDING LINE

**NOTES**

1. BUILDER TO VERIFY ALL BUILDING ELEVATIONS AND DIMENSIONS.
2. THIS PLOT PLAN DOES NOT CONSTITUTE A BOUNDARY SURVEY.
3. THE EASEMENTS SHOWN ON THIS PLOT PLAN ARE TAKEN FROM THE FINAL PLAT. OTHER EASEMENTS MAY EXIST.

Scale 1"=40'

**LOT INFORMATION**

27,203.16 SQ. FT.  
 MBOE = 973.0  
 MBFE = 967.02  
 ADDRESS  
 3102 SE 3RD TERR

**LEGAL DESCRIPTION**

LOT 99, MILL CREEK OF SUMMIT MILL 3RD PLAT, A SUBDIVISION AS RECORDED IN LEE'S SUMMIT, JACKSON COUNTY, MISSOURI.

MH 1-1  
 STA 1+36.83  
 TOP 979.96  
 FL OUT (W) 965.51

DRIVEWAY SLOPE = 5.7 %  
 \* DECK APPROVAL WILL BE REQUIRED PRIOR TO (FUTURE) DECK CONSTRUCTION

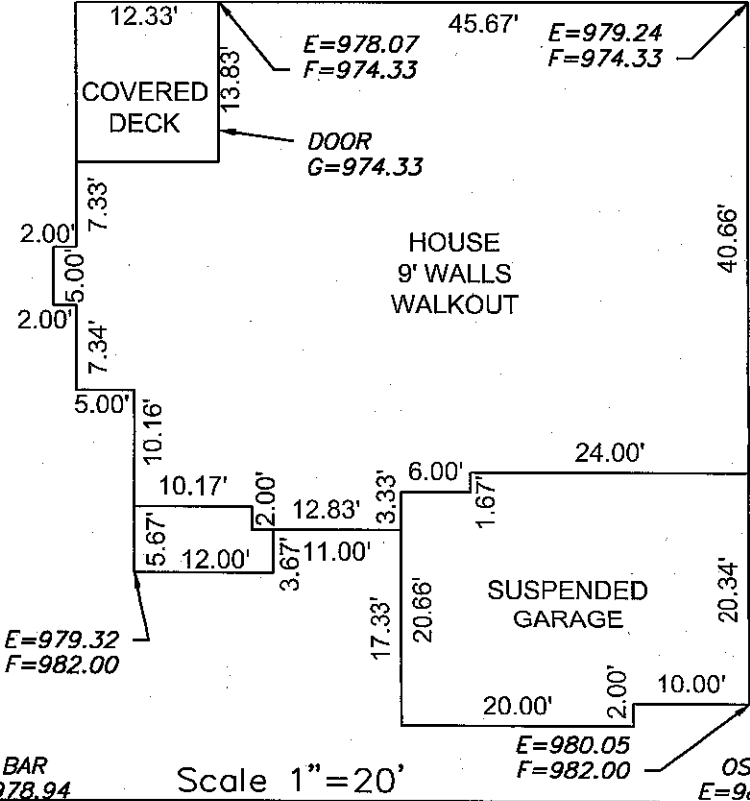

Scale 1"=20'

**ENGINEERING SOLUTIONS**  
 ENGINEERING & SURVEYING  
 50 SE 30TH STREET  
 LEE'S SUMMIT, MO 64082  
 P:(816) 623-9888 F:(816)623-9849  
 WWW.ENGINEERINGSOLUTIONKCC.COM

FINAL  
 5/28/15

<b>PLOT PLAN - LOT 99</b>				
MILL CREEK OF SUMMIT MILL 3RD PLAT LEE'S SUMMIT, JACKSON COUNTY, MISSOURI				
SUMMIT CUSTOM HOMES 120 SE 30TH STREET LEE'S SUMMIT, MO 64082				
PROJECT NO. 1	FILE NAME LOT 87, 90, 99, 117, & 124, MILL CREEK	DATE 05/20/15	SHEET 1	OF 1
Rev:				

THIS DRAWING IS NOT VALID UNLESS THE SIGNATURE, DATE AND SEAL OF THE ENGINEER WHO SUPERVISED THE PREPARATION OF THIS DRAWING HAS BEEN AFFIXED HERETO.