

Permit # PRSGN _____ – _____

SIGN PERMIT APPLICATION

Project Business Name: _____

Project Address/Location: _____

Applicant: _____

Applicant's Address: _____

Applicant's Phone & Fax #: _____

Applicant's Email Address: _____

Type of Sign: Check only one

- | | |
|--|---|
| <input type="checkbox"/> Wall Sign (\$100) | <input type="checkbox"/> Monument/Detached Sign (\$100) |
| <input type="checkbox"/> Temporary Sign (\$50) | <input type="checkbox"/> Directional Sign (\$50) |

Illumination: Specify whether the sign is illuminated

- | | |
|--|--|
| <input type="checkbox"/> Illuminated * | <input type="checkbox"/> Non-Illuminated |
|--|--|

***NOTE:** IF BRANCH CIRCUIT IS NOT CURRENTLY AVAILABLE FOR ILLUMINATED SIGN, A LICENSED ELECTRICAL CONTRACTOR MUST OBTAIN ELECTRICAL PERMIT PRIOR TO INSTALLATION. ALL SIGNS INVOLVING INTERNAL LIGHTS OR OTHER ELECTRICAL DEVICES OR CIRCUITS SHALL DISPLAY A LABEL CERTIFYING IT AS BEING APPROVED BY THE UNDERWRITER'S LABORATORIES, INC.

Sign Dimensions and Setbacks for Wall and Monument/Detached Signs

Height of sign: _____ ft (X) Width of sign: _____ ft (=) Area of sign: _____ sq ft

Area of building façade/wall: _____ sq ft Total height of detached sign: _____ ft

Setbacks: front property line: _____ ft rear property line: _____ ft
side property line: _____ ft side property line: _____ ft

The applicant understands that this permit is issued only for work described here in and included in **accompanying plans and specifications**. All rights and privileges acquired under the provisions of this Ordinance, or any application thereto, are merely licenses revocable at any time by the Director of Planning and Codes.

Signature of Applicant

Date

For City use only, do not write below this line.

Electrical Permit Required:

- ☐ N/A ☐ Yes ☐ No

Zoning: _____ Permit Fee: _____

Receipt #: _____

Signature of Codes Administration Plans Examiner

Approved: _____

Planning and Codes Administration Date

Remarks:



LEE'S SUMMIT MISSOURI

SIGN PERMIT AUTHORIZATION

Comes now Curry Investment Co, who being
(landlord or property owner)

duly sworn upon his/her oath, does state that he/she is the landlord or property owner that has
given permission to the applicant to place signage at 254 NW Oldham Pkwy.
(location address)

Dated this 21st day of February, 2019

Mike Sweeney
Signature of Landlord or Property Owner

Mike Sweeney
Printed Name



SPRINGFIELD SIGN

design | build | install | service

Jose Rizo-Farmers Insurance

Presented by Trey Watts

 800.845.9927

 springfieldsign.com

DISCLAIMER

By continuing to view this art package, you hereby agree to not reproduce, replicate, redistribute, or otherwise copy this artwork. You also agree to not use this artwork for bidding purposes. All images included in this package are property of Springfield Sign unless otherwise noted in writing.

PROPOSED SIGNAGE

'C-CUSTOM-bv TYPE' ILLUM CHANNEL LETTERS (VERTICAL FORMAT) (FULLCOLOR)-NO AGENT NAME-Ref. S3.1

SCALE: 1/2"=1'

254 NW Oldham Pkwy, Lee's Summit, MO 64081
Faces east towards Oldham Parkway

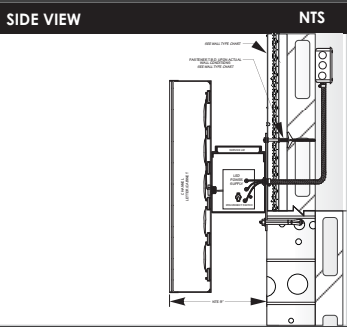

PROPOSED LOCATION: DAY VIEW

SCALE: 3/16"=1'

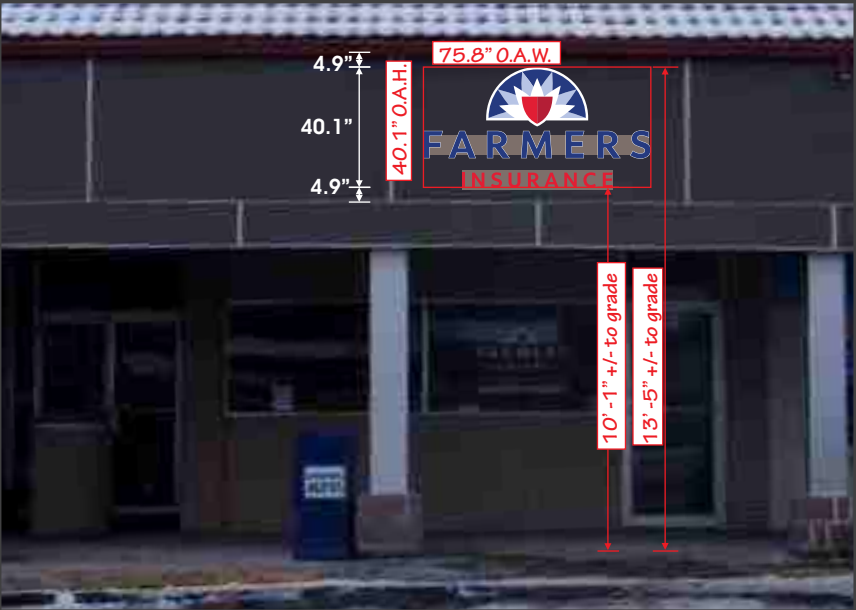

PROPOSED LOCATION: NIGHT VIEW

SCALE: 3/16"=1'



Site survey given 2/11/19

SIGN SPECIFICATIONS

Full Color Channel Letters

- Symbol Face to be .117" white translucent acrylic (acrysteel #7328 or approved EQ). Use artwork provided by designer.
- Symbol returns to be .063" aluminum form as shown. Paint interior with light enhancement paint.
- Symbol trim cap to be 1" Jewlite White.
- Letter faces to be .117" white translucent acrylic (acrysteel #7328 or approved by EQ). Use artwork provided by designer.
- .063" aluminum letter returns. form as shown. Paint matte white. Paint finish interior with light enhancement paint
- Letter trim cap to be 1" Jewlite White.
- First surface decorate letter face with translucent blue film. Provide a 1/8" keyline along letter face to allow white border at night.
- Finish surface decorate letter faces with translucent red film.
- All paints to be two-part polyurethane by Matthews.
- Paint interiors of all cabinets with spray-lat star brite white light enhancement paint. (recommended)
- All steel components to be primed with a zinc inhibitor (devcon-z or approved EQ)
- All electrical work to meet or exceed U.L. requirements.
- The raceways must be painted to match the fascia
- There is to be one raceway behind FARMERS and the emblem and then a separate raceway behind INSURANCE.

NOTE: Final sizing for all structral members(i.e. columns, match plates, connection bolts, anchor bolts, foundations, and reinforcement) to be sized by a licensed engineer to meet or exceed all applicable local, state, and federal codes.

Fabricator is responsible for the prevention of any light leaks.

Leads from back of illuminated letters/symbol shall be a minium of 6'-0" in length measured from the back surface of the letters/symbol. All vinyl films to be 3M as specified below.

LED lighting will be 6500 Kelvin.

- 3M EUROPEAN BLUE 3630-137
- 3M EVENING BLUE 3630-317
- 3M RED 3630-43
- 3M DARK RED 3630-73

CLIENT

Jose Rizo-Farmers Insurance

SALES

Trey Watts 800.845.9927

SCALE

VARIES

AO#

19211

ARTIST

A Lovell

REVISION HISTORY

- 12.17.18 - NEW
- 12.28.18-Revision 1-Reviewer's Comments
- 01.04.19-Revision 2-Door Vinyl updated to window vinyl
- 01.09.19-Revision 3-Reviewer's Comments
- 01.16.19-Revision 4-Reviewer's comments
- 02.12.19-Revision 4-PermittingandSurvey

T:\Cyrrious\Doc\Order\19000\o19211 - Farmer_s Insurance - Jose Rizo (6441)\Art\Working Files

SQUARE FOOTAGE

Proposed:
Channel Letters- 75.8"x 40.1= 21.11 sq ft
Window Vinyl- 38.5"x 31.2"= 8.34 sq ft

Total: 29.45 SQUARE FEET

This drawing is Copyrighted material. It remains the property of Springfield Sign unless otherwise agreed upon in writing. It is unlawful to use this drawing for bidding purposes, nor can it be reproduced, copied, or used in the production of a sign without the written permission from Springfield Sign, Inc.

This is an artistic rendition and final colors/sizes may vary from that depicted herein.

APPROVED BY

DATE

PROPOSED SIGNAGE

Raceway Mounted Channel Letter Attachment Details and Methods

NTS

Attachment Method



***FASTENER SCHEDULE:**
QTY-6 STRAPS WITH 2-EA FASTENERS
TYPICAL 6 PLACES

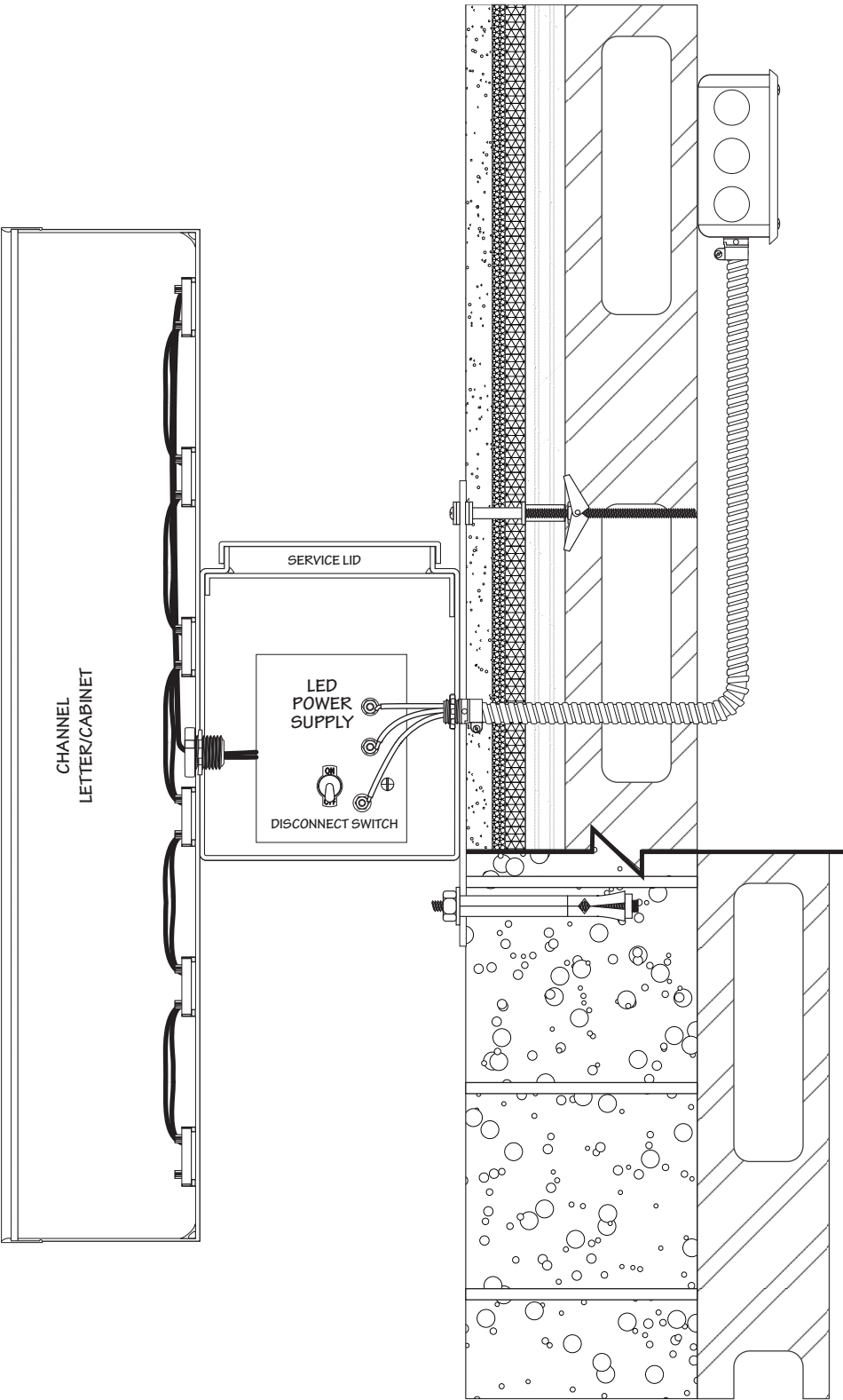

SIGN SPECIFICATIONS

Full Color Channel Letters

- Symbol Face to be .117" white translucent acrylic (acrysteel #7328 or approved EQ). Use artwork provided by designer.
- Symbol returns to be .063" aluminum form as shown. Paint interior with light enhancement paint.
- Symbol trim cap to be 1" Jewlite White.
- Letter faces to be .117" white translucent acrylic (acrysteel #7328 or approved by EQ). Use artwork provided by designer.
- .063" aluminum letter returns. form as shown. Paint matte white. Paint finish interior with light enhancement paint
- Letter trim cap to be 1" Jewlite White.
- First surface decorate letter face with translucent blue film. Provide a 1/8" keyline along letter face to allow white border at night.
- Finish surface decorate letter faces with translucent red film.
- All paints to be two-part polyurethane by Matthews.
- Paint interiors of all cabinets with spray-lat star brite white light enhancement paint. (recommended)
- All steel components to be primed with a zinc inhibitor (devcon-z or approved EQ)
- All electrical work to meet or exceed U.L. requirements.
- The raceways must be painted to match the fascia
- There is to be one raceway behind FARMERS and the emblem and then a separate raceway behind INSURANCE.

NOTE: Final sizing for all structral members(i.e. columns, match plates, connection bolts, anchor bolts, foundations, and reinforcement) to be sized by a licensed engineer to meet or exceed all applicable local, state, and federal codes.

Fabricator is responsible for the prevention of any light leaks.

Leads from back of illuminated letters/symbol shall be a minium of 6'-0" in length measured from the back surface of the letters/symbol. All vinyl films to be 3M as specified below.

LED lighting will be 6500 Kelvin.

- 3M EUROPEAN BLUE 3630-137
- 3M EVENING BLUE 3630-317
- 3M RED 3630-43
- 3M DARK RED 3630-73

CLIENT

Jose Rizo-Farmers Insurance

SALES

Trey Watts 800.845.9927

SCALE

VARIES

AO#

19211

ARTIST

A Lovell

REVISION HISTORY

- 12.17.18 - NEW
- 12.28.18-Revision 1-Reviewer's Comments
- 01.04.19-Revision 2-Door Vinyl updated to window vinyl
- 01.09.19-Revision 3-Reviewer's Comments
- 01.16.19-Revision 4-Reviewer's comments
- 02.12.19-Revision 4-PermittingandSurvey

T:\Cyrrious\Doc\Order\19000\o19211 - Farmer_s Insurance - Jose Rizo (6441)\Art\Working Files

SQUARE FOOTAGE

Proposed:
Channel Letters- 75.8"x 40.1= 21.11 sq ft
Window Vinyl- 38.5"x 31.2"= 8.34 sq ft

Total: 29.45 SQUARE FEET

This drawing is Copyrighted material. It remains the property of Springfield Sign unless otherwise agreed upon in writing. It is unlawful to use this drawing for bidding purposes, nor can it be reproduced, copied, or used in the production of a sign without the written permission from Springfield Sign, Inc.

This is an artistic rendition and final colors/sizes may vary from that depicted herein.

APPROVED BY

DATE

PROPOSED SIGNAGE

‘W2’ CUSTOM VINYL WINDOW ID (AGENCY NAME BELOW)



SIGN SPECIFICATIONS

WINDOW VINYL

- Signature Ruleline to be white opaque vinyl 3M #7725-10. Use artwork provided by designer. First surface apply.
- Ruleline and agency name to be white opaque vinyl 3M #7725-10. Typeface to be slate pro medium. Very all copy prior to fabrication. Apply second surface.
- Symbol to be digitally printed on white vinyl background.

CLIENT

Jose Rizo-Farmers Insurance

SALES

Trey Watts 800.845.9927

SCALE

VARIES

AO#

19211

ARTIST

A Lovell

REVISION HISTORY

- 12.17.18 - NEW
12.28.18-Revision 1-Reviewer's Comments
01.04.19-Revision 2-Door Vinyl updated to window vinyl
01.09.19-Revision 3-Reviewer's Comments
01.16.19-Revision 4-Reviewer's comments
02.12.19-Revision 4-PermittingandSurvey

T:\Cyrrious\Doc\Order\19000\o19211 - Farmer_s Insurance - Jose Rizo (6441)\Art\Working Files

SQUARE FOOTAGE

Proposed:
Channel Letters- 75.8"x 40.1= 21.11 sq ft
Window Vinyl- 38.5"x 31.2"= 8.34 sq ft

Total: 29.45 SQUARE FEET

PROPOSED DOOR VINYL

NTS

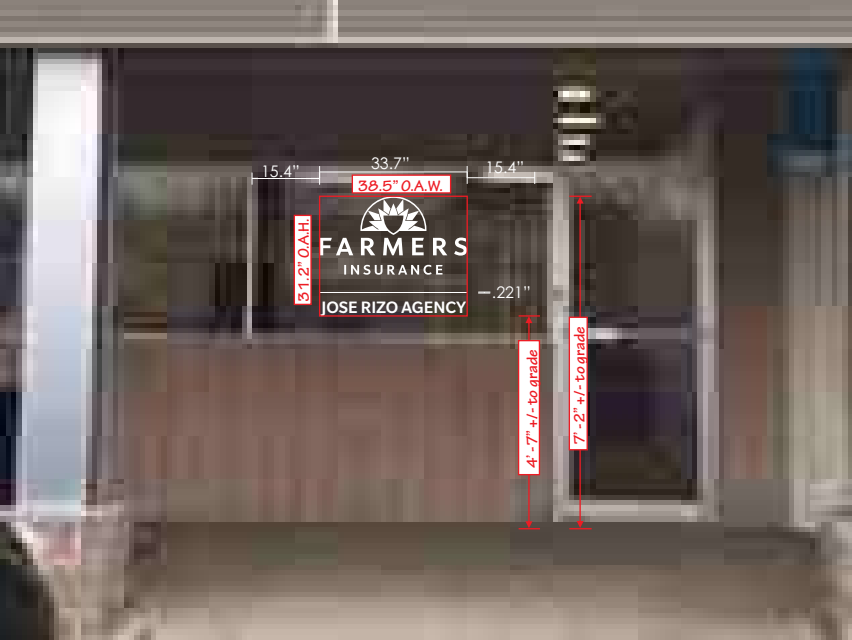

EXISTING

NTS



This drawing is Copyrighted material. It remains the property of Springfield Sign unless otherwise agreed upon in writing. It is unlawful to use this drawing for bidding purposes, nor can it be reproduced, copied, or used in the production of a sign without the written permission from Springfield Sign, Inc.

This is an artistic rendition and final colors/sizes may vary from that depicted herein.

APPROVED BY

DATE