

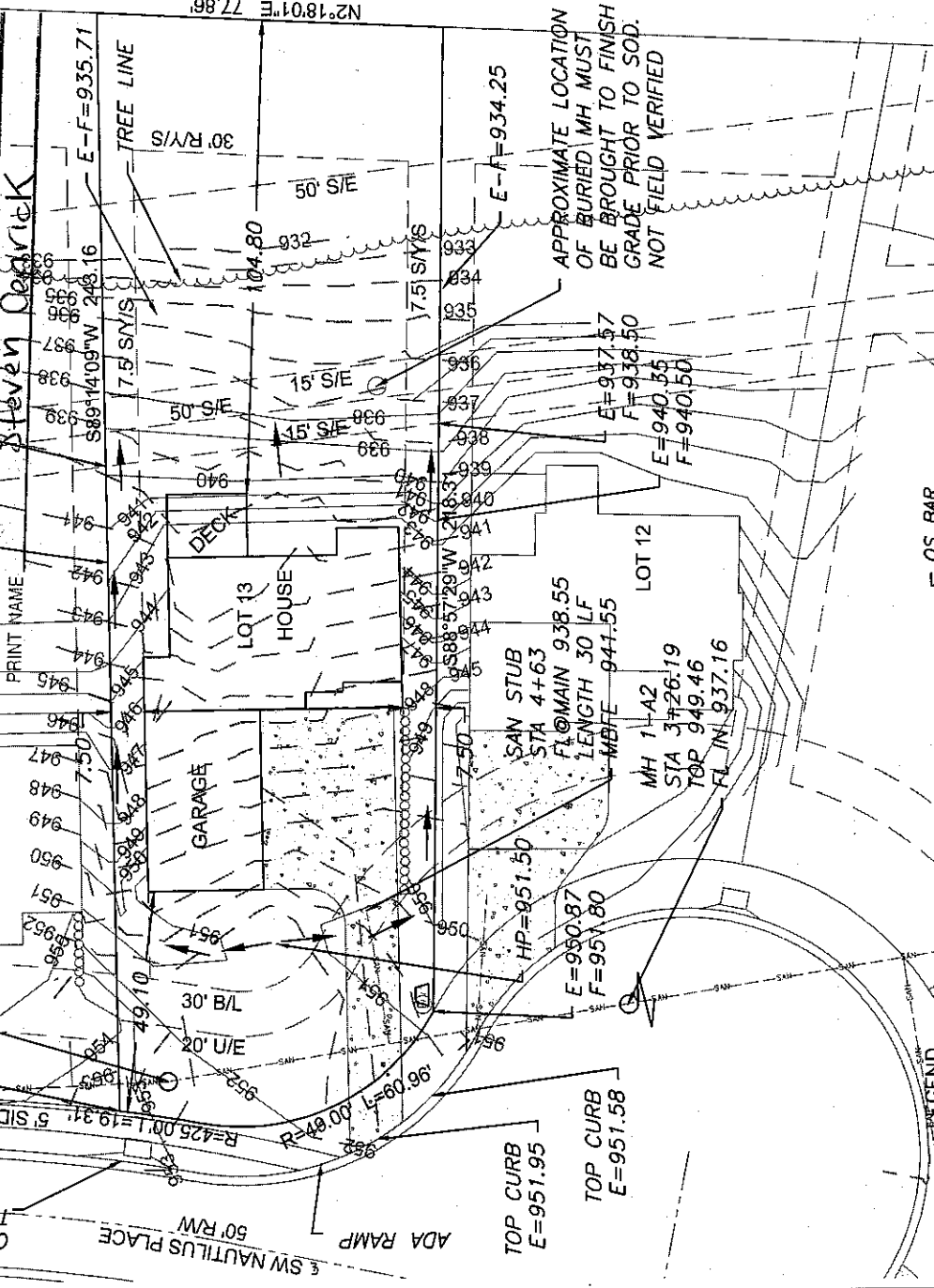







This approval is issued in reliance upon information submitted by the applicant. Any permit issued pursuant to this approval may be suspended or revoked whenever the permit is issued in error or on the basis of incorrect information supplied, or in violation of any ordinance or regulation. Approved plans shall not be changed, modified or altered without authorization. The issuance or granting of a permit or approval of plans shall not be construed to be a permit for or an approval of any work that is not within the provisions of the ordinance of the City of Lee's Summit, Missouri.

APPROVED  DATE 2/21/19  
 PRINT NAME Steven Deavrick



- LEGEND**
-  Gas Meter
  -  Telephone or Fiber-Optic Pedestal
  -  Cable TV Pedestal
  -  Mailbox
  -  Electric Pedestal
  -  Fire Hydrant
  -  Water Valve
  -  Light Pole

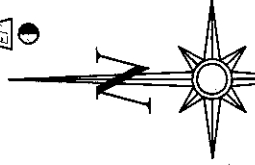

Scale 1"=40'

**PROPOSED HOUSE**

- TOP FOUNDATION = 953.00
- GARAGE FLOOR = 952.00
- TOP FOOTING = 944.00
- BASEMENT FLOOR = 944.33

- E = EXISTING ELEVATION
- F = PROPOSED FINAL ELEVATION
- G = ADJACENT GRADE AT EGRESS
- U/E = UTILITY EASEMENT
- B/L = BUILDING LINE
- S/M/S = SIDE YARD SETBACK
- R/Y/S = REAR YARD SETBACK

**LOT INFORMATION**

17,779 SQ. FT.  
 MBEE = 941.55  
 ADDRESS  
 4517 SW NAUTILUS PL

**LEGAL DESCRIPTION**

LOT 13, CREEKSIDE AT RAINTREE, A SUBDIVISION AS RECORDED IN LEE'S SUMMIT, CASS & JACKSON COUNTY, MISSOURI.

**NOTES**

1. BUILDER TO VERIFY ALL BUILDING ELEVATIONS AND DIMENSIONS.
2. THIS PLOT PLAN DOES NOT CONSTITUTE A BOUNDARY SURVEY.
3. THE EASEMENTS SHOWN ON THIS PLOT PLAN ARE TAKEN FROM THE FINAL PLAT. EASEMENTS MAY EXIST.

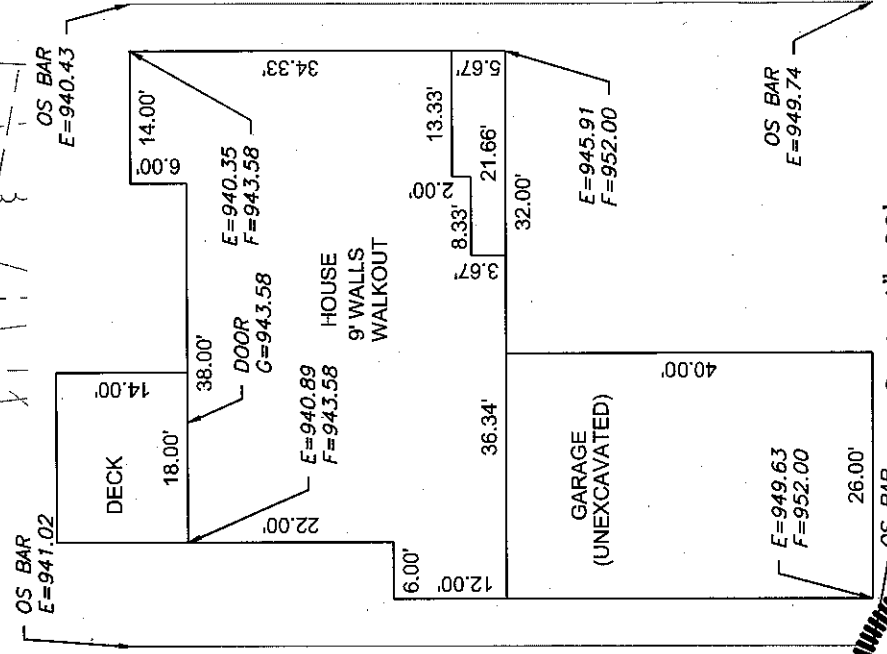

Scale 1"=20'

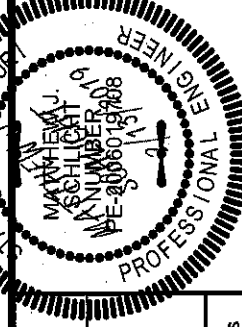

**ENGINEERING SOLUTIONS**  
 ENGINEERING & SURVEYING  
 50 S. SOUTH STREET  
 LEE'S SUMMIT, MO 64082  
 P: 816.228.7100 F: 816.228.0040  
 WWW.ENGINEERING SOLUTIONS LLC.COM

**PLOT PLAN - LOT 13**  
 CREEKSIDE AT RAINTREE  
 LEE'S SUMMIT, CASS & JACKSON COUNTY, MISSOURI  
 LANDROCK SIGNATURE HOMES, LLC  
 4326 W. GEEF STREET  
 KANSAS CITY, MISSOURI, 64111

|             |                               |          |       |    |
|-------------|-------------------------------|----------|-------|----|
| PROJECT NO. | FILE NAME                     | DATE     | SHEET | OF |
| 1           | LOT 13, CREEKSIDE AT RAINTREE | 11/29/18 | 1     | 1  |

THIS DRAWING IS NOT VALID UNLESS THE SIGNATURE, DATE AND SEAL OF THE ENGINEER WHO SUPERVISED THE PREPARATION OF THIS DRAWING HAS BEEN AFFIXED HERETO.