

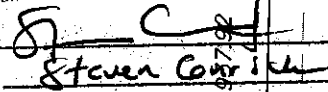

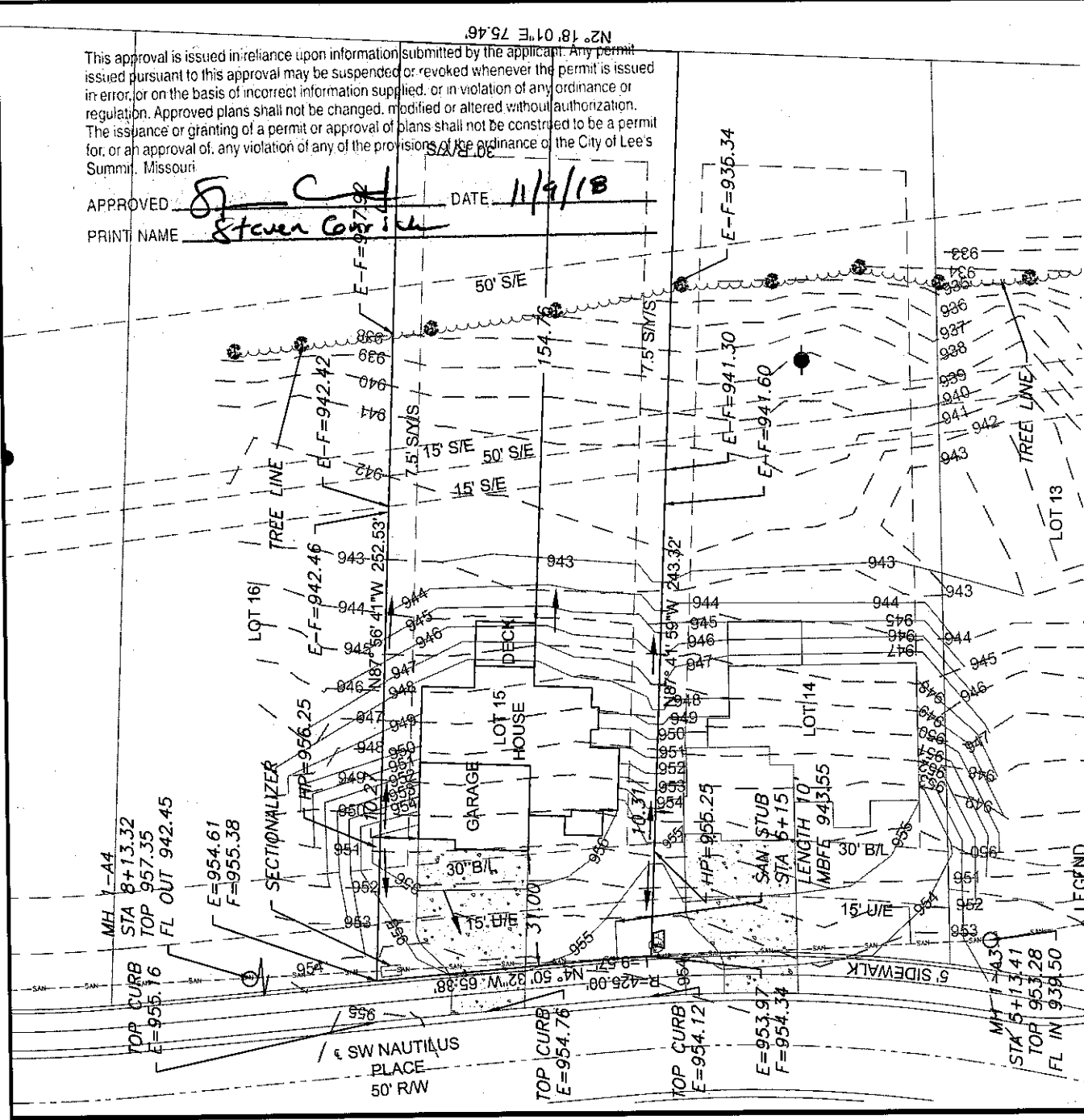







PRES 208 3800

This approval is issued in reliance upon information submitted by the applicant. Any permit issued pursuant to this approval may be suspended or revoked whenever the permit is issued in error, or on the basis of incorrect information supplied, or in violation of any ordinance or regulation. Approved plans shall not be changed, modified or altered without authorization. The issuance or granting of a permit or approval of plans shall not be construed to be a permit for, or an approval of, any violation of any of the provisions of the ordinance of the City of Lee's Summit, Missouri.

APPROVED  DATE 11/9/18
 PRINT NAME Steven Conrath



- LEGEND**
-  Gas Meter
 -  Telephone or Fiber-Optic Pedestal
 -  Cable TV Pedestal
 -  Electric Pedestal
 -  Light Pole
 -  Power Pole
 -  Mailbox
 -  Fire Hydrant
 -  Water Valve

PROPOSED HOUSE

TOP FOUNDATION = 957.75
 GARAGE FLOOR = 956.75
 TOP FOOTING = 948.75
 BASEMENT FLOOR = 949.08

E = EXISTING ELEVATION
 F = PROPOSED FINAL ELEVATION
 G = ADJACENT GRADE AT EGRESS
 U/E = UTILITY EASEMENT
 B/L = BUILDING LINE
 S/Y/S = SIDE YARD SETBACK
 R/Y/S = REAR YARD SETBACK

NOTES

1. BUILDER TO VERIFY ALL BUILDING ELEVATIONS AND DIMENSIONS.
2. THIS PLOT PLAN DOES NOT CONSTITUTE A BOUNDARY SURVEY.
3. THE EASEMENTS SHOWN ON THIS PLOT PLAN ARE TAKEN FROM THE FINAL PLAT. EASEMENTS MAY EXIST.

Scale 1" = 40'

LOT INFORMATION

18,574 SQ. FT.
 M/B/F/E = 943.55
 ADDRESS
 4509 SW NAUTILUS PL

LEGAL DESCRIPTION

LOT 15, CREEKSIDE AT RAINTREE, A SUBDIVISION AS RECORDED IN LEE'S SUMMIT, CASS & JACKSON COUNTY, MISSOURI.

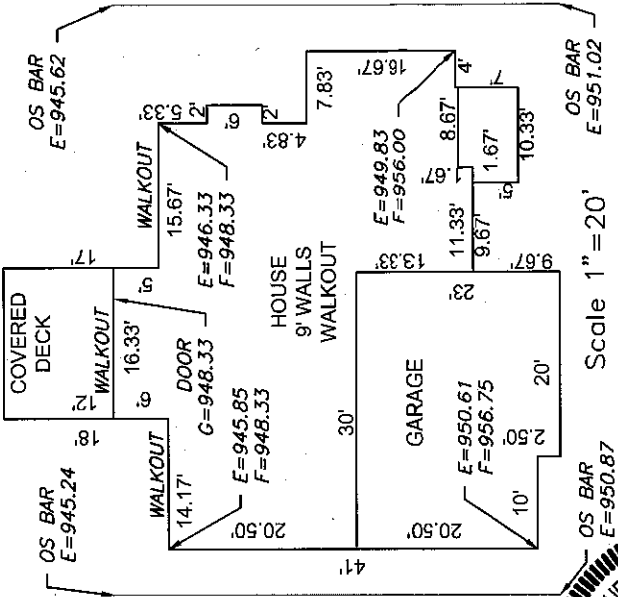

Scale 1" = 20'

ENGINEERING SOLUTIONS
 ENGINEERING & SURVEYING
 50 SE 30TH STREET
 LEE'S SUMMIT, MO 64082
 P: (816) 622-9888 F: (816) 622-9849
 WWW.ENGINEERINGSOLUTIONS.COM

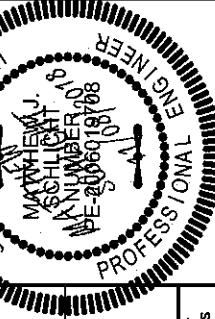

PLOT PLAN - LOT 15

CREEKSIDE AT RAINTREE
 LEE'S SUMMIT, CASS & JACKSON COUNTY, MISSOURI
 LANDROCK SIGNATURE HOMES, LLC
 4335 MCGEE STREET
 KANSAS CITY, MISSOURI, 64111

THIS DRAWING IS NOT VALID UNLESS THE SIGNATURE, DATE AND SEAL OF THE ENGINEER WHO SUPERVISED THE PREPARATION OF THIS DRAWING HAS BEEN AFFIXED HERETO.

PROJECT NO.	FILE NAME	DATE	SHEET	OF
1	LOT 9,12,14&15, CREEKSIDE AT RAINTREE	10/08/18	1	1