

THE CONTRACTOR SHALL PROVIDE FOR POSITIVE DRAINAGE AWAY FROM BUILDING AT ALL TIMES.

IT IS THE RESPONSIBILITY OF THE CONTRACTOR TO VERIFY THE DEPTH OF THE SANITARY SEWER IN RELATION TO THE FOUNDATION PRIOR TO POURING THE FOUNDATION.

CONTRACTOR SHALL
ASSURE POSITIVE
DRAINAGE

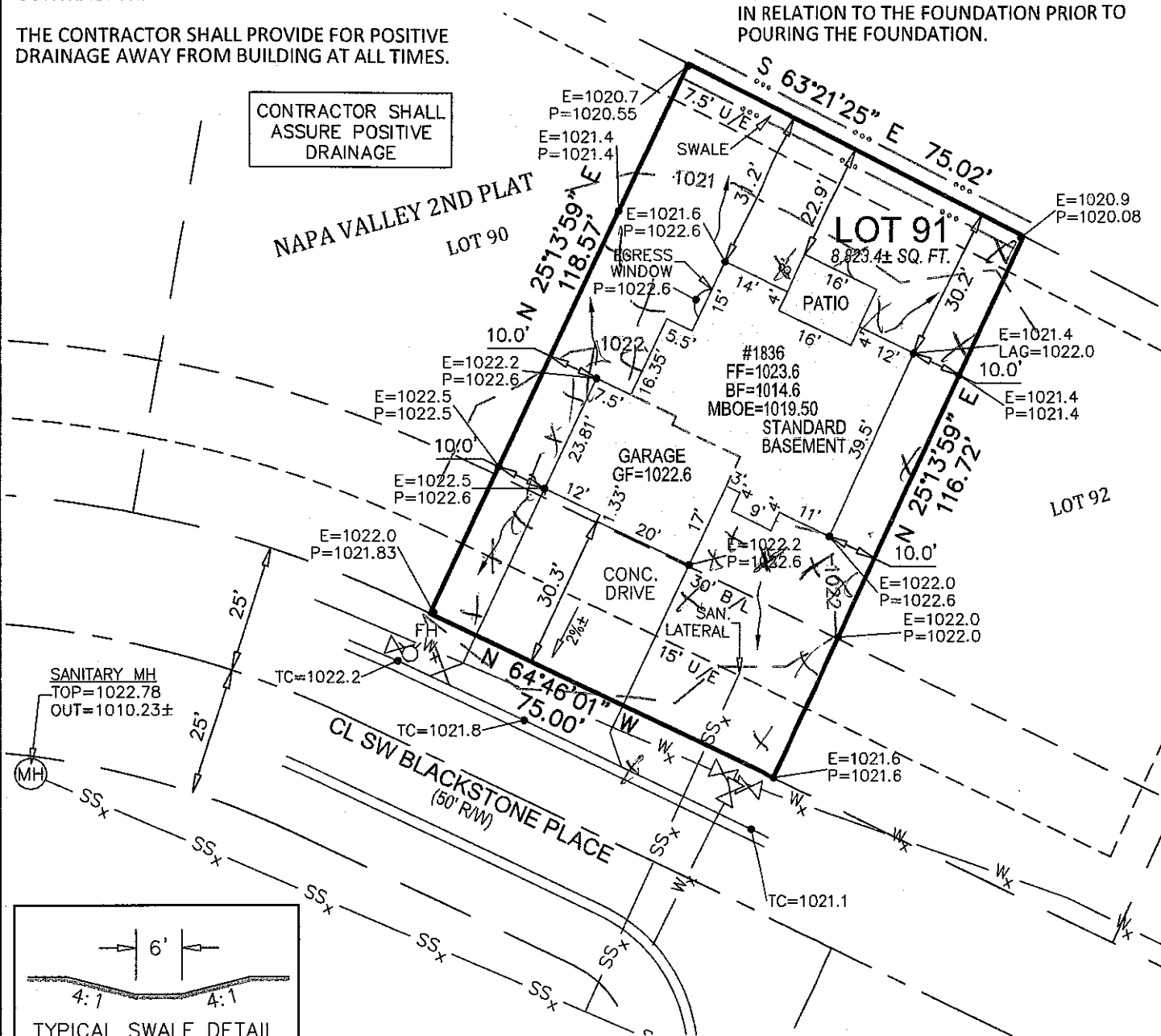

TYPICAL SWALE DETAIL
NTS

NOTE:

APPROVAL IS REQUIRED PRIOR TO ANY FUTURE DECK CONSTRUCTION.

DESCRIPTION:

LOT 91, NAPA VALLEY 2ND PLAT, A SUBDIVISION IN
LEE'S SUMMIT, JACKSON COUNTY, MISSOURI,
ACCORDING TO THE RECORDED PLAT THEREOF.

LEGEND:

U/E	UTILITY EASEMENT
B/L	BUILDING SETBACK LINE
TC	TOP OF CURB
E	EXISTING
P	PROPOSED
LAG	LOWEST ADJACENT GRADE AT EGRESS

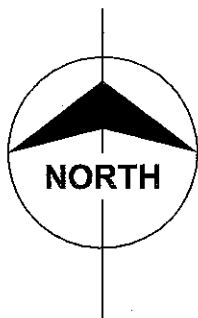

1836 BLACKSTON

JEREMY M. POWELL, PLS, CFedS
LS 2007000084