

3400 SW Lois Ln  
20171187



Mere Architecture

September 20, 2017

Douglas Landscape & design, LLC  
Attn: Douglas McMullen, President  
604 Northeast Street  
Lee's Summit, Missouri 64063

Doug:

I have taken the time to evaluate and determine the best course of action for bracing absent from the Michelle Hinkle residence. The location of the bracing in question is located at the west end of the structure, adjacent to the exterior deck with a window looking to the north. The location of the bracing was determined with no windows at this location during the design phase of the project.

The original design was intended to have "let-in bracing" from sill to top plate at this location for a distance of 3'-6". Continuous structural sheathing located on the inside face of the wall (R602.10.1.2, Offsets along a braced wall line) may be used in place of the let-in bracing originally designed for the project (Mixing methods, R602.10.4.1). The Continuous Sheathing Method recommended is structural fiberboard (CS-SFB) with the following specifications (Table R602.10.4, Bracing Methods):

- Thickness: 1/2" or 25/32" thickness
- Fasteners: 1 1/2" long x 0.12" diameter galvanized roofing nails for 1/2" sheathing  
1 3/4" long x 0.12" diameter galvanized roofing nails for 25/32" sheathing  
8d common nails (2 1/2" long x 0.131" diameter nails)
- Spacing: 3" at the edges and 6" elsewhere

The bracing method should extend from the corner of the master bedroom to the living room:

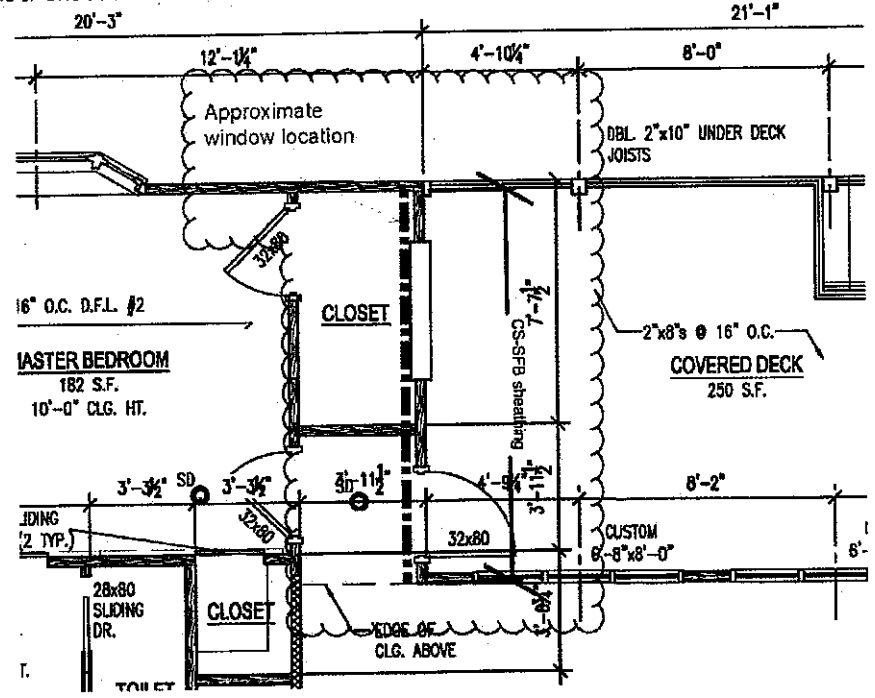

Please do not hesitate to call or e-mail should any additional issues arise.

Respectfully Submitted,

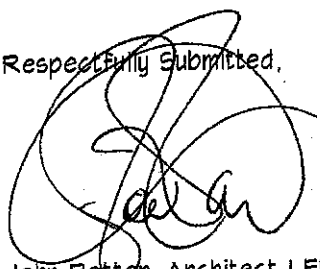

John Potter, Architect LEED<sup>AP</sup>

