

PRCOM 2016 1204.
2724 NE Independence Ave

WILLIAM E. MANZ, P. E.
STRUCTURAL ENGINEER
6328 HIGHLAND ESTATES DR.
ST. LOUIS, MO. 63129

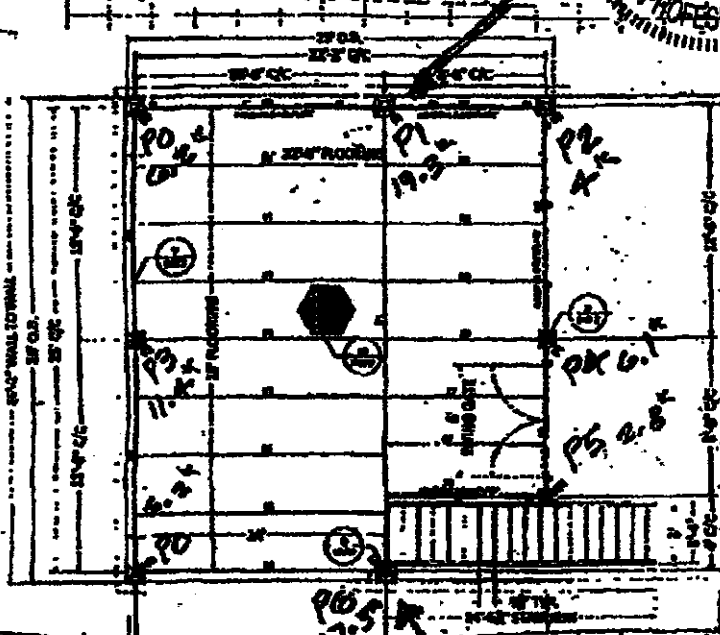
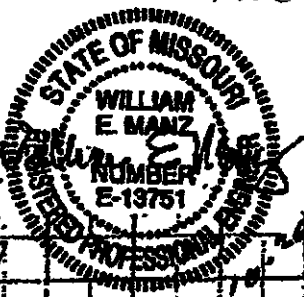
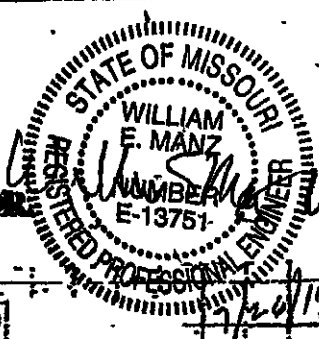

COLS. P1 & P6 REQ. REINFMT
OTHER 6 COLS DO NOT.

ALTERNATE DESIGN FOR
3-SIDED BASE PLATE

EXIST. BASE PLATE

3 SIDES:
BAR 2x 3/4"
w/ 1/2" STIFF

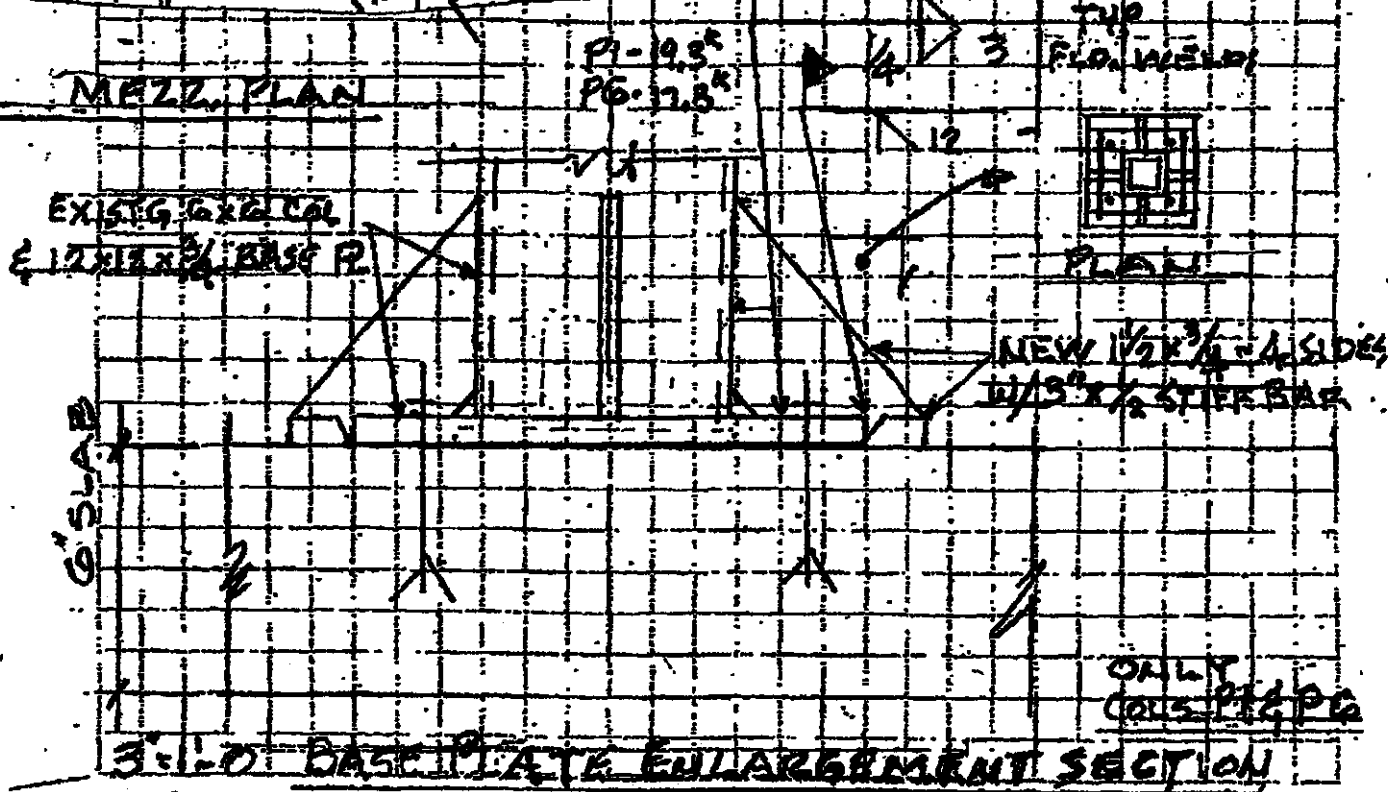

2724 NE INDEPENDENCE
BASE PLATE ENLARGMT. LEG SUMMIT, MO. 64064
PERMIT # PRCOM 2016 1204
Rev. 10-26-16 1 of 2
REV. 7-26-17