

SAN MH 1-4
STA 4+83.42
TOP 988.65
FL IN (E) 977.70

SAN MH 1-5
STA 8+02.27
TOP 996.37
FL OUT (W) 983.87

SAN STUB
STA 7+94.77
LENGTH 10
MBFE 986.91

LOT 110
WALKOUT
DIRT
E-F=995.55

TRANSFORMER PAD
PROP CNR
E-F=990.69

LOT 122
EMPTY

LEGEND

- Gas Meter
- Telephone or Fiber-Optic Pedestal
- Cable TV Pedestal
- Electric Pedestal
- Light Pole
- Mailbox
- Fire Hydrant
- Water Valve

PROPOSED HOUSE

TOP FOUNDATION = 899.50
GARAGE FLOOR = 897.50
TOP FOOTING = 890.50
BASEMENT FLOOR = 890.83

E = EXISTING ELEVATION
F = PROPOSED FINAL ELEVATION
G = ADJACENT GRADE AT EGRESS

U.E. = UTILITY EASEMENT
B.L. = BUILDING LINE

NOTES

1. BUILDER TO VERIFY ALL BUILDING ELEVATIONS AND DIMENSIONS.
2. THIS PLOT PLAN DOES NOT CONSTITUTE A BOUNDARY SURVEY.
3. THE EASEMENTS SHOWN ON THIS PLOT PLAN ARE TAKEN FROM THE FINAL PLAT. OTHER EASEMENTS MAY EXIST.

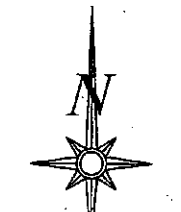

Scale 1"=30'

LOT INFORMATION

11,849.30 SQ. FT.
MBFE = 986.91
ADDRESS
288 SE COYLE DR.

LEGAL DESCRIPTION

LOT 109, MILL CREEK OF SUMMIT MILL 3RD PLAT, A SUBDIVISION AS RECORDED IN LEE'S SUMMIT, JACKSON COUNTY, MISSOURI.

DRIVEWAY SLOPE = 4.7 %
EXTENDED LOT AREA = 15,473.70 SQ. FT.
SIDEWALK AREA = 1,175.96 SQ. FT.

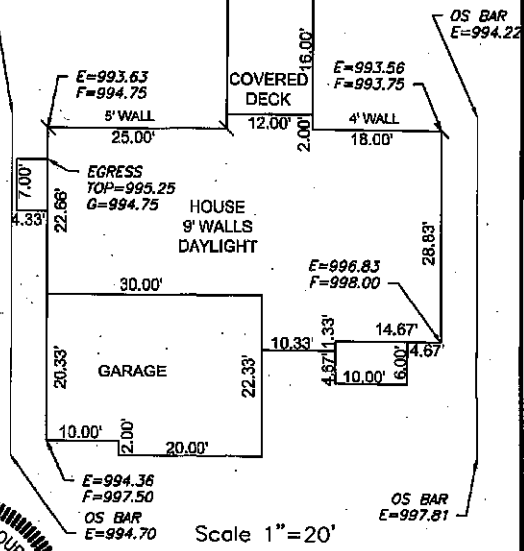

Scale 1"=20'

This approval is issued in reliance upon information provided by the applicant and is not to be used in any way without the approval of the engineer. The engineer assumes no responsibility for the accuracy of the information provided or for the consequences of any reliance thereon. The issuance or granting of a permit or approval of plans shall not be construed to be a permit for or an approval of any violation of any of the provisions of the ordinance of the City of Lee's Summit, Missouri.

APPROVED: *Matthew J. Schlicht* DATE: 3/11/16

ENGINEERING SOLUTIONS
ENGINEERING & SURVEYING

30 SE 30TH STREET
LEE'S SUMMIT, MO 64082
P: (616) 623-9841 F: (616) 623-9849
WWW.ENGINEERINGANDSURVEYING.COM

STATE OF MISSOURI
MATTHEW J. SCHLICHT
NUMBER 6
PE 0006019708
PROFESSIONAL ENGINEER

PLOT PLAN - LOT 109

MILL CREEK OF SUMMIT MILL 3RD PLAT
LEE'S SUMMIT, JACKSON COUNTY, MISSOURI

SUMMIT CUSTOM HOMES
120 SE 30TH STREET
LEE'S SUMMIT, MISSOURI, 64082

PROJECT NO.	FILE NAME	DATE	SHEET	OF
1	LOT 109, 110 & 120, MILL CREEK	02/19/16	1	1

THIS DRAWING IS NOT VALID UNLESS THE SIGNATURE, DATE AND SEAL OF THE ENGINEER WHO SUPERVISED THE PREPARATION OF THIS DRAWING HAS BEEN AFFIXED HERETO.