

CONSTRUCTION STAKE PLOT PLAN

LAND SURVEY COMPANY

a division of MIGAR Enterprises, Inc.
 P. O. BOX 528 • GRANDVIEW, MISSOURI 64030 • PHONE: 966-0839

ORDERED BY: Ben Cerra

DESCRIPTION:
 Beginning at a point 30 feet East of the Southwest corner of the Northwest 1/4 of Section 3, Township 47, Range 32, Lee's Summit, Jackson County, Missouri; thence parallel to and 30 feet East of the West line of said 1/4 section N 0° 31' 40" W, 180 feet; thence parallel to the South line of said 1/4 section N 89° 05' 42" E, 435.60 feet; thence parallel to the West line of said 1/4 section N 89° 05' 42" E, 435.60 feet; thence parallel to the West line of said 1/4 section N 89° 05' 42" E, 435.60 feet to the point of beginning.

VIEW HIGH DRIVE

SW. COR. OF
 NW 1/4 SEC
 3-47-32

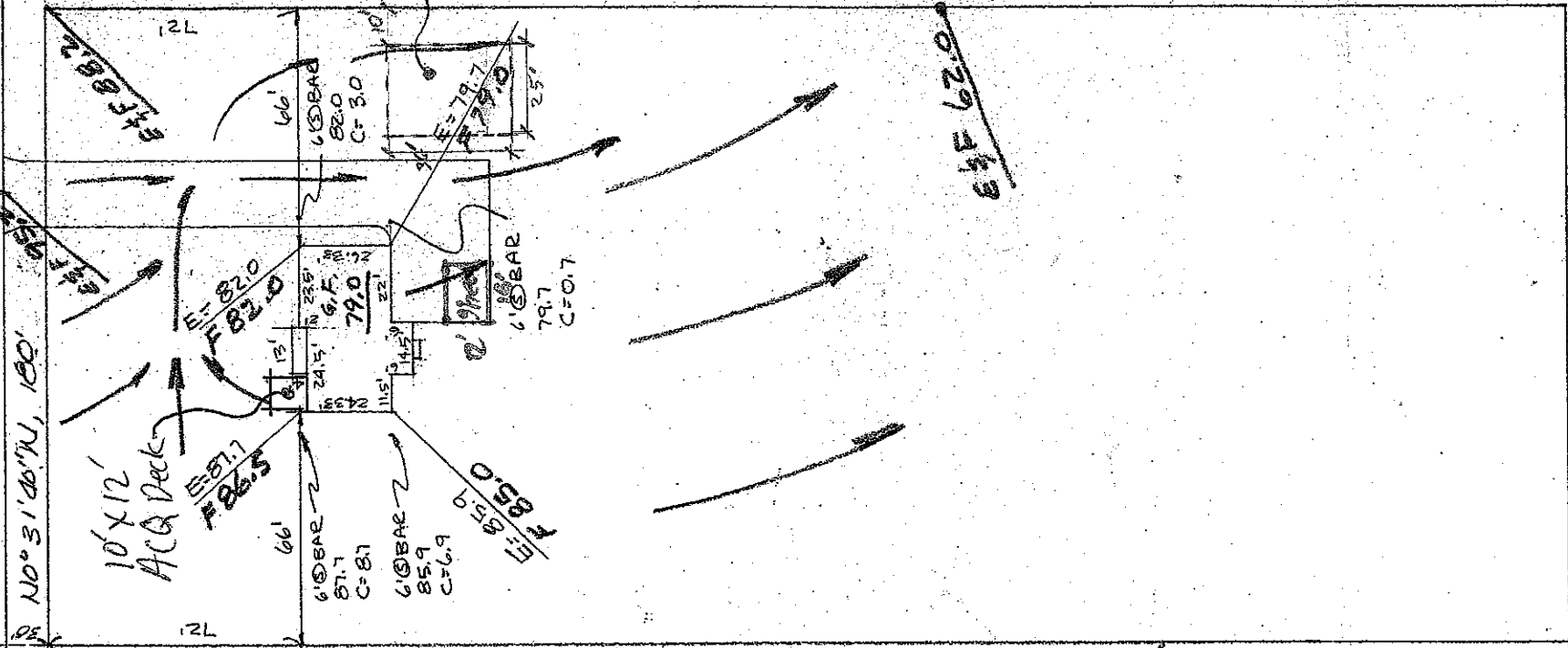

10' x 12' ACQ Deck

FUTURE 27' x 30' Detached 3-Car Garage

S 89° 05' 42" W
 435.6'

Planning: Divpt.
 for shed
 and detached garage
 Jeff Thompson
 12-11-13

S. LINE NW 1/4

RECORDED
 L. J. Lynch
 DATE 11-24-12

Deck Approval
 Check with PD
 9/24/12

180'
 S 0° 31' 40" W

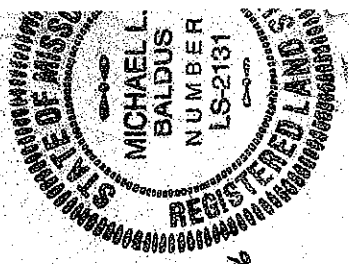

SCALE: 1"=50'
 DATE: 10/30/16
 JOB NO.:

ATTENTION: This plat was prepared for use before and during foundation construction only. House staked as shown on plat. Contractor to check and verify house dimensions and elevations at job site. Not responsible for unplatted easements. NOTE: Cuts shown hereon for excavation are a guide only. Final decision as to cuts and foundation height to be made by builder on job site.