

# **LEE'S SUMMIT** MISSOURI

Permit # PRSGN \_\_\_\_\_ - \_\_\_\_\_

## SIGN PERMIT APPLICATION

Project Business Name: Images By Davenport, LLC

Project Address/Location: John Knox Village - Chipman & Pryor

Applicant: Keith Davenport

Applicant's Address: 2401 SW Emerald Creek Place, Blue Springs, MO 64015

Applicant's Phone & Fax #: 816-224-9967 816-223-3247 Cell

Applicant's Email Address: keith@imagesbydavenport.com

### Type of Sign: Check only one

- |   |   |
|---|---|
| <input type="checkbox"/> Wall Sign (\$100)                | <input type="checkbox"/> Monument/Detached Sign (\$100) |
| <input checked="" type="checkbox"/> Temporary Sign (\$50) | <input type="checkbox"/> Directional Sign (\$50)        |

### Illumination: Specify whether the sign is illuminated

- |  |  |
|--|--|
| <input type="checkbox"/> Illuminated * | <input type="checkbox"/> Non-Illuminated |
|--|--|

**\*NOTE:** IF BRANCH CIRCUIT IS NOT CURRENTLY AVAILABLE FOR ILLUMINATED SIGN, A LICENSED ELECTRICAL CONTRACTOR MUST OBTAIN ELECTRICAL PERMIT PRIOR TO INSTALLATION. ALL SIGNS INVOLVING INTERNAL LIGHTS OR OTHER ELECTRICAL DEVICES OR CIRCUITS SHALL DISPLAY A LABEL CERTIFYING IT AS BEING APPROVED BY THE UNDERWRITER'S LABORATORIES, INC.

### Sign Dimensions and Setbacks for Wall and Monument/Detached Signs

Height of sign: 3.5 ft (X) Width of sign: 8 ft (=) Area of sign: 28 sq ft

Area of building façade/wall: \_\_\_\_\_ sq ft Total height of detached sign: \_\_\_\_\_ ft

**Setbacks:** front property line: \_\_\_\_\_ ft rear property line: \_\_\_\_\_ ft

side property line: \_\_\_\_\_ ft side property line: \_\_\_\_\_ ft

The applicant understands that this permit is issued only for work described here in and included in **accompanying plans and specifications**. All rights and privileges acquired under the provisions of this Ordinance, or any application thereto, are merely licenses revocable at any time by the Director of Planning and Codes.

  
Signature of Applicant

2.26.26  
Date

### For City use only, do not write below this line.

Electrical Permit Required:  
 N/A     Yes     No

Zoning: \_\_\_\_\_ Permit Fee: \_\_\_\_\_

Receipt #: \_\_\_\_\_

\_\_\_\_\_  
Signature of Codes Administration Plans Examiner

\_\_\_\_\_  
Approved: Planning and Codes Administration Date

### Remarks:

Project Address



## SIGN PERMIT AUTHORIZATION

Comes now Karen Burec/Manager of Mkt & Comm, who being  
(landlord or property owner)

duly sworn upon his/her oath, does state that he/she is the landlord or property owner that has  
given permission to the applicant to place signage at John Knox Village - Chipman & Pryor for shows shown Below  
(location address)

Dated this 26th day of February, 2026

*Karen Burec-Batchman*

Signature of Landlord or Property Owner

**Karen Burec**

Printed Name

Raspberry Spring Expo - March 13 & 14, 2026

Summer Chill Art and Craft Show - July 17 & 18, 2026

Oktoberfest Art and Craft Show - October 2 & 3, 2026

Holiday Art and Craft Show (Old Fall Harvest) - November 6 & 7, 2026

Tis' the Season Art and Craft Show - December 4 & 5, 2026

# Lees Summit, Missouri, United States

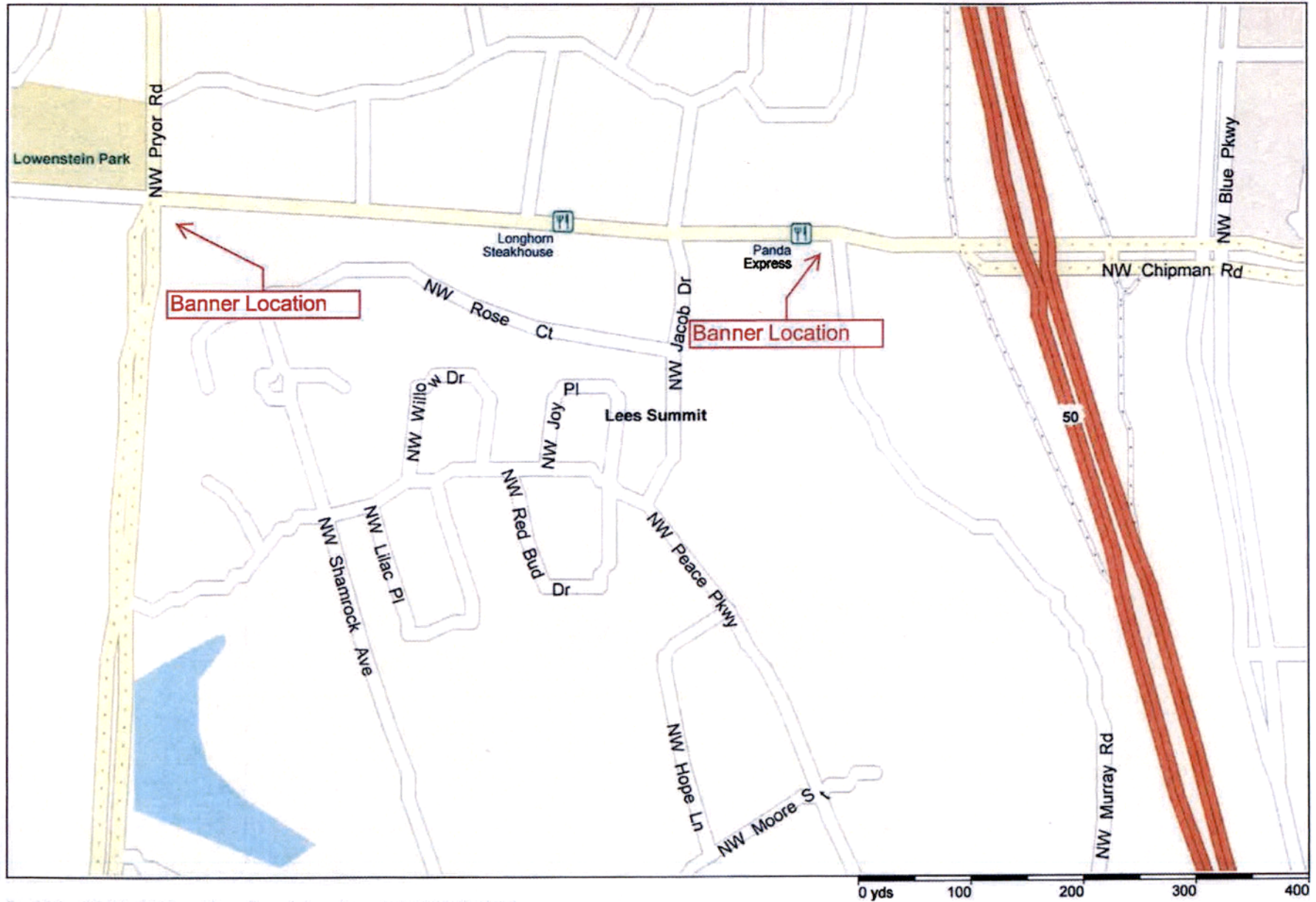

# RASPBERRY

## *Spring Expo*

**Art, Crafts & More**

**Friday**  
10:00-6:00

**Saturday**  
10:00-4:00



THE PAVILION  
AT JOHN KNOX VILLAGE

**FREE ADMISSION**