

NOTE:
TEMPORARY SEDIMENT BASIN AND OUTLET STRUCTURE W/ SKIMMER AND PLATE SHALL BE CONSTRUCTED WITH THE FIRST PHASE OF THE EROSION CONTROL PLAN. UPON FINAL STABILIZATION THE SKIMMER, PLATE, AND SEDIMENT SHALL BE REMOVED AND FINAL CONVERSION TO DETENTION BASIN COMPLETED. AN AS-BUILT RECORD DRAWING ACCEPTED BY THE CITY SHALL BE REQUIRED PRIOR TO OCCUPANCY.

Storm Sewer Construction Notes	
Structure	Notes
102	STA 1+90.50, LINE 100 INSTALL 6 X 5 CURB INLET 145'25"35" N 998213.9579 E 2841960.4357
201	STA 1+53.30, LINE 200 INSTALL 5' X 5' BASIN OUTLET STRUCTURE W/ 10 CU. YD. (20'X10'X1.5') STONE RIP-RAP USING A MIN. 50# (D50=12") STONE. PLACE FILTER FABRIC PRIOR TO CONSTRUCTION 235'15"56" N 998163.5557 E 2841943.1005

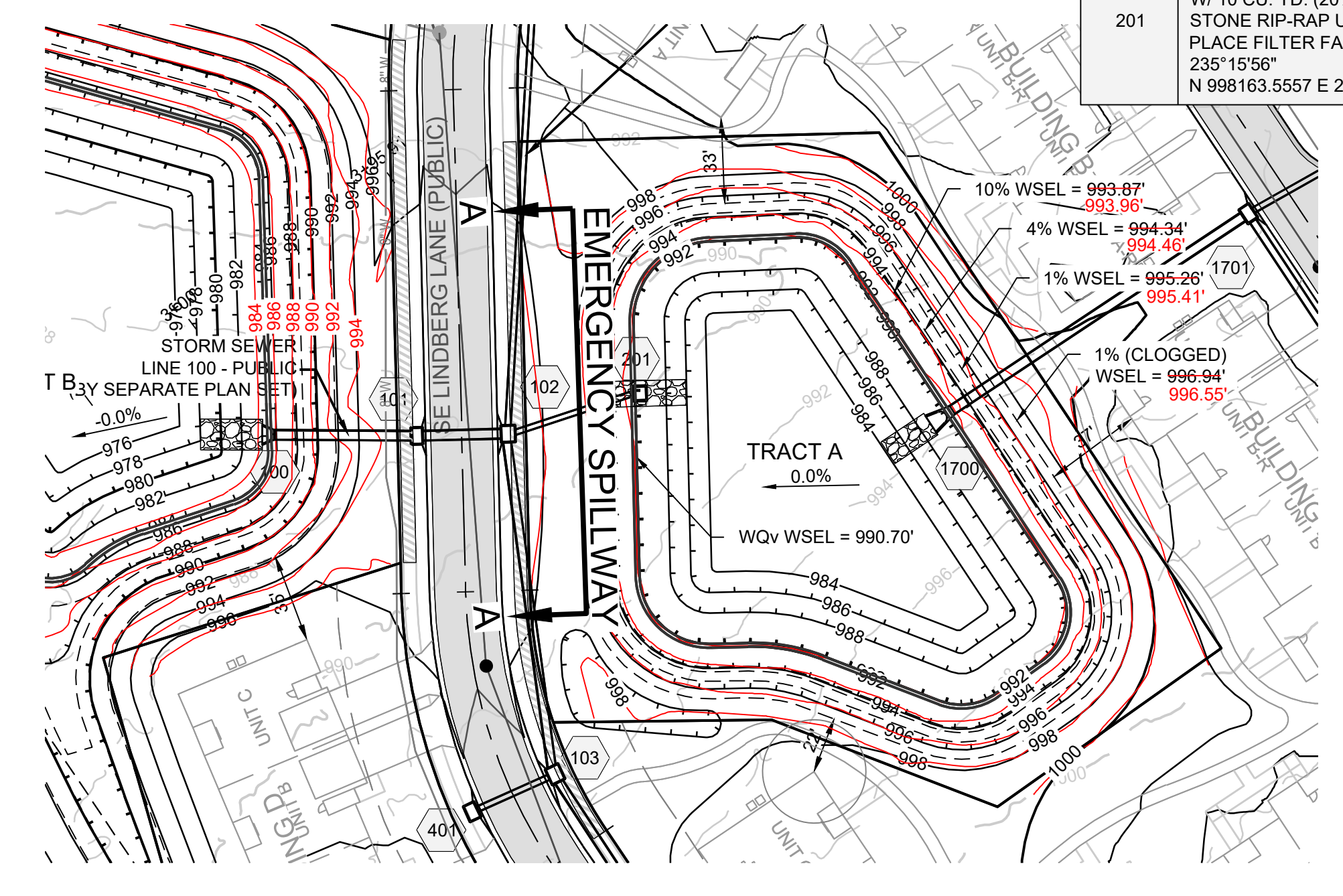

1% STORM STORAGE CAPACITY = 4.19 AC-FT
TOTAL BASIN CAPACITY = 6.02 AC-FT

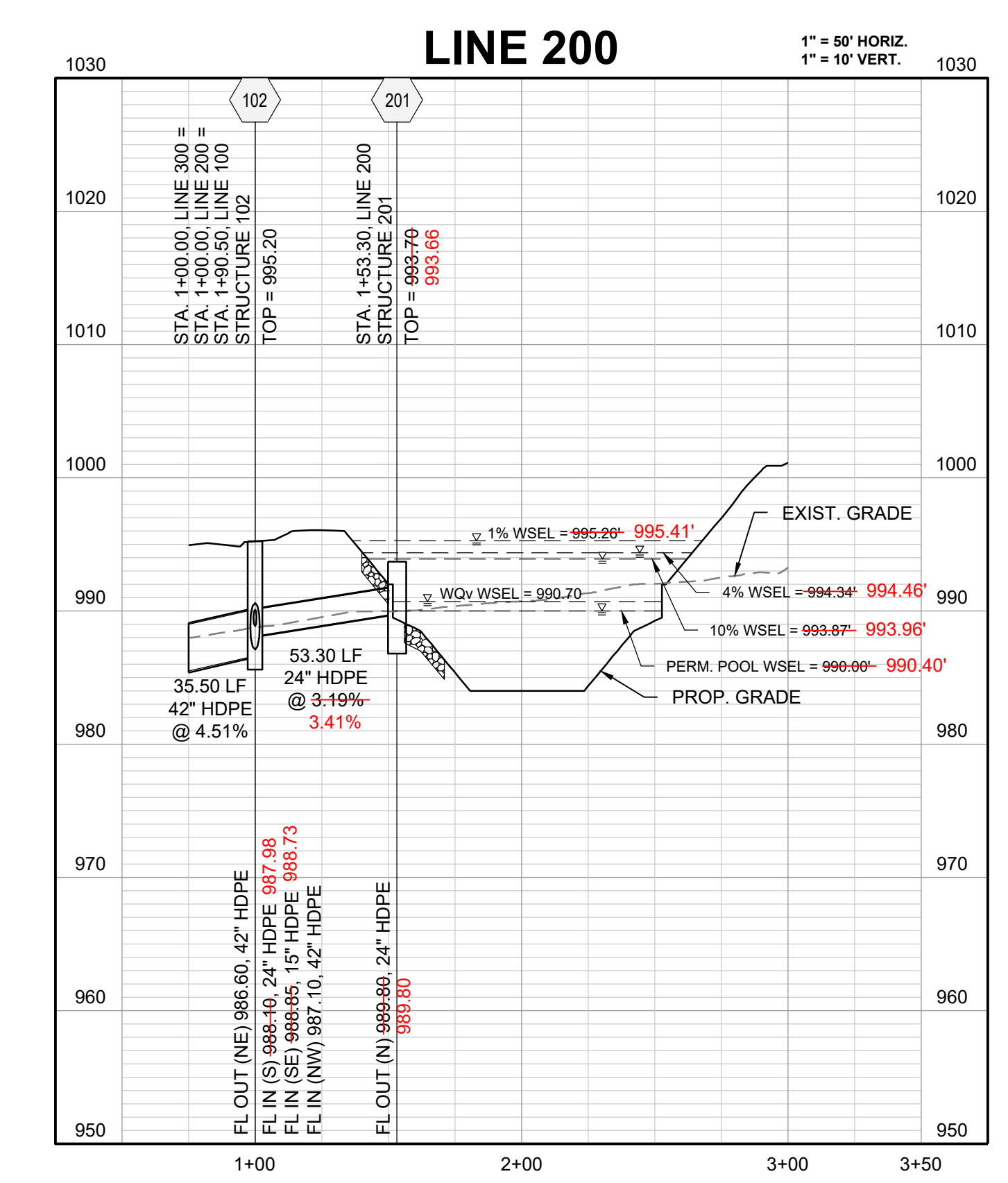

RECORD DRAWING

The information provided on this drawing conforms to construction records; it is not intended for construction, implementation or recording purposes; and it is solely based on information obtained by Schlager and Associates.

"400-00 100.10", "1.00% 1.15% slope", or "8-inch HDPE PVC pipe" are all typical examples of revisions that indicate that design data has been replaced with "as-built" information. All other data is as designed and has not been field verified.

Date: 1/30/2026
Certified by: MWM
Title: Sr. Project Engineer
Firm: Schlager and Associates, P.A.

REVISION DATE	DESCRIPTION
05/05/23	PER CITY COMMENTS
06/27/23	PER CITY COMMENTS
08/24/23	PER CITY COMMENTS
09/25/23	PER CITY COMMENTS
10/05/23	PER CITY COMMENTS
03/04/25	BUILDING FOOTPRINT REVISIONS
03/14/25	PER CITY COMMENTS
06/24/25	PER CITY COMMENTS
09/17/25	MAINTENANCE BUILDING UTILITIES

DRAWN BY: TRC
CHECKED BY: MAB
DATE PREPARED: 03/03/2023
PROJ. NUMBER: 06/24/25
22-697

OUTLET
STRUCTURE 201