

Oldham Village

SITE ADDRESS
Oldham Village
1050 SW Jefferson St,
Lee's Summit, MO 64081

INDEX
Page 1: Cover
Page 2: Sign Location
Page 3: Monument Sign
Page 4: Foundation Detail
Page 5: Chick-fil-A Tenant Panels

Revision 06
8/27/2025

PRESENTED BY:



550 STANLEY ROAD, KANSAS CITY KS 66115 • (816) 866-7446

PAGE

1

Oldham Village
 1050 SW Jefferson St,
 Lee's Summit, MO 64081

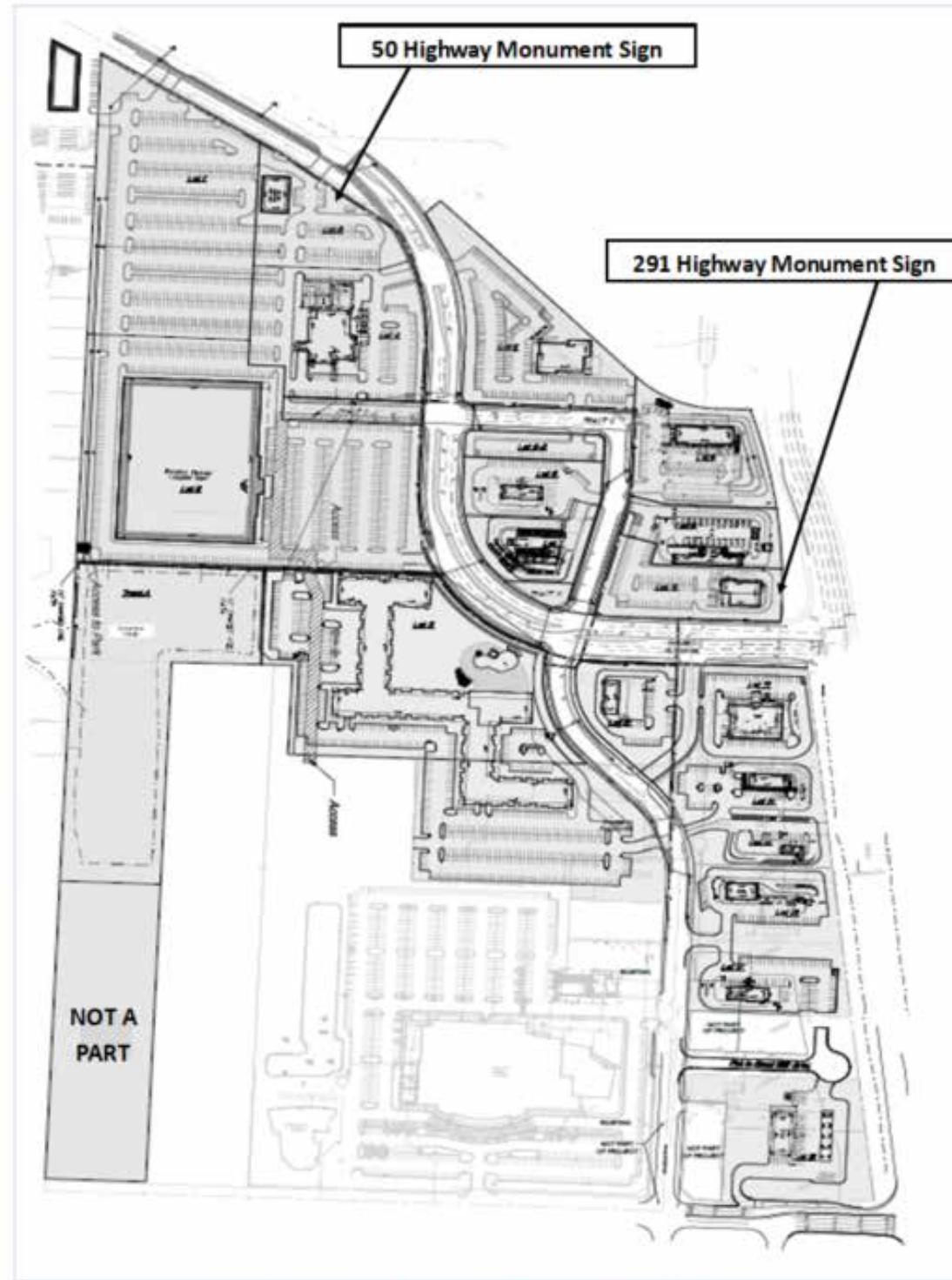

FOR DEMONSTRATION PURPOSES ONLY, ITEMS MAY NOT BE TO SCALE

MIDWEST SIGN COMPANY
 550 STANLEY RD, KANSAS CITY, KS
 (816) 866-7446

FILE NAME: Oldham Village Monument_06
DATE: 8/27/2025
CLIENT: Drake Development / Oldham Village
ADDRESS: 1050 SW Jefferson St, Lee's Summit, MO 64081
ACCOUNT MANAGER: Chris Kelly

REVISIONS:					
Rev #	Req #	Date	Req by	Drawn by	
	00	8/27/25	CK	KC	Original
	02	8/27/25	CK	KC	Site plan added
	03	9/29/25	CK	KC	Site plan updated

	Approval	Date
CLIENT		
SALES		
ESTIMATING		
ART		
ENGINEERING		
LANDLORD		

MULTI-TENANT MONUMENT SIGN

QTY two double-sided, internally illuminated monument signs with base skirt.
Cabinet: Welded aluminum framework with aluminum skin painted metallic silver.
Upper "Oldham Village" Cabinet: Routed .080" aluminum with 1" white push-thru acrylic.
 Painted medium grey.
Tenant panels: 3/16" white acrylic, individually removable.
Illumination Throughout: Principal Sloan LEDs, 7000k, 24VDC
Base Skirt: Stella Cream Dimensional stone veneer.
Foundation: Twin HSS steel poles and 6" above grade concrete pad.

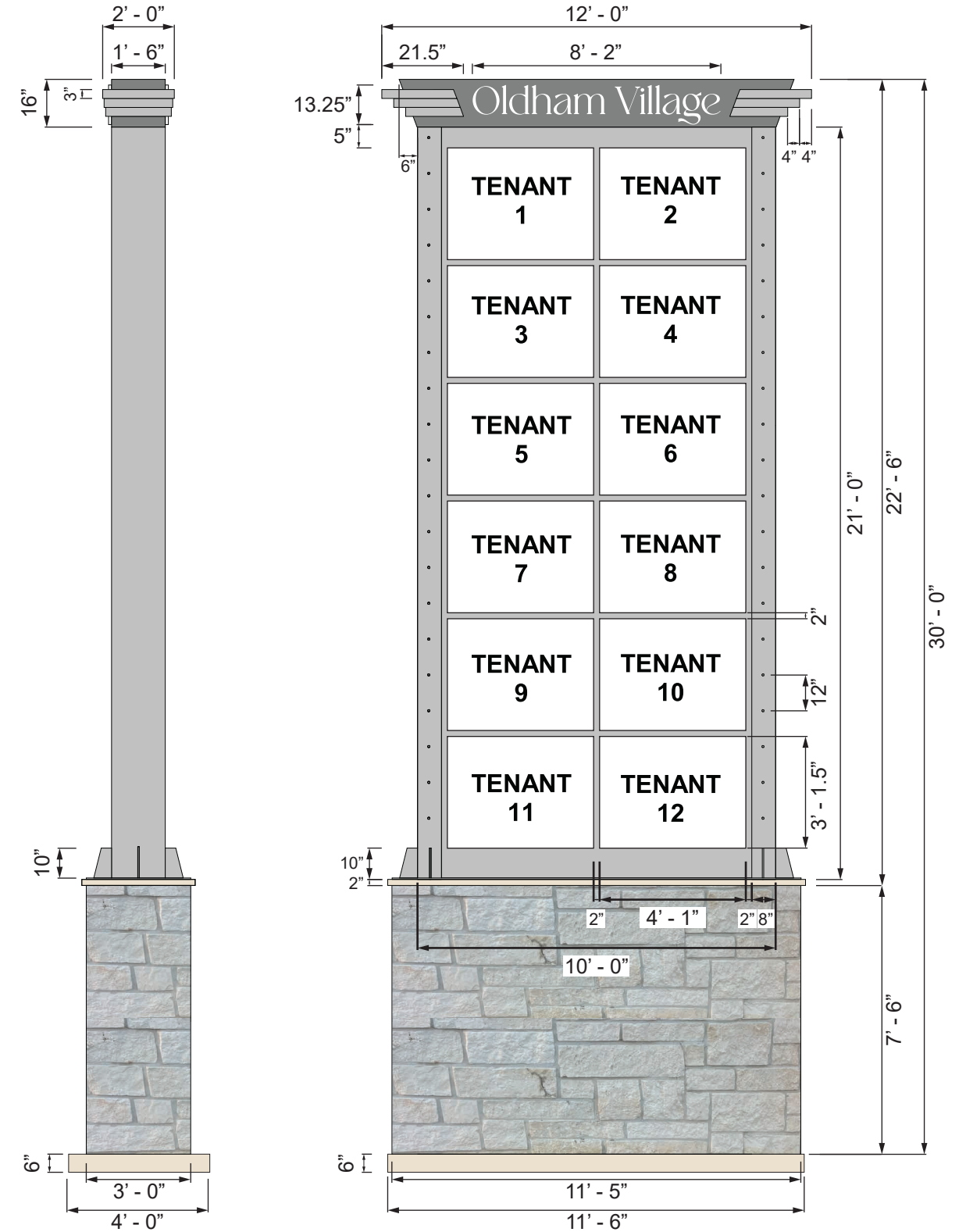

FILE NAME: Oldham Village Monument_06
 DATE: 8/27/2025
 CLIENT: Drake Development / Oldham Village
 ADDRESS: 1050 SW Jefferson St, Lee's Summit, MO 64081
 ACCOUNT MANAGER: Chris Kelly

REVISIONS:					
Rev #	Req #	Date	Req by	Drawn by	
	00	8/27/25	CK	KC	Original
	01	8/27/25	CK	KC	QTY two
	03	9/29/25	CK	KC	Revised stone veneer to Stella Cream Dimensional
	04	10/1/25	CK	KC	Stella Cream Dimensional image changed
	05	10/13/25	CK	KC	Option 2 removed
	06	10/29/25	CK	KC	Measurements adjusted

	Approval	Date
CLIENT		
SALES		
ESTIMATING		
ART		
ENGINEERING		
LANDLORD		

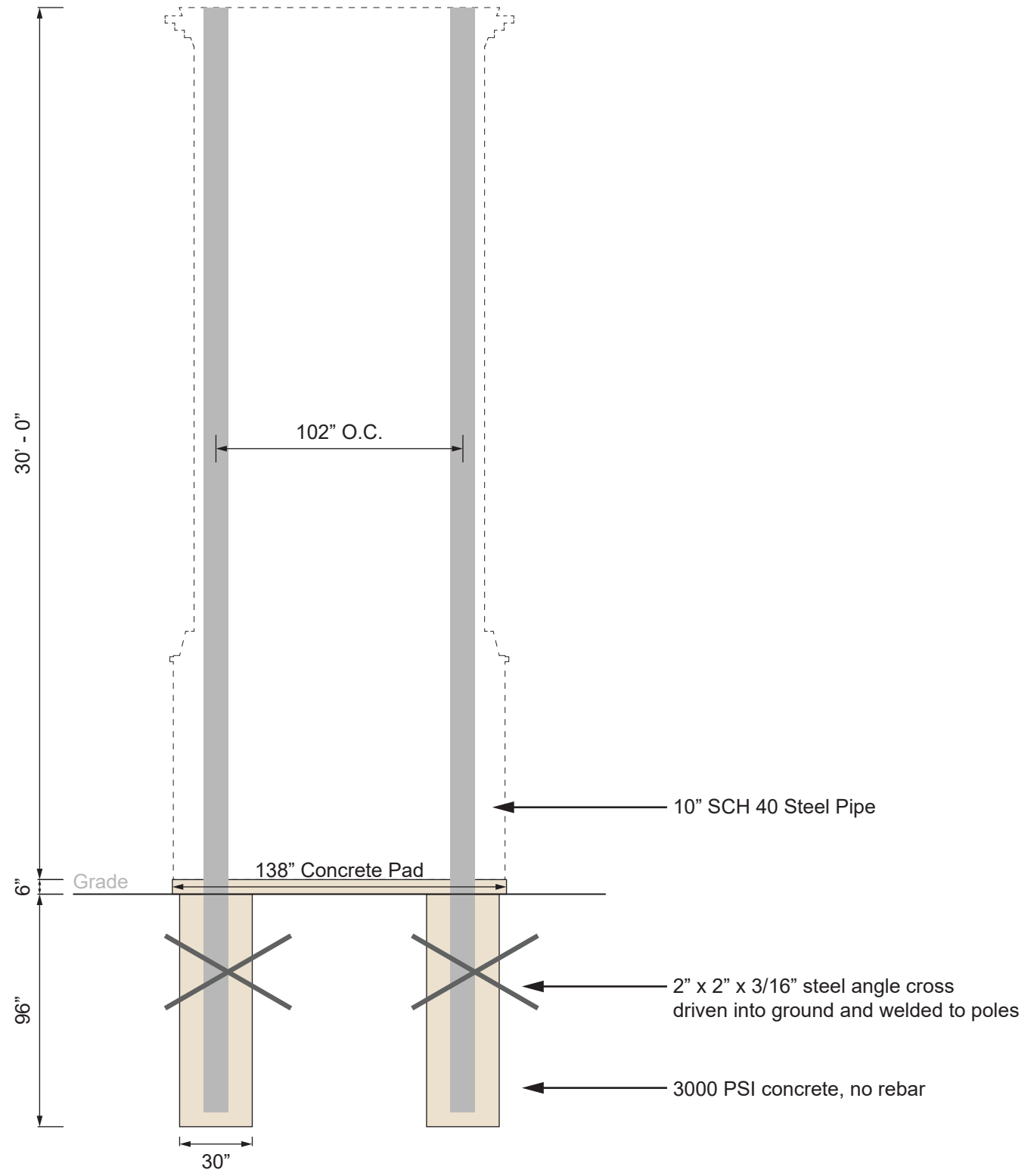

FILE NAME: Oldham Village Monument_06
 DATE: 8/27/2025
 CLIENT: Drake Development / Oldham Village
 ADDRESS: 1050 SW Jefferson St, Lee's Summit, MO 64081
 ACCOUNT MANAGER: Chris Kelly

REVISIONS:					
Rev #	Req #	Date	Req by	Drawn by	
	06	10/29/25	CK	KC	Foundation detail added

	Approval	Date
CLIENT		
SALES		
ESTIMATING		
ART		
ENGINEERING		
LANDLORD		

CHICK-FIL-A TENANT PANEL

QTY four tenant panels, two per monument.
 Panel to be in Tenant 2 space on both sides of both monuments.
Faces: 3/16" white acrylic with reverse-weeded vinyl graphics.
Vinyl color: **3M Cardinal Red 3630-53**

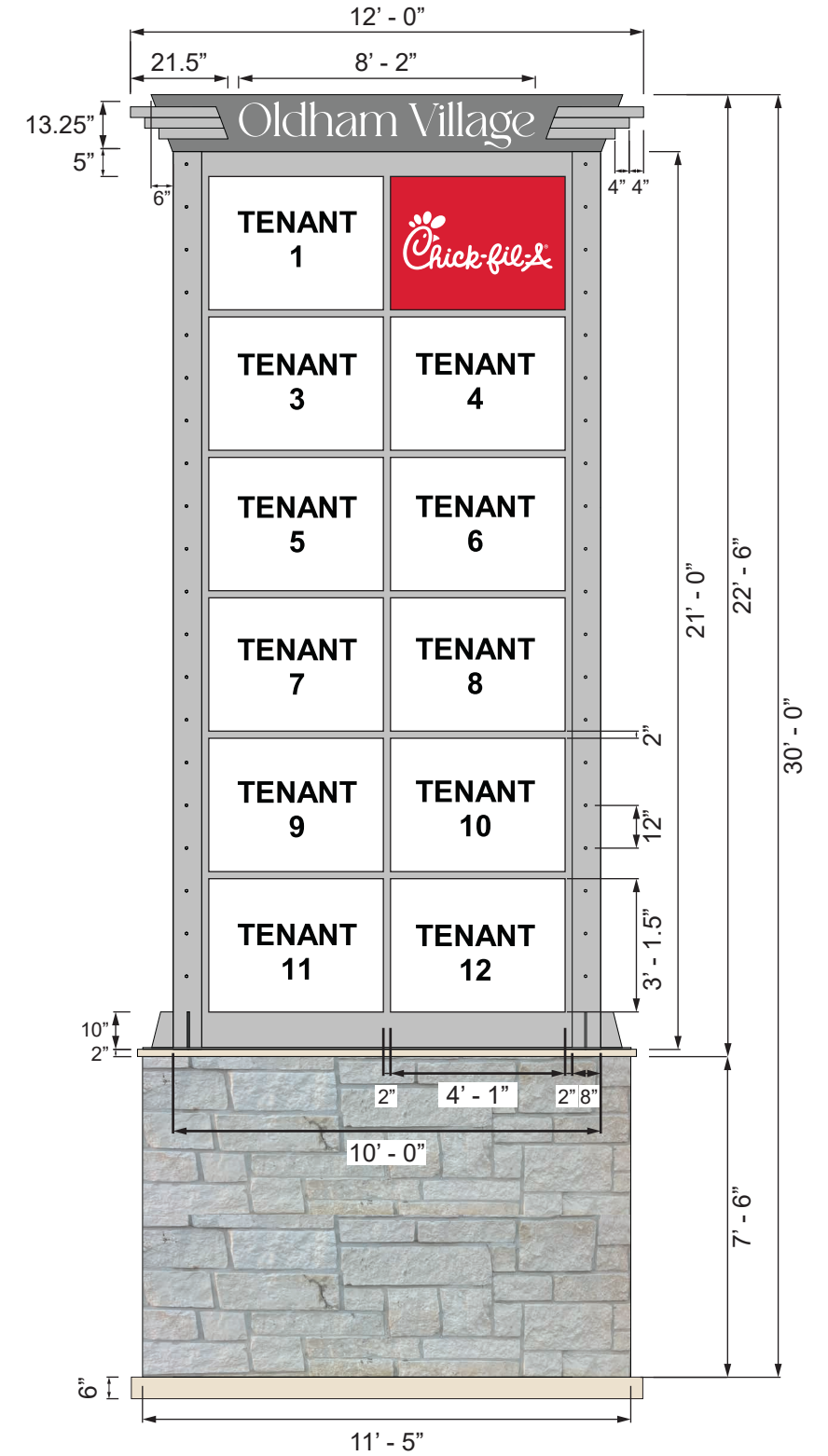
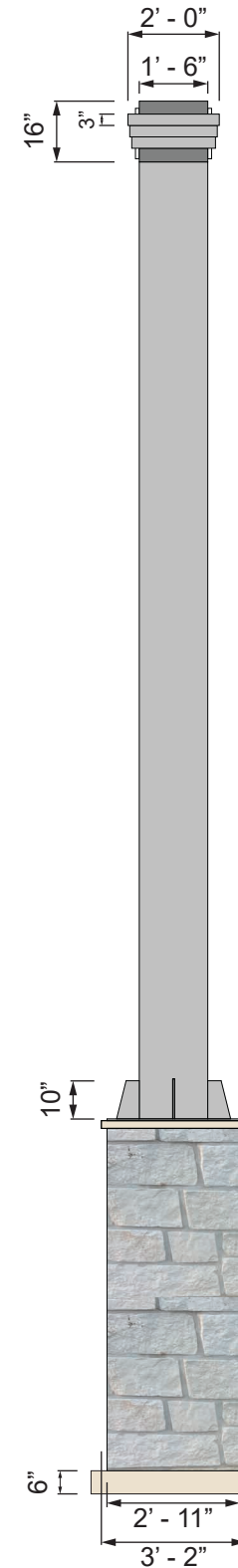

MIDWEST SIGN COMPANY
 550 STANLEY RD, KANSAS CITY, KS
 (816) 866-7446

FILE NAME: Oldham Village Monument_06
 DATE: 8/27/2025
 CLIENT: Drake Development / Oldham Village
 ADDRESS: 1050 SW Jefferson St, Lee's Summit, MO 64081
 ACCOUNT MANAGER: Chris Kelly

REVISIONS:					
Rev #	Req #	Date	Req by	Drawn by	
	02	8/27/25	CK	KC	Added Chick-fil-A tenant panel
	04	10/1/25	CK	KC	Stella Cream Dimensional image changed
	06	10/29/25	CK	KC	Panel measurements adjusted

	Approval	Date
CLIENT		
SALES		
ESTIMATING		
ART		
ENGINEERING		
LANDLORD		