

SYSTEM PLANNING:
 • FLOW ARROWS REFLECT GAS FEED PRIOR TO THIS WO
GAS OPS/GAS CONTROL
 • THERE ARE NO CONCERNS WITH THIS WO

CONSTRUCTION ENGINEERING:
 • INSTALL MAIN IN 70' ROAD ROW AND 10' UE
 • WO TO BE STAKED PRIOR TO CONSTRUCTION PER SR 9737954 BASED ON THE MAXIMO SCHEDULE START DATE. COORDINATE WITH ROW AT LEAST THREE WEEKS PRIOR TO CONSTRUCTION.

Page 2

PROPOSED PIPE SYSTEM
 PRESSURE SYS - 58 PSIG
 DESIGNED MAOP - 58 PSIG
 TEST PRESSURE - 100 PSIG

ENVIRONMENTAL:
 • THERE ARE NO ENVIRONMENTAL CONCERNS WITH THIS WORK ORDER

PIPELINE SAFETY AND COMPLIANCE:
 • THERE ARE NO PIPELINE SAFETY AND COMPLIANCE CONCERNS FOR THIS WORK ORDER

1. INSTALL AND ABANDON STEEL AND PLASTIC MAIN AND SERVICES PER SPIRE OPM STANDARDS.
2. SEE STD. 200.A FOR PRESSURE TESTING PIPING REQUIREMENTS
3. SEE STD. 180.B FOR EFV AND/OR MANUAL SHUTOFF VALVE INSTALLATION REQUIREMENTS
4. SEE STD. 170.I AND 190.G FOR TRACE WIRE AND TEST STATION INSTALLATION INFORMATION.
5. CORROSION PROTECTION INSPECTOR TO CHECK CATHODIC PROTECTION OF ALL EXISTING CATHODICALLY PROTECTED FACILITIES EXPOSED AND PROTECTED FACILITIES EXPOSED AND DIRECT STEPS NECESSARY TO MAINTAIN PROPER ISOLATION AND CATHODIC PROTECTION AS REQUIRED. A PIPE OBSERVATION REPORT IS TO BE CREATED IN MAXIMO ON READINGS
6. INSTALL ANODES PER STD. 190.C AND/OR TEST STATIONS PER STD. 190.G PER INSTRUCTIONS FROM CORROSION PROTECTION INSPECTOR.
7. CONDUCT INITIAL CATHODIC PROTECTION SURVEY FOR NEW STEEL INSTALLATION. (SEE 190.I FOR CATHODIC PROTECTION AT TIE INS)
8. CREATE PIPE OBSERVATIONS IN MAXIMO TO DOCUMENT EXPOSED PIPE CONDITIONS PER STD. 190.A, EXTERNAL CORROSION.
9. FOR UTILITY LOCATES, CALL ONE-CALL SYSTEM "811" OR (1-800-344-7483), AND ALL OTHER AFFECTED UTILITIES
10. CONTACT GIS DEPARTMENT FOR NECESSARY FIELD NOTES AT 314-349-2963.
11. CONTACT ROW TO SECURE NECESSARY EASEMENTS AND FOR ANY SURVEY WORK AT 314-713-6542
12. SEE STD. 170.J FOR SQUEEZE-OFF PROCEDURE
13. SEE STD. 170.A FOR GAS INTERRUPTION PROCEDURE REQUIREMENTS. CONTACT SYSTEM CONTROL AT 314-658-5486 OR 314-658-5488 PRIOR TO ANY WORK
14. SEE STD. 150.A AND 150.E FOR RADIOGRAPHIC EXAMINATION REQUIREMENTS
15. SPIRE PERSONNEL SHOULD FOLLOW STANDARD PRECAUTIONS REGARDING THE POTENTIAL FOR DRIP OIL TO BE PRESENT IN ACTIVE GAS MAINS AND ADHERE TO APPROVED PROCEDURES FOR MANAGEMENT/DISPOSAL OF ANY PIECES OF PIPE GENERATED IN THE COURSE OF ABANDONMENT. ANY DOCUMENTED DRIPS SHOULD BE CLEARED AND DRAINED BEFORE ABANDONMENT.

Existing Main / Asset Material	Main and Service	Valves/Meters/Regulators/CP	Fittings	Typical Soil Depth: 30" to 36"
— Bare Steel	— Proposed	⊗ Excess Flow Valve	⊠ End Cap	Normal Soil
— Coated Steel	- - - Abandon	⊕ Meter	⊞ Flange	Gravel
— Screwed Steel	— Proposed Previous WO	⊖ Controllable Valve	⊟ Reducer	Sand
— Cast Iron	- - - Abandon Previous WO	⊗ Regulator	⊠ Tee	Channery
— Plastic		⊕ Anode	⊞ Coupling	Solid Rock
			⊟ Tap / Saddle / Controllable Tee	

Check for Work Order Authorization

DESIGNER: 40170	REVISION DATE(S): _____
DATE: 11/5/2025	_____

FOR QUESTIONS ABOUT THIS DESIGN OR TO REQUEST A SCOPE OF WORK CHANGE PLEASE CONTACT JORDAN NGO AT 816-207-8157 OR FRED DEL TORO 816-266-3033



Work Order Title: 19 NE Sycamore St Lees Summit

Work Order: 36880866 Project #:808206

Municipality: Lees Summit

1:1,200

1 inch = 100 feet



Work Order Title: 19 NE Sycamore St Lees Summit (5 Day 11/03/25)

Work Order: 36880866 Project #:808206 Municipality: Lee's Summit



Tie-in Number _____
 Soap Test Yes No
 Date: _____
 Time: _____
 System Gauge Pressure: _____
 Signature: _____

Tie-in Number _____
 Soap Test Yes No
 Date: _____
 Time: _____
 System Gauge Pressure: _____
 Signature: _____

Tie-in Number _____
 Soap Test Yes No
 Date: _____
 Time: _____
 System Gauge Pressure: _____
 Signature: _____

Tie-in Number _____
 Soap Test Yes No
 Date: _____
 Time: _____
 System Gauge Pressure: _____
 Signature: _____

Tie-in Number _____
 Soap Test Yes No
 Date: _____
 Time: _____
 System Gauge Pressure: _____
 Signature: _____

PRESSURE TEST OF GAS MAINS (One Test Per Sheet)

Pipe Size: _____ Length (ft): _____

Pipe Size: _____ Length (ft): _____

Pipe Size: _____ Length (ft): _____

Designed MAOP _____

Test Medium: Water \ Air \ Gas Other: _____

Gauge Type: Recording Indicating Dead Weight

Gauge I.D. : _____

Calibration Date : _____

Test Date: _____

Start Time: _____ End Time: _____

Start Press.: _____ End Press. : _____

Start Temp.*: _____ End Temp.*: _____

* Water or Pipe temperature, not ambient

If Discharge volume is over 1,000 gallons - Contact Lab for sample.

Note all leaks or failures, including cause, and corrective action taken in comments below.

SEE STD. 200.A FOR PRESSURE TESTING OF MAIN REQUIREMENTS. FOR ANY QUESTIONS REGARDING THE STANDARD, PLEASE CONTACT PIPELINE SAFETY AND COMPLIANCE AT 816-863-1664 OR 816-469-9840.

Conducted By:

Signature: _____ Date: _____

Printed Name: _____

Page : _____ Of: _____

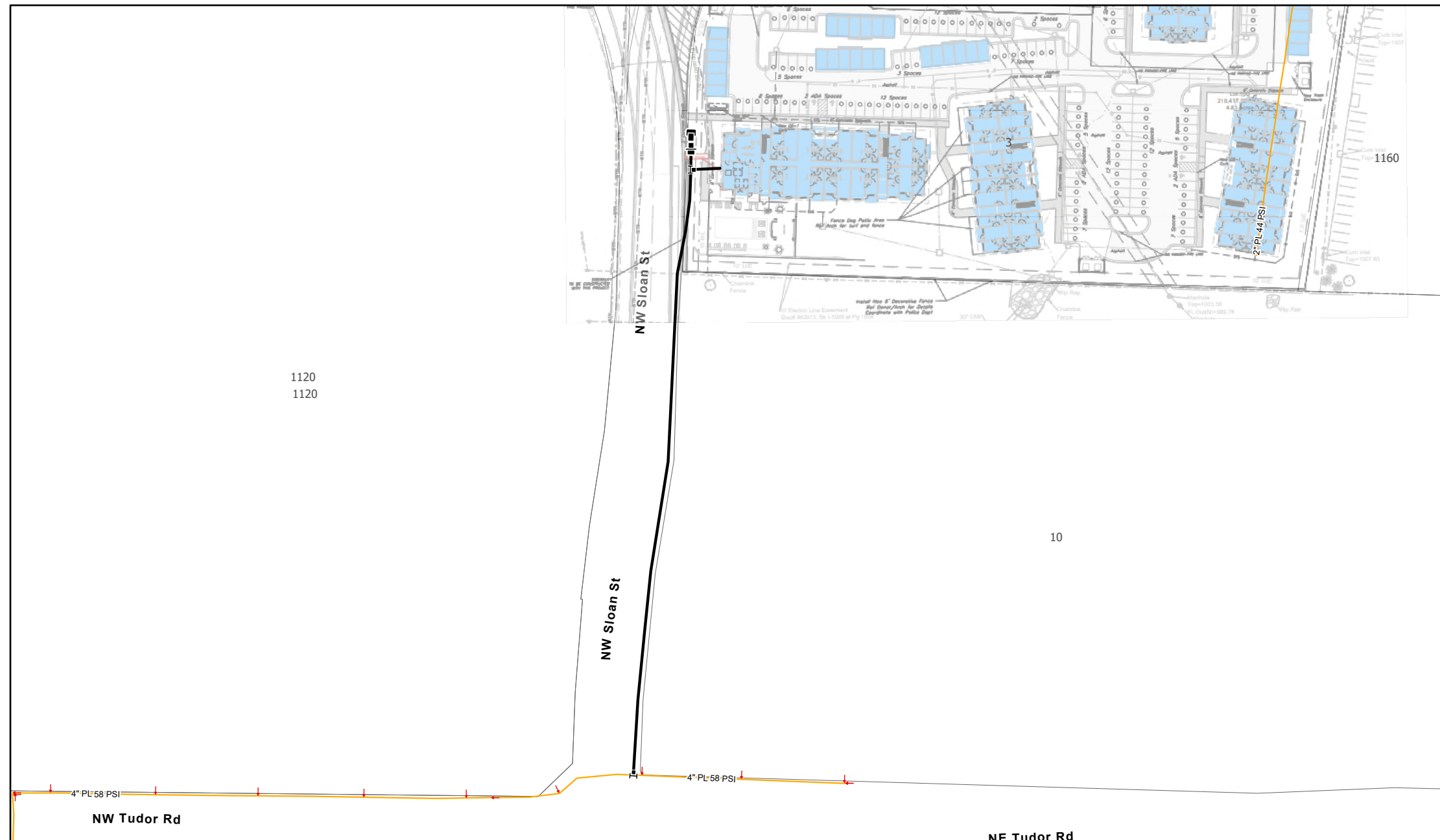

Comments: _____

