

LEGEND

- Gas Meter
- Telephone or Fiber-Optic Pedestal
- Cable TV Pedestal
- Electric Pedestal
- Light Pole
- Mailbox
- Fire Hydrant
- Water Valve

PROPOSED HOUSE

TOP FOUNDATION = 1041.25
GARAGE FLOOR = 1039.75
TOP FOOTING = 1032.25
BASEMENT FLOOR = 1032.58
DRIVE SLOPE = 7.9%

E = EXISTING ELEVATION
F = PROPOSED FINAL ELEVATION
G = ADJACENT GRADE AT EGRESS
U/E = UTILITY EASEMENT
B/L = BUILDING LINE
S/Y/S = SIDE YARD SETBACK
R/Y/S = REAR YARD SETBACK

NOTES

1. BUILDER TO VERIFY ALL BUILDING ELEVATIONS AND DIMENSIONS.
2. THIS PLOT PLAN DOES NOT CONSTITUTE A BOUNDARY SURVEY.
3. THE EASEMENTS SHOWN ON THIS PLOT PLAN ARE TAKEN FROM THE FINAL PLAT. OTHER EASEMENTS MAY EXIST.

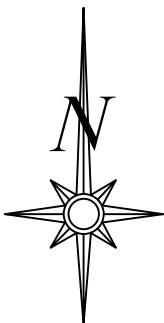

Scale 1"=30'

LOT INFORMATION

14,355.10 SQ. FT.
MBFE = 1030.62
ADDRESS
1933 SW HIGHTOWN DR
LEGAL DESCRIPTION
LOT 120, THE RESERVE AT STONEY CREEK - 4TH PLAT, A SUBDIVISION AS RECORDED IN LEE'S SUMMIT, JACKSON COUNTY, MISSOURI.

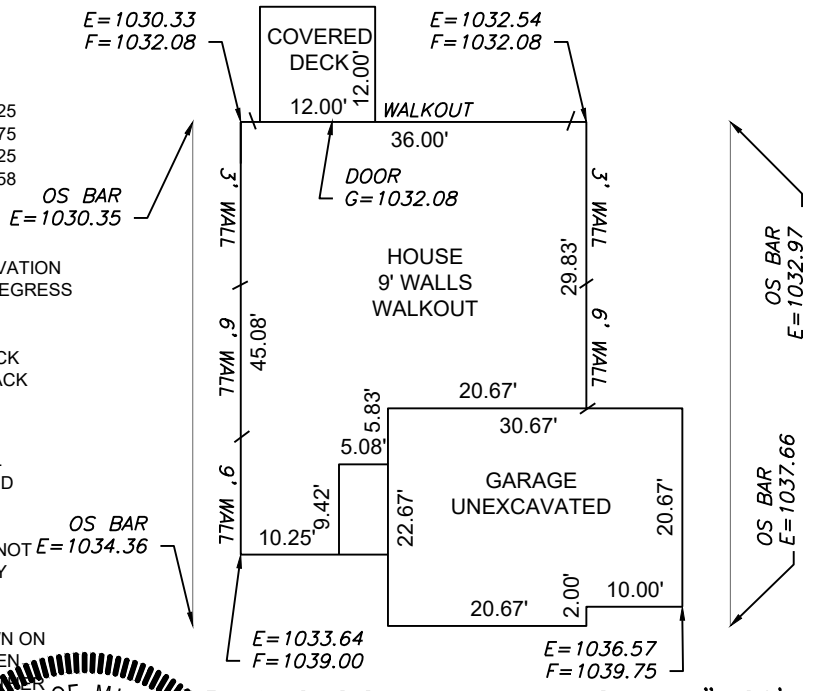

PLAN: OASIS

Scale 1"=20'

ENGINEERING SOLUTIONS
ENGINEERING & SURVEYING
50 SE 30TH STREET
LEE'S SUMMIT, MO 64082
P:(816) 623-9888 F:(816)623-9849
WWW.ENGINEERINGSOLUTIONSKC.COM

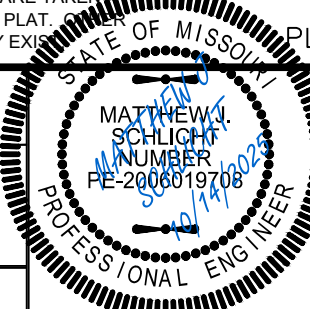

PLOT PLAN - LOT 120
RESERVE AT STONEY CREEK - 4TH PLAT
LEE'S SUMMIT, JACKSON COUNTY, MISSOURI
AVITAL PROPERTIES GROUP
P.O. BOX 23100
OVERLAND PARK, KS 66283

PROJECT NO. 1	FILE NAME LOT 120, RESERVE AT STONEY CREEK	DATE 9/17/25	SHEET 1	OF 1
---------------	--	--------------	---------	------

THIS DRAWING IS NOT VALID UNLESS THE SIGNATURE, DATE AND SEAL OF THE ENGINEER WHO SUPERVISED THE PREPARATION OF THIS DRAWING HAS BEEN AFFIXED HERETO.



Update MBOE
October 14, 2025
Lot 120, The Reserve At Stoney Creek 4th Plat

To Whom it May Concern

The Master Drainage Plan for The Reserve at Stoney Creek – 4th Plat calls MBOE's for Lot 120, these were placed erroneously, there is no need for an MBOE on this lot. If you have any questions or need anything else please feel free to give me a call at (816) 623-9888.

Thank You

Matthew J. Schlicht, PE
PE-2006019708

