

- NOTES:**
1. THE CONTRACTOR OR CONTRACTORS SHALL VERIFY THAT THE FOUNDATION DIMENSIONS SHOWN AND THE CONSTRUCTION STAKING ARE IN COMPLIANCE WITH THE OWNERS OR BUILDERS FOUNDATION PLAN. CUTS OR FILLS SHOWN ON CONSTRUCTION STAKING ARE FOR ASSISTANCE IN EXCAVATION ONLY. FINAL BASEMENT OR TOP OF FOUNDATION ELEVATIONS SHALL BE MADE BY THE OWNER OR CONTRACTOR.
  2. IT IS THE RESPONSIBILITY OF THE CONTRACTOR TO VERIFY THE DEPTH OF THE SANITARY SEWER IN RELATION TO THE FOUNDATION PRIOR TO POURING THE FOUNDATION.
  3. NO TITLE REPORT WAS PROVIDED BY THE CLIENT. BOUNDARY & CONSTRUCTION SURVEYING, INC. ASSUMES NO RESPONSIBILITY FOR BOUNDARY OR EASEMENTS NOT SHOWN. THE CLIENT HAS MADE AN AGREEMENT THAT THIS IS NOT A BOUNDARY SURVEY.
  5. DECK NOTE: DECK APPROVAL REQUIRED PRIOR TO CONSTRUCTION.
  6. AS-GRADED PLOT PLAN NEEDED (PER SECTION 7-160, CODE OF ORDINANCES)

- LEGEND**
- S/B - BUILDING SETBACK LINE
  - U/E - UTILITY EASEMENT
  - R/W - RIGHT-OF-WAY
  - M - MEASURE
  - R - RADIUS
  - L - ARC LENGTH
  - MBFE - MINIMUM BASEMENT FLOOR ELEVATION
  - TF - TOP OF FOUNDATION
  - BSMT- BASEMENT
  - GAR - GARAGE
  - TC - TOP OF CURB
  - E - EXISTING ELEVATION
  - F - FINISHED ELEVATION
  - ⇒ - DRAINAGE ARROW

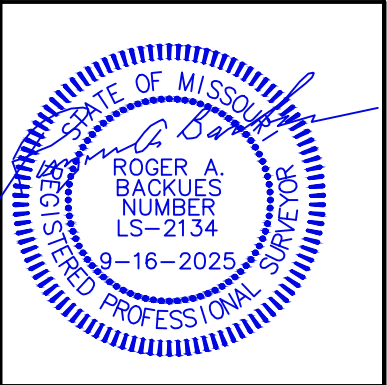

RELEASE FOR CONSTRUCTION  
AS NOTED ON PLANS REVIEW  
DEVELOPMENT SERVICES  
LEE'S SUMMIT, MISSOURI  
09/17/2025 3:17:10



PLOT PLAN	
BOUNDARY & CONSTRUCTION SURVEYING, INC.	
821 NE COLUMBUS STREET SUITE 100, LEE'S SUMMIT, MO. 64063 PH.# 816/554-9798, FAX # 816/554-0337	
PROJECT NO. 23-183	SHEET 1 OF 1
235 & 237 NW ORCHARD CT, LEE'S SUMMIT, MISSOURI	

**DESCRIPTION:**  
ALL OF BUILDING 6, A PART OF TRACT 1, SEQUOIA RESIDENTIAL,  
A SUBDIVISION IN LEE'S SUMMIT, JACKSON COUNTY, MISSOURI

DATE: 9.11.25	DEVELOPER
20 10 0	SITE360 LLC,
Scale In Feet 1" = 20'	1813 SW FOUNTAIN DR. LEES SUMMIT, MO. 64030